



# Casters [9A365]

**Components:**

Casters .....	4
Screws (5/16") .....	4
Washers .....	4

**Special Tools:**  
4" x 4" x 24" support

**Intended Use:**  
To make exam table mobile.

**Restrictions:**  
Do not install casters with rotational base.

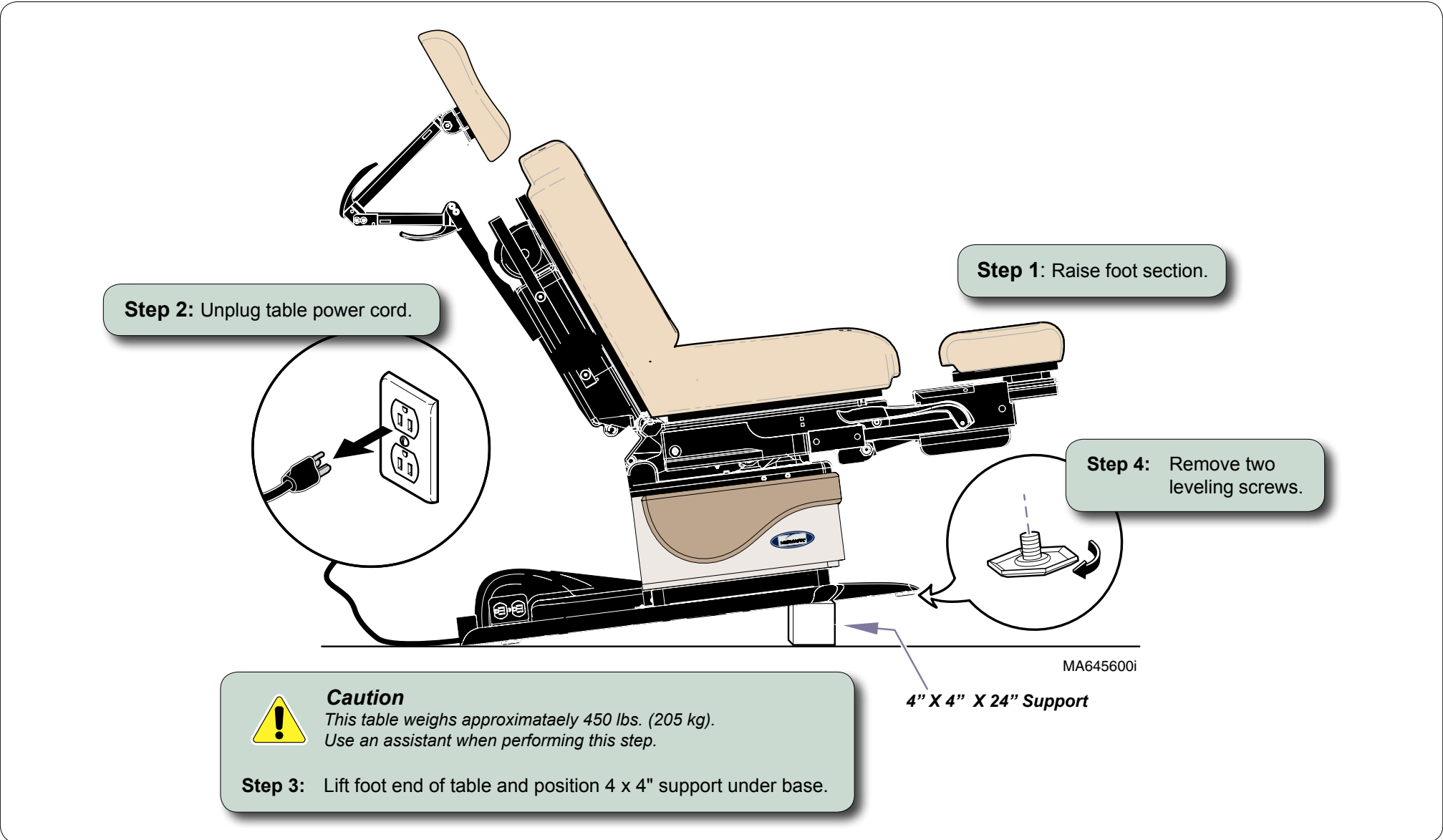

**Step 5:** Position foot end casters and secure with screws & washers.

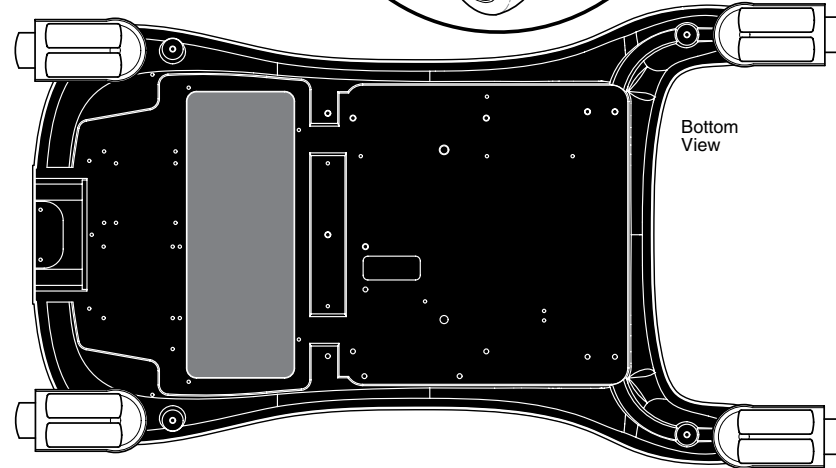
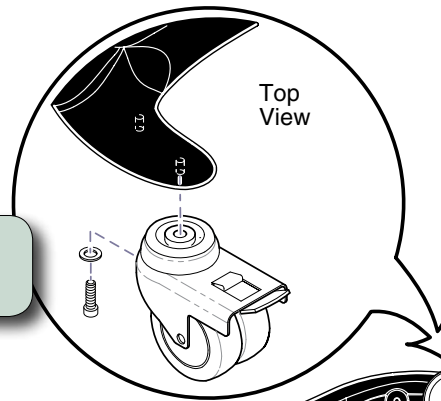

**Caution**

To prevent injury, lock foot end casters before performing Step 6.

**Step 6:** Position 4 x 4" support under head end of base. Install head end casters (same procedure).



**Caution**

To prevent injury, always lock casters before performing any procedures.

**To UNLOCK caster(s)...**  
Lift up on brake lever.

**To LOCK caster(s)...**  
Press down on brake lever.

MA743800i

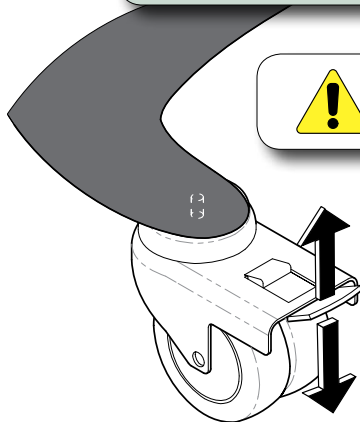

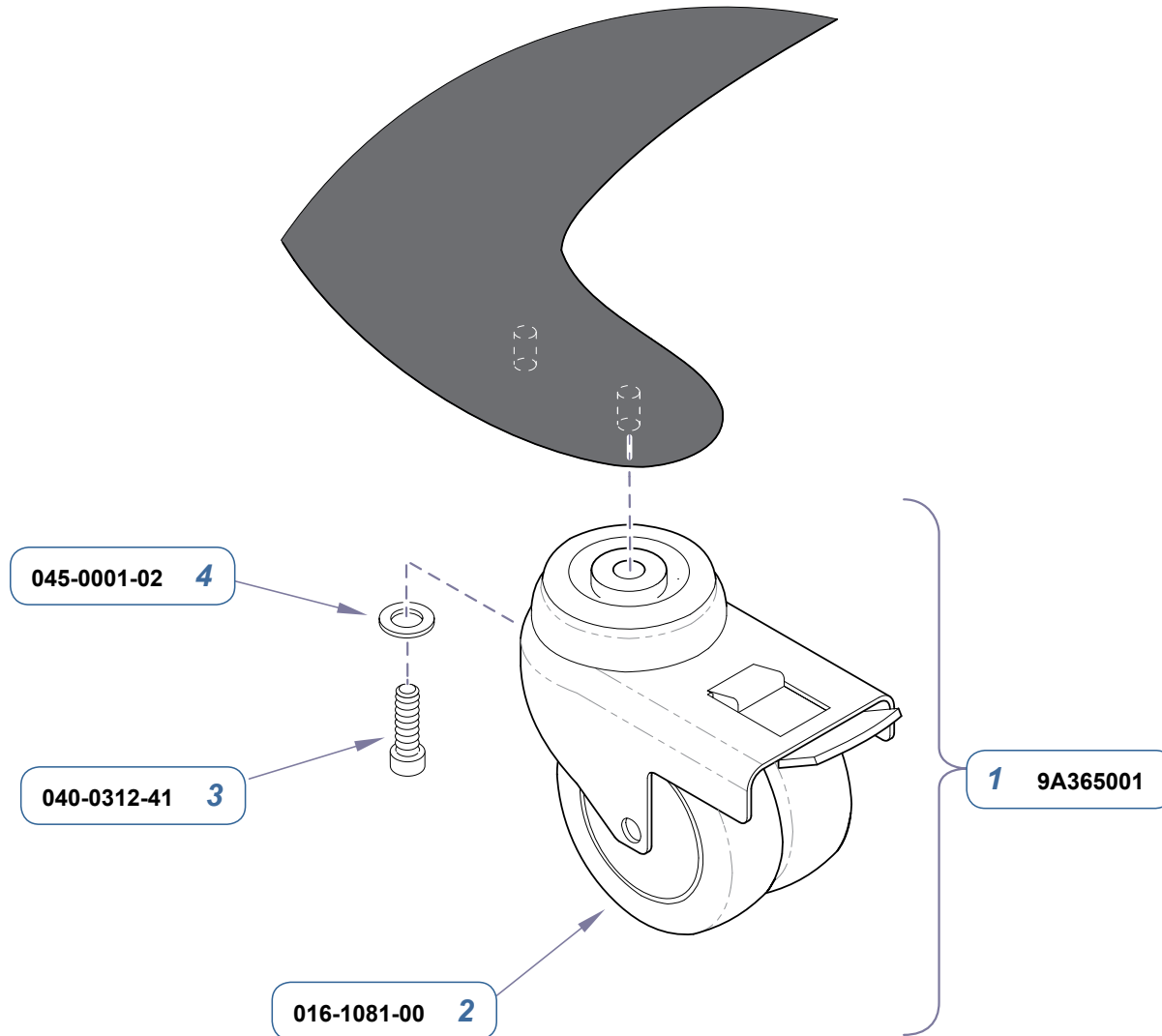

Item	Description	Qty.
1	Caster Accessory (incl. items 2 thru 5)	1
2	• Twin Wheel Caster	4
3	• Screw (5/16"-18 x 1")	4
4	• Washer (1/4", type "A", plain)	4
<b>Always specify Model &amp; Serial Number</b>		

**Serial Numbers / Dates:** all