



## Artizan® Expressions Side Station Installation

### Applies to Models:

SS5800-L/R, SS5810-L/R,  
SS6210-L/R, SS6310-L/R,  
SS7200-L/R, SS7210-L/R,  
SS7300-L/R

### Special Tools:

none

Language of origin: English

#### **Note:**

*All wiring, including disconnect, and plumbing must be installed by a licensed electrician or plumbing contractor following applicable local, city, and national codes.*



#### **Equipment Alert**

*Inspect all components for shipping damages. A concealed damage report must be filed with the carrier (by the person receiving the goods) within 15 days of delivery.*

#### **Note:**

*Cabinet hardware, configuration, and options may vary. General cabinet hardware, configuration, and options shown for assembly example purposes only.*

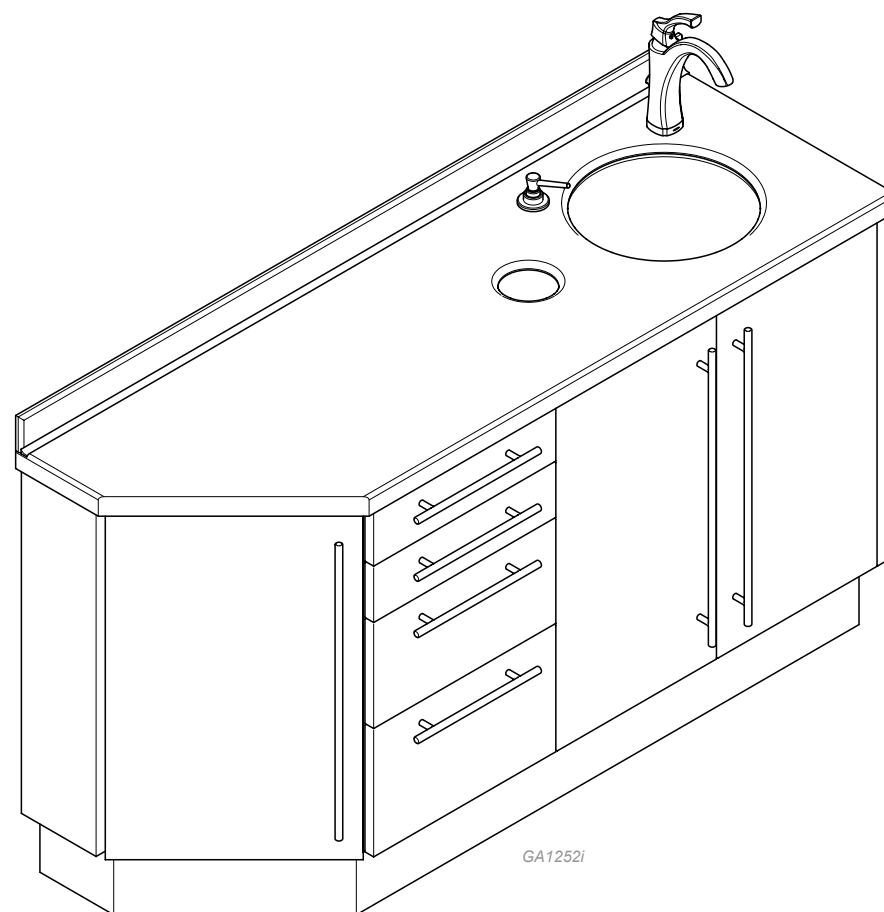

## Important Information and Symbols

These symbols may appear on your equipment and / or in the manuals.



### **WARNING**

*Indicates a potentially hazardous situation which could result in serious injury if not avoided.*



### **Caution**

*Indicates a potentially hazardous situation which may result in minor or moderate injury if not avoided. It may also be used to alert against unsafe practices*



### **Equipment Alert**

*Indicates a potentially hazardous situation which could result in equipment damage if not avoided.*

### **Note:**

*Amplifies a procedure, practice or condition.*



Proper Shipping Orientation



Fragile



Keep Dry



Consult User Guide



AC (Alternating Current)



Pressure Limits



Humidity Limit

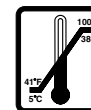

Temperature Limit



Type B Applied Part



No Stacking



Corrugated Recycle

## **Contact Information:**

Midmark Corporation  
115 G.L. Comer Road  
Glasgow, Kentucky 42141  
Phone: 1-800-643-6275 ext. 88015  
Fax: (270)-651-1732

## **Intended Use**

The Artizan® Expressions line of cabinetry is intended for use by the professional dental practitioners as supporting products in their practice providing adequate storage and technology integration for typical operatory products and equipment while still retaining an aesthetic appeal. The cabinetry should be designed to address the needs that the dental practitioners have when working in the operatory.

## **Transportation / Storage / Operating Conditions**

Transportation / Storage Temperature Range: ..0°F to 140°F (-18°C to 60°C)  
Relative Humidity:..... 10% to 90% (Non-Condensing)  
Atmospheric Pressure:.....7.2 PSI to 15.3 PSI (50 kPa to 106 kPa)  
Operating Temperature Range.....59°F to 95°F (15°C to 35°C)

## **Disposal of Equipment / Consumable Goods**

At the end of this products life, the unit, accessories and other consumable goods may be contaminated from normal use. Consult local codes and ordinates for proper disposal of this equipment and other consumables.

# Floor Layout

## Note:

Have licensed electrical and plumbing contractors position and install electrical outlet receptacles and related plumbing using the pre-installation template or layout. Assure floor is of such construction that the unit will be adequately supported and anchored. If necessary contact a licensed contractor to reinforce the flooring.

## Note:

A full size, pre-installation floor template is available upon request:

- Side Station, SS5800, P/N: 003-2731-xx
- Side Station, SS5810, P/N: 003-2732-xx
- Side Station, SS6310, P/N: 003-2733-xx
- Side Station, SS7200, P/N: 003-2734-xx
- Side Station, SS6210, P/N: 003-2735-xx
- Side Station, SS7210, P/N: 003-2736-xx
- Side Station, SS7300, P/N: 003-2737-xx

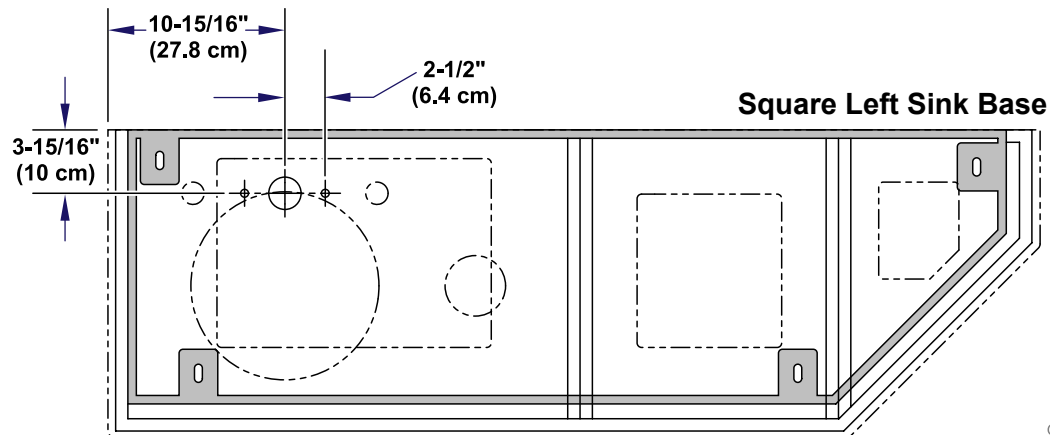
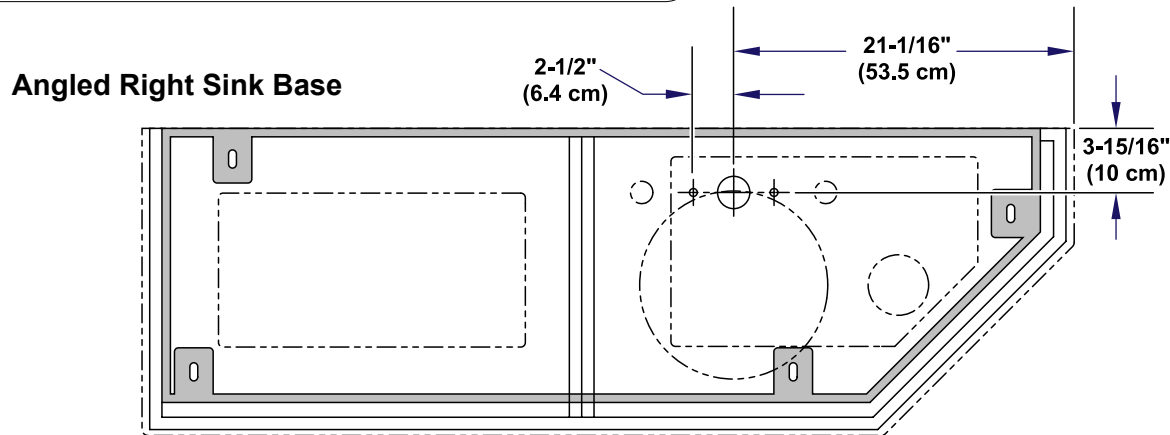
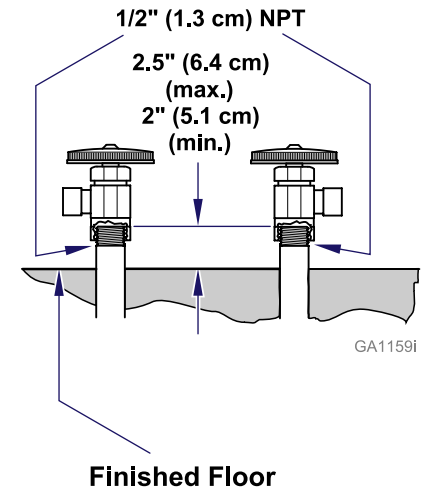

# Wall Layout

**Note:**

Have licensed electrical and plumbing contractors position and install electrical outlet receptacles and related plumbing using the pre-installation template or layout. Assure floor is of such construction that the unit will be adequately supported and anchored. If necessary contact a licensed contractor to reinforce the flooring.

**Note:**

A full size, pre-installation floor template is available upon request. Contact your Midmark customer experience representative.

**Note:**

Vertical dimensions specified are to the **finished floor**.

### Angled Sink Right Base

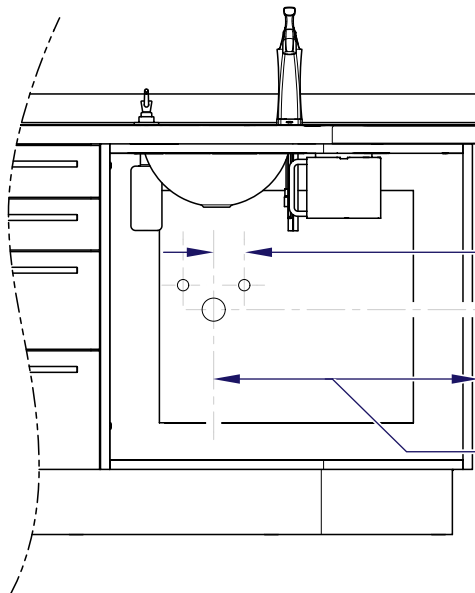

### Angled Sink Left Base

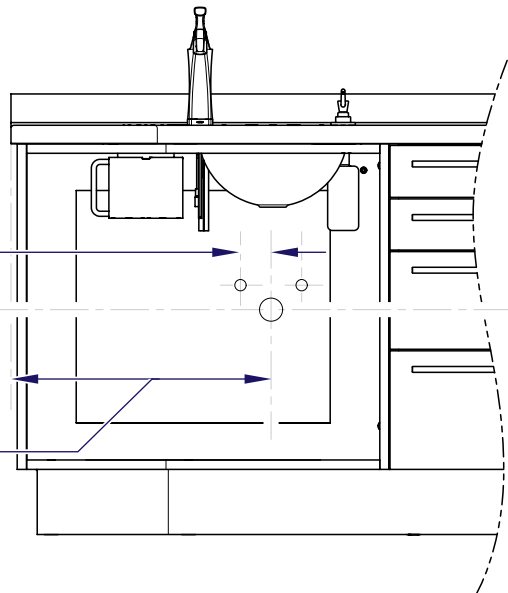

### Square Sink Right Base

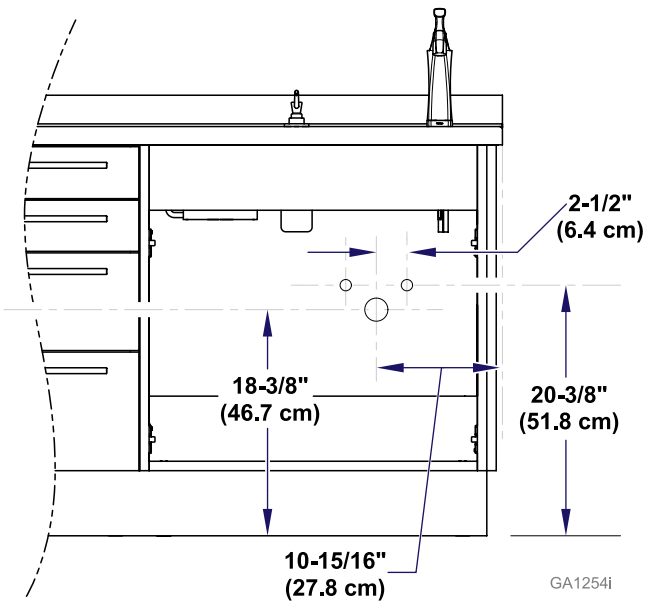

GA1254I

## Side Cabinet Installation

### Step 1: Remove Sink Base and Equipment Base

- A) Cut Straps and remove shipping materials.
- B) Remove cabinet drawers, doors and shelves. (Refer to Drawer Removal, Installation, and Adjustment and Door Removal, Installation, and Adjustment in this manual).
- C) Access under the cabinet through false bottom cutouts use a 3/8" socket to remove lag screws securing base clips and cabinet to shipping pallet.
- D) Move cabinet into area for installation.
- E) Using floor template, or measurement specified drill holes into floor for base clip installation. Use a 3/8" masonry drill bit for concrete and a 9/32" wood drill bit for composite flooring.
- F) Set cabinet in place over rough-in plumbing.

Note: Be sure to save base clips and lag screw to use later in the installation process to secure cabinet to floor of the building.



### WARNING

Top not to be utilized for lifting. Refer to illustrations for proper lifting points.

### Base Clip Removal / Install

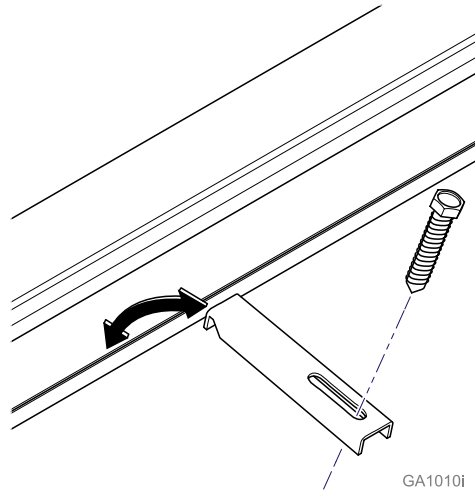

SS5800-R shown

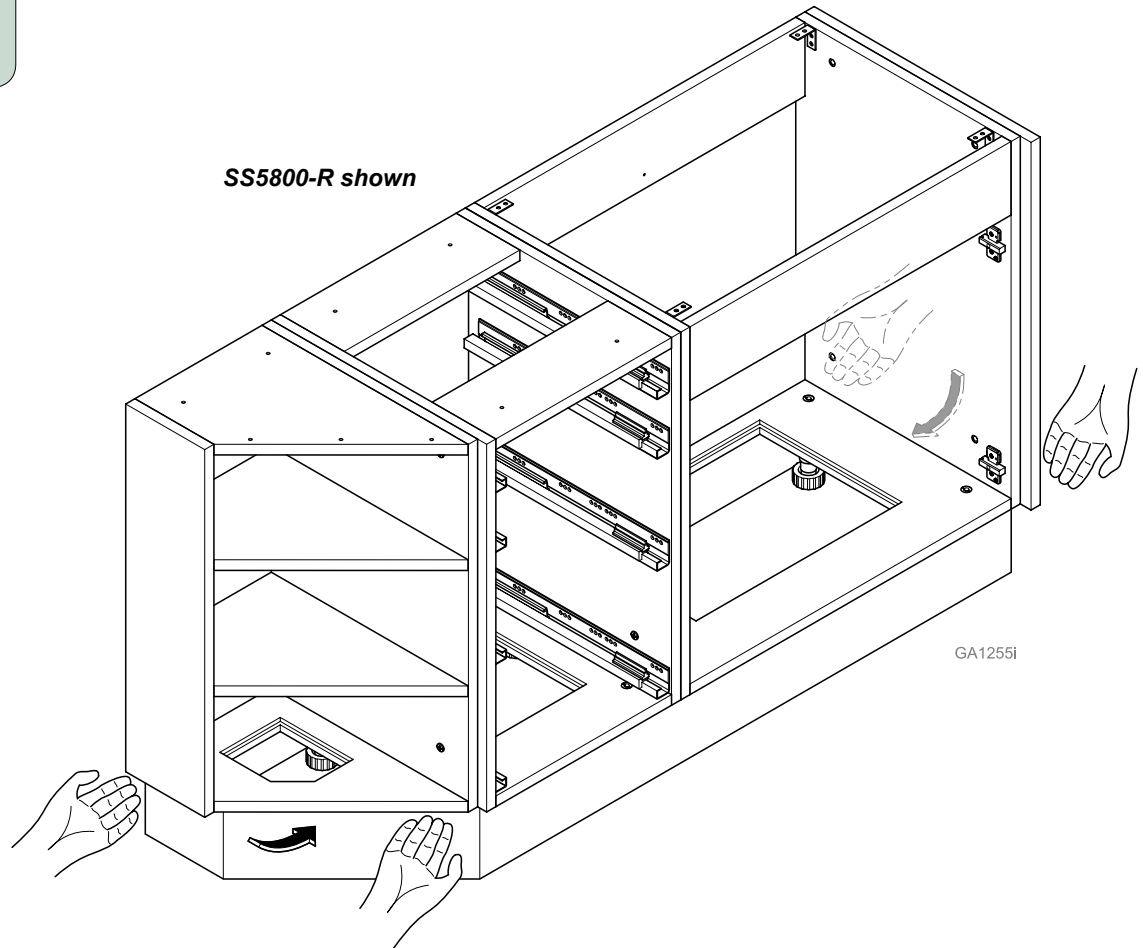

### Caution

Cabinet modules are significant in weight. Lift with two people on the bottom edge of the cabinet. Only lift the cabinet in designated locations after drawers have been removed. Refer to illustrations for proper lifting points.

## Side Cabinet Installation

### Step 2: Side Station Install

- A) Using a level as necessary, unscrew the leg levelers using a flat head screwdriver through the hollow leg bolt in the bottom of the cabinet (see Adjustable Camar Leg Leveler) or by hand through the false bottom cutout until cabinet is level.
- B) Use the lag screws (if floor is made of composites) and base clips that were used to secure the cabinet to the shipping pallet and secure the cabinet to the floor of the building. If the floor is concrete, then utilize the supplied floor anchors.

Note: To make installation easier and to prevent damage to area surrounding the screw hole in the floor, drill pilot holes. Use a 3/8" masonry bit for concrete and a 9/32" wood drill bit for composite flooring.



#### Equipment Alert

Adjusting both ends of the assembly will level the cabinets but will not support the rated load. Be sure that all leg levelers are adjusted such that they are in contact with the floor and thus supporting the load of the cabinets and its contents.

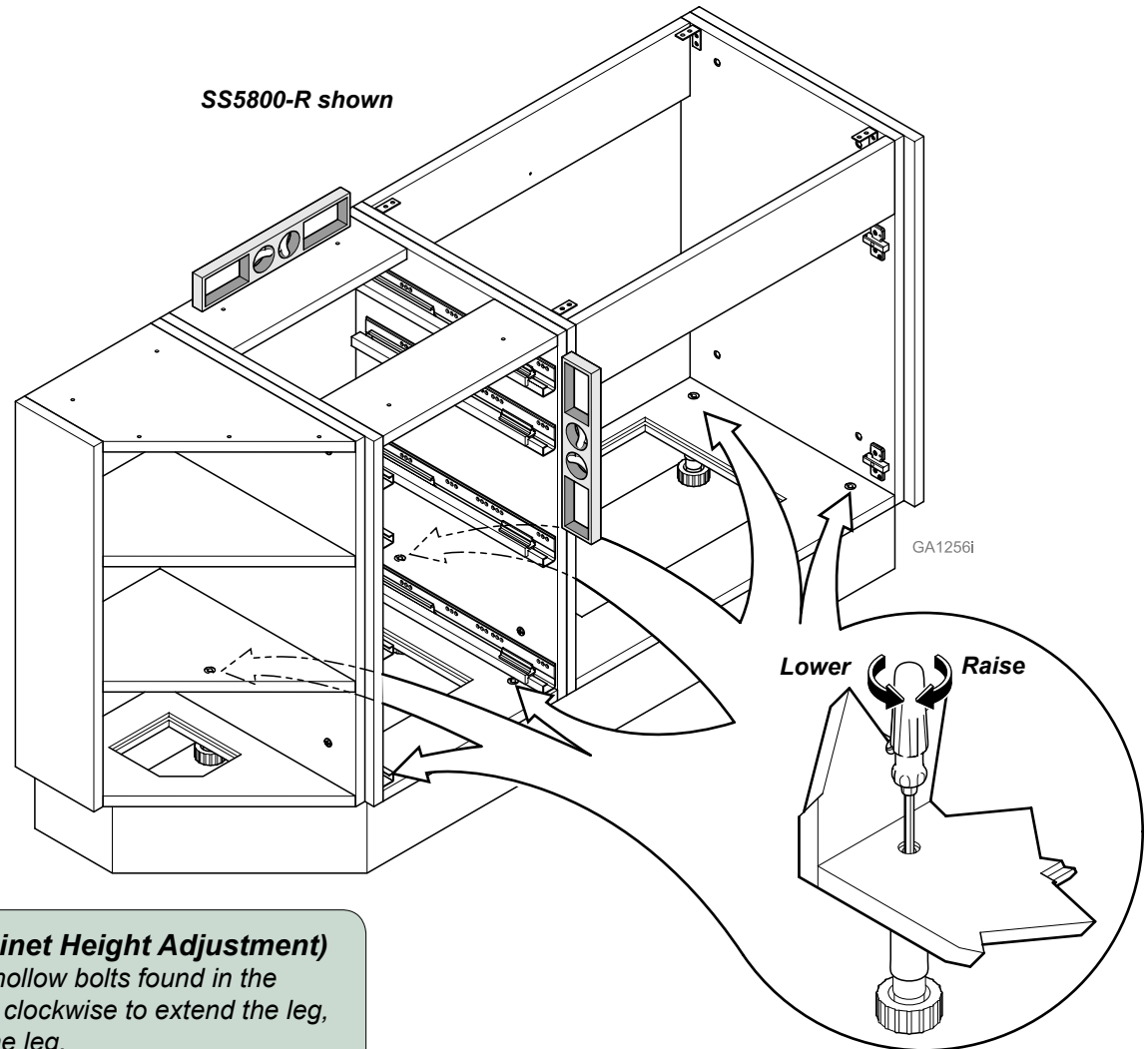

#### Adjustable Camar Leg Leveler (Cabinet Height Adjustment)

- A) Insert a flat head screwdriver into the hollow bolts found in the bottom of a cabinet. Turn screwdriver clockwise to extend the leg, and turn counterclockwise to retract the leg.

## Side Cabinet Installation

### Step 3: Cabinet Assembly Connections (If applicable)

Note: Typically side stations over 72" in length will come in multiple sections and will require cabinet connections.

- If floor is unlevel, install the high side cabinet first using the instructions from **Step 2**
- Un-Package additional side cabinet assembly.
- Remove cabinet doors, drawers, and shelves (see Drawer Removal, Installation, and Adjustment and Door Removal, Installation, and Adjustment in this manual)
- Position the cabinet assembly next to the already mounted side cabinet.
- Using a level as necessary, unscrew the leg levelers using a flathead screwdriver through the hollow leg bolt in the bottom of the cabinet (see Adjustable Camar Leg Leveler) or by hand through the false bottom cutout until cabinet is level.
- Use the lag screws (if floor is made of composites) and base clips that were used to secure the cabinet to the shipping pallet and secure the cabinet to the floor of the building. If the floor is concrete, then utilize the supplied anchors.

Note: To make installation easier and to prevent damage to area surrounding screw hole in the floor, drill pilot holes. Use a 3/8" masonry drill bit for concrete and a 9/32" wood drill bit for composite flooring.

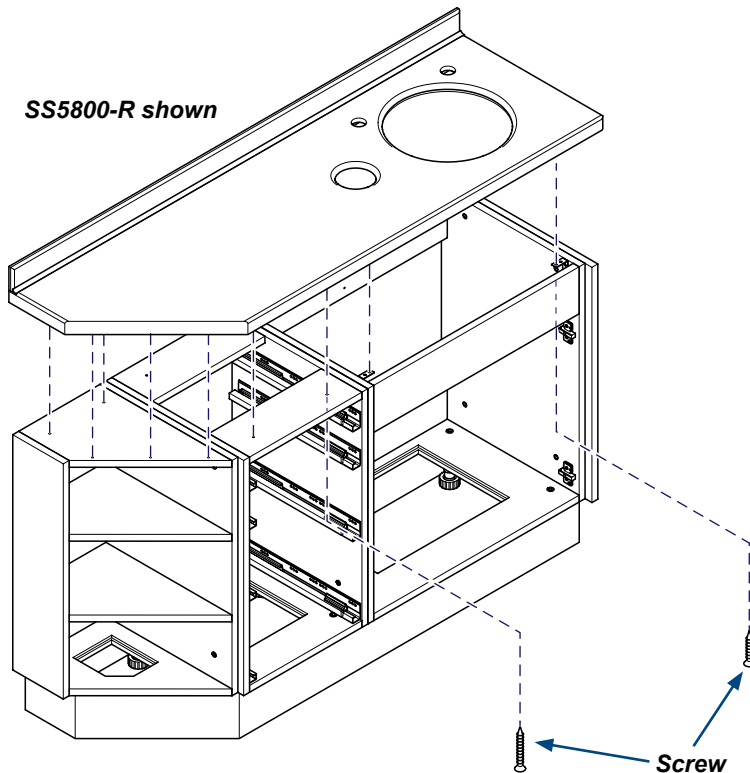
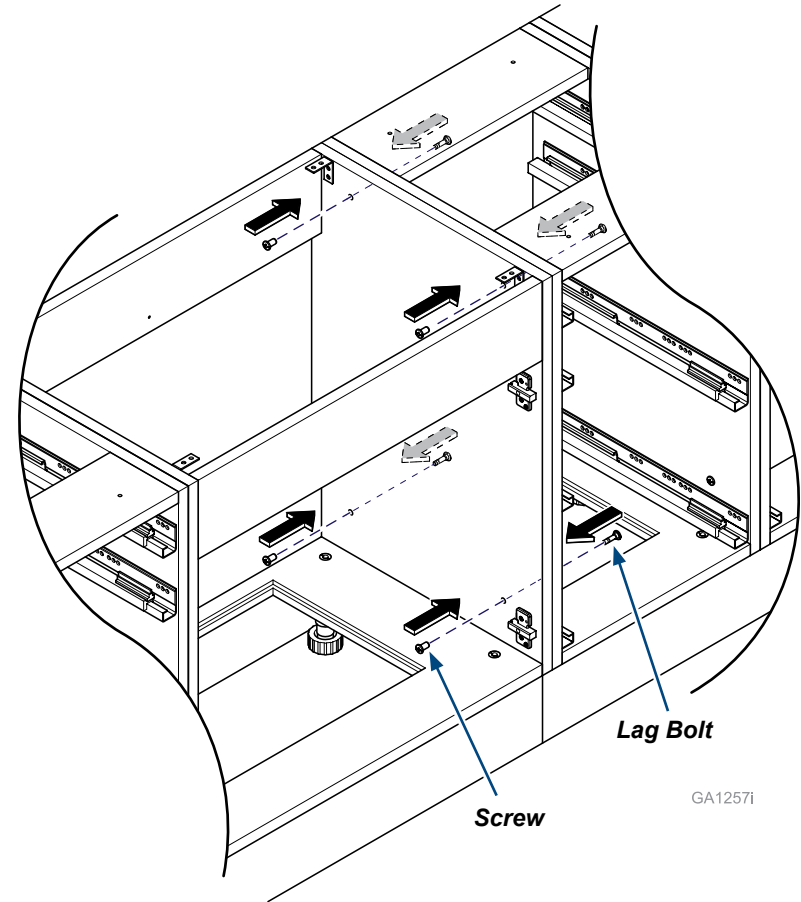

SS5800-R shown

### Step 4: Solid Surface Countertop Installation (if applicable)

- If not already attached to one of the cabinet assemblies, remove countertop from packaging and place on cabinets.
- Adjust the countertop against the wall and overhang the side of the cabinet by a 1/2" if on a finished end.
- In general, use the supplied 1" drywall screws to fasten L-brackets to the countertop and 1-5/8" screws through pre-drilled holes in the tops of all other cabinets.
- If backsplash and / or sidesplashes are included, attach with silicone and clean off any excess.

Note: If countertop has blemishes after installation see Cleaning and Maintenance (Solid Surface) in this manual.



## Side Cabinet Installation

### Step 4: Laminate Countertop Installation (if applicable)

- A) If not already attached to one of the cabinet assemblies, remove countertop from packaging and place on cabinets.
- B) Adjust the countertop against the wall and overhang the side of the cabinet by a 1/2" if on a finished end.
- C) In general, use the supplied 1" drywall screws to fasten L-brackets to the countertop and 1-5/8" screws through pre-drilled holes in the tops of all other cabinets.
- D) If backsplash and / or sidesplashes are included, attach with silicone and clean off any excess.

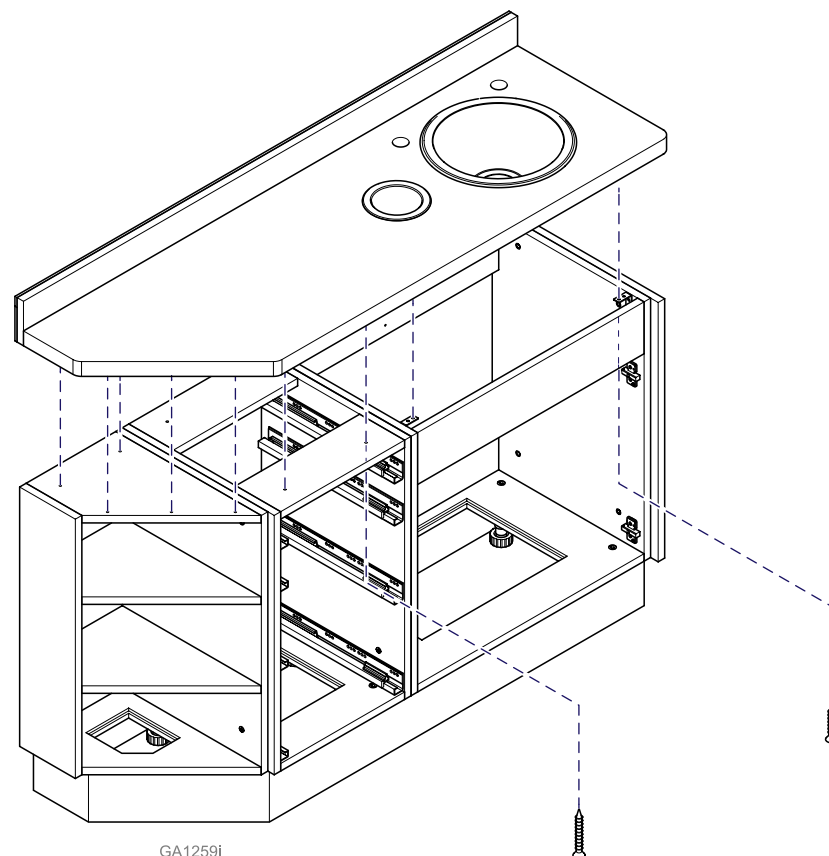
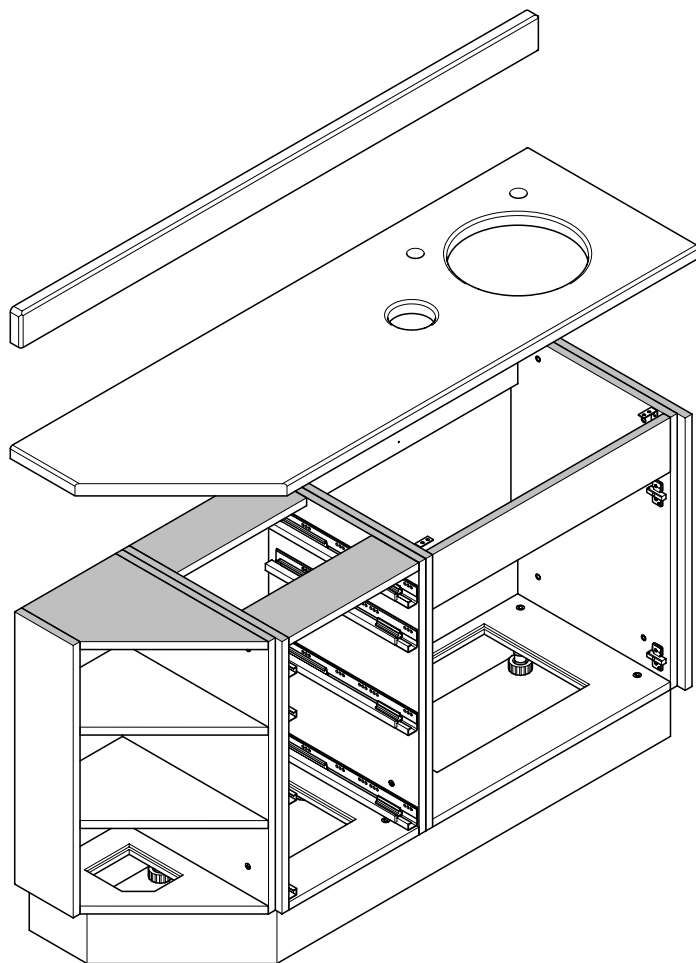

### Step 4: Quartz Countertop Installation (if applicable)

- A) Remove countertop from packaging and move into area for installation.
- B) Apply Silicone or similar adhesive to the top of the cabinets.
- C) Lift and place countertop into position so that the back of the countertop is against the wall with 1/2" overhang on the left/right finished end of the cabinet.
- D) Apply Silicone or similar adhesive to back side of backsplash and back of countertop. Set backsplash into place, centering left to right on the countertop.

GA1260i



## Side Cabinet Installation

### Step 6: Doors Drawers and Shelves

- A) Re-install cabinet drawers (see Drawer Removal, Installation, and Adjustment in this manual) and make adjustments as needed.
- B) Re-install cabinet doors (see Door Removal, Installation, and Adjustment in this manual) and make adjustments as needed.
- C) Install Shelves.

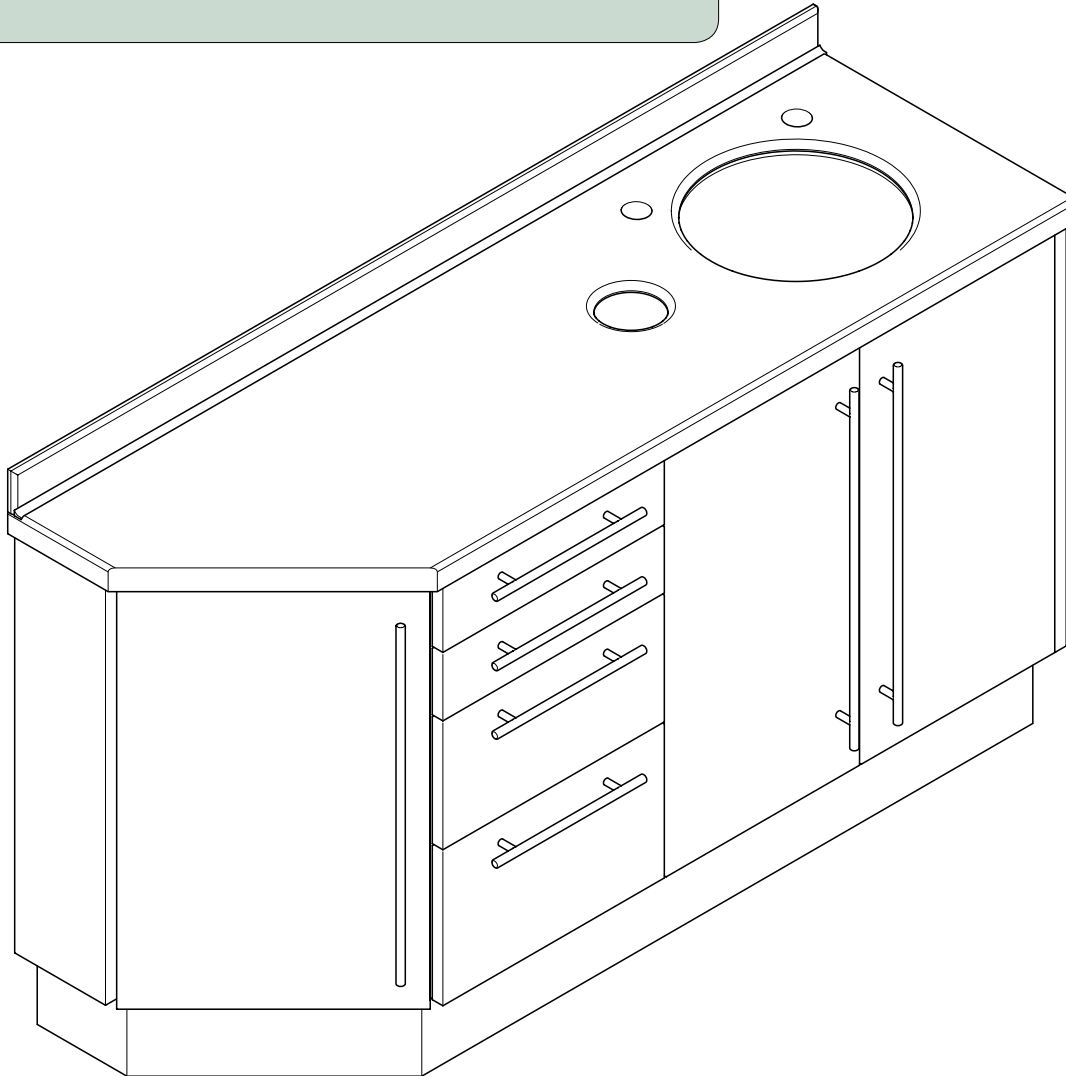

GA1263i

### Shelf Peg Type

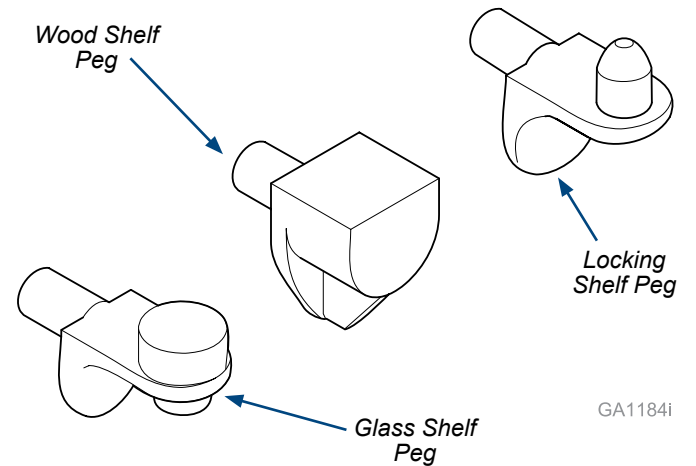

GA1184i

## Electrical Diagrams (Side Stations)



### Equipment Alert

Dedicated branch circuit rated at 120VAC, 50/60 Hz, 20 amp.



### Equipment Alert

Important Notice: This unit must be wired to a GCFI protected circuit.

**Handy Box 027-1681-00**  
(used primarily in Drawer, Shelf or Ultrasonic bases)

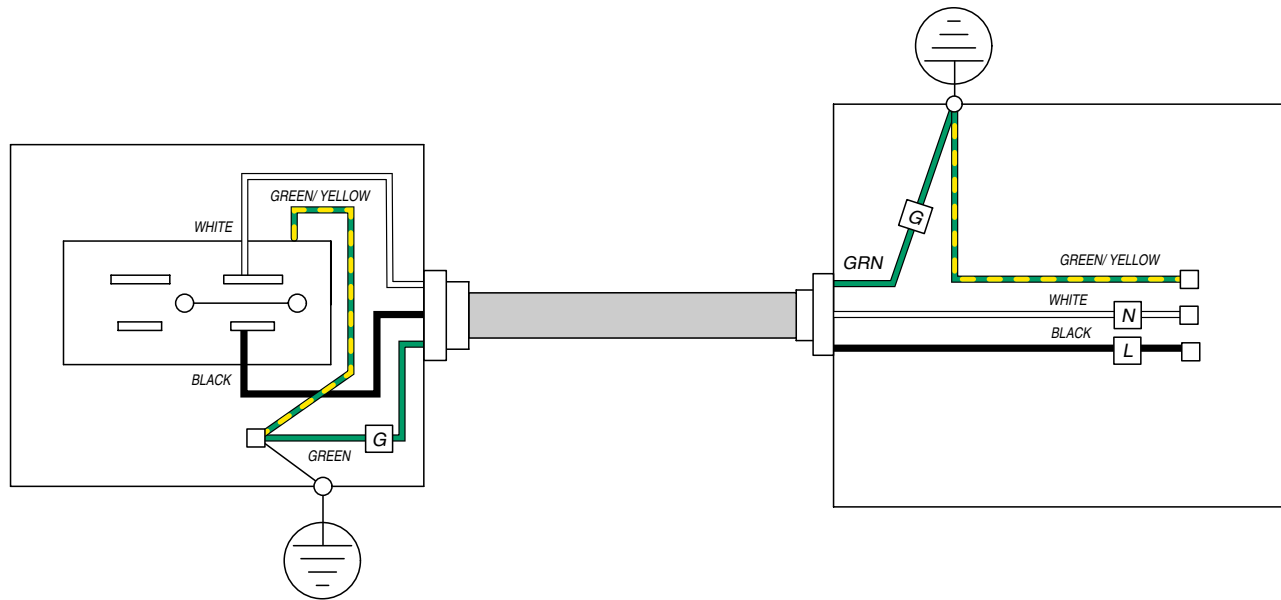

GA1261i

### Note

Only Licensed Electricians following local and applicable electrical codes should install and connect the electrical supply power. Midmark cannot be held responsible for installations that do not conform to local codes.

## Drawer Removal, Installation and Adjustment

### Drawer Removal

- A) Open drawer completely.
- B) Lift up on the drawer front until the front of the box releases from the glide.
- C) Pull out on the drawer slightly.
- D) Lower the drawer back down while pulling out on the drawer.

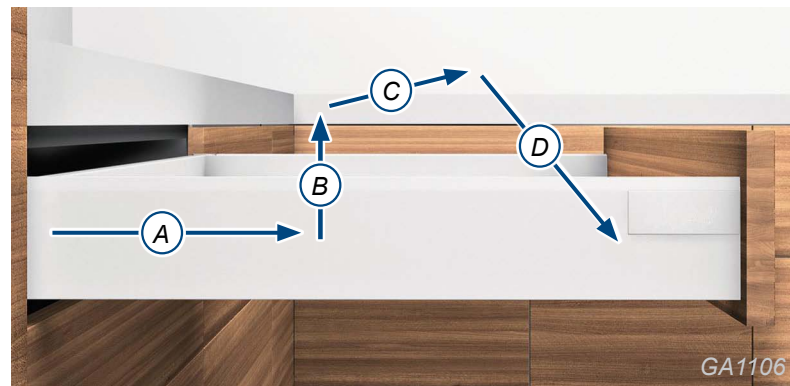

### Drawer Installation

- A) Fully extend drawer glides from the cabinet. (Optional)
- B) Place the drawer on the glides.
- C) Push the drawer in completely.
- D) Cycle drawer a couple times to ensure that the drawer is securely attached to the glides.

### Full Extension Glide Removal & Installation...

#### Removal

- A) Extend the glide to its outermost position. Push the release levers in and remove the drawer member of the sides.

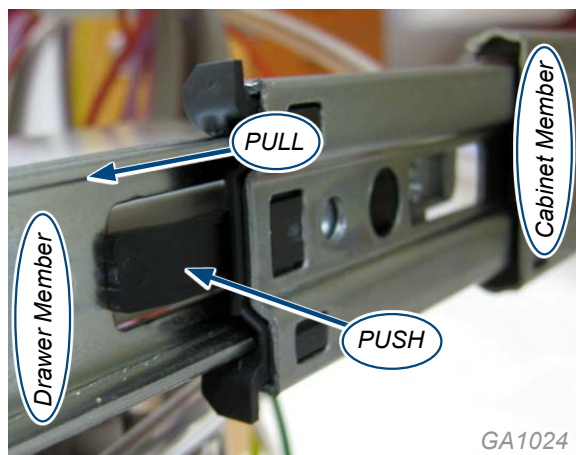

#### Installation

- A) Line up the drawer member to the cabinet member and push the drawer into its compartment.

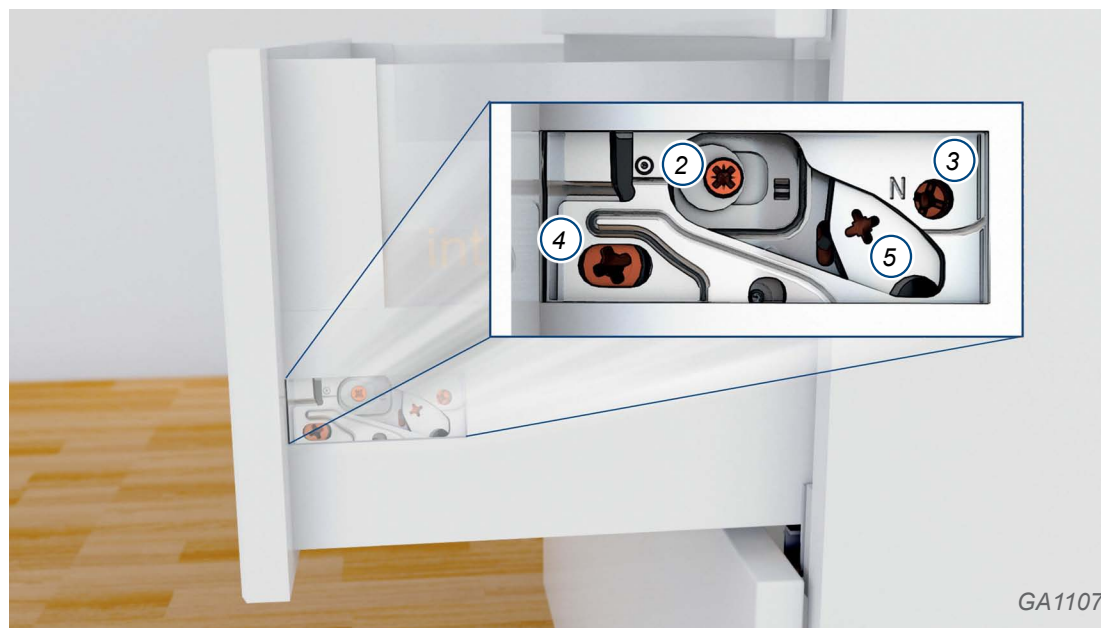

### Drawer Front Adjustment and Removal

- 1) Remove the cover caps on the drawer side by hand.
- 2) Height Adjustment: Rotate in either direction to adjust the drawer front vertically.
- 3) Tilt Adjustment: Adjust after the drawer front is installed to ensure the drawer sides meet square with the drawer front. (Only available on large drawer boxes.)
- 4) Side Adjustment: Adjusts the drawer front horizontally. Turn in either direction.
- 5) Tension/Removal: For large drawers, turn the screw toward the front of the drawer until the front detaches from the box. Repeat this procedure on both sides of the drawer. For small and medium drawer boxes, turn the screw toward the back of the drawer to remove the front.

## Door Removal, Installation, and Adjustment

### Hinge 1 & 2 Adjustments

Use a phillips head screw driver for the following steps...

- A) Screw A adjusts the door in direction A seen in the Adjustment Direction Guide
- B) Screw B adjusts the door in direction B. Equal adjustment must be made to all hinges on the door for it to move the desired distance.
- C) Screw C adjusts the door in the C direction. Make adjustments to top and bottom hinge as necessary.

Note: Use a level to ensure the door is level and plumb. Preferred gaps are approximately 1/8" between doors and 1/16" between accents and doors.

### Hinge 1 & 2 Removal

- E) Press button at point E at the back of the hinge and pull away from cabinet.

### Hinge 1, 2, & 3 Installation

- F) Hook the hinge to the mounting block at point F
- G) Latch at point G by pressing the hinge against the hinge block.

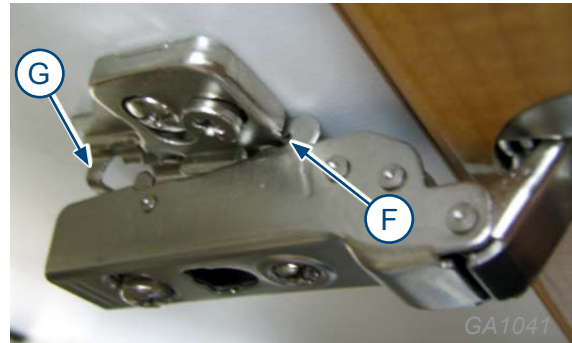

### 180° Hinge Adjustments

- D) Loosen screw D and adjust door gap and angle using a level. Tighten screw D when positioned correctly,

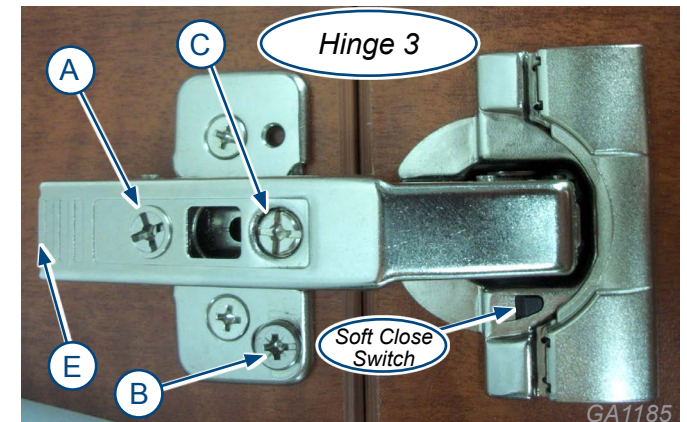
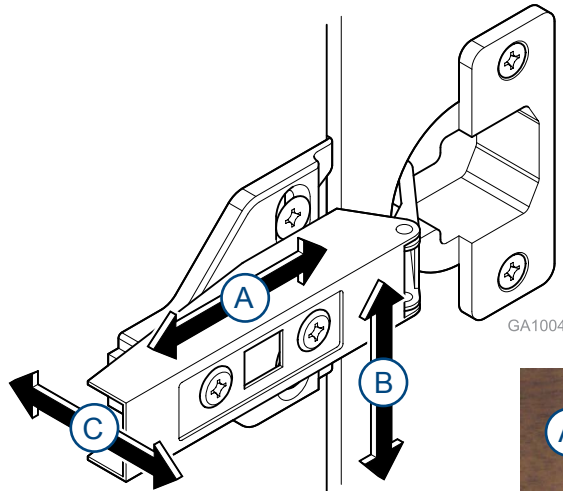
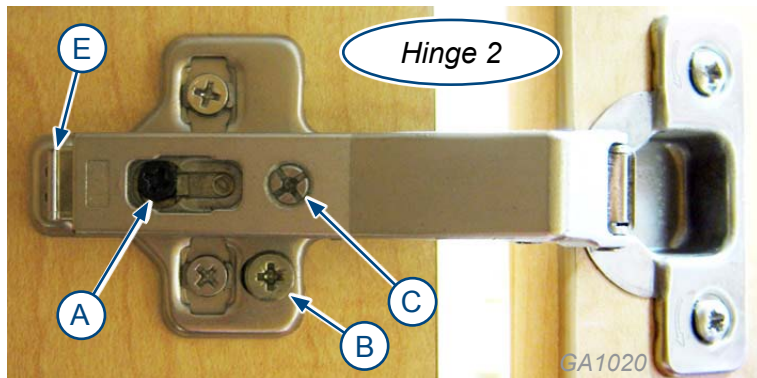
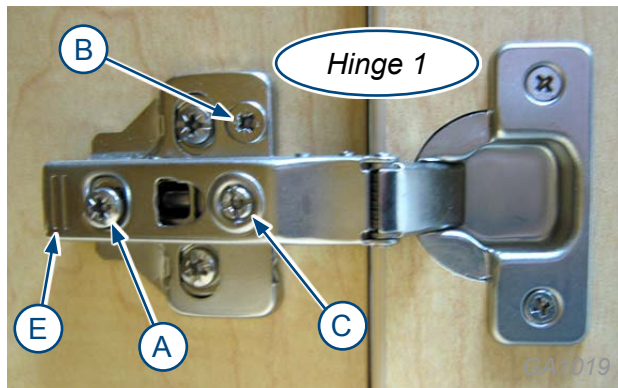
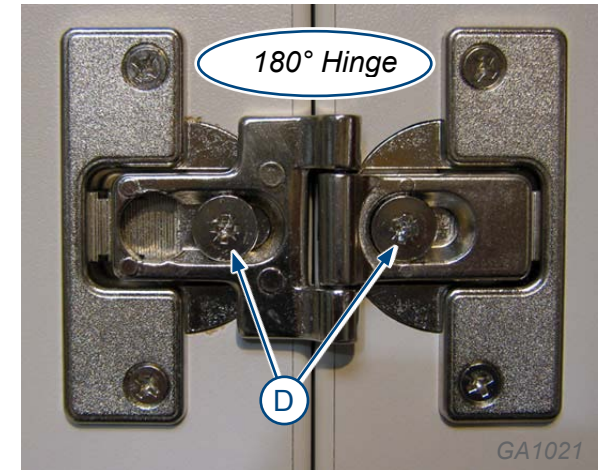



## Disinfecting Procedures for External Surfaces

### Attention!

Midmark assumes no responsibility or liability for any result, expressed or implied. These are suggested practices, based on the best information available at this time.



### Equipment Alert

- Users should not use cleaning or decontamination methods different from those recommended by the manufacturer without first checking with the manufacturer that the proposed methods will not damage the equipment.
- Midmark's dental equipment is manufactured from the most chemical-resistant materials available. However, no material is impervious to every chemical. Using protective barriers is the most effective method to prevent equipment damage.
- Use only moist cloth with appropriate cleaner for cleaning casework.

## Cleaning and Disinfectant Procedures

Use cleaners and disinfectants that are appropriate for the situation such as warm water and mild detergents, or an ammonia based cleaner.

**NOTE:** Every dental practice is different, and no single disinfectant is the best choice for every facility. Listed below are some organizations to assist you in choosing the best disinfectants available for your practice.

- Organization for Safety & Asepsis Procedures: <http://www.osap.org>
- American Dental Association: <http://www.ada.org>
- Dept. of Health & Human Resources Centers for Disease Control & Prevention (CDC): <http://www.cdc.gov>

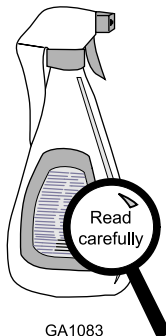

GA1083

### When using disinfectants...

Carefully read the product label and directions for use.  
Do not exceed the dilution rate.

**Read all labels carefully!**

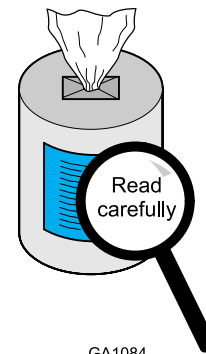

GA1084

## ***Cleaning and Maintenance (Solid Surface)***



*Caring for your Solid Surface countertop is as simple as wiping the surface with a damp cloth. If a stain develops, wipe it away with soap and water. Or if you prefer wipe it clean with ammonia based cleaner.*

*If a stain doesn't respond to soap and water, for a matte finish, apply an abrasive cleanser and buff with a Scotch-Brite™ pad using a circular motion. The same technique can be used for burns. **If you have a gloss finish, please contact your dealer or fabricator before attempting repairs.***

*For minor cuts and scratches, simply sand lightly with a medium (220 grit) sandpaper, then follow with a fine (320 grit) sandpaper. Finally, touch up the finish by buffing with a Scotch-Brite™ pad.*



### **Caution**

*Do not expose the surface to harsh chemicals, such as paint remover, turpentine, nail polish remover or stove and drain cleaners. If these chemicals come in contact with the surface, immediately wash them off with water, using appropriate safety measures to avoid injury.*



Because we care.