

Preferred Lift Exam Table

PRODUCT GUIDE

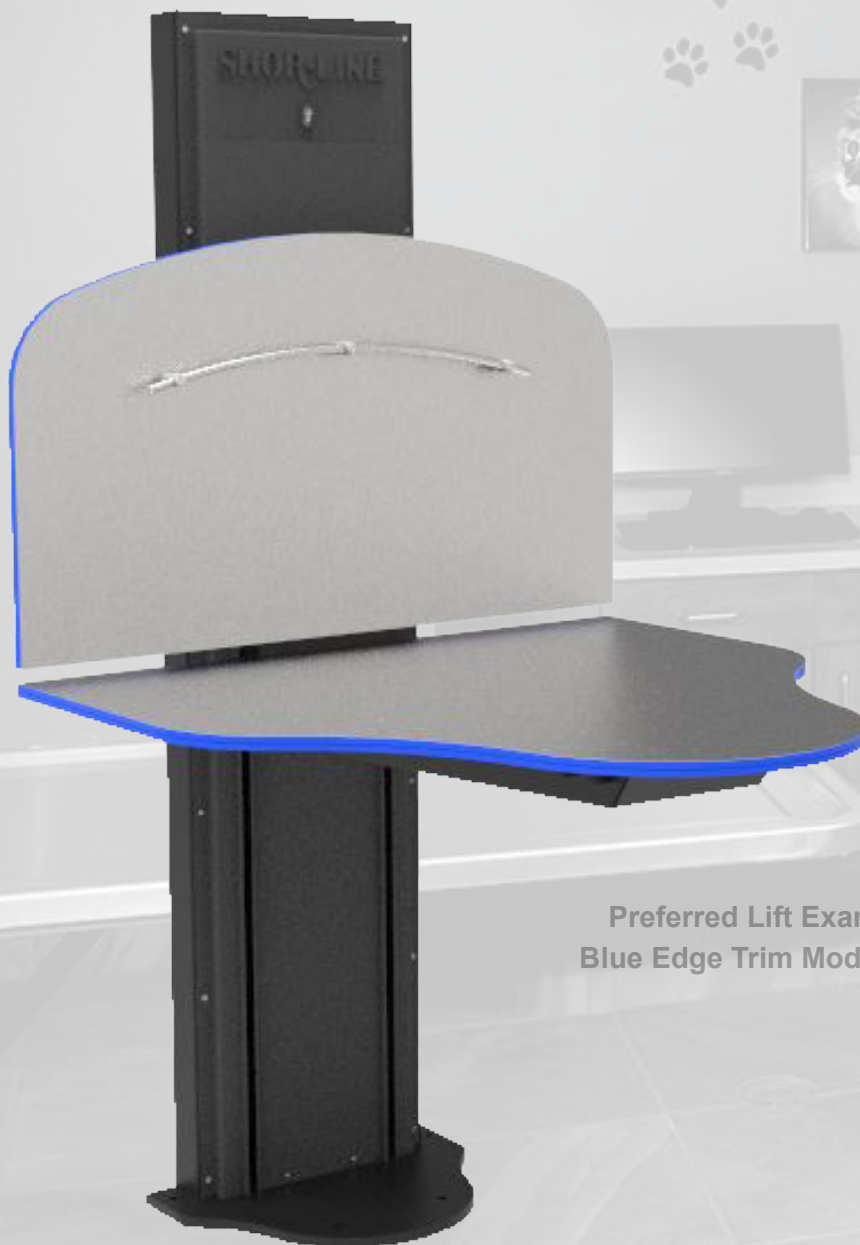

Preferred Lift Exam Table
Blue Edge Trim Model Shown

Introduction

Thank you for purchasing Shor-Line products. As a leader in animal care equipment, our commitment to provide quality products and personable customer service is the same as it was in 1927.

This Guide provides information regarding the installation, use, and care of your Shor-Line product. Keep this Guide in a safe and convenient place for reference.

For further questions, to purchase additional products, or to replace a lost or damaged Guide, please feel free to contact Shor-Line:

SHOR-LINE

Schroer Manufacturing Company
511 Osage Ave.

Kansas City, Kansas 66105, USA

PHONE: 800.444.1579

LOCAL: 913.281.1500

FAX: 913.281.5339

EMAIL: guides@shor-line.com

WEB ADDRESS: shor-line.com

SHOR-LINE LIMITED

Vale Business Park Llandow,

Vale of Glamorgan CF71 7PF

United Kingdom

PHONE: +44 1446 77 20 41

FAX: +44 1446 77 36 68

EMAIL: quality@shor-line.co.uk

WEB ADDRESS: shor-line.co.uk

Shor-Line may provide instructions that supplement or supersede this Guide at any time. Contact Shor-Line to ensure the Guide is the latest version.

During installation, if a contradiction between this Guide, existing conditions, or local regulations arise, contact a Shor-Line representative before proceeding with installation.

The Preferred Lift Exam Table also referred to as the "Lift Table" and "Table" in this document.

Visit Shor-line.com for a full list of TERMS AND CONDITIONS.

© Copyright 2020 Schroer Manufacturing Company. All rights reserved.



DANGER

READ THIS GUIDE COMPLETELY BEFORE INSTALLATION AND USE AND THOROUGHLY UNDERSTAND AND FOLLOW ALL SAFETY INSTRUCTIONS.



WARNING

WEAR PERSONAL PROTECTIVE EQUIPMENT, such as, but not limited to, eye protection, back support brace, and gloves during installation. Failure to do so could result in SERIOUS INJURY.



CAUTION

This product is intended to be used for animals only. Do not use for anything other than the intended purpose.

INTRODUCTION

Introduction	ii
--------------------	----

GENERAL INFORMATION

General information.....	1
Safety Alert Symbol	1
Personal Protective Equipment (PPE).....	1
Safety Warnings Included In This Guide	2
Safety Decal Locations.....	3
Shipment Inventory And Inspection.....	4
Shipment Inventory.....	4
Shipment Inspection	4
Damage Reporting	4
Preferred Lift Exam Table	4
Component Parts List.....	5

SECTION TWO, ASSEMBLY PROCEDURES

Installation	6
Lift Table Set-up.....	6
Locate Unit.....	7
Table Frame Installation	8
Base Plate Anchor Requirements.....	8
Table Lift Control Switch	9
Lift Frame Base Plate	9
Table Panel Assembly.....	10
Leash Safety Ties	12

SECTION THREE, USE AND CARE

Use And Care.....	13
Lift Table Safe Use Practices.....	13
Electric Lift Function	13
General Maintenance & Care.....	14
Maintenance Recommendations	14
Care Recommendations	14

SECTION FOUR, TERMS & CONDITIONS

Terms And Conditions	15
Damaged Freight Procedures	15
Limited Warranty	16
Contact Information.....	17

General information

Refer to the Guide, images and content to assist with the installation of the product. Throughout the Guide, safety notices provide help for a successful installation.

SAFETY FIRST!

Shor-Line uses the following symbols and signal words to identify potential hazards or unsafe practices:

Safety Alert Symbol



Indicates a potential personal injury hazard exists. It is important to heed any safety warning information associated with this alert symbol.

Signal Words for Hazard Alerting Safety Messages



Indicates a hazardous situation which, if not avoided, WILL result in serious injury or death.



Indicates a hazardous situation which, if not avoided, COULD result in serious injury or death.



Indicates a hazardous situation which, if not avoided, COULD result in minor or moderate injury.

Important Information Symbol



Indicates information considered important but not directly hazard related.

Personal Protective Equipment (PPE)

PPE refers to protective clothing or other equipment designed to protect against injury. It is the responsibility of the client/installer to ensure all local and federal codes are adhered to during the installation and assembly of this product. Included is a list of PPE items suggested, but not limited to, protective equipment to help complete the installation safely.

- Back Support Brace
- Gloves
- Metatarsal, foot protection

Shor-Line makes no guarantee, implied or otherwise, that the information included in this Guide will be complete or failsafe, or that the information will prevent an injury from occurring. Standard measures described may not reflect the full extent of all steps that may need to be taken in any given emergency instance.

California Proposition 65 Warning



This product can expose you to chemicals including chromium, which are known to the state of California to cause cancer. For more information go to: www.P65Warnings.ca.gov

Safety Warnings Included In This Guide



Do NOT operate the equipment until the installation is complete and ready for use. Ensure the power wire is free of kinks and not bound/pinched. Electrical shock hazard. Failure to do so will result in **SERIOUS INJURY or **DEATH**.**

Installation and repair of the unit MUST BE PERFORMED BY A QUALIFIED ELECTRICIAN. Contact with electrical/live circuit wiring can cause electrical shock or fire, which, if not avoided, will result in **SERIOUS INJURY OR **DEATH**.**

Power Supply and Circuity for end use components requires electrical isolation. PRIOR TO AND DURING INSTALLATION AND MAINTENANCE, ALWAYS PROVIDE two protective measures in accordance with EN60601-1. Contact with electrical/live circuit wiring can cause electrical shock or fire, which, if not avoided, will result in **SERIOUS INJURY OR **DEATH**.**

PRIOR TO AND DURING INSTALLATION AND MAINTENANCE, ALWAYS ISOLATE AND DISCONNECT all three poles. Contact with electrical/live circuit wiring can cause electrical shock or fire, which, if not avoided, will result in **SERIOUS INJURY OR **DEATH**.**



WEAR PERSONAL PROTECTIVE EQUIPMENT (PPE), such as, but not limited to, eye protection, protective gloves and Metatarsal/foot protection during installation. Failure to do so could result in **SERIOUS INJURY or **DEATH**.**

Enlist help and USE SAFE LIFTING PRACTICES during assembly, installation and moving equipment. Failure to do so could result in **SERIOUS INJURY or **DEATH**.**

Do NOT operate the lift table before checking to ensure the unit and surrounding area is clear of personnel, animals and obstructions. Failure to do so could result in **SERIOUS INJURY or **DEATH**.**

The lift table is not designed to free-stand. Do NOT leave the table unattended until the installation is complete. Always maintain control of the table during the installation/assembly procedures. Tipping Hazard. Failure to follow these safeguards could result in **SERIOUS INJURY or **DEATH**.**

Do NOT use the table lift to access the lift frame top brace connections. Tipping Hazard. Failure to follow these safeguards could result in **SERIOUS INJURY or **DEATH**.**

Never leave an animal tethered to the lift table unattended. Always maintain full control of animals when on the exam table.

Stow the foot operated pedal and FOB hand held lift control switches in a safe place to avoid unintentional activation (table movement).

The table should never be operated remotely without an operator at the table to ensure the area is clear of obstruction, personnel and animals. Do NOT operate the table remotely with the table unattended. Failure to do so could result in **SERIOUS INJURY or **DEATH**.**



This product is intended to be used for animals only. Do not use for anything other than the intended purpose.

Keep hands clear of possible pinch areas during installation, which if not avoided, could result in **MINOR to **MODERATE INJURY**.**

Do NOT exceed the weight limitations (225 lbs) of the table. Exceeding the weight limit may cause equipment failure.

Stainless steel panels have sharp edges, stay clear of and DO NOT TOUCH exposed edges which, if not avoided, could result in **MINOR to **MODERATE INJURY**.**

SAFETY

Safety Decal Locations

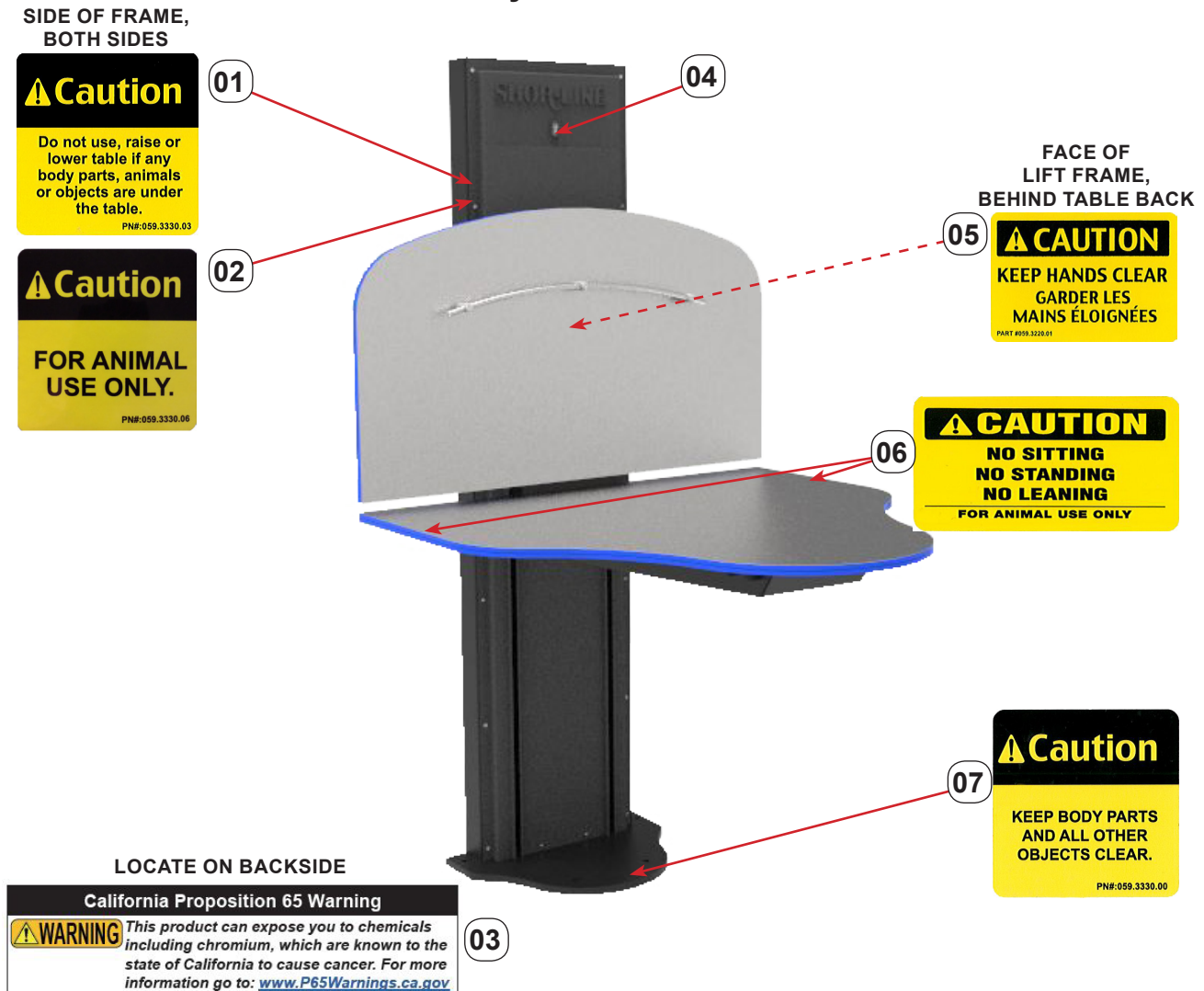

Safety Decals Location

Safety Decal List			
Item	Part #	Description	Qty
01	059.3330.03	SAFETY DECAL, Caution - Do Not Use	2
02	059.3330.06	SAFETY DECAL, Caution - Animal Use Only	2
03		SAFETY DECAL, Warning - Proposition 65	1
04	059.3400.00	DECAL Lift Switch Directional Label	1
05	059.3220.01	SAFETY DECAL, Caution - Keep Hands Clear (Eng/Sp)	1
06	059.4120.00	SAFETY DECAL, Caution - No Sitting/Animal Use Only	2
07	059.3330.00	SAFETY DECAL, Caution - Keep Objects Clear	1

Read all warning, danger and caution decals before equipment is operated. Never use equipment if decals are missing, hidden, improperly placed, damaged or altered. Keep safety decals clean and legible.

Contact Shor-Line (800.444.1579) for replacement safety decals.

Shipment Inventory And Inspection

Shipment Inventory

Upon arrival, unpack and inspect the shipment to ensure it is complete and free of any damages that may have occurred during shipping. Compare the packing list with the shipment to ensure all parts/ components have been received.

NOTICE *This Guide can be used to identify parts and their associated part numbers listed on the packing slip.*

Shipment Inspection

While verifying the shipment contents, take a moment to inspect each component for damage. This should be done before the shipment is signed received and accepted.

If damaged components are apparent, follow the instructions within Shor-Line's Damage and Freight Procedures.

Damage Reporting

Follow the instructions within Shor-Line's Damage and Freight Procedures.

Contact Shor-Line (800.444.1579) immediately to expedite replacements or repairs.

NOTICE *After fifteen (15) calendar days of receipt of merchandise, this policy becomes void.*

Preferred Lift Exam Table

The Preferred Lift Exam Table and components are packed and shipped on a single pallet. Carefully remove packing material and inspect each component for damage.

Product Specifications	
• Fully Assembled Product Weight	327 lbs
• Product Overall Length (L) x Width (W) x Height (H)	48"L x 44"W x 75"H
• Lift Actuator Power Requirements	120-240vAC 60/50hz, 3A@100v
• Lift Range (From 7.75" above floor to 36" above floor)	28.25" Rise
• Maximum Weight Allowance	225 lbs
• Foot Operated Lift Control - Charger	120-240vAC 60/50hz, 18vDC .4a Output
• FOB Lift Control Hand Held Remote	12vDC 23amp Battery

⚠ DANGER *Do NOT operate the equipment until the installation is complete and ready for use. Ensure the power wire is free of kinks and not bound/pinched. Electrical shock hazard. Failure to do so will result in SERIOUS INJURY or DEATH.*

⚠ WARNING *Enlist help and USE SAFE LIFTING PRACTICES during assembly, installation and moving equipment.*

The lift table is not designed to free-stand. Do NOT leave the table unattended until the installation is complete. Always maintain control of the table during the installation/ assembly procedures. Tipping Hazard. Failure to follow these safeguards could result in SERIOUS INJURY or DEATH.

⚠ CAUTION *Keep hands clear of possible pinch areas during installation, which if not avoided, could result in MINOR to MODERATE INJURY.*

SECTION ONE

Component Parts List

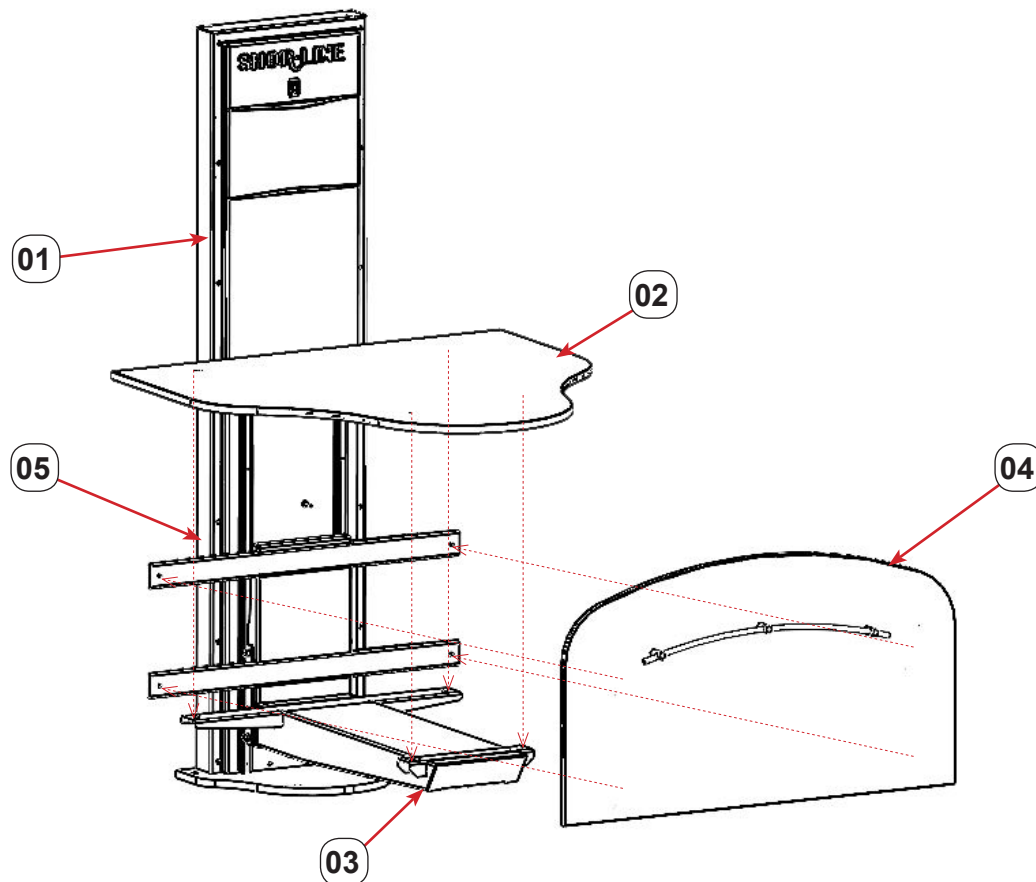

FIGURE 1.1 - Preferred Lift Exam Table

Item	Part #	Description
	903.3400.00	Preferred Lift Exam Table-Black Trim
	903.3400.01	Preferred Lift Exam Table-Blue Trim
01		Lift Table Frame
02	313.3400.02	Table Top-Blue Edge Trim
	313.3400.03	Table Top-Black Edge Trim (Not Shown)
HDWR	• 062.2505.01	• 1/4"-20x1/2" Long Truss Head Phillips
HDWR	• 065.2500.00	• 1/4" Flat Washer
03		Table Top Lift Frame (Lift Arms)
04	313.3400.00	Table Back Panel-Blue Edge Trim
	313.3400.01	Table Back Panel-Black Edge Trim (Not Shown)
HDWR	• 062.2505.01	• 1/4"-20x1/2" Long Truss Head Phillips
HDWR	• 065.2500.00	• 1/4" Flat Washer
05		Table Back Panel Lift Frame
		FOB Lift Control Hand held Remote (2ea), Not shown
		Foot Operated Lift Control - Wireless Pedal Switch and Charger Not shown

Installation

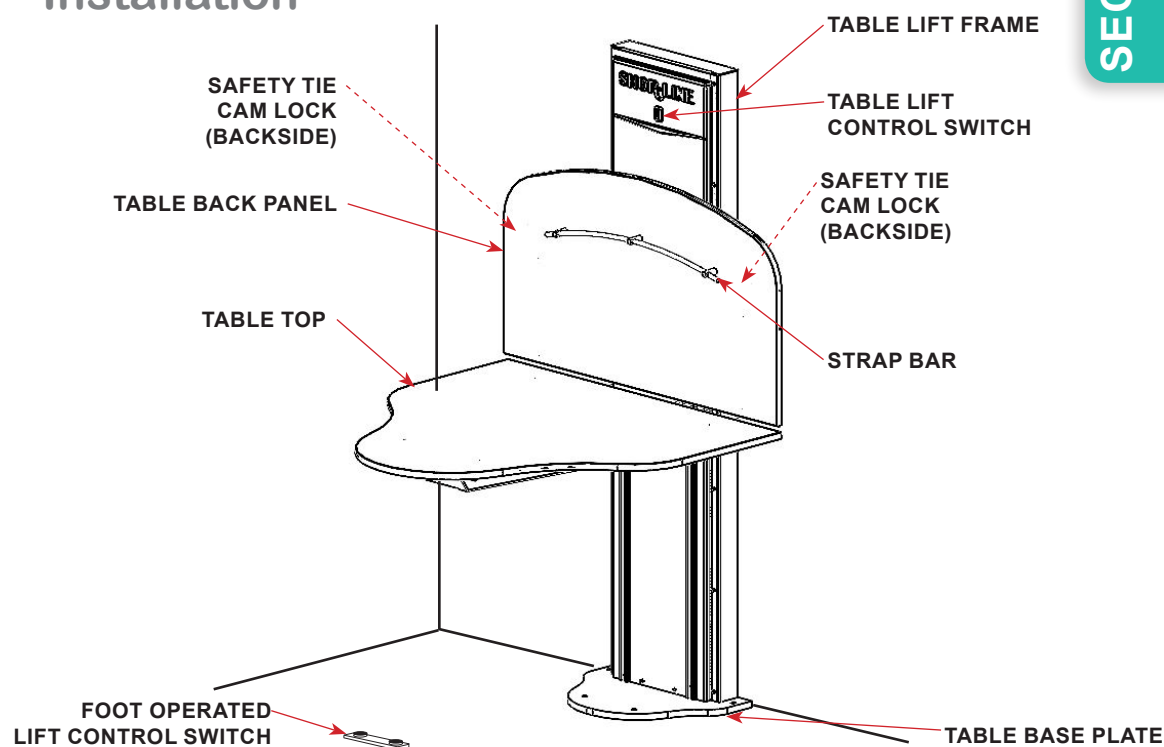

FIGURE 2.0 - Preferred Lift Exam Table

Lift Table Set-up

An isolation circuit disconnect is required for direct connection configurations in accordance with IEC ES60601-1. The lift table is to be direct wired (hardwire); installation of power service must be completed by a certified electrician.

Installation techniques may vary depending on the building construction and desired location. The installer is responsible to provide any alternative electrical and mounting hardware required for code compliant installation.

The unit control box is off-center, 72" above the finished floor. Ensure the power run provided, wall penetration location and proposed base anchors are align before setting anchors or conducting demolition (existing facility installation).

Do NOT use extension cords to provide power for the table.

Unit installation must be performed by a qualified electrician. Power Supply and Circuitry for end use components requires electrical isolation. Prior to installation and conducting maintenance procedures, always provide two protective measures in accordance with EN60601-1.

During installation and maintenance, always isolate and disconnect all three circuit poles.



DANGER *Power Supply and Circuitry for end use components requires electrical isolation. PRIOR TO AND DURING INSTALLATION AND MAINTENANCE, ALWAYS PROVIDE two protective measures in accordance with EN60601-1. Contact with electrical/live circuit wiring can cause electrical shock or fire, which, if not avoided, will result in SERIOUS INJURY OR DEATH.*

PRIOR TO AND DURING INSTALLATION AND MAINTENANCE, ALWAYS ISOLATE AND DISCONNECT all three poles. Contact with electrical/live circuit wiring can cause electrical shock or fire, which, if not avoided, will result in SERIOUS INJURY OR DEATH.

SECTION TWO

Locate Unit



DANGER

Do NOT operate the equipment until the installation is complete and ready for use. Ensure the power wire is free of kinks and not bound/pinched. Electrical shock hazard. Failure to do so will result in *SERIOUS INJURY* or *DEATH*.

Installation and repair of the unit *MUST BE PERFORMED BY A QUALIFIED ELECTRICIAN*. Contact with electrical/live circuit wiring can cause electrical shock or fire, which, if not avoided, will result in *SERIOUS INJURY OR DEATH*.

Power Supply and Circuitry for end use components requires electrical isolation. *PRIOR TO AND DURING INSTALLATION AND MAINTENANCE, ALWAYS PROVIDE two protective measures in accordance with EN60601-1*. Contact with electrical/live circuit wiring can cause electrical shock or fire, which, if not avoided, will result in *SERIOUS INJURY OR DEATH*.

***PRIOR TO AND DURING INSTALLATION AND MAINTENANCE, ALWAYS ISOLATE AND DISCONNECT all three poles*. Contact with electrical/live circuit wiring can cause electrical shock or fire, which, if not avoided, will result in *SERIOUS INJURY OR DEATH*.**



WARNING

Enlist help and *USE SAFE LIFTING PRACTICES* during assembly, installation and moving equipment.



CAUTION

Keep hands clear of possible pinch areas during installation, which if not avoided, could result in *MINOR* to *MODERATE INJURY*.

Stainless steel panels have sharp edges, stay clear of and *DO NOT TOUCH* exposed edges which, if not avoided, could result in *MINOR* to *MODERATE INJURY*.

NOTICE

Do NOT lift or move the table by the platform or back panel. Always move the table by the base frame using enough personnel and safe lifting procedures.

STEP 1: Remove the table frame, panels and parts from the shipping material and locate near its preferred destination.



WARNING

The lift table is not designed to free-stand. Do NOT leave the table unattended until the installation is complete. Always maintain control of the table during the installation/assembly procedures. Tipping Hazard. Failure to follow these safeguards could result in *SERIOUS INJURY* or *DEATH*.

STEP 2: Remove the FOBs (remote control, 2 each) and foot operated pedal from its shipping material, set aside, away from the installation area.

NOTICE

Prevent unintentional activation of the lift table during the installation process. Store controllers in a safe place.

STEP 3: Route the power cable to the control box.
See FIGURE 2.1

STEP 4: Secure the Live, Neutral and Ground leads per the component labeling. Ensure the cable is free of binding and kinks.

NOTICE

Use the disconnect switch for the isolation circuit to toggle the power on/off when directed in the instructions.

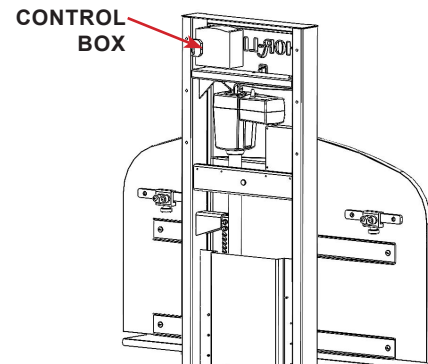

FIGURE 2.1 - Control Box

Table Frame Installation

Base Plate Anchor Requirements

The table base **MUST** be anchored to the floor using all four anchor hole locations provided. Anchor hardware is **NOT** provided.

Due to varying site (facility) specific floor construction types and existing conditions of finishes, it is recommended to consult a contractor for anchor type and size to use to secure the lift table frame to the floor.

Do **NOT** locate or anchor the lift table on a floor surface covered in carpet or mat material. Tip Hazard.

If the site specific construction type calls for threaded stud anchor hardware installation, follow the anchor hole layout. See FIGURE 2.2

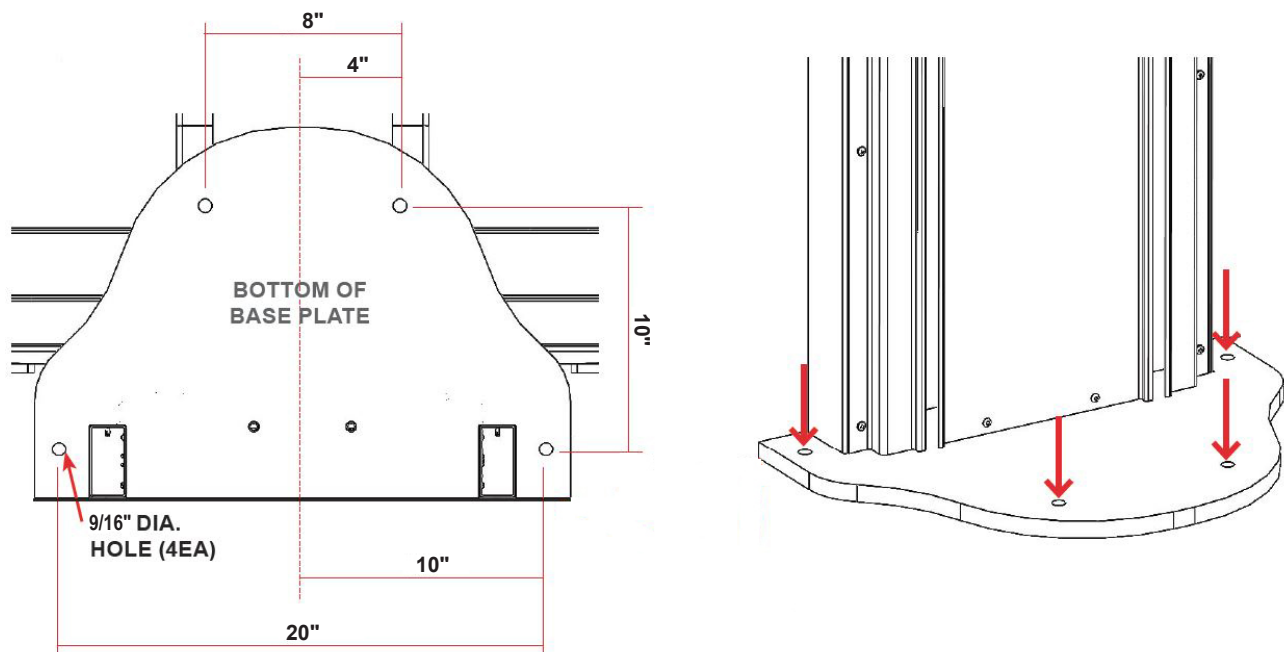

FIGURE 2.2 - Base Plate, Lift Frame Installation



WARNING Enlist help and **USE SAFE LIFTING PRACTICES** during assembly, installation and moving equipment.

*The lift table is not designed to free-stand. Do NOT leave the table unattended until the installation is complete. Always maintain control of the table during the installation/assembly procedures. Tipping Hazard. Failure to follow these safeguards could result in **SERIOUS INJURY** or **DEATH**.*



CAUTION Keep hands clear of possible pinch areas during installation, which if not avoided, could result in **MINOR** to **MODERATE INJURY**.

*Stainless steel panels have sharp edges, stay clear of and **DO NOT TOUCH** exposed edges which, if not avoided, could result in **MINOR** to **MODERATE INJURY**.*

SECTION TWO

Table Lift Control Switch

WARNING Do NOT operate the lift table before checking to ensure the unit and surrounding area is clear of personnel, animals and obstructions. Failure to do so could result in **SERIOUS INJURY** or **DEATH**.

NOTICE Use the disconnect switch for the isolation circuit to toggle the power on/off when directed in the instructions.

Use the lift control switch to adjust the arms height to aid during installation procedures.

The lift control switch toggles up or down to move the table up/down respectively. With no activation the switch rests in a neutral state, table still. See FIGURE 2.3

Raise the lift arms just high enough to be able to access the base plate front anchor holes for installation.

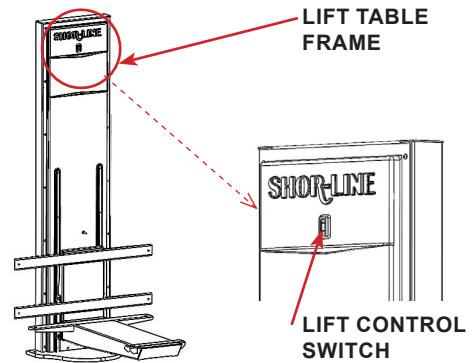

FIGURE 2.3 - Lift Control Switch

Lift Frame Base Plate

Installation of the lift table must be performed by a qualified contractor.

There are several hardware options that can be recommended to anchor the lift frame to the floor. Typically, depending upon site conditions; either threaded studs set in concrete or threaded bolts will be recommended by a contractor.

A contractor shall secure the lift table frame to the facility floor. Follow the manufactures recommendation for procedures for proposed hardware per site conditions.

NOTICE Do NOT lift or move the frame by the platform or its framing. Always move the table frame by the base and support the unit using enough personnel and safe lifting procedures.

WARNING The lift table is not designed to free-stand. Do NOT leave the table unattended until the installation is complete. Always maintain control of the table during the installation/assembly procedures. Tipping Hazard. Failure to follow these safeguards could result in **SERIOUS INJURY** or **DEATH**.

STEP 1: Carefully lift and align the table frame into position.

STEP 2: Level the base plate left to right and front to back, shim as required. See FIGURE 2.4

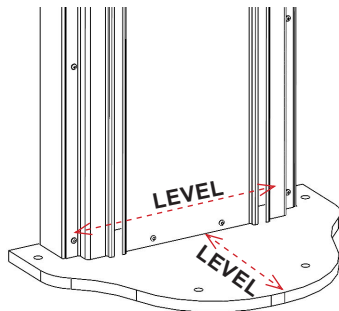

FIGURE 2.4 - Level Base Plate

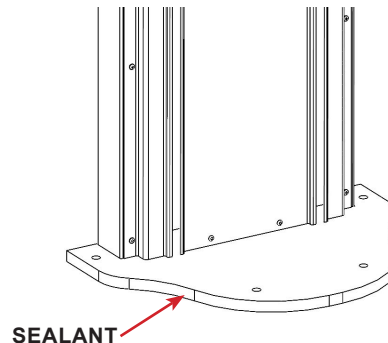

FIGURE 2.5 - Seal Base Plate

STEP 3: Secure using hardware proposed for the specific site conditions, construction type.

STEP 4: Seal around the base plate as required. For a site specific recommendation, consult with the contractor for application requirements. See FIGURE 2.5

Table Panel Assembly

The lift table top and back panel must be installed onto the lift frame. Four screws and washers (each panel) are used to secure the panels to the frame. See FIGURE 2.6

WARNING Do NOT operate the lift table before checking to ensure the unit and surrounding area is clear of personnel, animals and obstructions. Failure to do so could result in **SERIOUS INJURY** or **DEATH**.

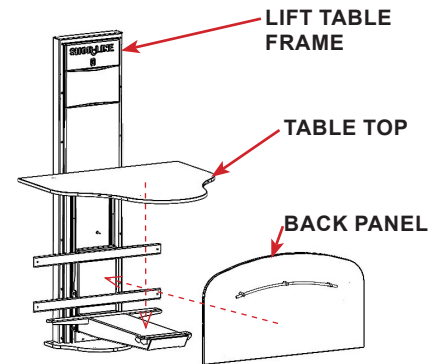

FIGURE 2.6 - Top & Back Panels

Table Back Panel

NOTICE Use the disconnect switch for the isolation circuit to toggle the power on/off when directed in the instructions.

Raise or lower the lift arm for accessibility during the panel installations.

The lift control switch toggles in the up and down direction to move the table up/down respectively. With no activation the switch rests in a neutral state, table still. See FIGURE 2.3

After positioning the lift arms, disconnect power during the installation procedures to avoid unintentional table movement.

WARNING Enlist help and **USE SAFE LIFTING PRACTICES** during assembly, installation and moving equipment.

CAUTION Keep hands clear of possible pinch areas during installation, which if not avoided, could result in **MINOR** to **MODERATE INJURY**.

Stainless steel panels have sharp edges, stay clear of and DO NOT TOUCH exposed edges which, if not avoided, could result in MINOR to MODERATE INJURY.

STEP 1: Carefully align the table back panel with four holes on the lift frame. See FIGURE 2.7

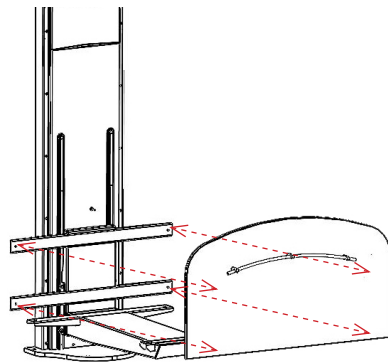

FIGURE 2.7 - Install Back Panel

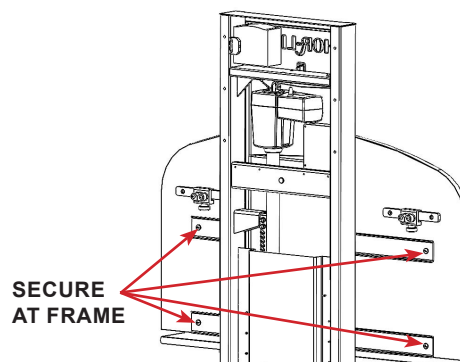

FIGURE 2.8 - Secure Back Panel

STEP 2: Secure the back panel to the frame using a 1/4"-20x1/2" long phillip head screw and 1/4" flat washer. (4 locations) See FIGURE 2.8

SECTION TWO

Table Top Panel

NOTICE

Use the disconnect switch for the isolation circuit to toggle the power on/off when directed in the instructions.

Raise or lower the lift arm for accessibility during the panel installations.

The lift control switch toggles in the up and down direction to move the table up/down respectively. With no activation the switch rests in a neutral state, table still. See FIGURE 2.3

After positioning the lift arms, disconnect power during the installation procedures to avoid unintentional table movement.

WARNING

Enlist help and USE SAFE LIFTING PRACTICES during assembly, installation and moving equipment.

CAUTION

Keep hands clear of possible pinch areas during installation, which if not avoided, could result in MINOR to MODERATE INJURY.

Stainless steel panels have sharp edges, stay clear of and DO NOT TOUCH exposed edges which, if not avoided, could result in MINOR to MODERATE INJURY.

STEP 1: Carefully align the table top panel with four holes on the lift frame. See FIGURE 2.9

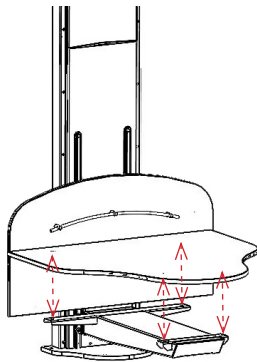

FIGURE 2.9 - Install Top Panel

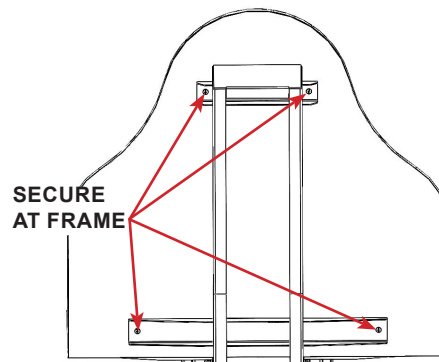

FIGURE 2.10 - Secure Top Panel

STEP 2: Secure the top panel to the frame using a 1/4"-20x1/2" long phillip head screw and 1/4" flat washer. (4 locations) See FIGURE 2.10

WARNING

Do NOT operate the lift table before checking to ensure the unit and surrounding area is clear of personnel, animals and obstructions. Failure to do so could result in SERIOUS INJURY or DEATH.

STEP 3: Use the foot operated pedal to test the up and down function of the table.

Store the foot operated lift switch in a safe place to avoid unintentional contact, movement of the lift table. Use the charging cable periodically, depending on use to maintain a charged battery. Charging cable provided.

STEP 4: Use the FOBs to test the up and down function of the table. Store the FOB switches in a safe place to avoid unintentional contact, movement of the lift table.

WARNING

Never leave an animal tethered to the lift table unattended. Always maintain full control of animals when on the exam table.

Stow the foot operated pedal and FOB hand held lift control switches in a safe place to avoid unintentional activation (table movement).

The table should never be operated remotely without a operator at the table to ensure the area is clear of obstruction, personnel and animals. Do NOT operate the table remotely with the table unattended. Failure to do so could result in SERIOUS INJURY or DEATH.

Leash Safety Ties

The lift table is equipped with two slide rails located on the backside of the back panel; and in conjunction with safety tie cam locks can be used to secure a leash. See FIGURE 2.11



WARNING *Never leave an animal tethered to the lift table unattended. Always maintain full control of animals when on the exam table.*

Safety tie cam locks install onto the slide track by hooking over one edge of the rail, then loosening the position lock knob enough to clear the other side of the track rail.

Tighten the position lock knob once in place. See FIGURE 2.12 and FIGURE 2.13

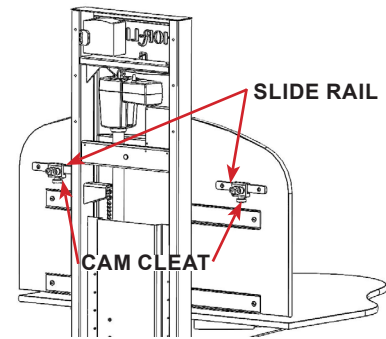

FIGURE 2.11 - Safety Ties System

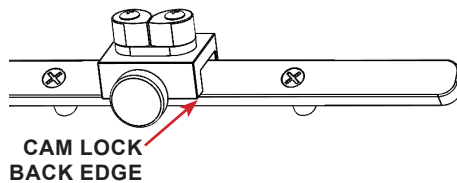

FIGURE 2.12 - Cam Cleat

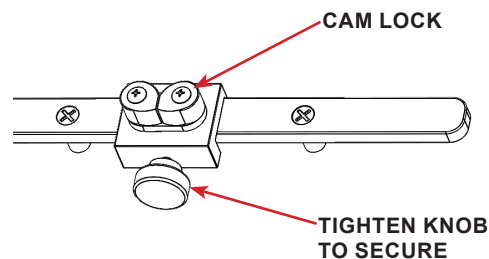

FIGURE 2.13 - Cam Cleat

Loosen the position lock knob to adjust/slide the accessory along the rail. Turn the position lock knob in the clockwise to lock in place.

Release, or slightly rotate one of the strap cam cleats to create a gap.

The strap retainer cam cleats are spring loaded and provide tension on the strap, allowing one-directional movement in the locked position. See FIGURE 2.14

Place the strap in between the cam cleats releasing the cam cleat to provide tension on the strap. Pull the strap through the cam cleats to secure the patient in the desired position.

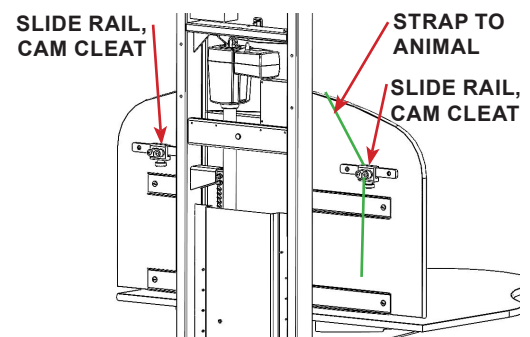

FIGURE 2.14 - Safety Ties System

Use And Care

Lift Table Safe Use Practices

Always use safe practices during loading and unloading patients from the lift table. All procedures should be created by the facility owner and followed. Common sense and being aware of safety concerns should always drive procedures. Below is a list of recommendations and situational conditions that require attention, heed all warnings.

- Unplug the unit before conducting any maintenance or cleaning procedures. Do NOT allow any personnel under or around the unit when plugged into a power outlet.
- Do NOT operate the lift table before checking to ensure the unit and surrounding area is clear of personnel, animals and obstructions.
- Do NOT sit, stand or lean on the table. Animal use ONLY.

Electric Lift Function

The lift table is equipped with an electric lift feature to raise and lower the table platform approximately 28-1/4 inches.



WARNING Do NOT operate the lift table before checking to ensure the unit and surrounding area is clear of personnel, animals and obstructions. Failure to do so could result in **SERIOUS INJURY** or **DEATH**.

Never leave an animal tethered to the lift table unattended. Always maintain full control of animals when on the exam table.

Stow the foot operated pedal and FOB hand held lift control switches in a safe place to avoid unintentional activation (table movement).

*The table should never be operated remotely without an operator at the table to ensure the area is clear of obstruction, personnel and animals. Do NOT operate the table remotely with the table unattended. Failure to do so could result in **SERIOUS INJURY** or **DEATH**.*

The electric lift is operated by a foot activated control pad, hand held remote controller (FOB), or the lift control switch at the top of the unit.

To recharge the foot operated lift control switch, use the charging cord (provided), as needed. Do NOT allow the foot switch sit for extended periods of time without use, recharge periodically.

Check and replace batteries in the hand held FOB remotes if they fail to respond.

The electric lift is capable of lifting up to 225 lbs of weight on the table top surface.

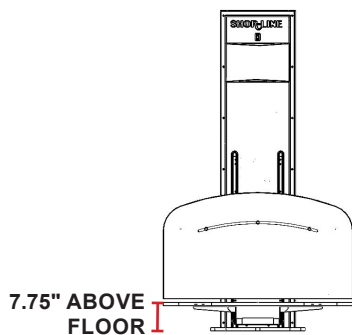

FIGURE 3.1 - Table Top Height (Down)

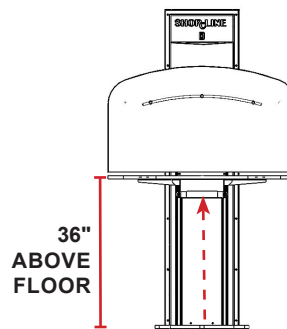

FIGURE 3.2 - Table Top Height (Up)



CAUTION Do NOT exceed the weight limitations (225 lbs) of the table. Exceeding the weight limit may cause equipment failure.

General Maintenance & Care

Maintenance Recommendations

NOTICE *Routine maintenance will extend the quality and life of Shor-Line products.*

It is the owners responsibility to set-up scheduled maintenance programs, depending on use of the equipment. Scheduled preventive maintenance should include, but not limited to daily or weekly inspections and maintenance of products to prolong its longevity and to help maintain proper product functions.

- Follow manufacturers cleaning and maintenance recommendations outlined in product literature provided for components not included in these recommendations. Configurations/component parts may vary.
- Check alignment of operable panels, doors and components to ensure operation is free of obstructions. Adjust as required.
- Check any battery compartments to ensure the batteries are not failing, corroding the contacts or damaging the equipment. A pencil eraser can be used to clean electrical contacts in battery compartments.
- Check any wiring for kinks or exposed inner wiring. If damage exist, stop equipment use and contact Shor-Line Technical Services for direction.
- Check any hydraulic lift components for leaking fluid. If fluid is present, stop equipment use and contact Shor-Line Technical Services for direction. Do NOT attempt to repair hydraulic leaks.

Care Recommendations

NOTICE *Routine product care will extend the quality and life of Shor-Line products and aids in protecting animals from transmittable diseases and infections.*

It is the owners responsibility to set-up scheduled cleaning programs, depending on use of the equipment. Scheduled preventive cleaning should include, but not limited to daily or weekly inspections and cleaning of products to prolong its longevity and to help maintain finishes.

Safe Cleaning Practices

- Use the mildest cleaning procedure that will complete the job effectively. Ordinary waste deposits and fluids can usually be removed with soap and water, using a soft cloth or sponge. Rinse thoroughly with clear water and dry completely with a soft cloth to discourage hard-water spotting.
- Minor scale build up and some hard water spotting can be removed by washing with a vinegar diluted mixture followed by a clear water rinse and thorough drying.
- Bleach, deodorizing agents, disinfectants, and sanitizers can corrode stainless steel, thoroughly rinse all surfaces treated with these chemicals with a clear water rinse and dry with a soft cloth.
- If scrubbing is required, use only polymer or nylon fiber products made for use with polymer or nylon materials.
- Always rinse with clear water and dry of all surfaces treated with cleaning, sterilization solutions.

Unsafe Cleaning Practices (NOT Recommended)

- Do NOT use a dry cloth or wipe clear polymer surfaces which can scratch if dust/dirt is wiped with the hand or dry cloth.
- Polymer materials can discolor if exposed to sunlight, ultraviolet rays. Avoid direct sun exposure.
- Do NOT use ammonia or bleaches to clean polymer surfaces.
- Do NOT allow fluids to accumulate, puddle without removing and completely drying the surfaces and components. Standing water/fluids are a hazard and can cause damage to component materials.
- Do NOT use scouring powders that will scratch polymer finishes.

NOTICE *Steel wool or steel brushes should never be used to clean stainless steel or polymer surfaces, avoid abrasive cleaning techniques/supplies.*

SECTION FOUR

Terms And Conditions

Shor-Line's [TERMS AND CONDITIONS](#) can be found at shor-line.com

Damaged Freight Procedures

Freight Claim - Contact the technical services department toll-free at 1.800.444.1579

To file a freight claim:

Inspect ALL packages upon arrival. If containers show evidence of damage when delivered, the packages should be opened and inspected before the carrier leaves. The shipment should be inventoried and inspected jointly by the customer and the carrier. The driver will then make proper notation on the delivery receipt.

Customer must inspect all materials for shortages, damages, conformity with the order, and defects before signing any documentation requested by the carrier. Customer must immediately complete such inspection and shall not accept delivery of goods that are damaged or not in accordance with the bill of lading or packing slip without proper notification to the carrier and Shor-Line. If products are damaged, defective, shorted or appear not to conform to the order, Customer shall discontinue their use and immediately notify the carrier and Shor-Line of such condition and afford a reasonable opportunity to inspect the same.

Customer shall make, or provide Shor-Line in writing with all information necessary to make a claim against such carrier for any shortage, damage, or discrepancy of the shipment within fifteen (15) days after receipt of the products. Claims or written information thereon not so presented within fifteen (15) days after receipt of the products will not be allowed. No returned products will be accepted, credited or replaced, unless arrangements for their return have been made in compliance with Shor-Line's Return Policy.

If containers do not show evidence of damage, there may be "concealed damage". Customer must report any concealed damage within 15 days after receipt of the shipment. Such report is to be made directly to Shor-Line's Traffic Department who will file a claim with the carrier. All packaging and contents must be held for this inspection.

STEP 1: Customer must check goods, contents against packing slip, weight against bill of lading, containers, etc.

STEP 2: Customer fills out "Inspection Report of Loss or Damage Discovered After Delivery".

STEP 3: Customer is to sign the report form. A copy is left with the customer and should be forwarded to Shor-Line's traffic department to file a claim.

STEP 4: Call Shor-Line's Traffic Department to file a claim (1.800.444.1579). Shor-Line will arrange pick-up, return shipment, and replacement of the product.

Return Policy & Repairs - All products being returned for any reason or delivered for repair service (whether or not pursuant to the Limited Warranty) must receive advance authorization from Shor-Line. Customer must contact Shor-Line's Technical Service Department at 1.800.444.1579 to receive a Return Authorization Number. All products returned, except for warranty service or pursuant to the Product Satisfaction policy, are subject to a minimum 15% restocking charge. Customer will be responsible for all freight charges on returns.

Return Product Authorization - To assure efficient handling on damaged or defective equipment, or repairs, please contact our Technical Service Department for Return Product Authorization (1.800.444.1579). Failure to obtain Return Product Authorization will only delay processing and may result in the denial of any repair, replacement or credit.

Repairs - It is mandatory to contact Technical Service Department at 1.800.444.1579 prior to sending product for repair.

Limited Warranty

In the event the Customer is not fully satisfied with the quality or workmanship of a product, Shor-Line in its sole discretion may arrange either to credit Customer's account (excluding shipping and handling costs) or replace the product. However, Customer must notify Shor-Line in writing of its dissatisfaction within fifteen (15) days of receipt of the product from Shor-Line. Customer must also return the rejected product to Shor-Line (freight paid) within thirty (30) days of its receipt in compliance with Shor-Line's Return Policy (See Section 4). Shor-Line's obligation is limited to providing the applicable credit or product replacement, which will be processed only after receipt of the returned product. In addition, this Product Satisfaction Policy does not apply to specially designed, discontinued, used, factory second or repaired products.

SHOR-LINE warrants to the initial purchaser only of products manufactured by it that such products are free from defects in materials or labor for varying periods depending on the particular product and subject to the limitations and conditions set forth herein. SHOR-LINE's stainless steel products are warranted to be free from such defects for their normal useful life. SHOR-LINE's mechanical and electrical products, parts, devices and components (including such parts, devices and components of stainless steel products), and other non-stainless steel products are warranted to be free from such defects for one year. SHOR-LINE disclaims any express or implied warranty for products not manufactured by SHOR-LINE and the only warranty available therefor to customer is that offered by the products' manufacturers.

The warranty period shall run from the date of delivery to customer. If within the applicable warranty period a product proves to be defective as described herein, SHOR-LINE will repair or replace the product, at SHOR-LINE's sole discretion, conditional upon customer's written notice of the defect within fifteen (15) days after its discovery and compliance with applicable return procedures. Upon receipt of customer's notice including substantiation of customer's status as the initial purchaser and details of the defect, SHOR-LINE shall advise customer whether it plans to repair or replace the product. SHOR-LINE's obligation is solely limited to repair or replacement of a defective product and in no event shall SHOR-LINE be liable for transportation from or to SHOR-LINE's offices or any other expense which may arise in connection with this limited warranty or the aforementioned product satisfaction policy.

SHOR-LINE makes no other warranty or guarantee of any kind whatsoever, whether expressed or implied, statutory or otherwise including, but not limited to implied warranties of fitness and or merchantability. The above limited warranty constitutes SHOR-LINE's only warranty and no person or entity is authorized, on behalf of SHOR-LINE, to modify or expand upon the provisions expressed in the limited warranty statement. SHOR-LINE's liability under this limited warranty shall be limited as provided for above and the foregoing shall be the customers sole remedy and recourse under this contract. There are no warranties, which extend beyond the description on the face hereof and goods are sold as-is. SHOR-LINE's limited warranty is only available to the initial purchaser of its products.

Customer agrees to comply with all instructions and specifications furnished by SHOR-LINE relating to installation, care and application of products sold. Customer agrees that it will not modify, misapply, or misuse such products in any manner including one that would deviate from the products' intended use. Any repairs, alterations or service provided by parties other than SHOR-LINE, or its authorized representative may void this limited warranty. This limited warranty shall not apply to normal wear and tear, damage caused by accident, negligence, improper operation, or the use of the corrosive material (including without limitation bleach-sodium hypochlorite) on stainless steel surfaces. SHOR-LINE's limited warranty made in connection with this sale shall not be effective and shall be void unless such goods are applied and used in accordance with SHOR-LINE's instructions.

Limitation Of Liability

Under no circumstances shall SHOR-LINE be liable to buyer or any other person for any special liquidated, incidental or consequential damages, including, without limitation, damages based upon lost goodwill, lost sales or profits, work stoppage, delay, product failure, impairment of goods or otherwise and whether arising out of breach of warranty, breach of contract, negligence or otherwise, and in any case, SHOR-LINE's liability for any and all losses and damages sustained by buyer and others, rising out of or by reason of this contract, shall not exceed the original purchase price of the products upon which liability is founded. In no event shall any action be commenced against SHOR-LINE more than one year after the cause of action with respect to which the claim is made has occurred. SHOR-LINE shall not be responsible for expenses for repairs not made by SHOR-LINE without the prior written consent of SHOR-LINE. Product specifications are subject to change without any notice or obligation on the part of SHOR-LINE.

DECEMBER 2020

SHOR-LINE[®]

SINCE 1927

SHOR-LINE

Schroer Manufacturing Company
511 Osage Ave.

Kansas City, Kansas 66105, USA

PHONE: 800.444.1579

LOCAL: 913.281.1500

FAX: 913.281.5339

EMAIL: guides@shor-line.com

WEB ADDRESS: SHOR-LINE.com

SHOR-LINE LIMITED

Vale Business Park Llandow,
Vale of Glamorgan CF71 7PF

United Kingdom

PHONE: +44 1446 77 20 41

FAX: +44 1446 77 36 68

EMAIL: quality@shor-line.co.uk

WEB ADDRESS: SHOR-LINE.co.uk