

Ritter®

MEDICAL

VistaCool™ Direct-to-Drain Cooling System for Autoclave Wastewater

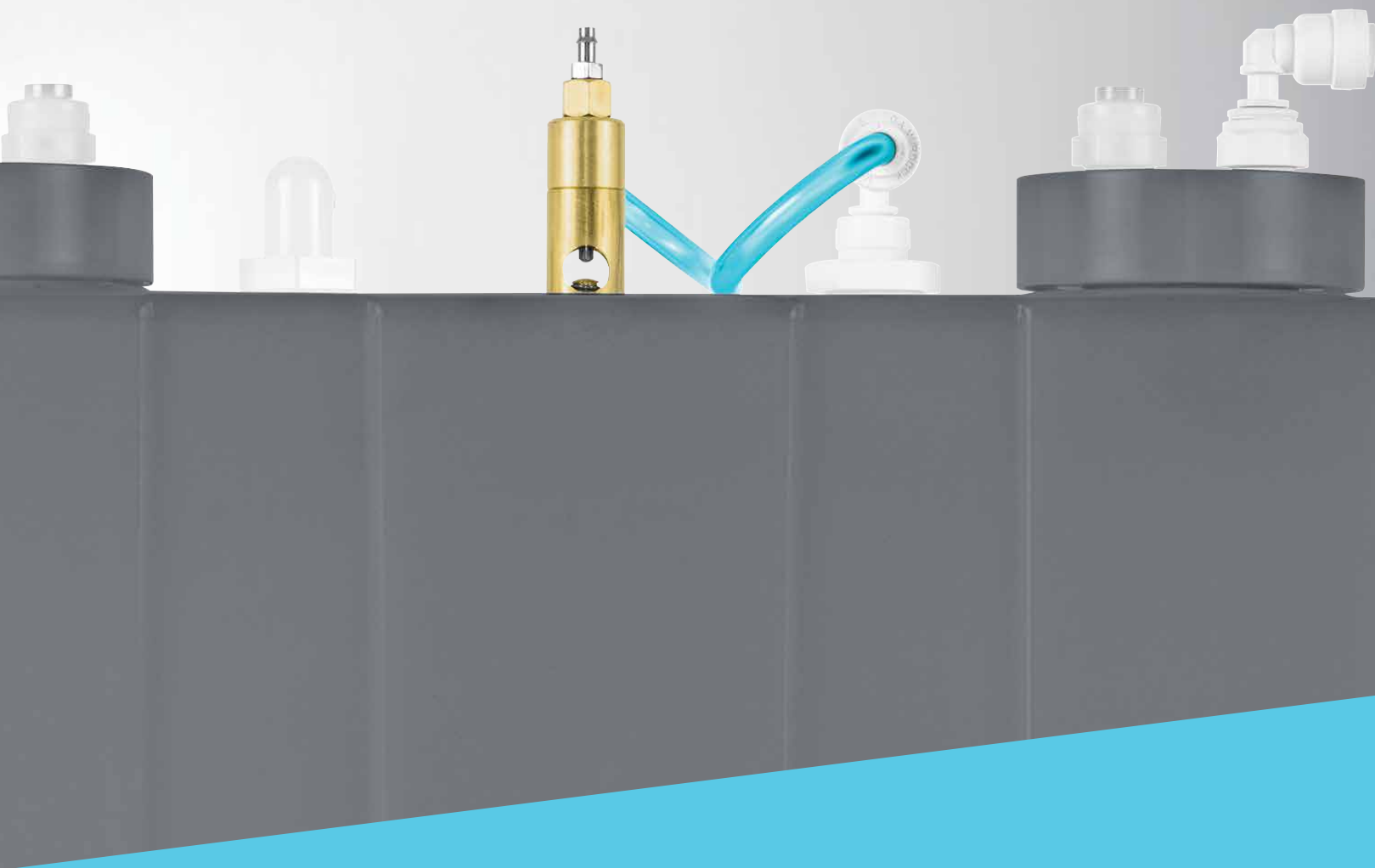

Say goodbye to your condensation tanks.

The steam and condensation produced by your sterilizer can be time-consuming and messy to empty. It can even melt plumbing if not cooled sufficiently before pouring it down the drain.

There is a better solution. The VistaCool™ Direct-to-Drain Cooling System for Autoclave Wastewater is designed to reduce the temperature of sterilizer wastewater—eliminating condensation bottles and tanks!



SINGLE UNIT

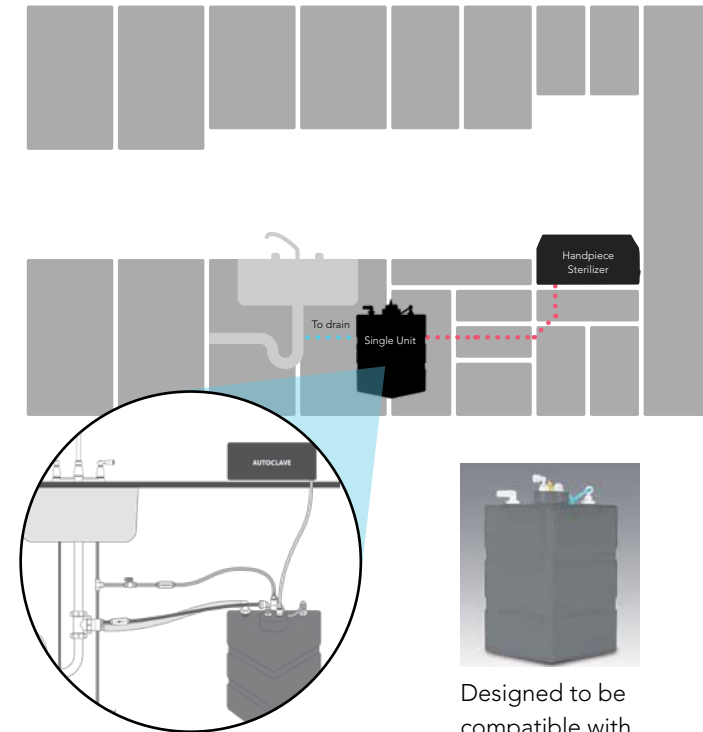

Designed to be compatible with the Ritter M3 Part No. 9A586001

DOUBLE UNIT

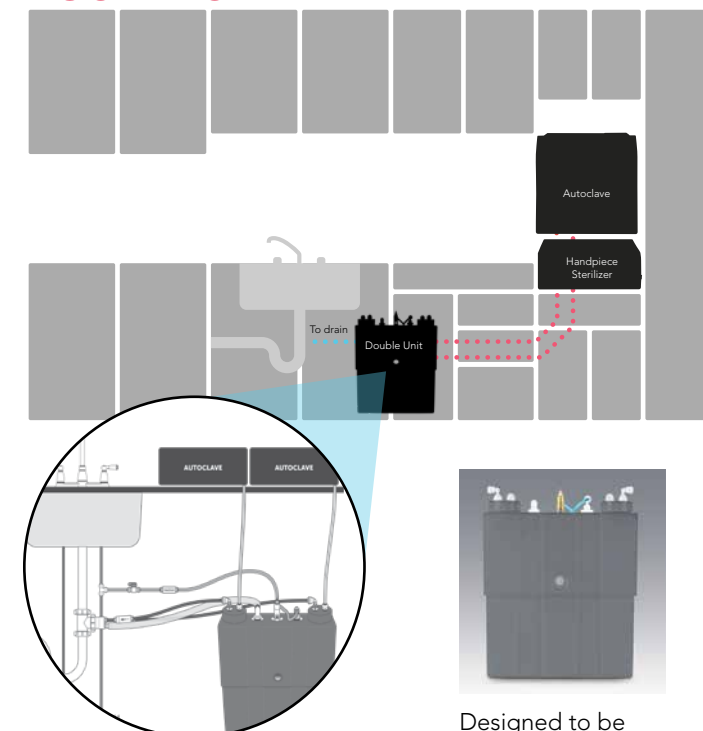

VistaCool is the only direct-to-drain product designed and tested to work with Ritter steam sterilizers.

Designed to be compatible with any two current Ritter® sterilizers Part No. 9A586002

VISTACOOL™ IS A CONVENIENT SOLUTION.

Eliminating the need to manually empty condensation tanks, VistaCool can allow you and your staff to spend more time with patients and less time tending to office equipment. This safe and reliable solution is designed to enhance office efficiency. Less work for staff means more time to care for patients.

PROTECTS STAFF

- Eliminates hazardous handling of hot condensation tanks
- Non-electric, self-monitoring system saves staff time with limited user maintenance required

PROTECTS DRAINS

- Designed to prevent sterilizer wastewater from melting plumbing
- Built-in backflow prevention meets or exceeds local plumbing codes

PROTECTS CABINETS

- Helps prevent mold and mildew caused by spills and exhaust from condensation tanks
- Helps protect cabinets from spills by sending cooled wastewater directly and safely to the drain

Designed to be compatible with:

Ritter® M3 Steam Sterilizer
Ritter M9® and M11® Steam Sterilizers*

*Compatible with double unit only.
Includes adapter kit.

SPECIFICATIONS

	Single	Double
Compatible Sterilizer	M3	M3, M9 and M11
Tank material:	Polyethylene - Gray	Polyethylene - Gray
Tank dimensions w/ fittings:	7.6" W x 7.6" L x 13.75" H (19.3 cm x 19.3 cm x 34.9 cm)	4.0" W x 13.0" L x 17.0" H (10.2 cm x 33.1 cm x 43.2 cm)
Tank volume:	1.5 gal (5.7 liters)	3.0 gal (11.4 liters)
Tank weight w/ water + fittings:	15 lb (6.8 kg)	28 lb (12.7 kg)
Approximate shipping weight:	7 lb (3.2 kg)	10 lb (4.5 kg)
Coolant water connection:	Supply fittings for 1/4" O.D. feed tubing included. To be provided by installer.	Supply fittings for 1/4" O.D. feed tubing included. To be provided by installer.
Max. coolant water pressure:	100 psi (6.9 bar)	100 psi (6.9 bar)
Max. altitude (If using air gap):	6,561 ft (2,000 m)	6,561 ft (2,000 m)

Accessories		
9A586004 Air Gap Kit	(needed only if required by local code)	(needed only if required by local code)
9A586005	Single VistaCool™ adjustable tank stand	N/A
9A586006	N/A	Double VistaCool adjustable tank stand
*9A586003	N/A	M9/M11 Adapter Kit

*M9 and M11 Steam Sterilizers are compatible with the double unit only. The double unit includes the required adapter kit (9A586003).

VistaCool™

Midmark is an ISO 13485 and ISO 9001 Certified Company. Certain products are not included. See the complete list at: midmark.com/ISO

For more information, contact your Midmark dealer or call: 1.800.MIDMARK

Outside the USA call: 1.937.526.3662 or visit our website at midmark.com

© 2019 Midmark Corporation, Miamisburg, Ohio USA

Manufactured by Crosstex International, Inc., for distribution by Midmark Corporation, Versailles, OH

The VistaCool™ Direct-to-Drain Cooling System for Autoclave Wastewater is manufactured by and a trademark of Crosstex International, Inc., a Cantel Medical Company.

Products subject to improvement changes without notice.
Litho in USA
007-10159-00 Rev. B1 (3/21)

Ritter®