



## COLORS + FINISHES

**Cabinetry:** Flat Iron

**Countertops:** Silver Birch Corian® Solid Surface

**Panel Style:** Cove

**Upholstery:** Cobalt Vista

**Walls:** Pure White SW7005

**Flooring:** Interface - A00308 Light Concrete

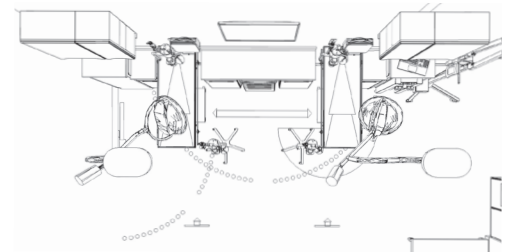

[midmark.com/animalhealthexpcenter](https://midmark.com/animalhealthexpcenter)

# PRODUCT SELECTIONS

## MIDMARK EXPERIENCE CENTER DENTAL SUITE



### ANESTHESIA

**91800003**  
VMS®

**91305418**  
Isoflurane VIP 3000® - Key Fill

**91305507**  
Sevoflurane VIP 3000® - Well  
Fill

**91800042**  
VMS® Wall Mount

**9A465011**  
Monitor Mount, Stud, for  
8013/8014/8015/8019

**40162800**  
Midmark Central Scavenger

### DIGITAL DENTAL RADIOGRAPHY SYSTEMS

**DCVM-G0X/H/S4/L**  
Midmark Complete Mobile  
System, #2 Bite-Resistant  
Sensor with Laptop

**ASAM-GT**  
Laptop Tray for Mobile X-ray

**30-08180**

Laptop

**XSVN-04**  
Bite-Resistant Size 2 Sensor,  
0.9M Cable

### MONITORING

**8019-001**  
Midmark Multiparameter  
Monitor with Printer

**8019-002**  
Midmark Multiparameter  
Monitor without Printer

**9A465012**  
Monitor Mount, Wall, for  
8013/8014/8015/8019

### SEATING

**102-7000-31**  
Chair without Arms (Saddle)

**102-7100-31**  
Chair without Arms (Triangle)

### SURGERY TABLES

**100-3261-21**  
60" With Heated Top

**200-3041-34**  
Caster Set – Plate, 4 Locking  
For Surgery Tables (Oct 2018 –  
Present)

**200-3041-03**  
Small Drip Bucket, 2 Quart

### DENTAL DELIVERY SYSTEM

**8000-008S**  
Midmark 1000 with Integrated  
LED Scaler and Fiber-Optic  
Swivel High-Speed Handpiece,  
Swivel Low-Speed Handpiece

**8000-007S**  
Midmark 1000 with Integrated  
LED Scaler and 2 Fiber-Optic  
Swivel High-Speed Handpieces

### LIGHTING

**255-021**  
255 LED Procedure Light Single  
Mount, 8' (2.4m) Ceiling

### CABINETRY

**Custom**  
Synthesis® Cabinetry Layout  
Base and Upper Cabinets

### MOBILE TREATMENT CART

**M41A.807.KCN**  
Mobile Treatment Cart M4