

# Maintaining Operator Equipment

Whether you are working normal hours, reducing your hours or planning to close your practice temporarily, remember to perform regular operator maintenance to keep your equipment clean, safe and running smoothly.

## AFTER EACH PATIENT

Use proper personal protective equipment (PPE) while cleaning.

**STEP 1:** Clean and disinfect clinical contact surfaces (e.g., delivery system and clinician, light, and chair controls) using an EPA registered and FDA market-cleared cleaner/disinfectant or 10% solution of bleach with water.

**OR**

Install new barriers on all clinical contact surfaces (recommended).

**STEP 2:** Clean and flush handpiece tubing.

### Asepsis 21® and Procenter Delivery Units

- Press and hold the foot control pedal for 30 seconds.
- Press and hold the flush button for 30 seconds for water to flow fluidly. If no water flows or just spurts, the system has not flushed properly.
- Repeat these steps for all tubing to the handpieces.

**Note:** If you are using a low speed handpiece and waterlines are disconnected, flushing is not required.

### Elevance® Delivery Units

- Perform a flush operation (refer to the ICM Screens guide for more details).
- Per CDC guidelines, discharge water and air after each patient for a minimum of 20–30 seconds from any device connected to the dental water system that enters the patient's mouth.

**Note:** Hold the tubing and syringe over a container or drain while flushing.

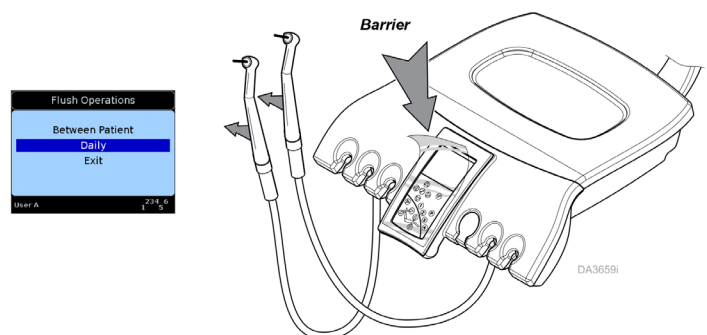
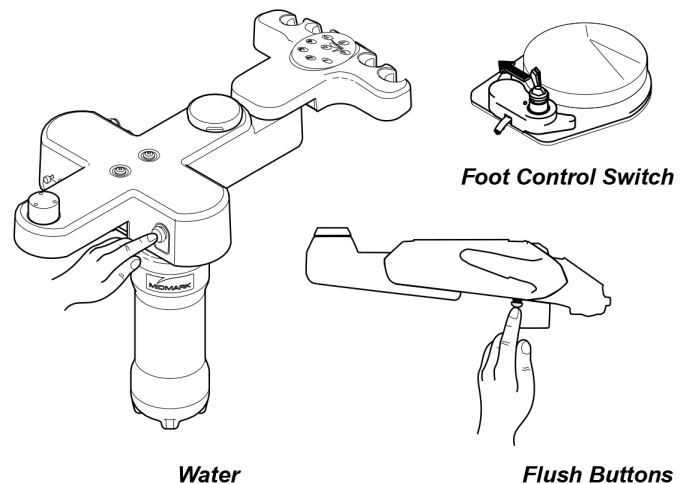
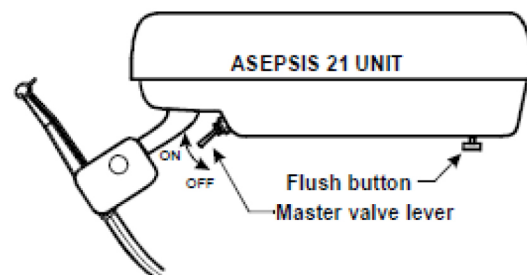

# AFTER DAILY USE

- STEP 1:** Perform daily purge procedure on waterlines.  
**Note:** Per CDC guidelines, flush waterlines for 20–30 seconds at the beginning and end of each day and between patients to remove patient material potentially retracted during treatment.
- STEP 2:** Turn the master switch off, then press and hold the foot pedal until all pressure is released.
- STEP 3:** Perform general purpose cleaning on chairs, delivery units and lights.

# AS NEEDED

- STEP 1:** Clean the air/oil separator.
- See **Image A: Elevance®**
  - See **Image B: Asepsis 21®**
  - See **Image C: Procenter**
- STEP 2:** Inspect HVE and saliva ejector O-rings.

Continued on next page

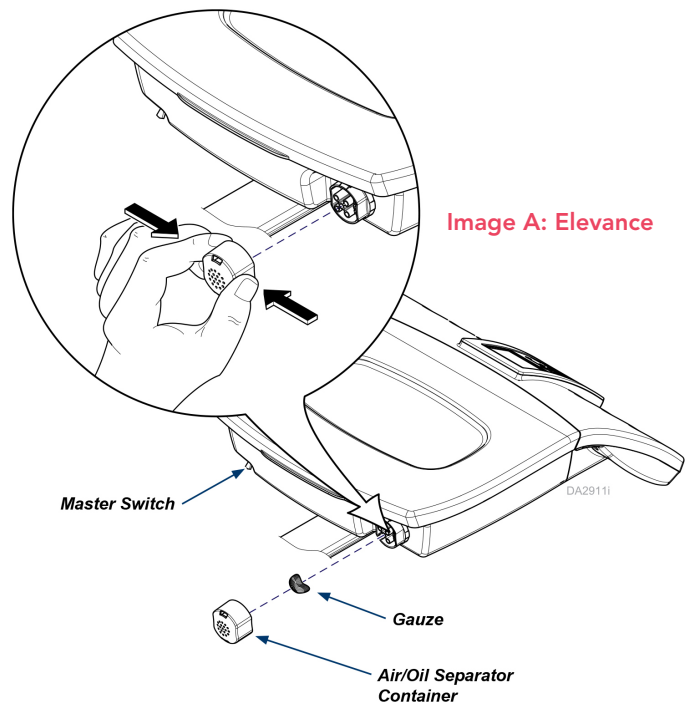

Image A: Elevance

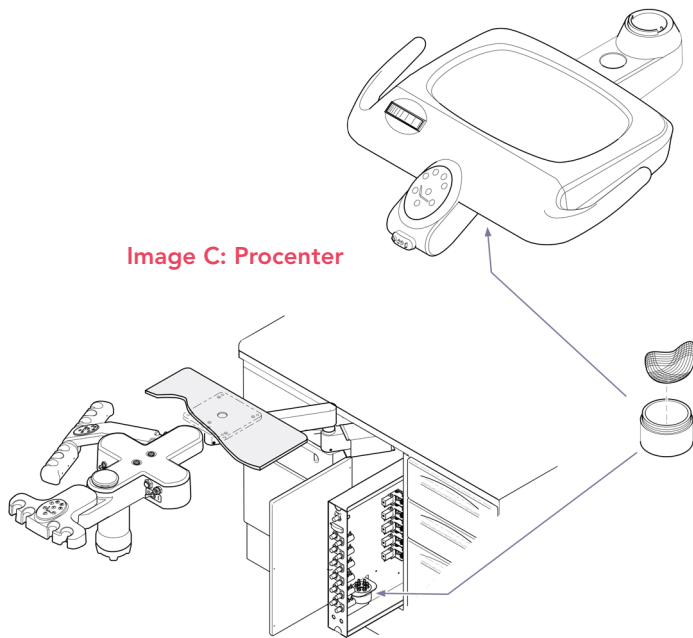

Image C: Procenter

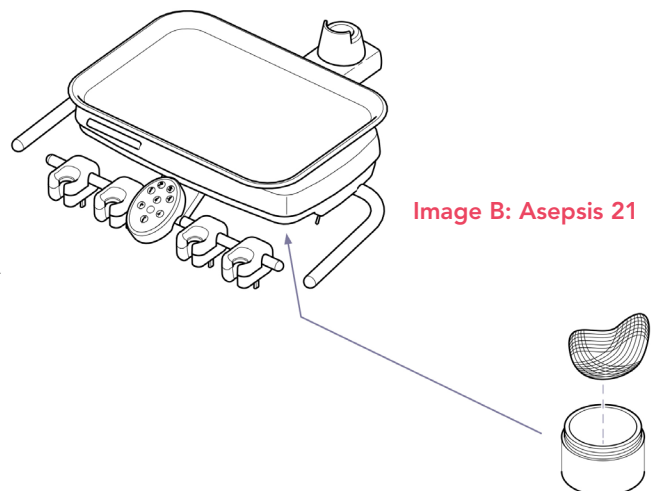

Image B: Asepsis 21

# AS NEEDED (CONTINUED)

**STEP 3:** Check the oil level in the dental chair.

**a. Position chair.**

- i. Rotate chair to the right for more room to work.
- ii. Tap and lift arm cover three times to raise chair to the home position.
- iii. Lower back until level with seat.
- iv. Disconnect chair from power supply.

**Warning:** Always disconnect chair from the power source before removing any covers. Failure to do so may result in personal injury.

**b. Remove upper lift arm cover.**

- i. Push in with a slotted screwdriver to release upper lift arm cover clips.
- ii. Lift cover off chair.

**c. Check oil level.**

- i. Remove screw in cap bracket and rotate bracket to remove.
- ii. Pull up on oil cap to remove from reservoir.
- iii. Oil should be level with the base of the oil cap opening.
- iv. Add only Hydraulic Oil with Viscosity ISOVG 32. if oil level is low.

**Equipment Alert:** Factory fill volume: 1.3–1.4 US quarts (1.2–1.3 liters)

**d. Install oil cap, cap bracket and lift arm cover.**

- i. Push oil cap into tank opening.
- ii. Place bracket over screw, rotate bracket to fit over oil cap and screw into tank.
- iii. Replace upper arm lift cover—see instructions above.
- iv. Connect chair to power supply.

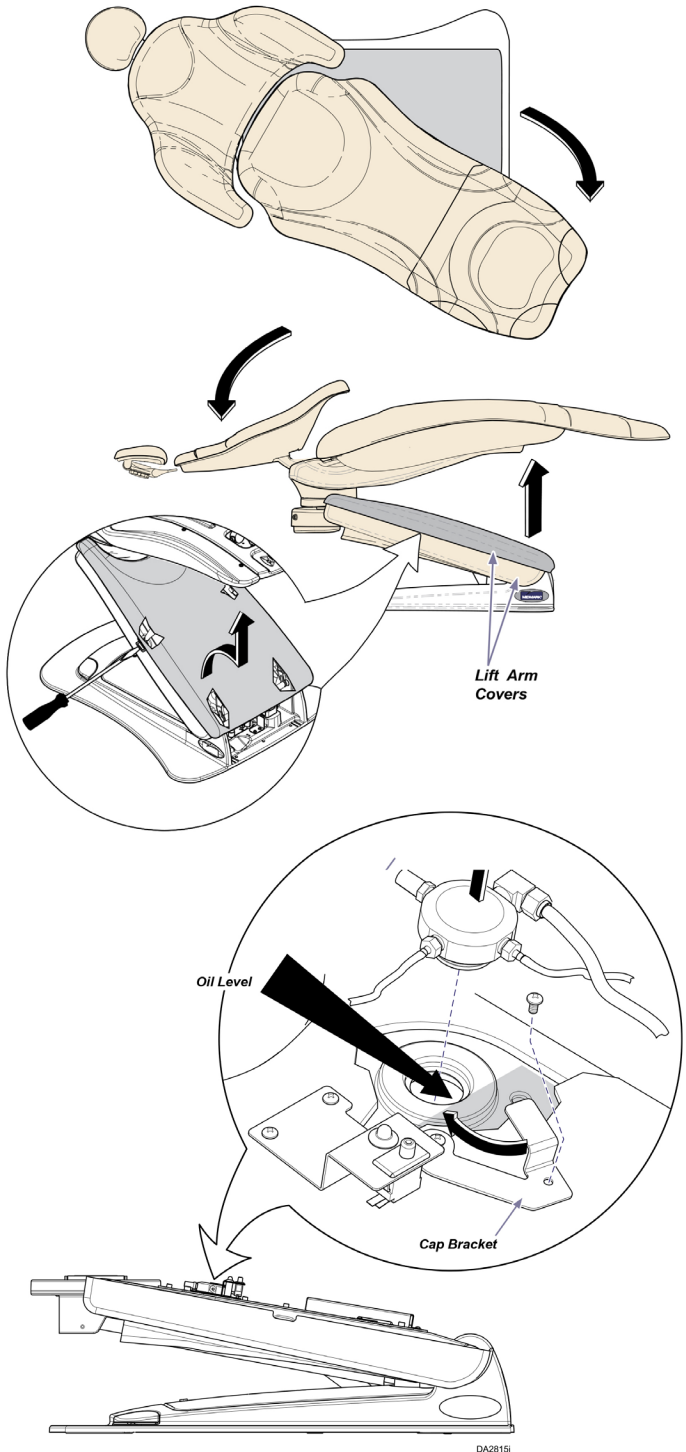

## AFTER YEARLY USE

Replace air and water regulator filters in the junction box.

**Note:** If city water is used, water filter might need to be replaced more often based on water quality.

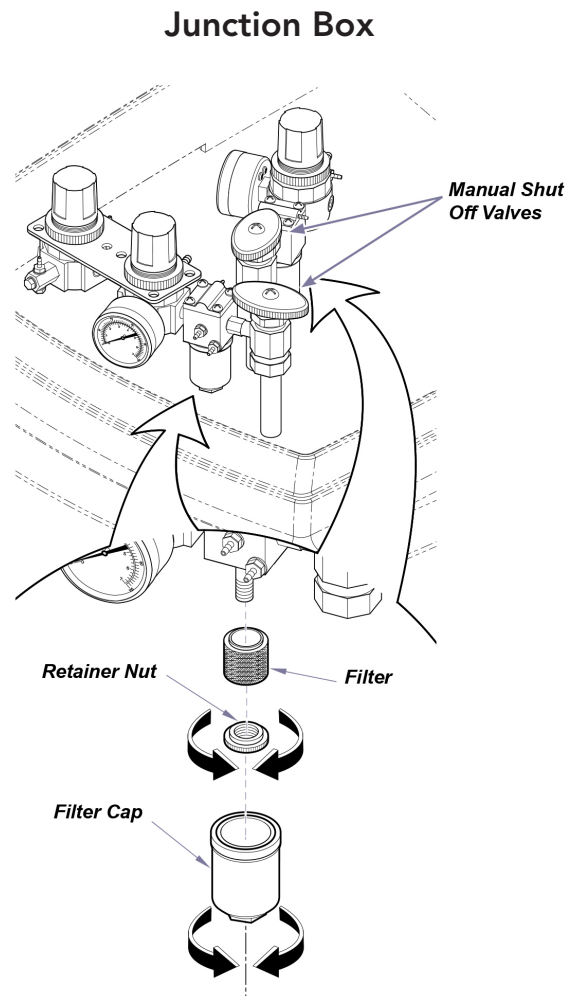

## Sources

[CDC](#)

[OSAP](#)

[Elevance® Dental Chair User Guide](#)

[Delivery System User Guide](#)

[Asepsis 21® Delivery Systems User Guide](#)

[Procenter Delivery Systems User Guide](#)

[Elevance Standard Delivery System User Guide](#)

If you have questions or need assistance, please contact [Technical Service online](#) or at 1.800.MIDMARK.

MKT-00382 © 2020 Midmark Corporation, Miamisburg, Ohio USA. All rights reserved