

# Operatory Startup Procedures

**Applies to Models:**  
All Junction Boxes

## Junction Box

**Note:** These instructions outline basic startup procedures. For all technical information and user guides, visit our technical library at [www.midmark.com/technical-library](http://www.midmark.com/technical-library).

### Step 1: Visual check.

- A) Turn on the air, vacuum, and water (if needed) at the wall panel. Then remove the lid of the junction box and check for any air or water leaks.
- B) Verify that all hoses and wiring appear to be connected properly.

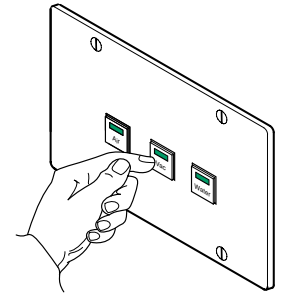

ArtQuarter

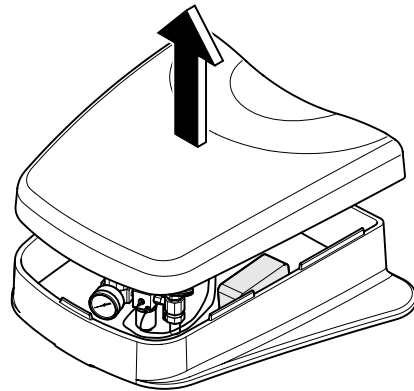

Water Shut Off Valve  
(If Equipped)

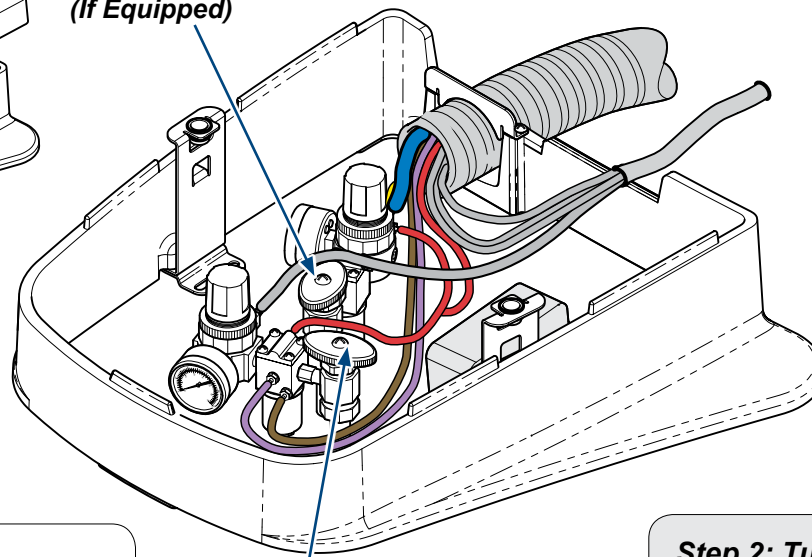

Air Shut Off Valve

**Note:**

Shut off valves are typically located in the bottom of the cabinet for cabinet mounted units.

**Note:**

Junction box styles will vary depending on the model you own.

### Step 2: Turn on air and water.

- A) Turn on the air, and water (if equipped) by opening the shut off valves. Check for leaks.
- B) Then reinstall the lid of the junction box.

*Note:* Common shut off valve designs differ. They may take 2-3 turns, one rotation or 90-degree rotation to open the shut off valve fully.

# Water Bottle

## Applies to Delivery System Models:

Elevance  
Procenter  
Asepsis 21

### Step 1: Relieve pressure from water bottle.

- A) Turn master switch OFF.
- B) Press and hold syringe air button until all residual air pressure is released (you can hear it stop hissing).

#### Note:

Water systems needs to be maintained in order to meet the CDC requirements.

#### Note:

Water used must meet all local requirements for drinking water.

Water  
Bottle

Mounting  
Cap

O-ring

(Optional)  
Quick Release  
Water Bottle

ArtQuarter

### Step 2: Fill water bottle.

- A) Unscrew water bottle.
- B) Fill bottle with water.
- C) Be sure gasket is in place (in mounting cap) and screw bottle into mounting cap.

# Elevance<sup>®</sup> Dental Unit

**Applies to Models:**  
Elevance

**Note:**

The purging procedure removes debris from the tubing to the handpieces and syringe. Performing this procedure frequently may help reduce the accumulation of biofilm on your instruments.

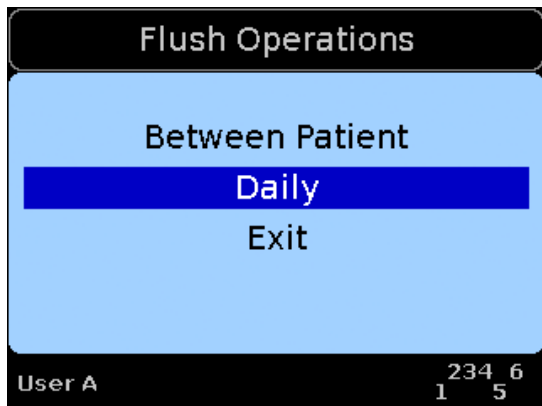

**Step 1: Clean unit and flush water system.**

- A) Thoroughly clean and visually inspect the delivery system and install new barriers on all clinical contact surfaces.
- B) Pull two or more smart handpieces at the same time and the flush operations menu will appear.
- C) Use  $\triangle$   $\nabla$  to move highlight to desired option.
- D) Press  $\checkmark$  to select the highlighted flush operation.
- E) Perform the daily flush procedure for both the syringe and all handpieces.

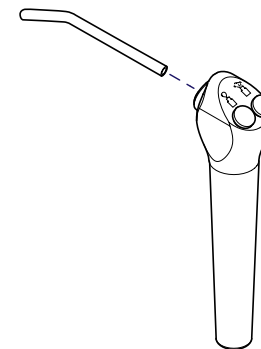

**Note:**

Pulling multiple smart handpieces is the **ONLY** way to access the flush operations menu.

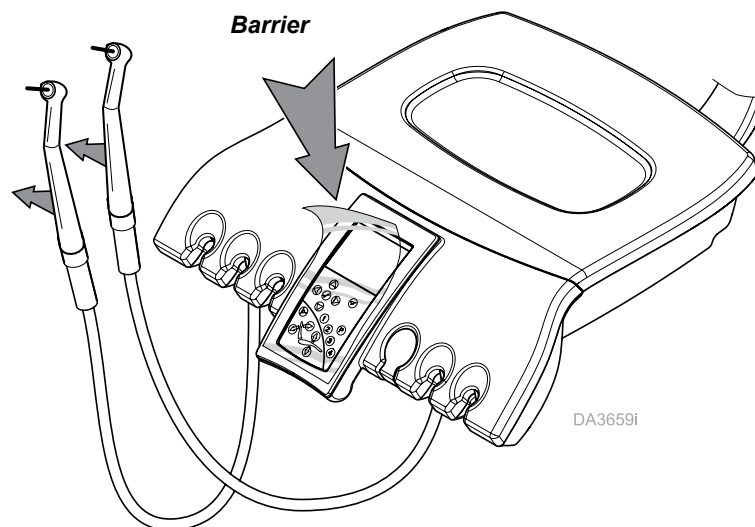

# Procenter Dental Unit

**Applies to Models:**  
Procenter

## Note:

The purging procedure removes debris from the tubing to the handpieces and syringe. Performing this procedure frequently may help reduce the accumulation of biofilm on your instruments.

### Step 1: To begin the purging procedure.

- Turn Master Switch ON.
- Turn Water Selector Switch to bottle setting.
- Move the foot control switch to the water setting.
- Disconnect handpiece from tubing.

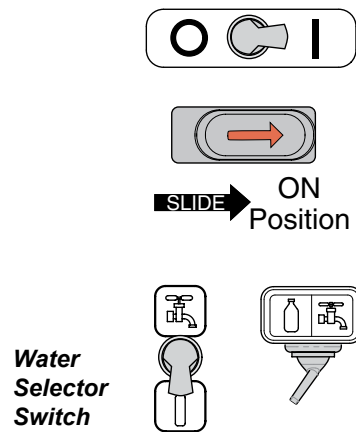

### Step 2: Flush the tubing to the handpieces.

- Hold the tubing and syringe over a container or drain while flushing.
- Press and hold the foot control pedal for 30 seconds.
- Press and hold the flush button for 30 seconds.
- Repeat for all tubing to the handpieces.

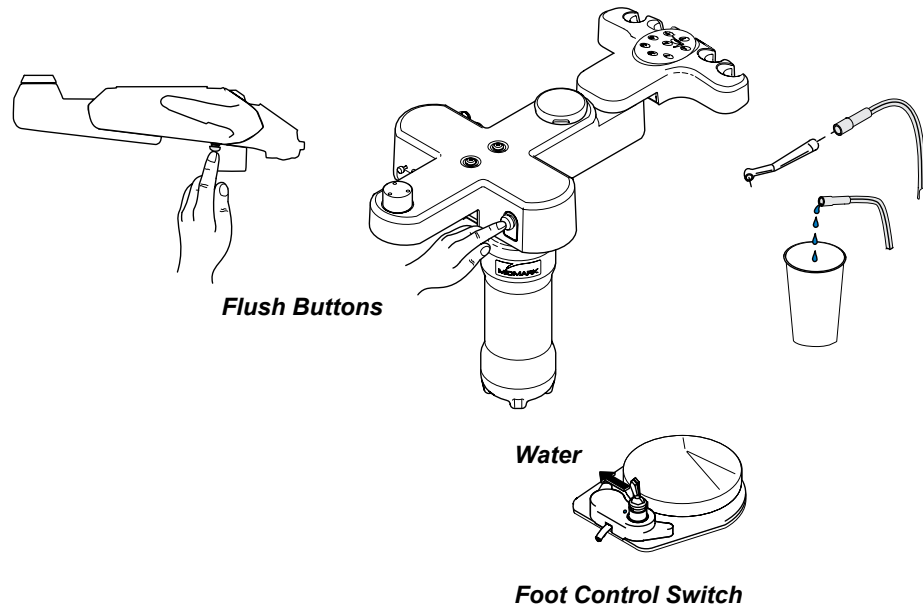

### Step 3: Flush the syringe tubing.

- Press and hold both syringe buttons (air and water) for 30 seconds.

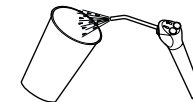

DA2559011

# Asepsis<sup>®</sup> 21 Dental Unit

**Applies to Models:**  
Asepsis 21

## Note:

The purging procedure removes debris from the tubing to the handpieces and syringe. Performing this procedure frequently may help reduce the accumulation of biofilm on your instruments.

### Step 1: To begin the purging procedure.

- Turn Master Switch ON.
- Turn Water Selector Switch to bottle setting.
- Move the foot control switch to the water setting.
- Disconnect handpiece from tubing.

### Step 2: Flush the tubing to the handpieces.

- Hold the tubing and syringe over a container or drain while flushing.
- Press and hold the foot control pedal for 30 seconds.
- Press and hold the flush button for 30 seconds.
- Repeat for all tubing to the handpieces.

Master Switch

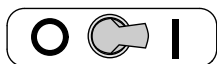

Water Selector Switch

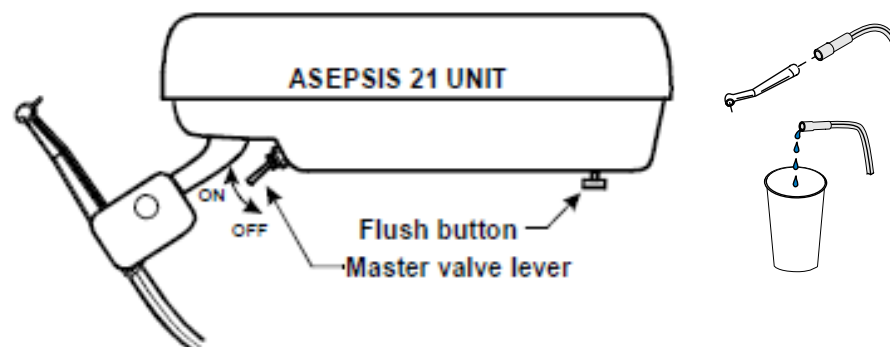
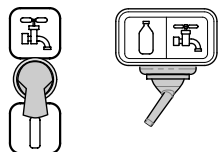

Water

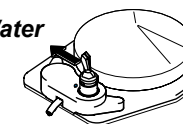

Foot Control Switch

### Step 3: Flush the syringe tubing.

- Press and hold both syringe buttons (air and water) for 30 seconds.



DA255901i

# Assistant's Unit

## Applies to Models:

Elevance  
Procenter  
Asepsis 21

### Step 1: Purging assistants syringe.

A) Follow steps outlined for the unit to flush the assistants syringe.

### Procenter

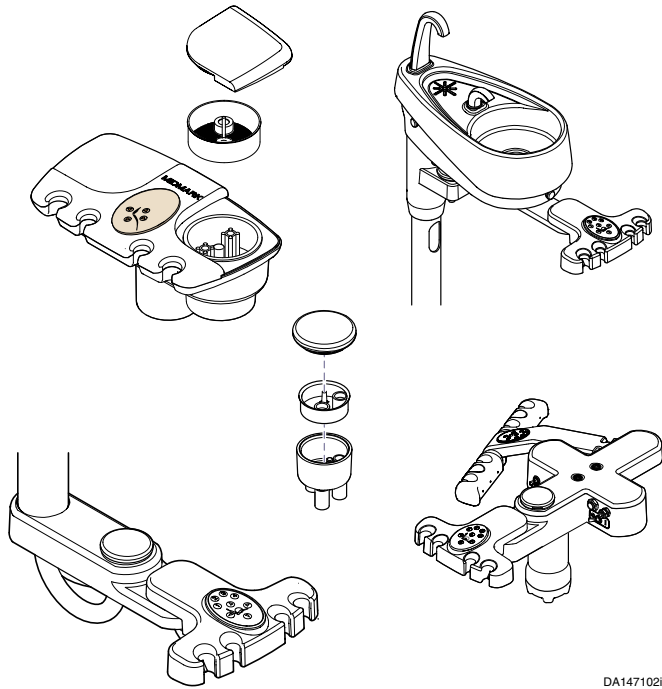

DA147102i

### Elevance

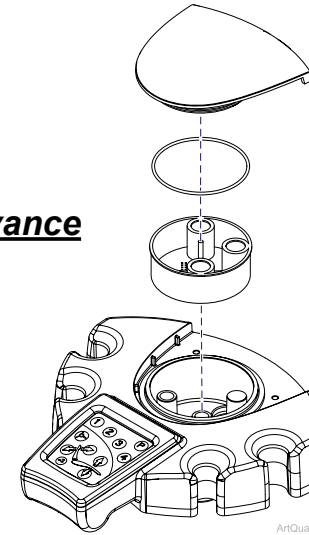

ArtQuarter

### Step 2: Clean the solids collector.

- A) Turn facility vacuum OFF.
- B) Remove lid and basket.
- C) Clean basket and housing.
- D) Reinstall basket and lid.



### Caution

Always dispose of biohazardous debris according to local regulations.

### Asepsis 21

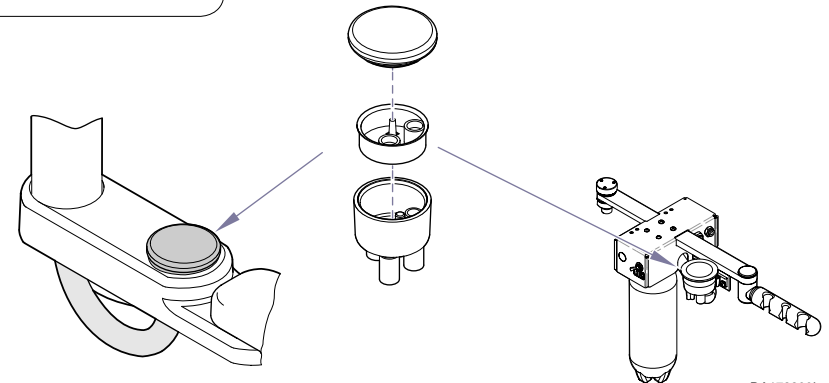

DA178800i

# Cuspidor

## Applies to Models:

Elevance  
Procenter  
Asepsis 21

### **Step 1: Flush/Operate the cuspidor.**

- A) Operate the cup fill and bowl flush/rinse several times to flush system and ensure water is coming out smoothly.
- B) Check the timing of the rinse and cup fill to meet desired flow for office's usage.

### **Procenter/ Asepsis 21**

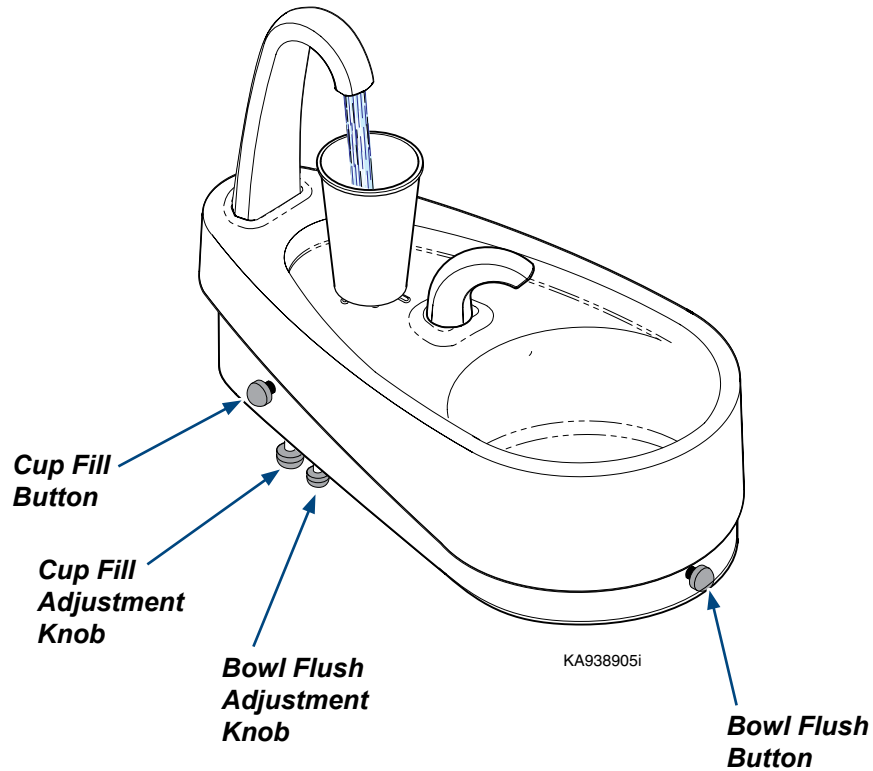

### **Elevance**

