

ISA Phasein CO2 & Multigas Scavenging Kit [002-10171-00]

Components:
Scavenging Tee Assy....1
Special Tools:
none



Caution

Connect the gas sample exhaust port to a scavenging system to prevent pollution of the operation room when N2O and/or anesthetic agents are being used.

Step 1:

- A) Turn off anesthetic agent, oxygen and scavenging system.
- B) Remove scavenging tubing from APL valve.
- C) Connect scavenging tee between APL valve and scavenging tubing.
- D) Connect small clear tube to the CO2 or Multigas analyzer exhaust port.

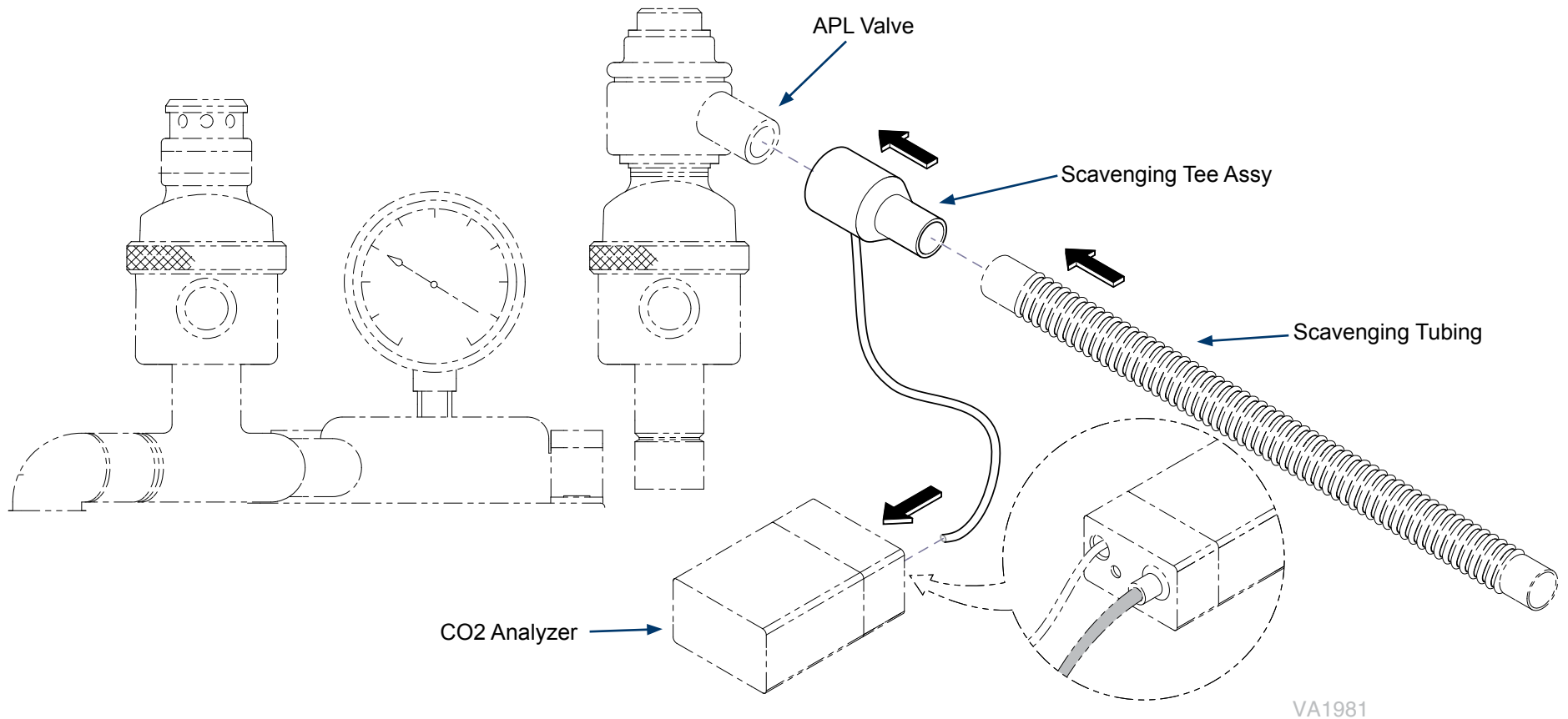

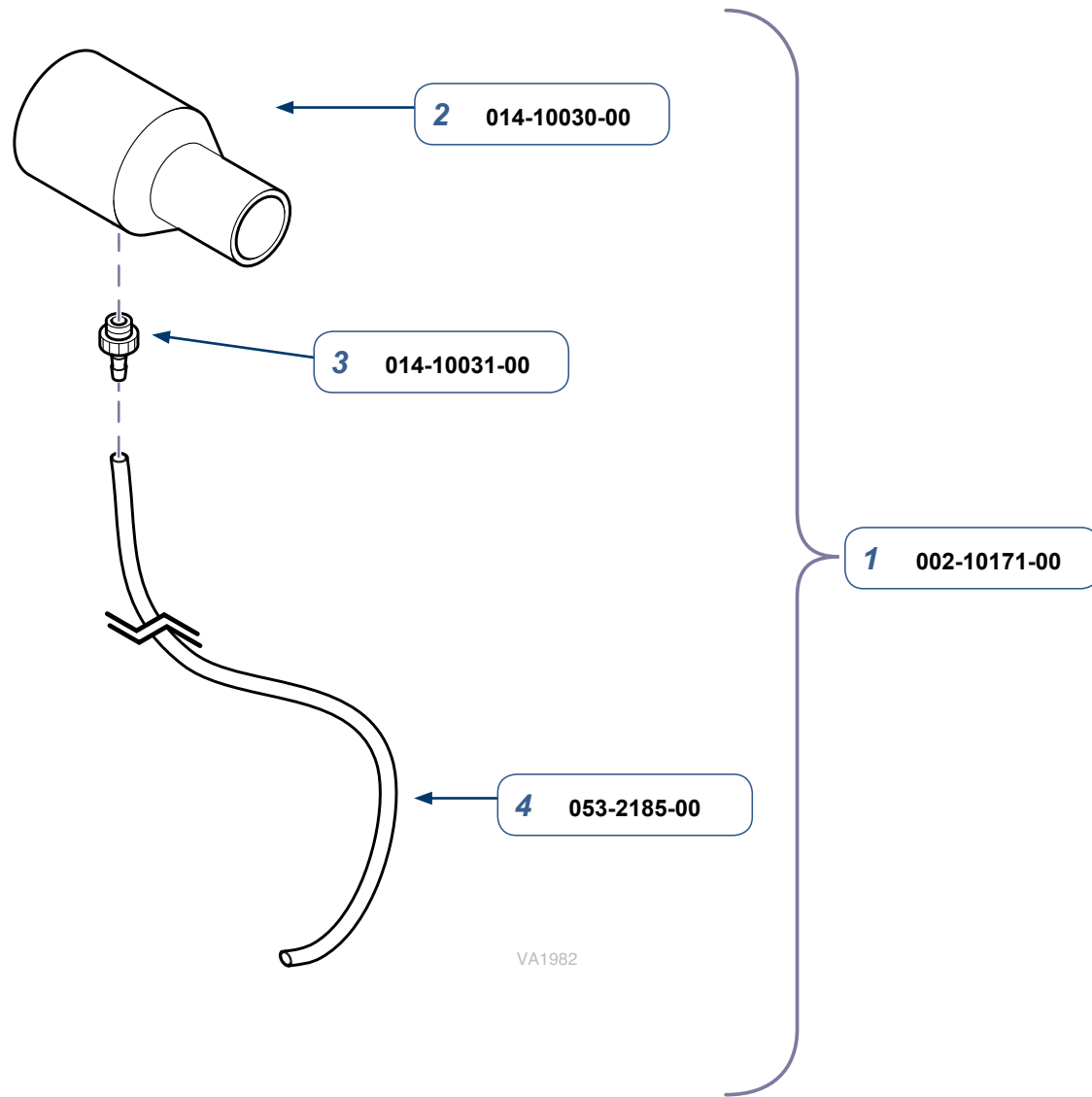

ISA Phasein CO2 & Multigas Scavenging Kit
(includes items 2 thru 4)

Item	Description	Qty.
1	ISA Phasein CO2 & Multigas Scavenging Kit	1
2	•Scavenging Tee	1
3	•Barb Fitting, 1/4-28 UNF X 3/32 ID	1
4	•Clear Tubing 5/32" OD X 3/32" ID	66 in

Serial Numbers / Dates:

all