



Software Update Installation

626-001 (002-10264-xx)
626-002 (002-10318-xx)
626 (-003 /-005) (002-10319-xx)
626 (-004 /-006) (002-10320-xx)



Caution

Always disconnect power to chair before removing covers or performing any service procedures.



Equipment Alert

Verify that the serial number on the flashdrive matches the serial number on your Chair before using it to update the software.

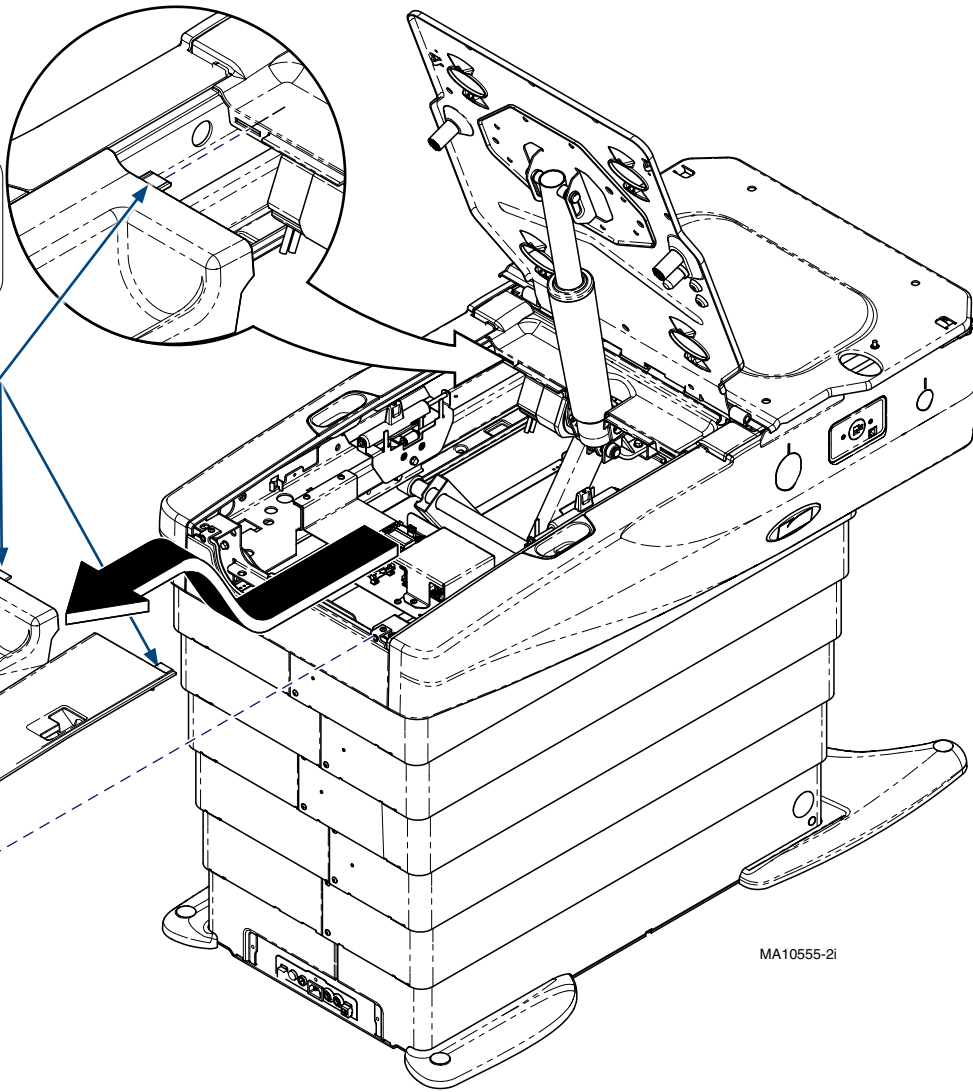
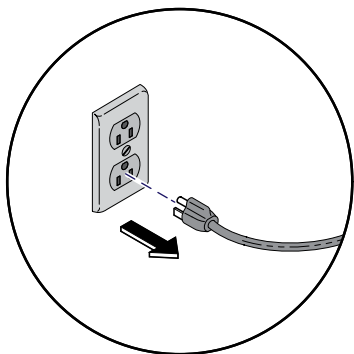

Screws

Tabs

MA10555-2i

Step 1: Remove Top Cover

- A) Raise chair backrest to the full upright position.
- B) Unplug chair.
- C) Remove two screws from back of Top Cover.
- D) Pull cover toward head end to disengage tabs, then lift up to remove cover.

Step 2: Update the software.

- A) Plug in chair.
- B) Insert the flashdrive into the USB port located on the Diagnostic Interface PCB.
- C) "Update Software" screen appears. Press the Enter Button.
- D) "Update Start?" screen appears. Press the Enter Button.
- E) A progress percentage appears, increasing percentage as the update is loaded to each of the PCB(s). (This takes several minutes.)
- F) When the "Update Complete" screen appears, remove the USB flash drive.
- G) Unplug the chair, wait a few seconds and plug the chair back in.

Note: The software will update several PC boards depending on chair configuration.
The Chair beeps when the Main PC board is finished there are no beeps for other boards.

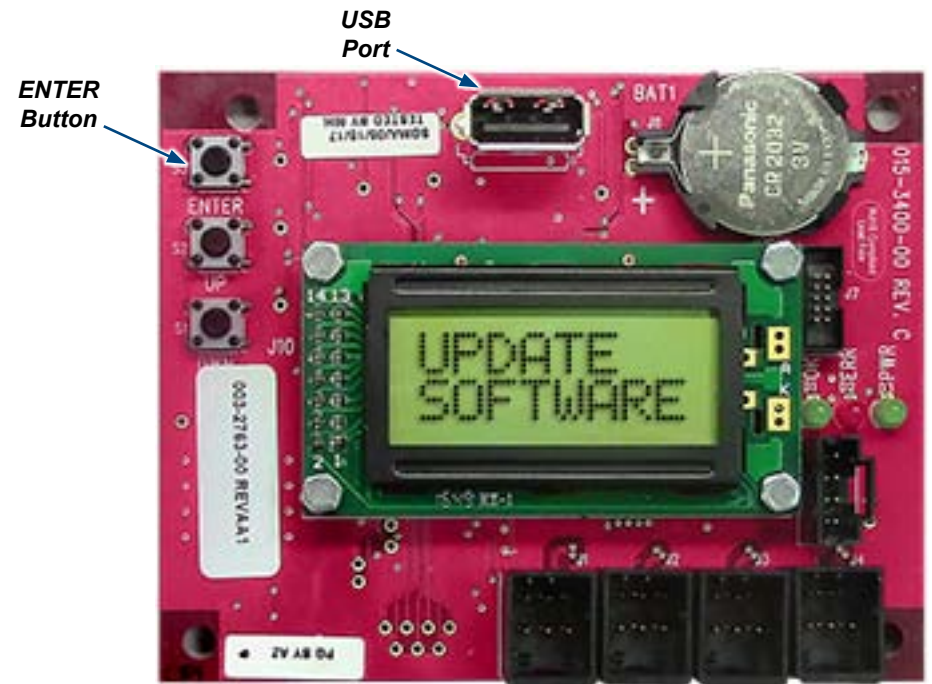

Note

If the update process is interrupted, repeat Step 2, A through F if necessary.

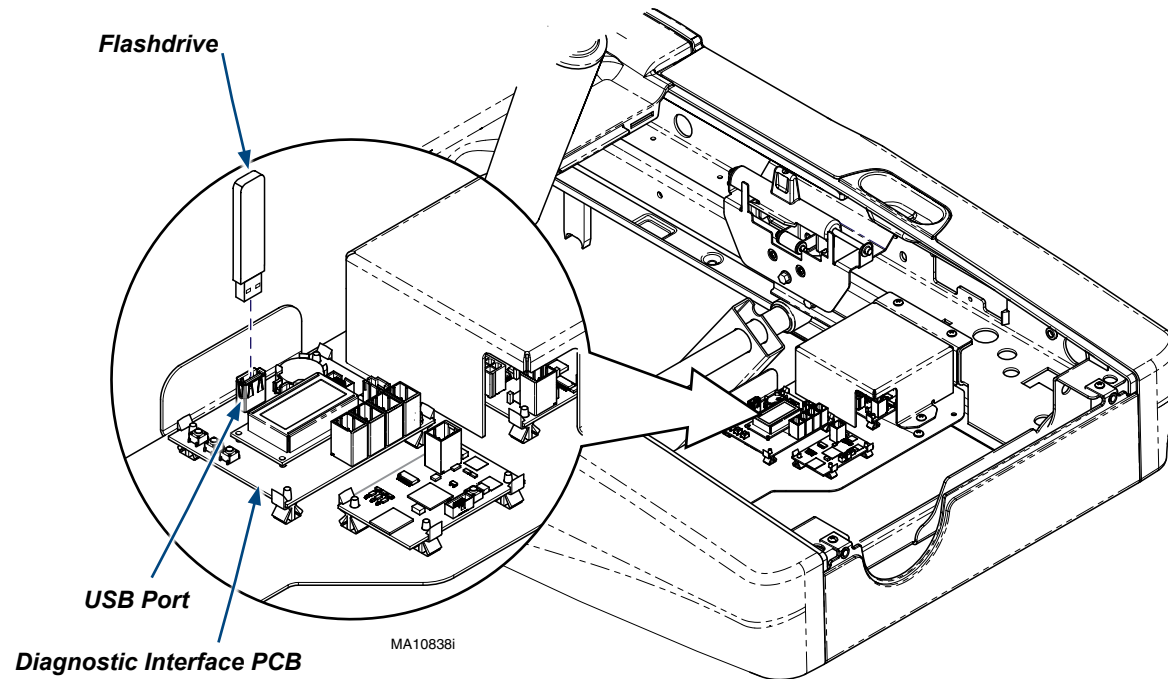

Chair Position Calibration Procedure

Step 1:

- A) Power up chair.
- B) Locate the Diagnostic PC Board.

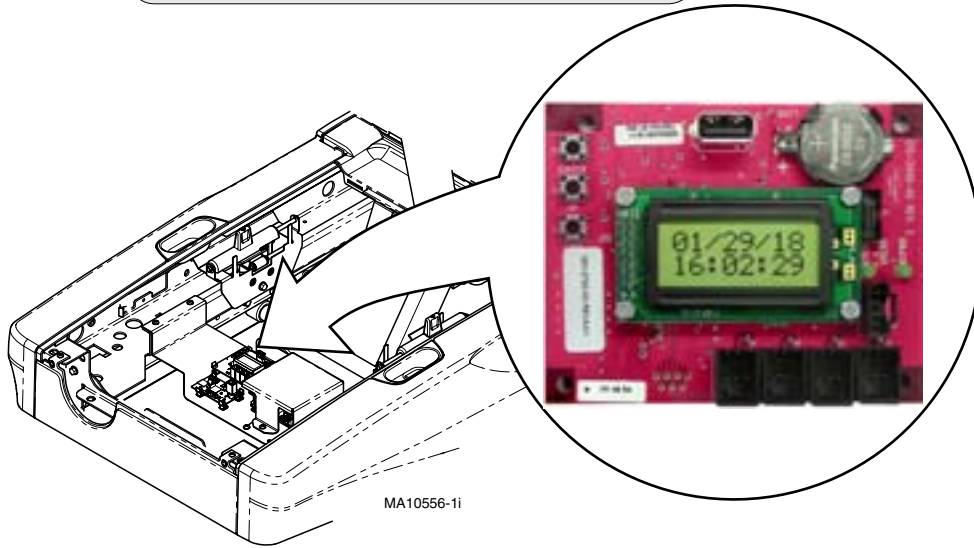

MA10556-1i

Step 2:

- A) Press and release the UP or DOWN button until "POSITION CALIBRAT(ion)" is displayed.

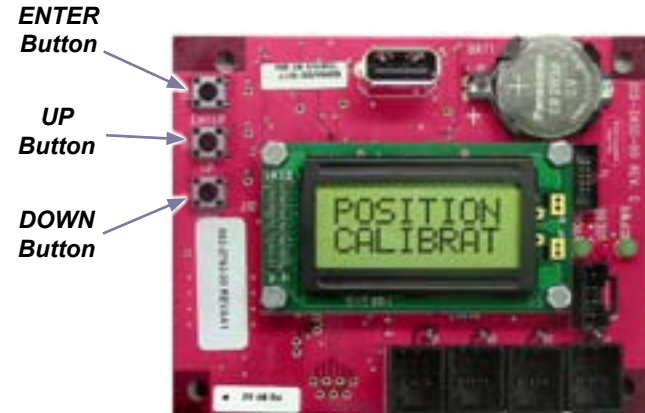

Step 3:

- A) Press ENTER button once. The display will show "CALIBRAT(ion) Start".
- B) Press ENTER button again. The chair base and back will start to cycle up & down and the display will show "CALIBRATING (Scrolling) POSITION".
- C) You will hear a steady pattern of "beeps". When calibration is completed you will hear three short beeps and the display will show "CALIBRAT COMPLETE".



Scale Calibration Procedure (If Equipped)

Step 1:

- A) Remove any load from the patient surface.
- B) Press and hold the Weight and Plus buttons until "CLEAR CHAIR" is displayed, then release buttons.



Step 2:

- A) Press and release the plus button.
- B) The display will say "ZEROING then "ADD 50 POUNDS".



Step 3:

- A) Place fifty pound calibrated weight on patient surface.
- B) Firmly press and release the plus button.
- C) The display will say "WAIT" then "DONE".

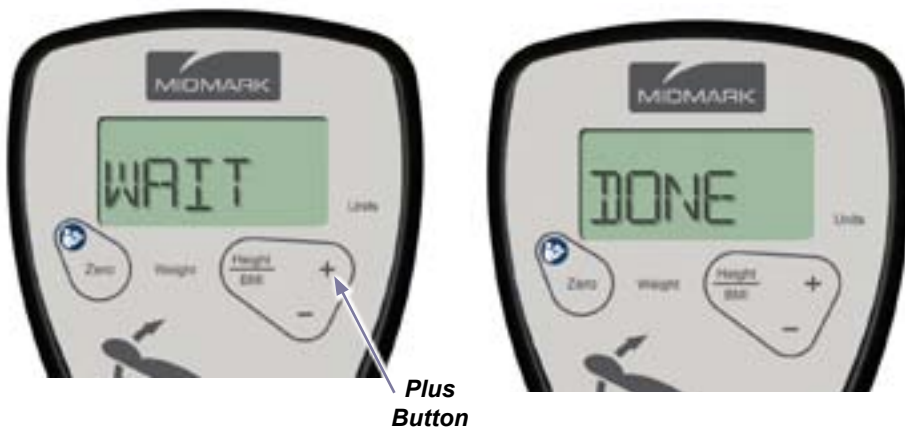

Step 4:

- A) **The display will go blank.**
- B) Firmly press and release the weight button. Note: "50.0 lbs" should be displayed.
- C) Remove calibrated weight.



Programmable 'Home' Function

The Home function automatically commands the chair to a programmed position. The Home function is factory preset to automatically raise or lower the chair height to 17 inches (43 cm) and raise the Back angle to 80 degrees.

To program the Home function...

- Press the Base Up / Down button to move the Base to the desired height.
- Press the Back Up / Down button to move the Back to the desired angle.
- Press the Stop button, then the Home button and hold simultaneously for three to four seconds.

Note: You will hear an audible tone when the new 'Home' position is saved.

Note

An audible tone will sound when the Home button is pressed to indicate auto-movement.

To activate the Home function...
Press & release the Home button.

Note: At any time, ANY button can be pressed to terminate movement.



Equipment Alert

Controllers must be within a Fifteen foot radius of chair to be able to command the chair.

Quick Exam® Function

The Quick Exam® function automatically commands the chair to a programmed position. The Quick Exam® function is factory preset to automatically raise or lower the chair height to 34 inches (86 cm) and raise the Back angle to 20 degrees.



To program the Quick Exam® function...

- Press the Base Up / Down button to move the Base to the desired height.
- Press the Back Up / Down button to move the Back to the desired angle.
- Press the Stop button, then the Quick Exam® button and hold simultaneously for three to four seconds.

Note: You will hear an audible tone when the new Quick Exam® position is saved.

To activate the Quick Exam® function...
Press & release the Quick Exam® button.

Note: At any time, ANY button can be pressed to terminate movement.

Note

An audible tone will sound when the Quick Exam® button is pressed to indicate auto-movement.

Troubleshooting the Update

There are a number of possible errors that can occur during the update. Reference the table below to find the solution.

Error Name	Probable Cause	Check	Solution
ERROR INI FILE MISSING	Problem with the USB flash drive.	Retry Firmware Update.	If problem persists after retrying, get a new USB flash drive.
ERROR NO LOADFILE			
ERROR SERIAL NUM MISSING			
ERROR SERIAL NUM DECODE			
ERROR SREC FILE MISSING			
ERROR SREC EOF MISSING			
ERROR USB DRIVE			
ERROR FILE NOT OPEN			
ERROR NOT FOUND IN LIST			
ERROR USB MSD REMOVED	Problem with the USB flash drive.	Retry Firmware Update	If problem persists after retrying, get a new USB flash drive. If problem persists with new USB flash drive, get a new Service Port PCB.
ERROR UART TRANSMIT	Problem with the Diagnostic Interface/Service Port PCB.	Retry Firmware Update	If problem persists after retrying, get a new Service Port PCB.
ERROR SERIAL NUM MISMATCH	Serial number does not match.	Verify USB flash drive serial number matches 626 serial number. Retry Firmware Update.	If serial numbers match, get a new USB flash drive. If serial numbers DO NOT MATCH, order the correct USB flash drive for the table.
ERROR VERSION MISMATCH	Problem with the USB flash drive or one of the table PCBs.	Retry Firmware Update three times.	If problem persists after three retries, observe the update process and determine which board fails the update process. Begin troubleshooting based on PCB Troubleshooting Steps (below). "081-0020" displayed 626 MOTOR CONTROL "081-0016" displayed SERVICE PORT PCB "081-0025" displayed WIRELESS BASE STATION PCB "081-0019" displayed SCALE AND VSM PCB "081-0015" displayed UPHOLSTERY HEATER PCB
UPDATE FAILED			
PCB Troubleshooting Steps	Affected PCB is not present in the table.	Verify affected PCB is not present in the table.	If the Firmware Upgrade fails due to a missing PCB, get a new USB flash drive and confirm its configuration matches the table (the table contains all boards it is supposed to contain)
	Affected PCB is present in the table but is missing hardware connections	Verify all hardware connectors are connected to the affected PCB	If Firmware Upgrade continues to fail, move to troubleshooting for "Affected PCB is not able to communicate"
	Affected PCB is not able to communicate	Using the Service Port menu, navigate to the "Display Versions" menu and verify the software version of the affected PCB is present in the list.	If the software version is present, get a new USB flash drive. If the software version is not present, get a new PCB.