



WARNING

To prevent risk of shock always disconnect power before removing covers or performing any service procedure.

Step 1: Remove Motor Switch Harness.

- A) Remove Screws, Nuts, and Lock Washers holding motor switch harness to motor bracket. Remove Insulators and Switch Actuator.
- B) Disconnect Spade Connectors, and Main PC Board Connector.

Step 2: Install Motor Switch Harness.

- A) Assemble Switch Actuator, Insulators and Motor Switch on to screws.
- B) Position Motor Switch as shown and insert screws through the Door Motor Frame. Secure with Lock Washers and Nuts.
- C) Connect Spade Connectors and Main PC Board Connector.

Note

Position Motor Switch with the actuator on the right hand side as shown.

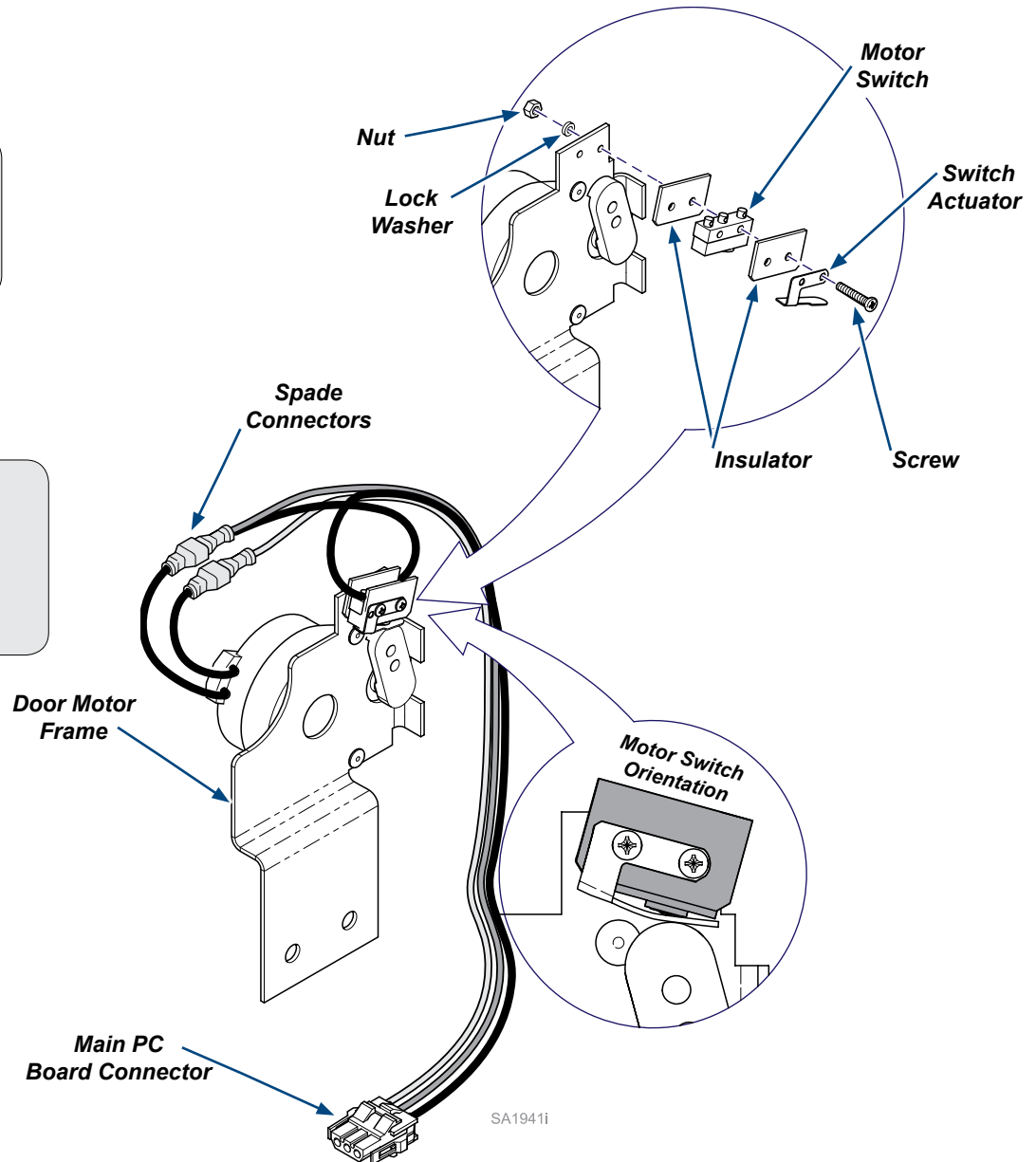

SA19411