

Gas Cylinder Kit [002-10380-0x]

Step 1:

In fully compressed position verify kit is correct by matching color on bottom of gas cylinder.

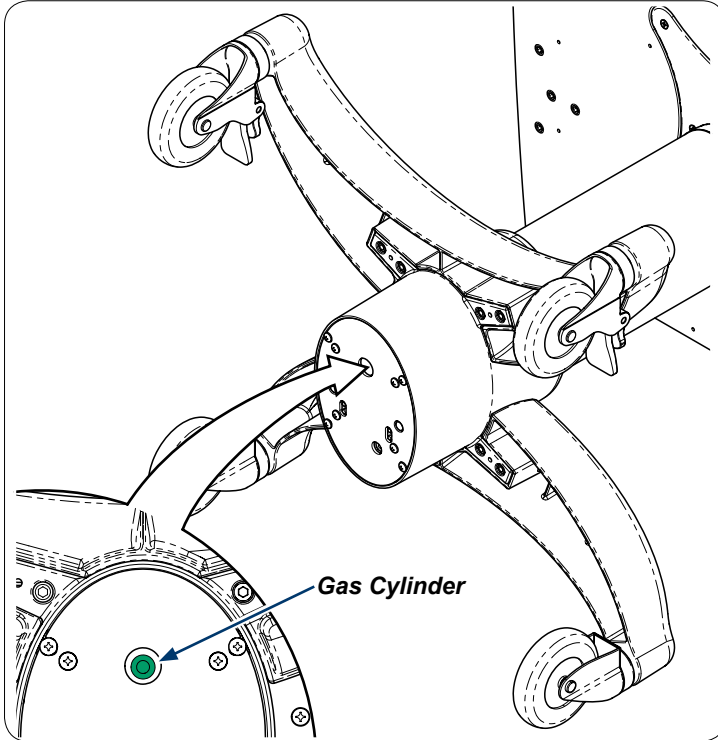

Step 3:

Remove screws (3) from hand actuator assembly to remove from worksurface or mouse tray.

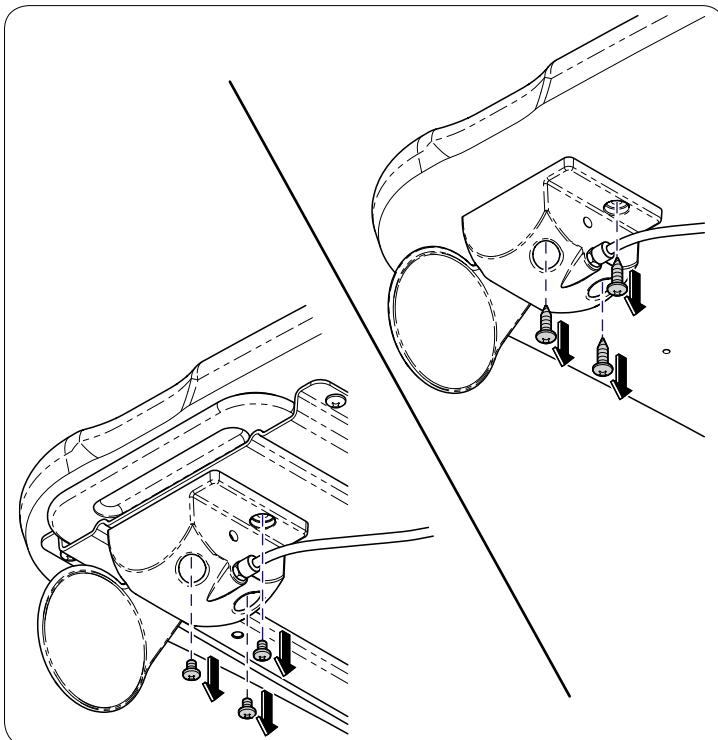

Step 2:



WARNING

Pressurized gas cylinder assembled in this workstation. Raise workstation to highest position before performing replacement to avoid injury.

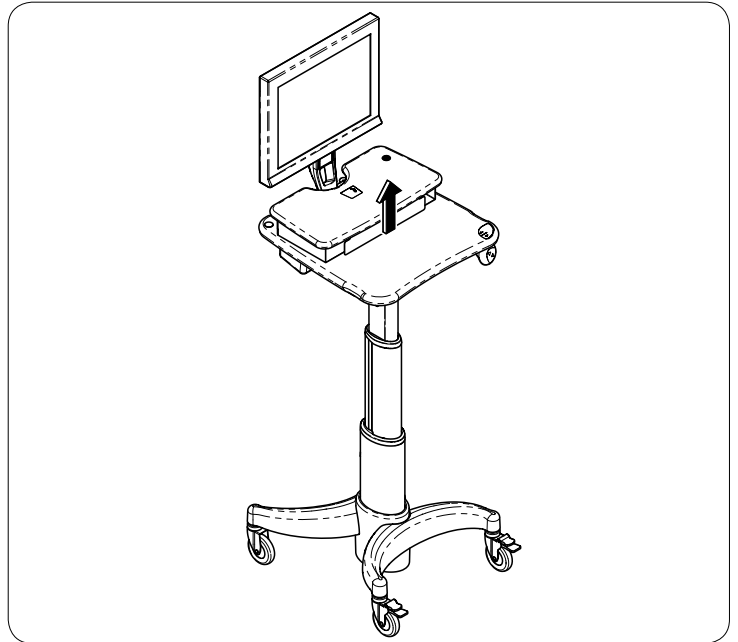

Step 4:

If necessary remove any accessories blocking access to mounting plate.

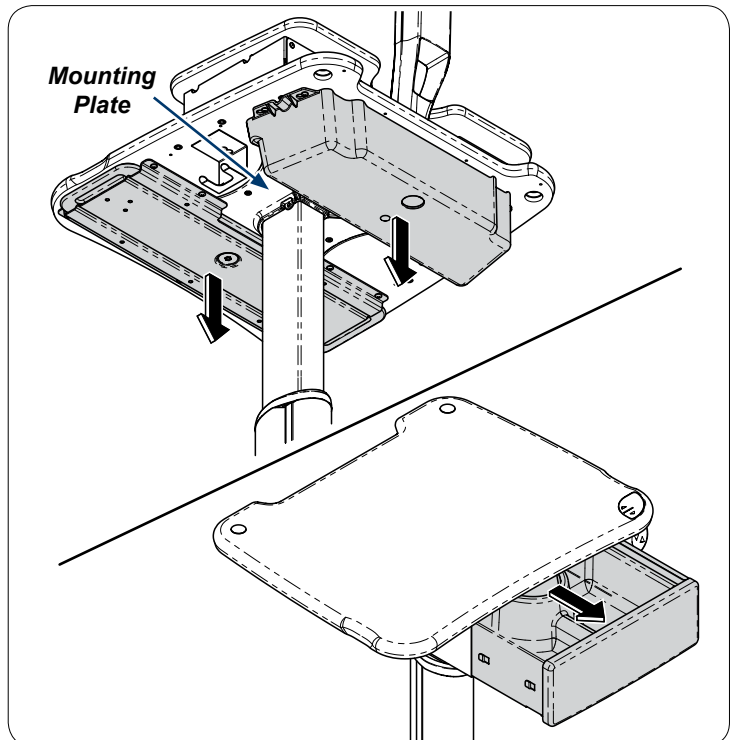

Step 5:

Remove screws (6) and worksurface from mounting plate.

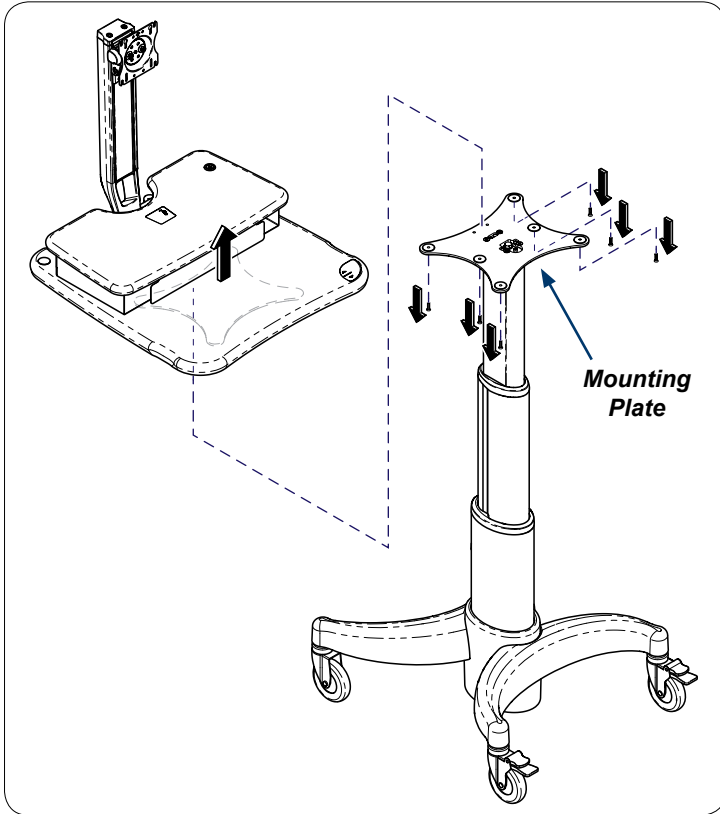

Step 6:

Remove bolt, washer and compression plate. Rotate current gas cylinder to remove from column.

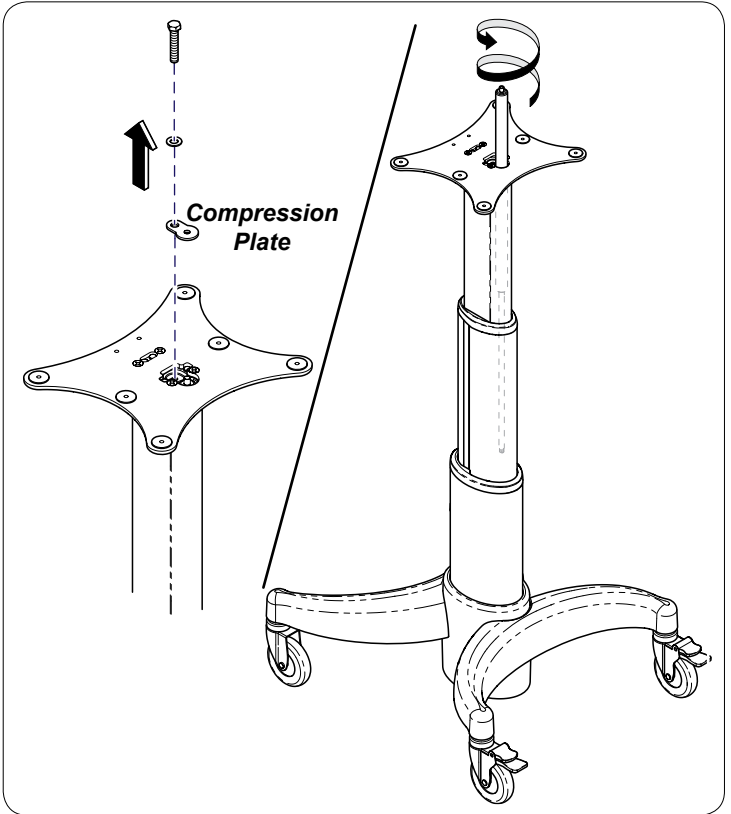

Step 7:

Rotate replacement gas cylinder into position in column and tighten. Secure by installing compression plate washer and bolt.

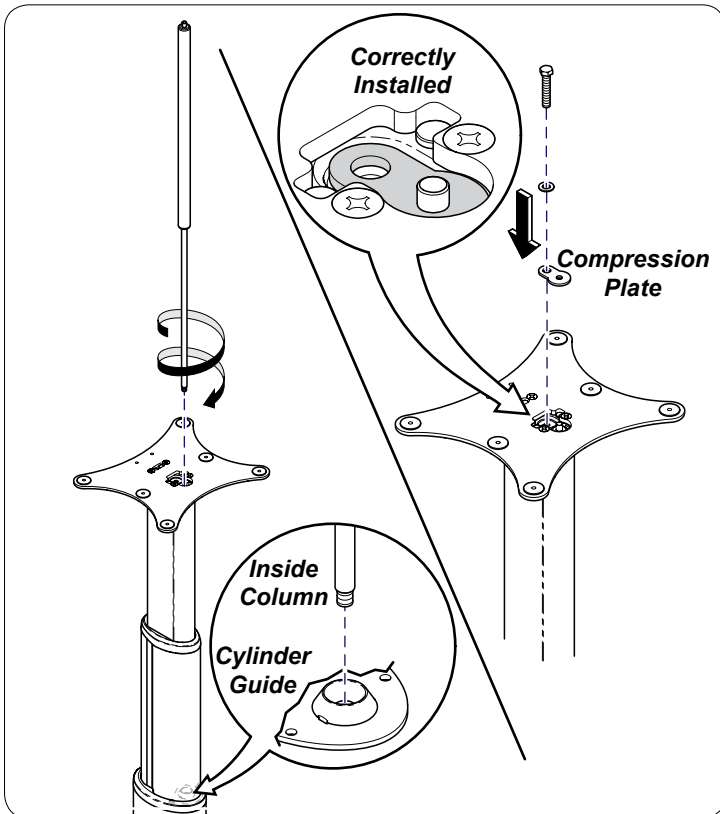

Step 8:

Secure and worksurface to mounting plate with screws (6).

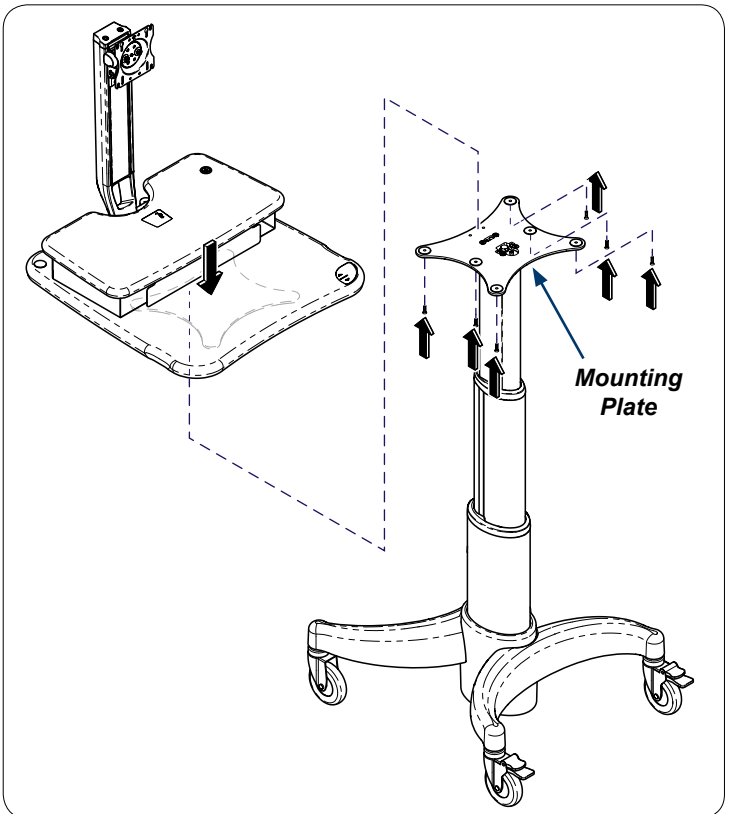

Step 9:

If accessories were removed secure as needed into position.

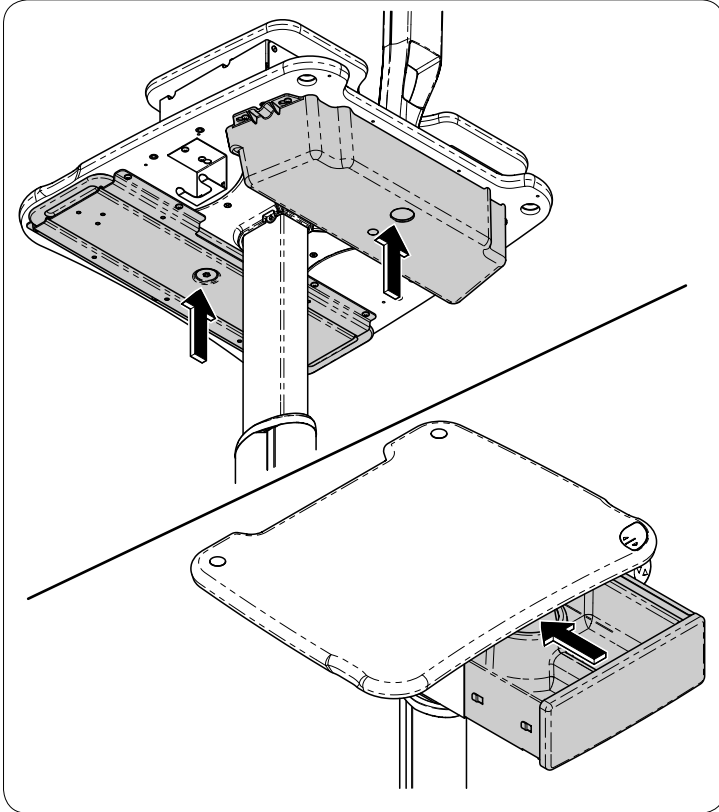

Step 10:

Secure hand actuator assembly to worksurface or mouse tray with screws (3).

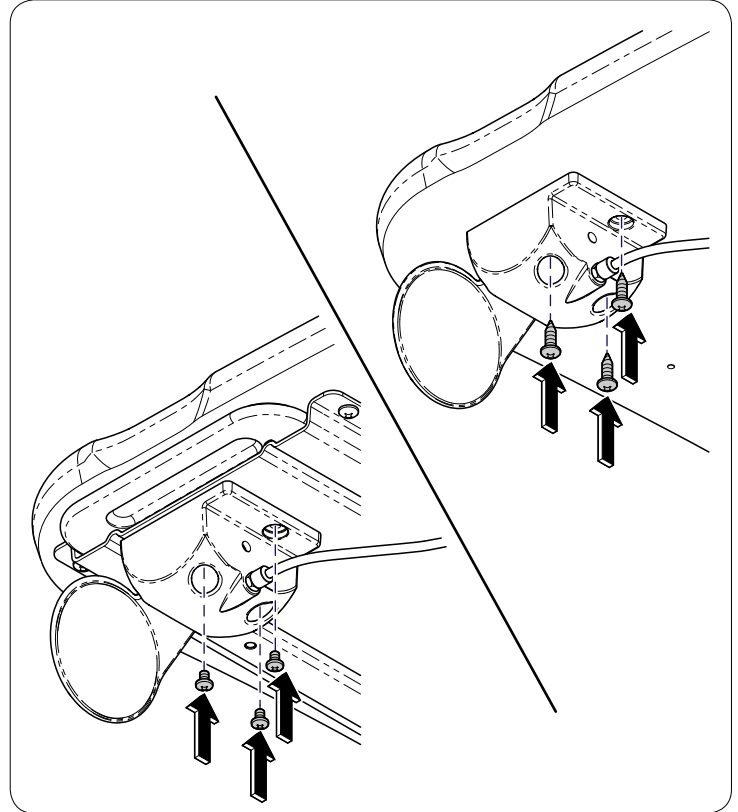

Step 11:

Before testing Workstation be sure all components are mounted. Press hand actuator paddle to adjust.

