

Installation Instructions

9A280001 354/355 Lighting System Single to Double Conversion Kit

Disassembly



DANGER

Always disconnect electrical power to the unit before removing any of the unit's covers/shrouds or making any repairs to prevent the possibility of electrical shock. Failure to comply with these instructions could result in severe personal injury or death.

1. Turn off facility power breaker so there *is no* power in customer supplied wiring.
2. Remove screw (1, Figure 1) and slide pivot sleeve cover (2) up out of way.
3. Disconnect two wires (3) from two wires (4).
4. While supporting cross tube / lighthead (5), remove two screws (6) and separate cross tube / lighthead from down tube (7).

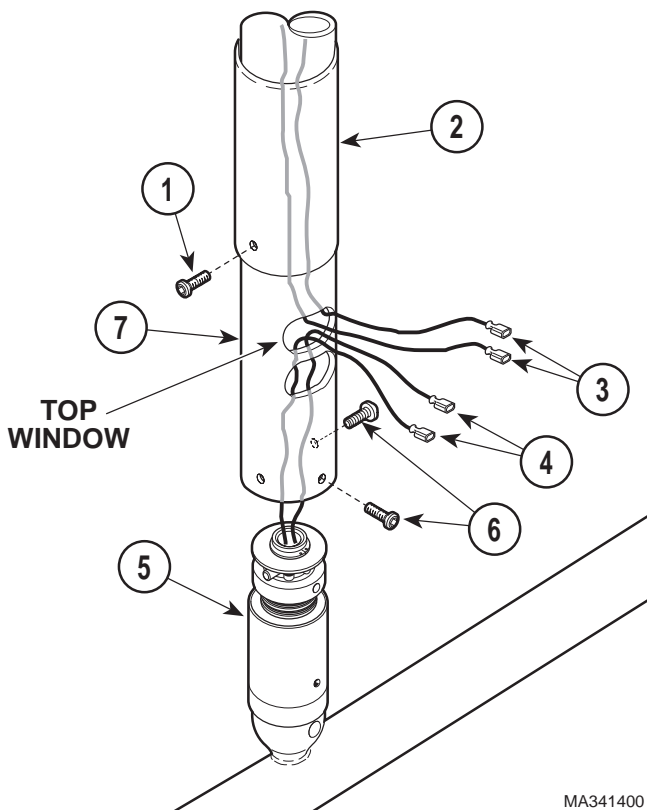

Figure 1. Cross Tube Removal

5. Remove four screws (1, Figure 2) and single ceiling cover (2). Slide single ceiling cover off of down tube (3). Discard single ceiling cover.
6. Loosen four screws (4) and then remove junction box cover (5) from junction box (6) by pulling outward.
7. Tag and disconnect two transformer output wires (7) from two wires (8).
8. Tag and disconnect all facility wires (9) from 5-position terminal block (10).
9. Remove three nuts (11), lockwashers (12), and down tube (3) from studs (13).
10. Remove three nuts (14) from studs (13).
11. Disconnect any conduit fitting attached to junction box.
12. Pull facility power wires (9) out of junction box.

NOTE

The recommended mounting system is shown. Your mounting system may be different.

13. Remove four nuts (1, Figure 3), lockwashers (2), and ceiling plate (3) from studs (4).

Remove Required Parts from the Ceiling Plate Assembly Not Being Used

1. Remove two screws (1, Figure 4) and transformer (2) from junction box (3).
2. Remove black jumper wire (4) between fuse holder (5) and terminal block (6).
3. Remove nut (7) and fuse holder (8) from junction box (3).
4. Remove three nuts (9), washers (10), and studs (11) from ceiling plate (12).
5. Discard junction box (3) and ceiling plate (12).

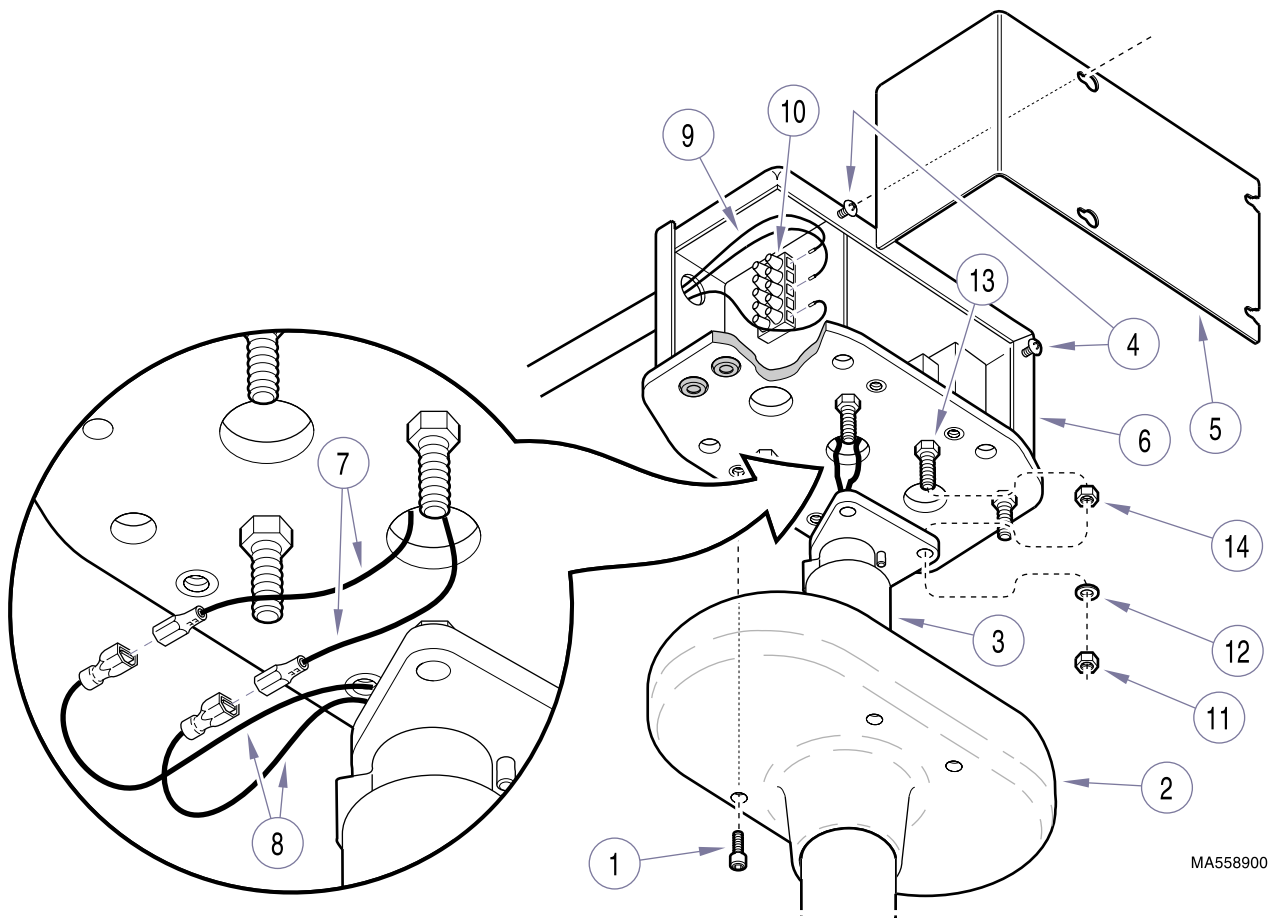

Figure 2. Transformer Wires Disconnection

Configure Ceiling Plate For Dual Lights

1. Look at ceiling plate (See Figure 4). Notice that there are three sets of hole patterns on the ceiling plate. On the single light system, the center hole pattern is used. On a dual light system, such as the one about to be assembled, the left and right hole patterns are used and the center hole pattern is left unused.
2. Install three studs (11) in remaining left or right unused holes and secure with three washers (10) and nuts (9).
3. Install second fuse holder (8) in junction box (3) and secure with nut (7) (supplied with fuse holder).
4. Install second transformer (2) in junction box (3) and secure with two screws (1).
5. Tag and disconnect all remaining wires from 5-position terminal block. Remove 5-position terminal block and terminal block label and discard.
6. Install 8-position terminal block (6) and label (13) onto junction box (3).
7. Connect black jumper wire to fuse holder (8). Connect both black jumper wires to terminal block (6) per wiring diagram (See Figure 5).
8. Connect transformer wires to terminal block (6) and fuse holders (5) and (8) per wiring diagram (See Figure 5).
9. Connect green / yellow ground wire to terminal block (6) per wiring diagram (See Figure 5).
10. Connect 4" (10 cm) long jumper wire to correct terminals of terminal block (6) per wiring diagram (See Figure 5).
11. Install dual light system per appropriate 354 or 355 Light System Installation Manual.

EQUIPMENT ALERT

When assembling a dual light system combination consisting of a model 354 mounted in combination with a model 355, special care must be taken to ensure that the proper junction box assembly is used for each. Failure to do so may result in a blown fuse and/or bulb. The transformer output voltage is different for the two models. The model 354 transformer is labeled with part number 015-1206-00 and the secondary leads are marked S1 and S2. The model 355 transformer is labeled part number 015-1356-00 and leads are not marked.

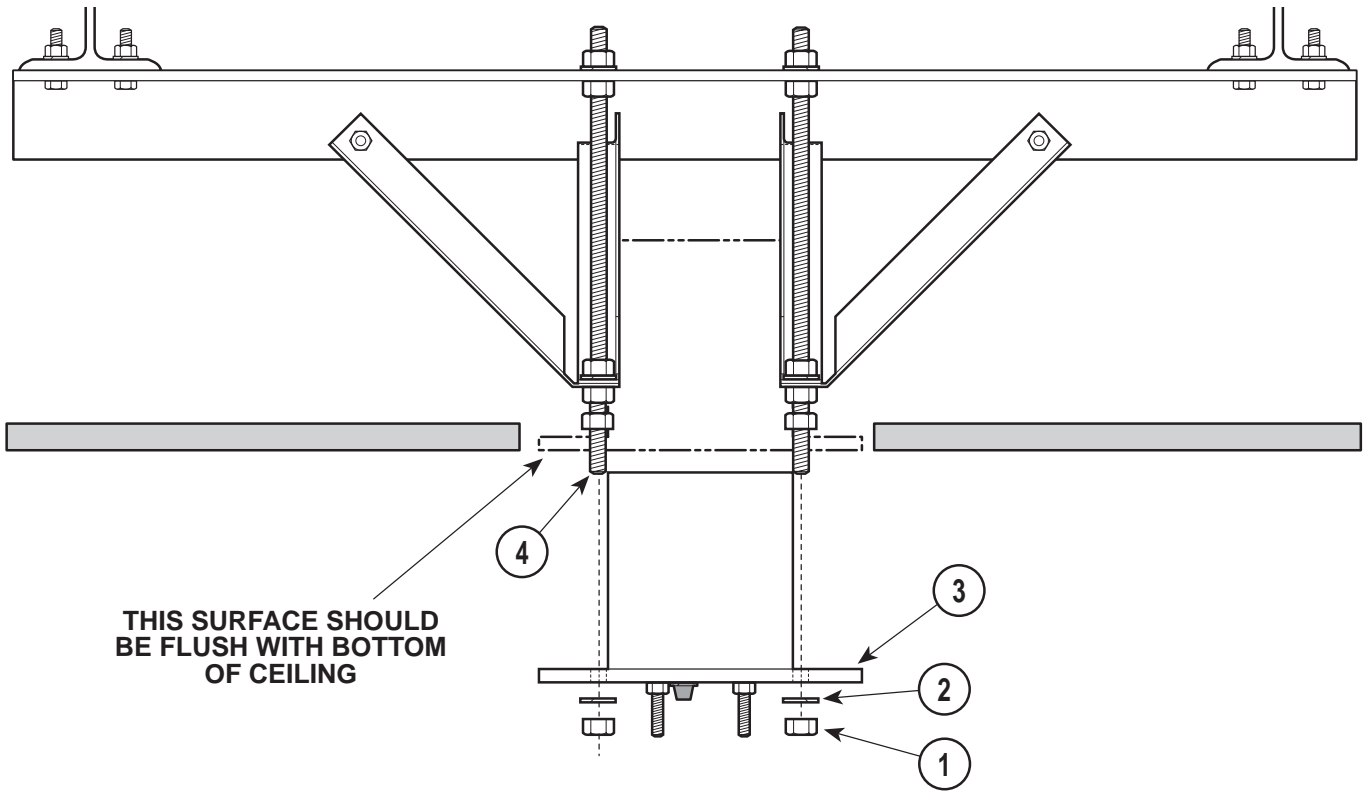

THIS SURFACE SHOULD BE FLUSH WITH BOTTOM OF CEILING

Figure 3. Ceiling Plate Removal

MA341600

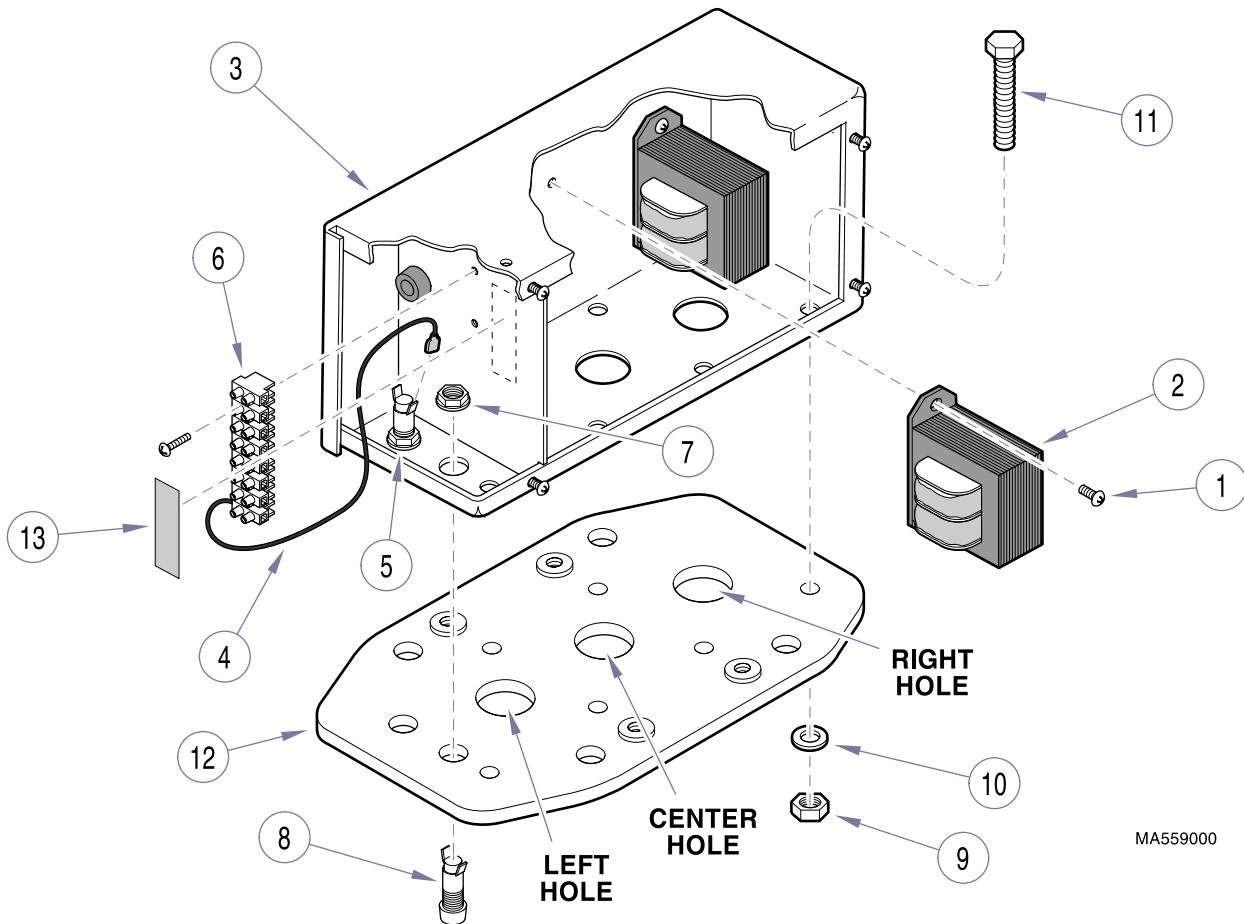

Figure 4. Assembling Double Ceiling Plate

MA559000

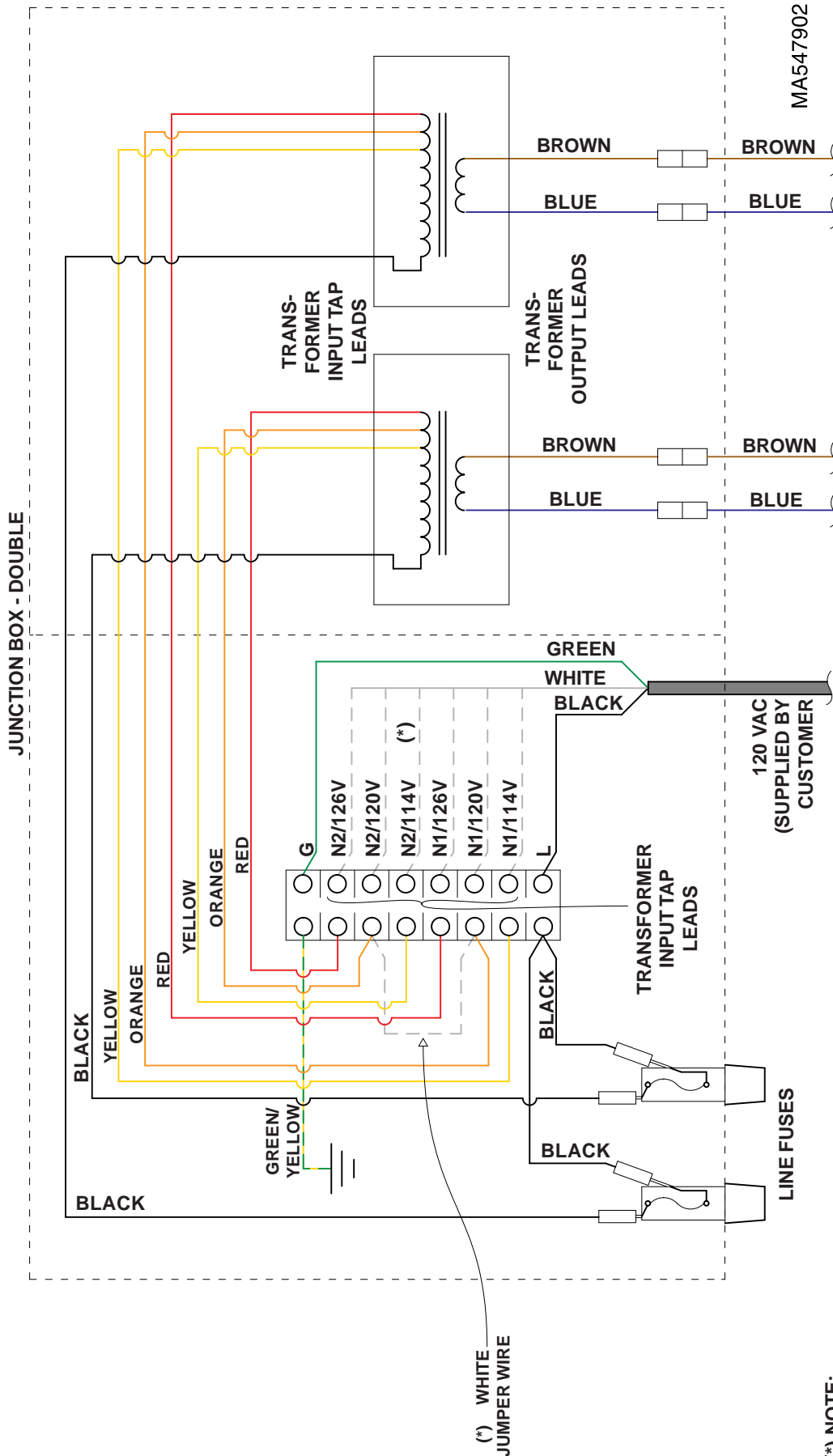

Figure 5. Wiring Diagram