

002-0668-0X (115 VAC) Power Cord Kit 002-0678-0X (230 VAC) Power Cord Kit For the Midmark Dental Chair

KIT COMPONENTS

Part Number	Description	Qty.
002-0668-00	Power Cord Kit (115 VAC)	
• 123108-00	Power Cord, 9 1/2 ft. (29 cm)	1
002-0668-01	Power Cord Kit (115 VAC)	
• 123108-02	Power Cord, 6 ft. (18 cm)	1
002-0678-00	Power Cord Kit (230 VAC)	
• 015-1510-00	Power Cord, 9 1/2 ft. (29 cm)	1
002-0678-01	Power Cord Kit (230 VAC)	
• 015-1510-02	Power Cord, 6 ft. (18 cm)	1
015-0590-03	Jumper Harness	1
003-1169-00	Installation Instructions.....	1

REQUIRED TOOLS

- 1/8" Allen Wrench
- Pliers
- Screwdriver (Standard blade and Phillips)
- VOM (for checking voltage)

GENERAL INFORMATION

Provides a kit for replacement of the power cord on a Midmark Dental Chair.

The 002-0668-0X Kits contains either a 9 1/2 ft. (2.9 m) cord or a 6 ft. (1.8 m) cord with plug for the 115 VAC chair.

The 002-0678-0X Kits for the 230 VAC chair also have either cord length as the above kits but the cords do not come with a plug. The plug must be provided by the installer.

All kits will have the jumper harness for the main control p.c. board included. It must be installed after the power cord has been routed to the main control p.c. board thru the access hole in the support located on the hydraulic chassis.

INSTALLATION (1)

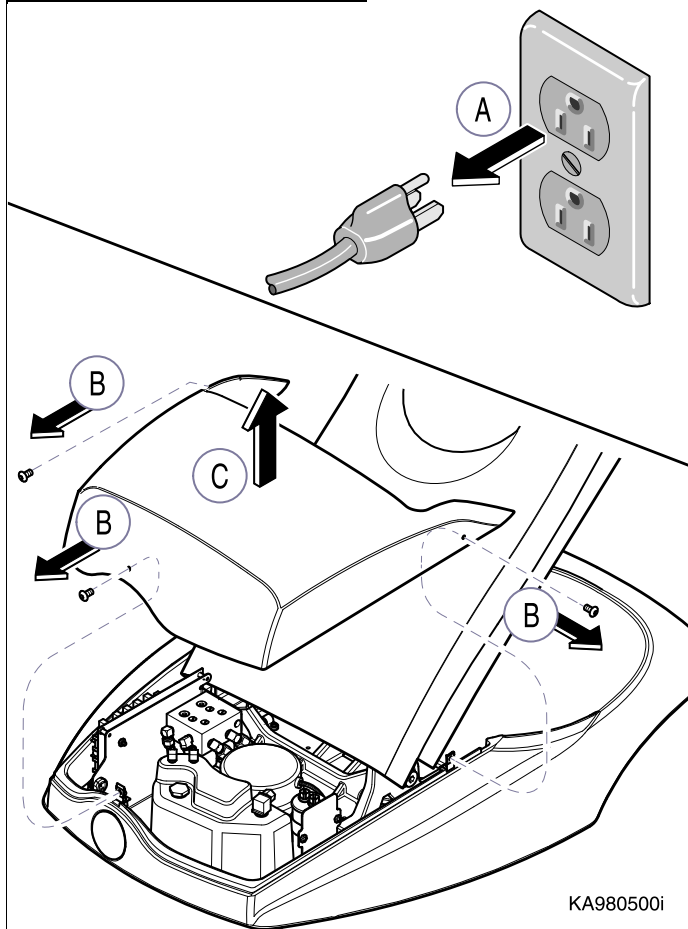

DANGER
Unplug chair from electrical outlet. Failure to comply could result in serious injury or death.

- A. Unplug Chair from outlet or disconnect supply power at source.
- B. Remove three screws on hydraulic cover.
- C. Remove cover.

INSTALLATION (2)

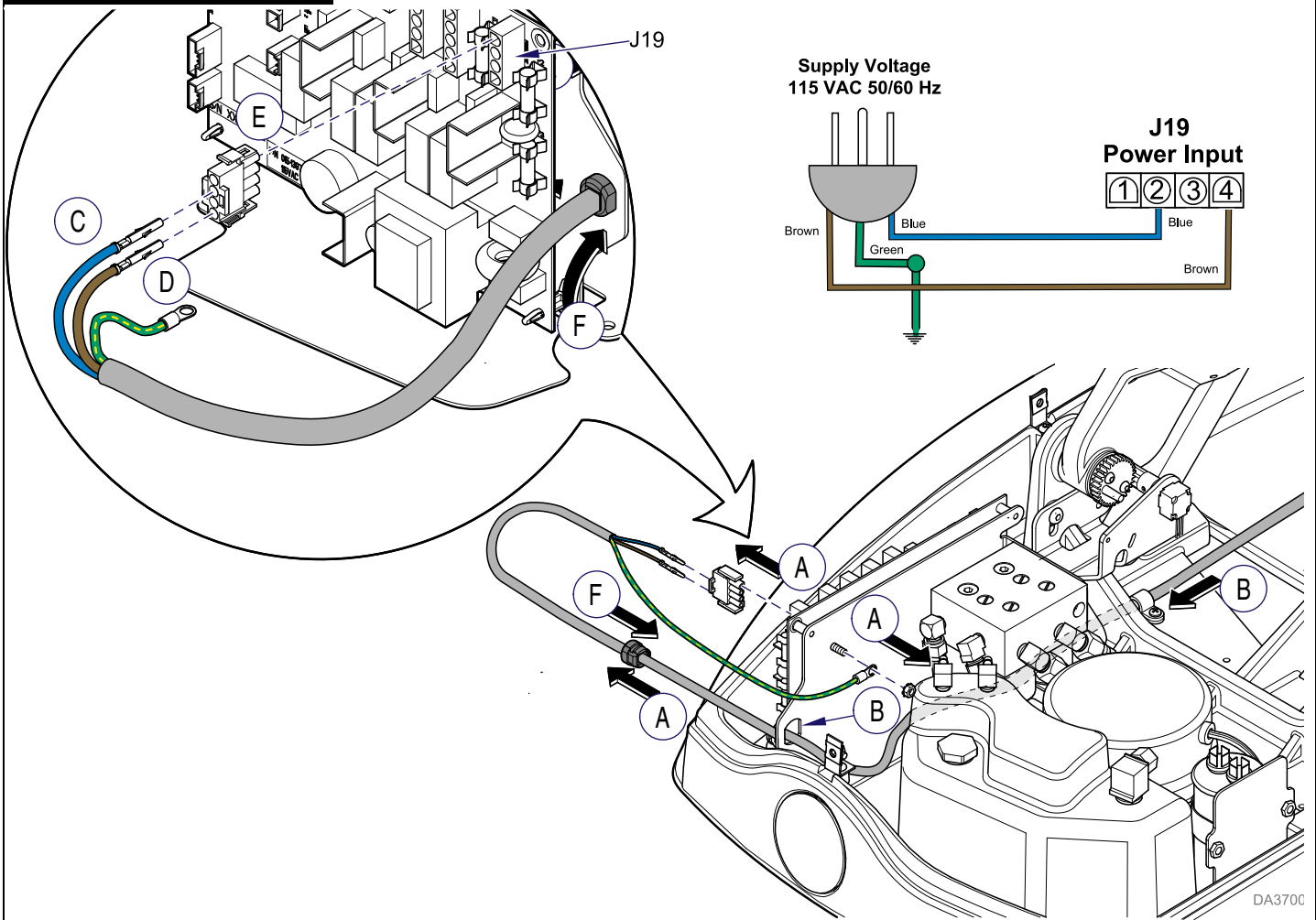

NOTE

After removing existing power cord from the chair do **not** discard cord restraint as it will be used with replacement power cord. It will be necessary to cut the jumper harness from existing cord in order to remove cord.

- A. Remove existing power cord, cord restraint, and jumper harness.
- B. Route new cord from the back of the chair base, under the hydraulic valve block assembly, and through access hole, in the support.



EQUIPMENT ALERT

Assure the leads from power cord are located correctly in jumper harness. Failure to correctly install the leads could damage the main control PC board and possibly other components on the chair.

- C. Insert Blue lead into the jumper harness socket next to the Green ground lead.
- D. Insert Brown lead into the end socket of the jumper harness.
- E. Connect jumper harness to plug connect J19 on the main control p.c. board and connect ground leads from power cord and jumper harness to the ground terminal.
- F. Install cord restraint.



CAUTION

Using caution to prevent electrical shock, plug chair into outlet and check operation. Unplug chair, install hydraulic cover, and then plug chair into outlet.

MIDMARK®

Midmark Corporation, 60 Vista Drive, P.O. Box 286, Versailles, Ohio 45380-0286
Phone: 1-937-526-3662 Fax: 1-877-249-1793 midmark.com

003-1169-00 Rev. B (10/12)