

# Foot Control Installation Guide

### FOOT CONTROL INSTALLATION

**(1)** Depress BASE UP button (A, Figure 1) on touch pad (1) [located on side of chair] to raise chair as high as it will go.



#### WARNING!

Always disconnect power cord before removing shrouds or covers. Failure to comply could result in serious personal injury or death.

**(2)** Unplug power cord from outlet.

**(3)** Remove three screws (2) and hydraulic cover (3).

**(4)** Route foot control cord (4) under back of chair; then secure restraint bracket (5) to chair base using screw (6).

**(5)** Plug foot control cord (4) into J1 connector (B) on PC board (7).

**(6)** Plug power cord into outlet and check for proper operation.

**(7)** Replace hydraulic cover (3) and secure with three screws (2).

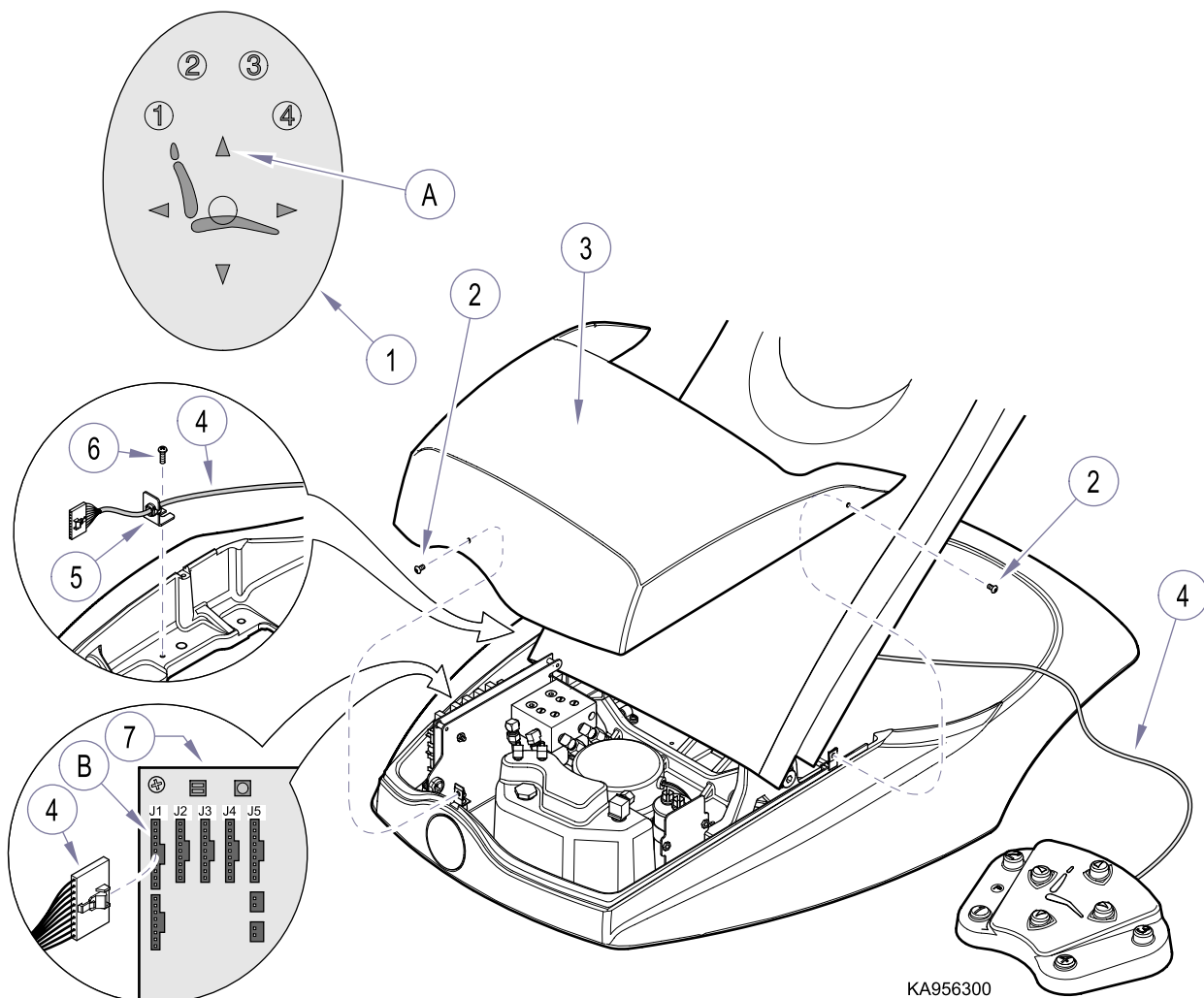

Figure 1. Foot Control Installation