

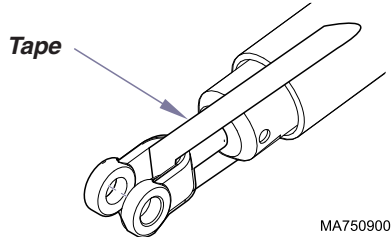

Back Actuator Kit [002-0795-00]

- Components:**
 Back Actuator 1
 Ground Wire 1
 Set Screws 2
 Ground Screw 1
- Special Tools:**
 none



Equipment Alert
 Do not remove tape from new actuator until instructed to do so. Failure to comply will allow the actuator shaft to rotate, resulting in misalignment of the internal limit switches.

MA750900i

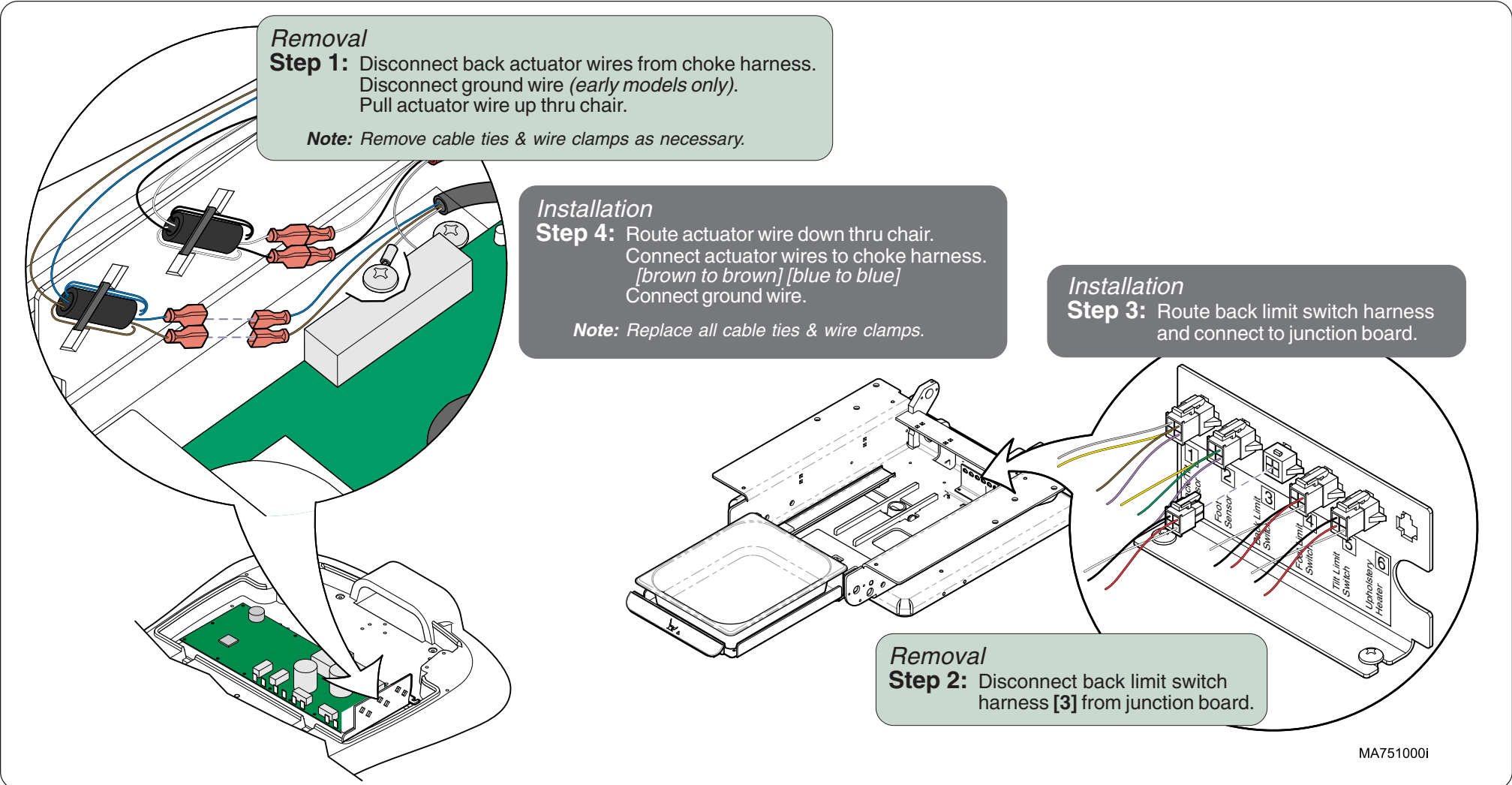

MA751000i

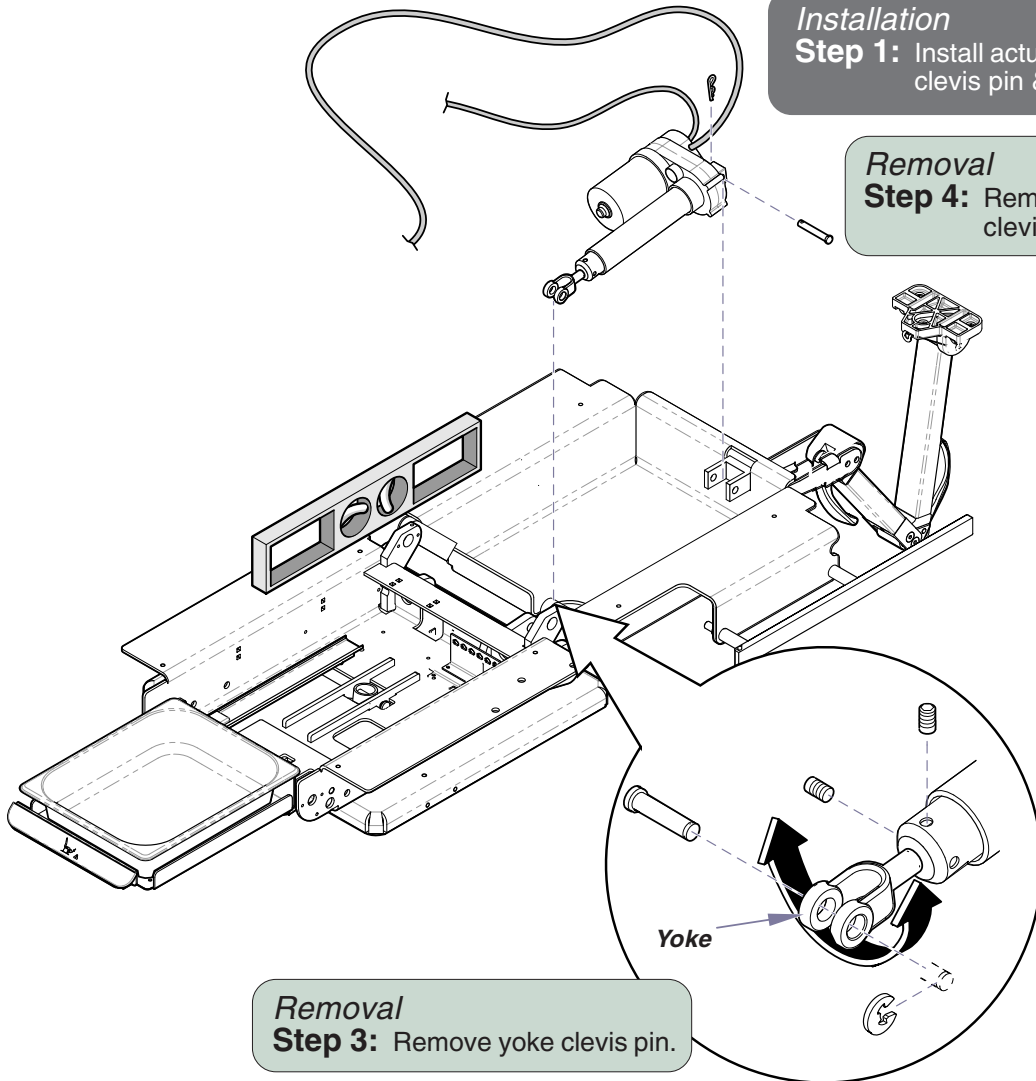

Installation
Step 1: Install actuator, base clevis pin & cotter pin.

Removal
Step 4: Remove base clevis pin & actuator.

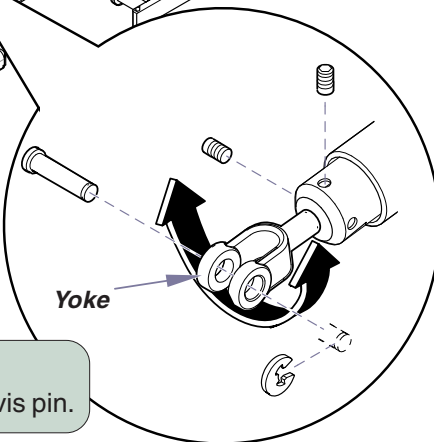

Removal
Step 3: Remove yoke clevis pin.

Equipment Alert
 Carefully remove tape from actuator yoke. **Do not rotate the actuator shaft!** Rotate yoke only enough to align holes.

Installation
Step 2: Level back & seat weldments. Rotate yoke to align holes. Install yoke clevis pin & clip ring. Install two set screws.

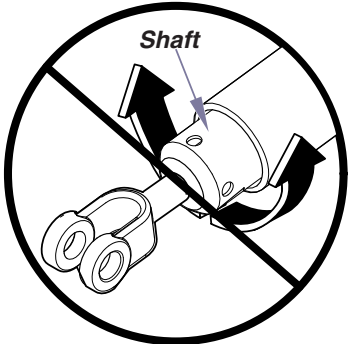

Grounding Instructions

Models w/ Grounding Plate:
 To ensure proper ground, the metal braided insulation on the actuator wires must be in direct contact with the grounding plate.

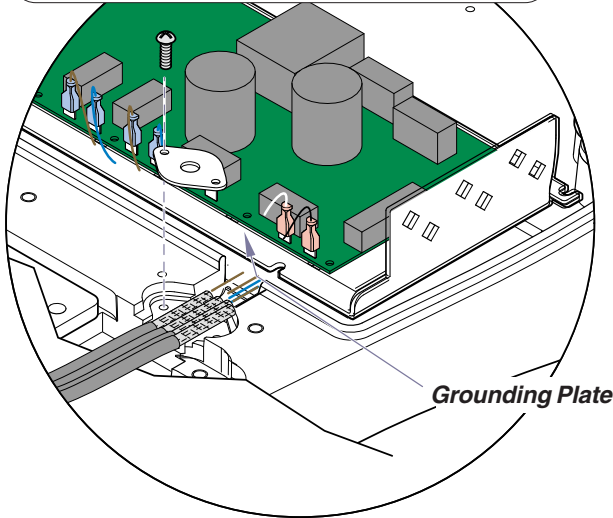

Models w/o Grounding Plate:
 Push back the metal braided insulation on actuator wires. Connect the ground wire (provided) as shown. Connect ground wire to base casting w/screw (provided).

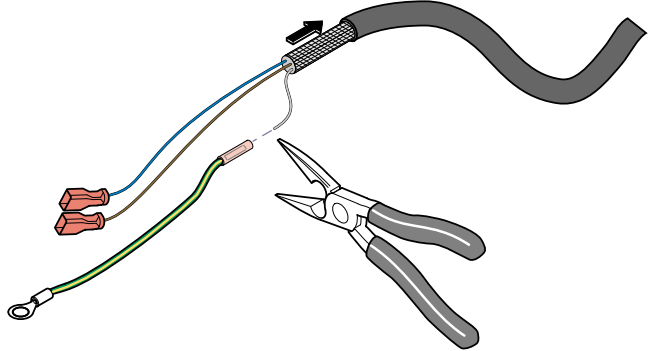

MA7511001