



Upper Glide Replacement Kit [002-0864-00]

Components:
Upper Glide 2

Special Tools:
none

Note: If possible, lower the base before removing shrouds. This will prevent the shrouds from falling when the outer shrouds are removed.

Midmark models only
Removal
Step 1: Remove three magnetic covers.

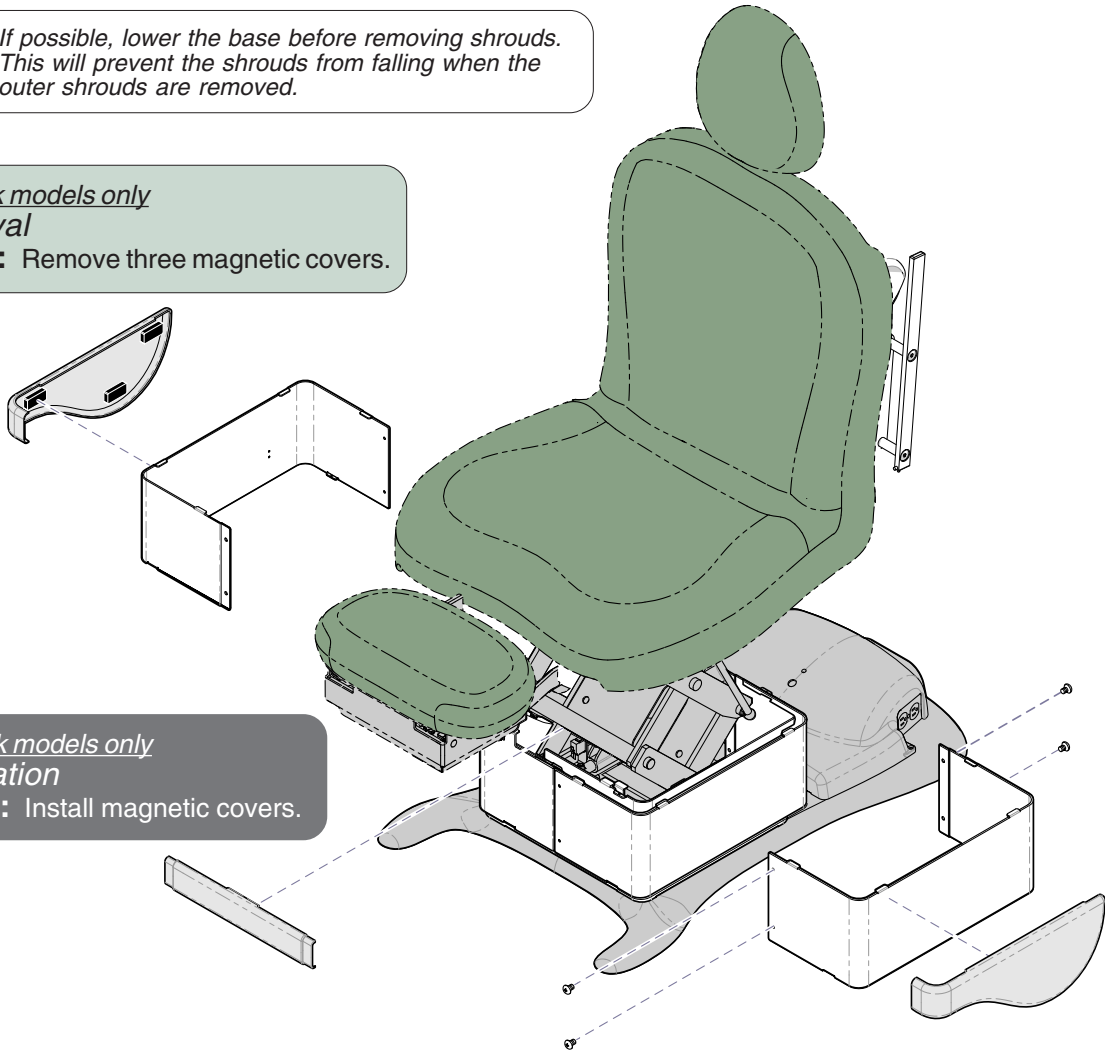

Midmark models only
Installation
Step 4: Install magnetic covers.

Removal
Step 2: Remove screws from outer shrouds *only*. Pull shrouds outward to disengage tabs.

Installation
Step 3: Position outer shrouds. Secure with screws at both ends.
Note: Insert shroud tabs into seat weldment slots.

MA684100i

Installation

Step 2: Secure two guide bars with four screws.

Removal

Step 3: Remove two screws from guide bar. Repeat on opposite side.

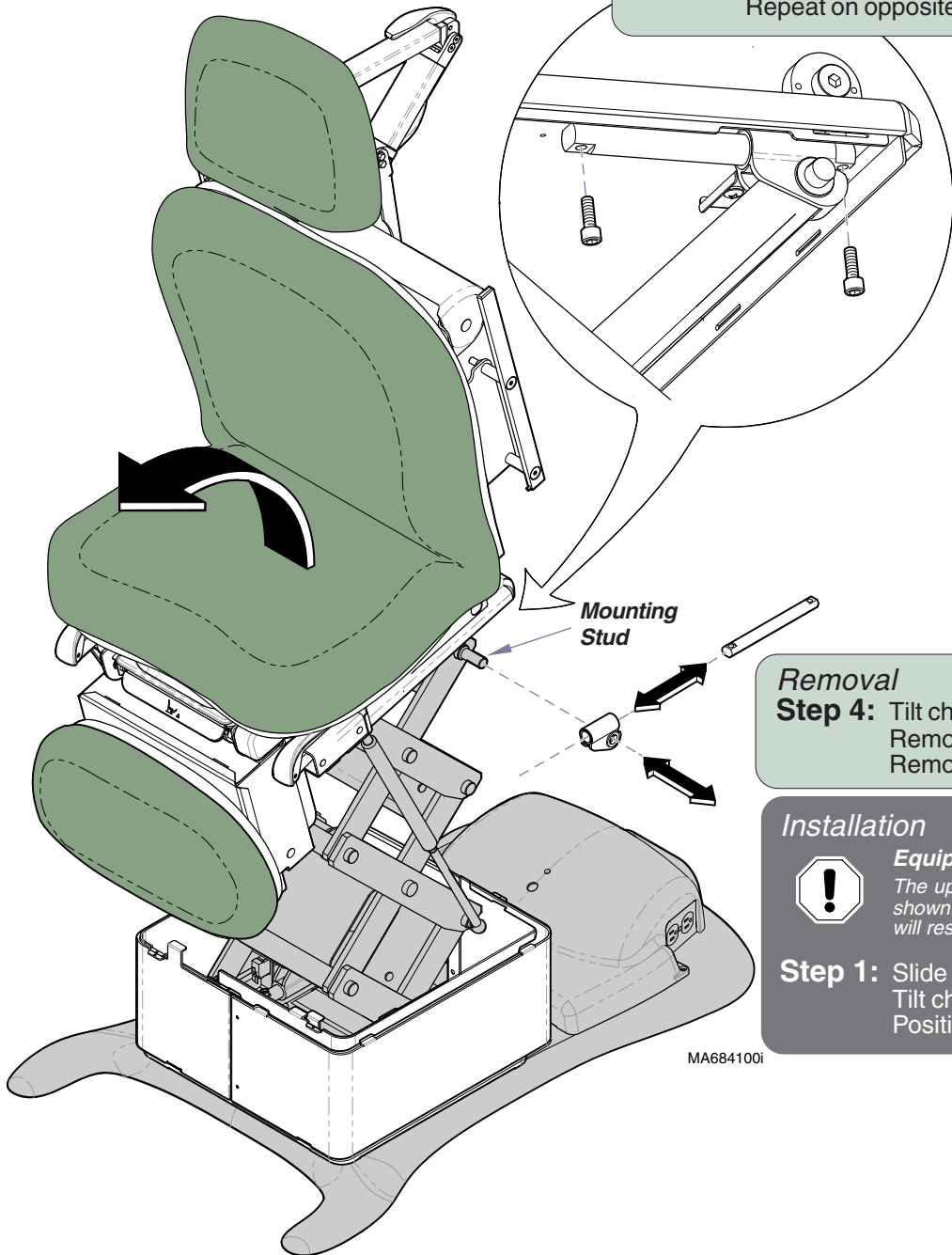

Removal
Step 4: Tilt chair top slightly (*toward foot end*). Remove two guide bars. Remove two upper glides.

Installation
Equipment Alert
The upper glide must be positioned as shown. Installing the glide backwards will result in damage to the chair.
Step 1: Slide guide bar thru upper glide. Tilt chair top slightly (*toward foot end*). Position upper glide on mounting stud.

MA684100i