



# Ultra Series Chairs Back Replacement Kits

## UltraTrim® Back Kits

- 002-0892-00-xxx-xxx - Thermoform
- 002-0892-01-xxx-xxx - UltraLeather
- 002-0892-02-xxx-xxx - Seamless UltraLeather
- 002-0892-03-xxx-xxx - UltraLeather Promessa
- 002-0892-04-xxx-xxx - Seamless Promessa

## UltraComfort® Back Kits

- 002-1930-00-xxx-xxx - UltraComfort®
- 002-1930-01-xxx-xxx - UltraLeather
- 002-1930-02-xxx-xxx - Seamless UltraLeather

## Components:

- Back Assembly ..... 1
- Back Upholstery ..... 1
- Shoulder Bolts (1/2" x 3/4") .... 2
- Shoulder Bolts (Painted) ..... 2
- Joint Connector Bolts ..... 2

## Special Tools:

none



### Caution

Unplug the chair power cord before removing any parts.

### Note

Use these instructions to switch from an UltraTrim® to UltraComfort® style back or vice versa.

Upholstered Back

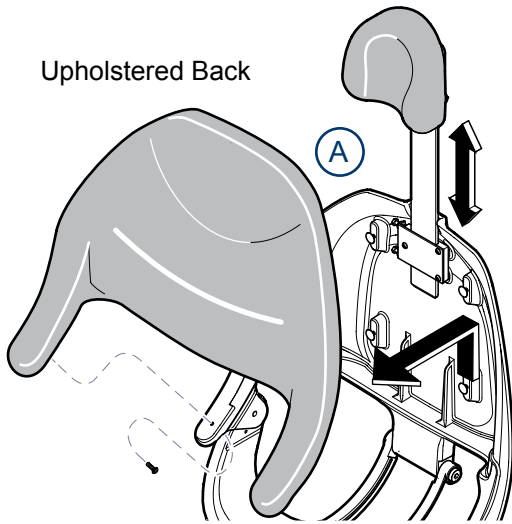

### Remove upholstery and back assembly...

- A) Raise headrest. Remove two screws and lift up to remove upholstered back.
  - B) Remove mounting screw, unplug the pin connector, then remove the touchpad.
- Note: Observe the orientation of the plug to pin connector on the touchpad so that you can reconnect it.
- C) Remove shoulder bolts and bearings from links that attach to the back casting and remove assembly. Keep the spacer(s).
  - D) Remove shoulder bolts from yoke castings. Keep the washer.

UltraComfort® Back

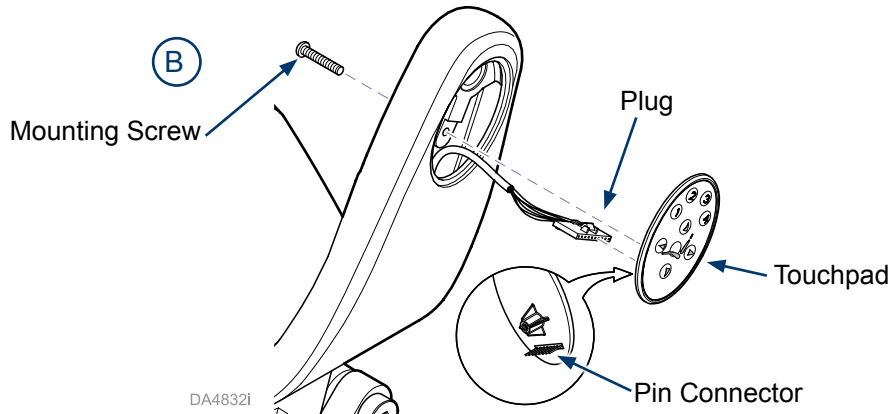
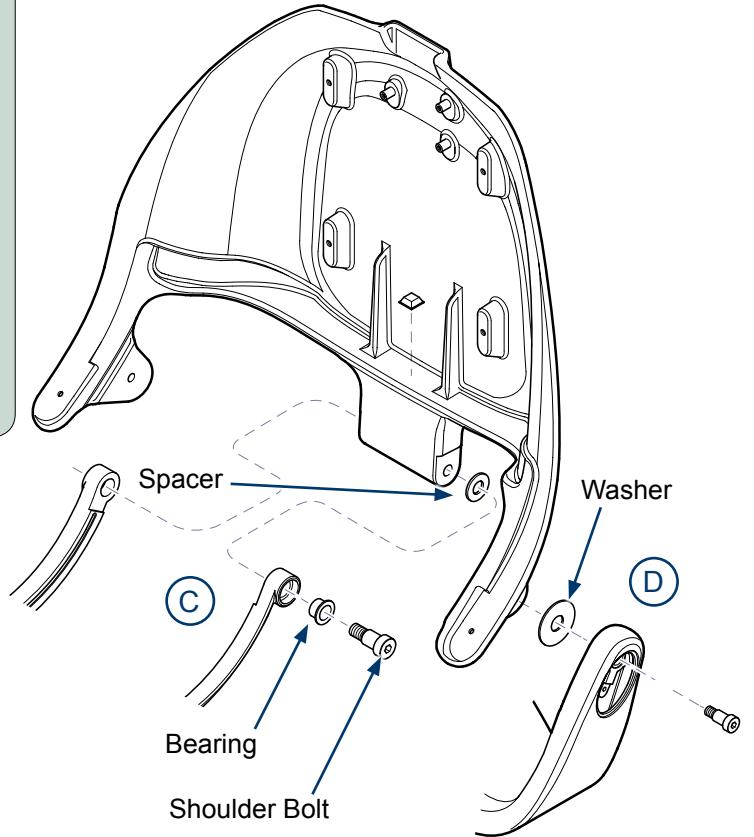

DA4832i

## UltraTrim® Back

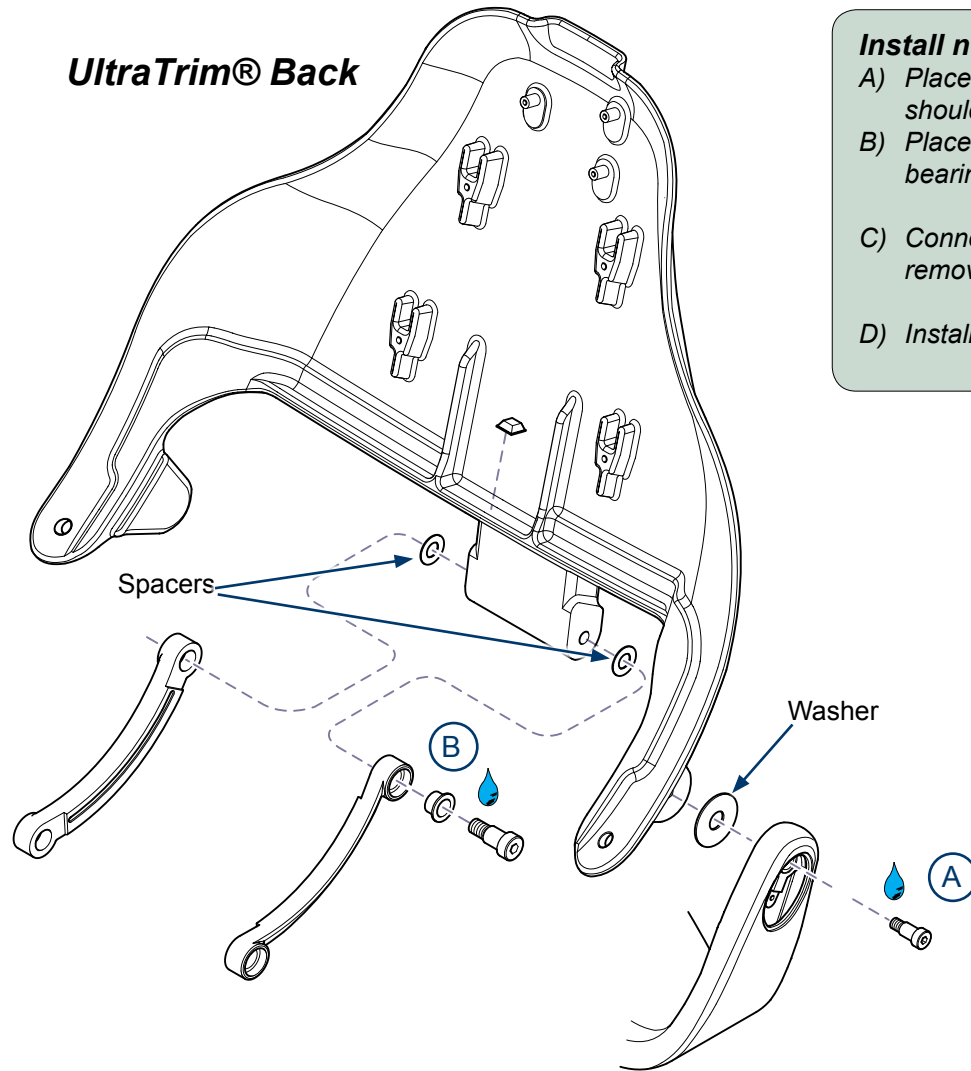

### Install new upholstery and back assembly...

- A) Place non-permanent threadlock on shoulder bolts. Position washers and install shoulder bolts. Torque bolts to 33 ft-lbs (45 N.m).
- B) Place non-permanent threadlock on shoulder bolts. Position spacers and install bearings and shoulder bolts. Torque bolts to 55 ft-lbs (75 N.m).
- C) Connect the plug to touchpad pin connector, oriented the same as when you removed it. Position touchpad and install mounting screw.
- D) Install upholstered back. (Reference page 1).

