

For models:
 All Midmark 3" Casework
 All Ritter 3" Casework

OVERHEAD UNITS

Installation
Step 1: Attach all cabinets together and temporarily hang in place so filler panel size can be determine.

Installation
Step 3: Cut filler panels to size and attach to brackets with #10 x 1/2" wood screws provided.

Note
 May need to cut filler panels to fit space (See Step 3).

Note
 If filler panels will be attached to left side of unit, nutserts will need to be installed into the connector holes. (Special nutsert installation tool necessary, contact Midmark for information.)

Installation
Step 2: Remove end cabinet(s) and position so access is available to side of unit. Attach brackets to side using Midmark fasteners into connector holes. (For left hand filler, see note below.)

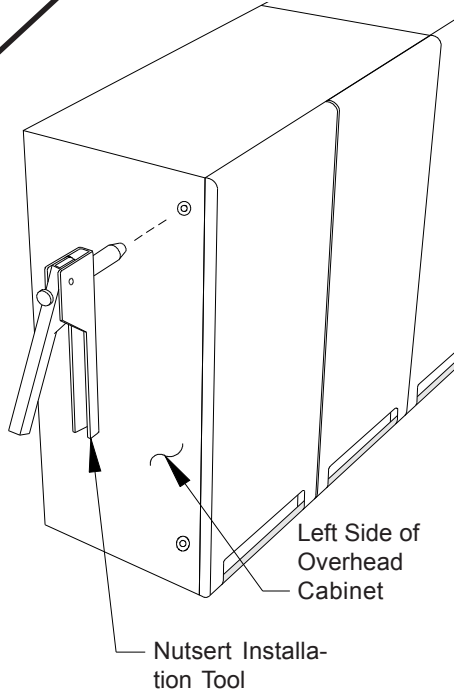
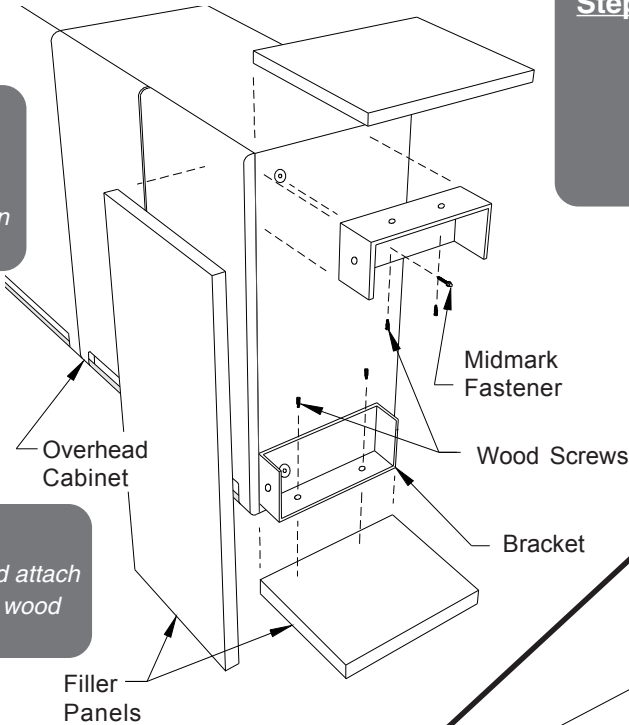

BASE UNITS

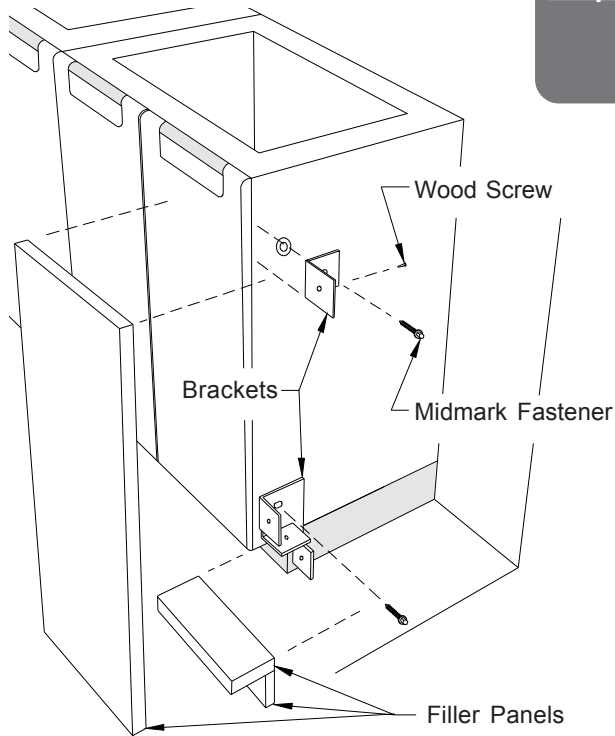

Installation

Step 1: Attach all cabinets together and temporarily position in place so filler panel size can be determine.

Installation

Step 2: Position cabinets so access is available to side of unit. Attach brackets to side of base cabinet using Midmark fasteners into connector holes. (For left hand filler, see note below.)

Note

May need to cut filler panels to fit space (See Step 3).

Installation

Step 3: Cut filler panels to size and attach to brackets with #10 x 1/2" wood screws provided.

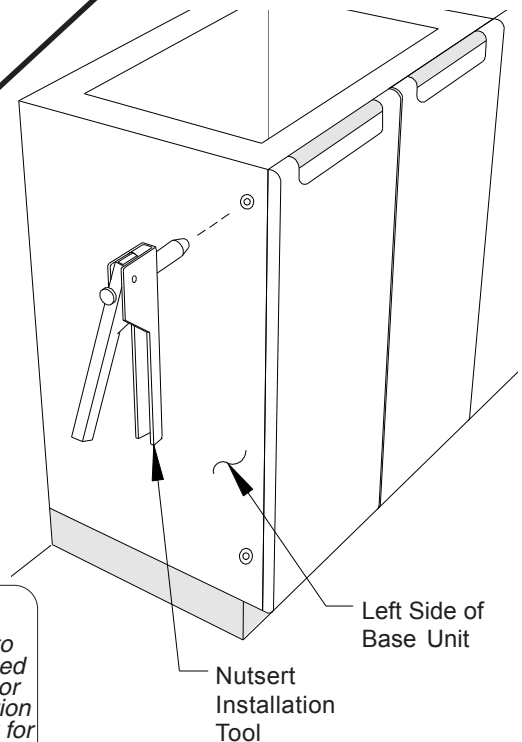

Note

If filler panels will be attached to left side of unit, nutserts will need to be installed into the connector holes. (Special nutsert installation tool necessary, contact Midmark for information.)