

Armrest Installation

151236-00 RH Armrest
151235-00 LH Armrest

Step 1: After turning set screw outward, insert armrest in pivot post.

Note: There is a left and right hand armrest. The armrest is in the proper position when the notch above the slot is located toward the outside of the chair.

Step 2: Position the armrest parallel to the side of the chair, until the slot in the shaft locks into position on the locating pin.

Step 3: Turn the set screw in until it is tight and then back it out 1/4 turn.

Note: This adjustment allows the armrest to be lifted and rotated but prevents complete removal of the armrest.

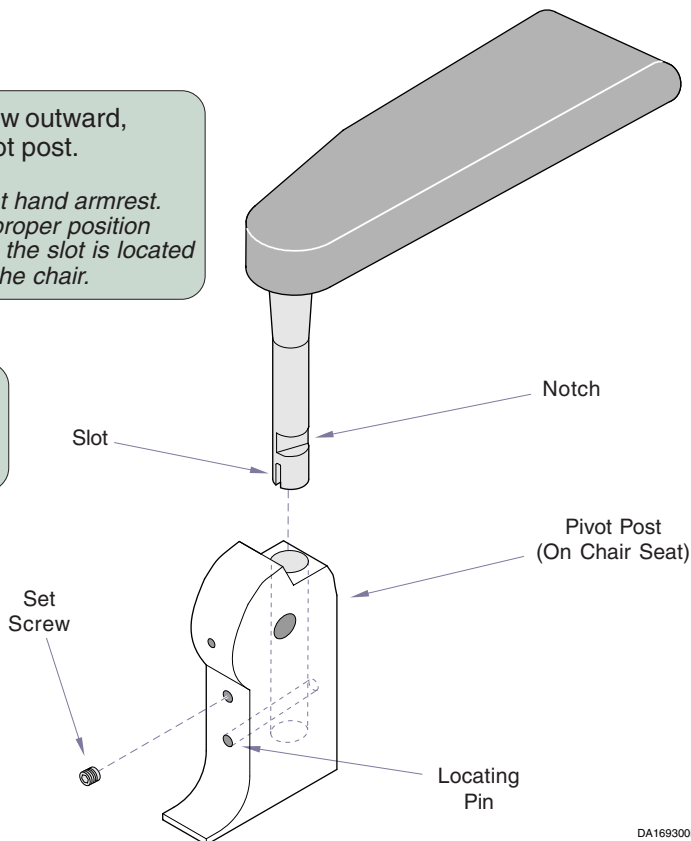

DA1693001



Equipment Alert

Never operate the armrest without the set screw in position and properly adjusted.

Without the set screw in position the armrest could be positioned toward the back. In this position, if the chair were to be operated, damage could occur to the armrest or chair.

To position armrest:

- A. Grasp armrest with both hands and pull upward and swing out 90° away from chair.
- B. With patient seated, swing armrest back until it locks.

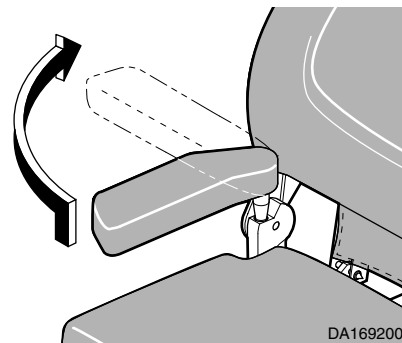

DA1692001