

Models 391-002 Otolaryngology (ENT) Chair *Installation Guide*

For models:

120 VAC: 391-002 Otolaryngology
(ENT) Chair



WARNING

- Equipment not suitable for use in the presence of a flammable anesthetic mixture with air, or with oxygen or nitrous oxide.
- Assure chair is attached to a dedicated circuit suited for the electrical specifications of the chair.
- Ground reliability can only be achieved if this equipment is connected to an equivalent receptacle marked "**Hospital Grade**".
- Observe all local and national electrical codes.

Note

Chair should be located at least 18" (45.7 cm) from the nearest wall, cabinet, or permanent fixture when in the fully reclined position.
The chair seat moves forward 4 1/2" (11.4 cm) as the base is raised.

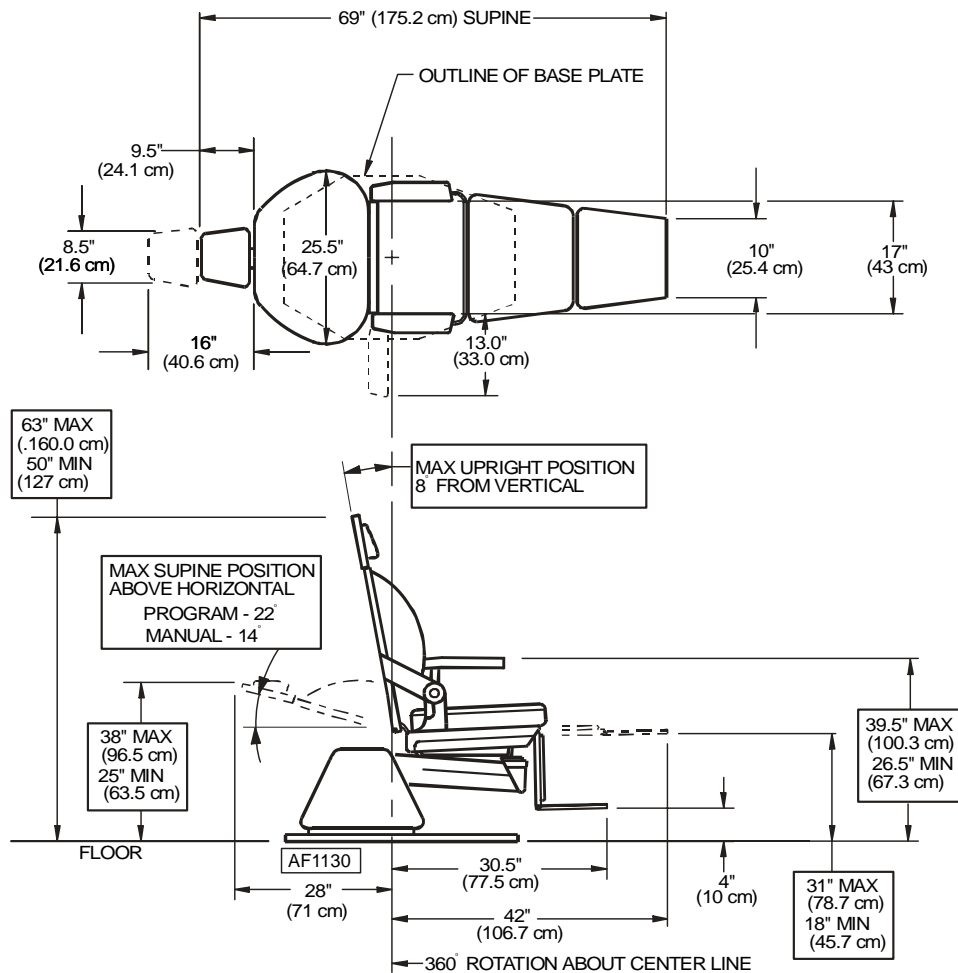

REMOVING CHAIR FROM SKID

Note

Leave the chair on the pallet until the chair back has been assembled.

Step 1: Plug the foot controller into the chair and then plug the chair into an electrical outlet.

Step 2: Using the control, raise the chair vertically off the pallet brace.

Step 3: Remove the hardware that secures the chair to the pallet.

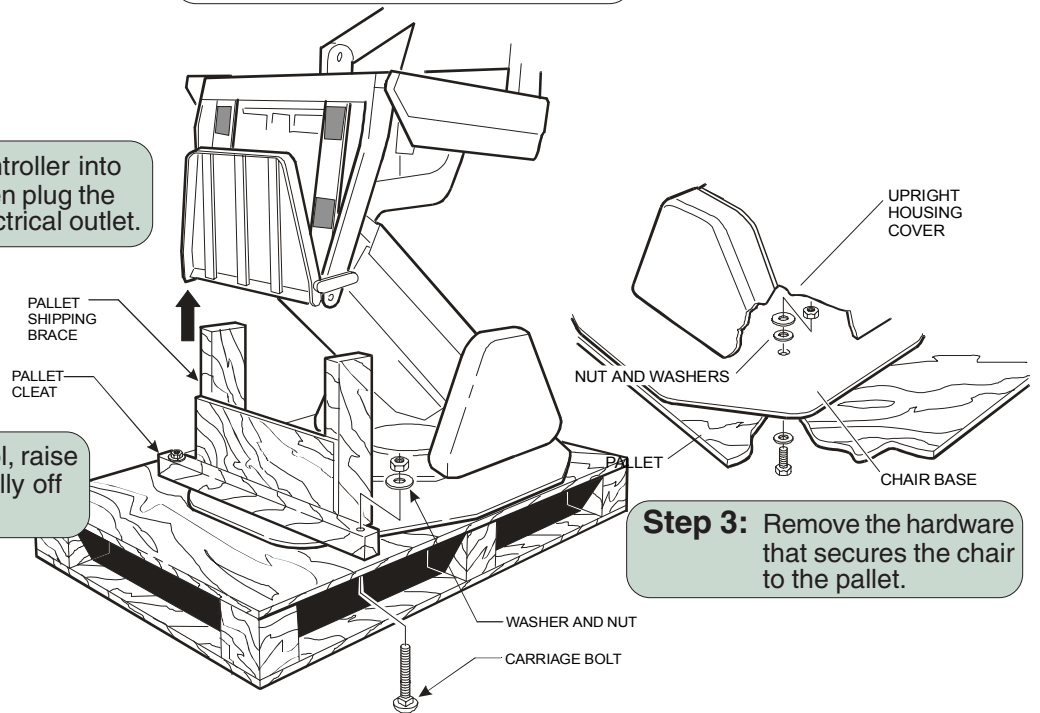

CHAIR BACK



Equipment Alert

Assure the wire harness and ground wire is located behind the pivot pin and secured by the cable clip on the tow bar.

Step 2: As the chair back is lifted up, the clevis ends will slide in position over the tow bar ends.

Step 1: Remove the retaining rings, pivot pins and *short* white bushings from the tow bar end.

NOTE

The *long* white bushings should remain in position in the tow bar ends.

Step 3: Install the pivot pins, *short* white bushings, and retaining rings to the tow bar ends and chair back.

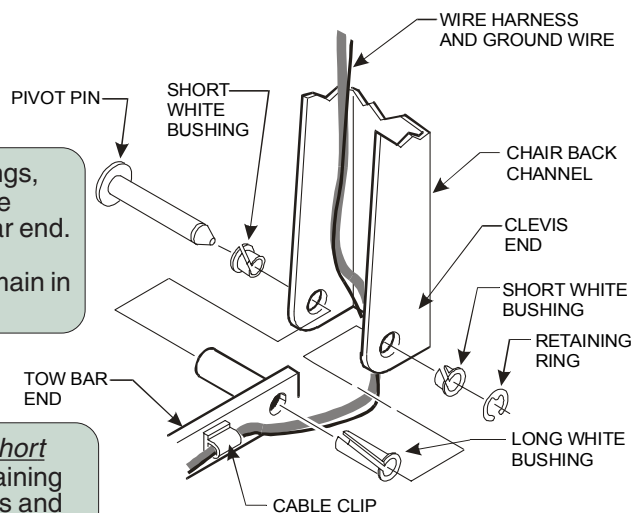
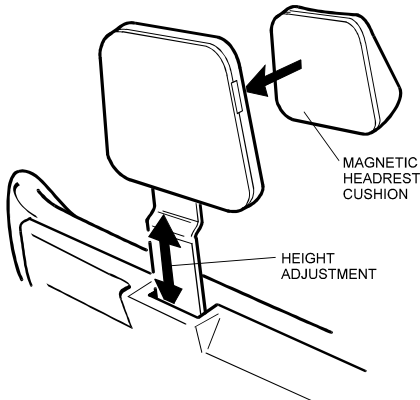

ILLUSTRATION SHOWING CHAIR BACK ASSEMBLY (RIGHT-HAND SIDE SHOWN)

Step 4: Lubricate each joint with a drop of light weight oil.

HEADREST ADJUSTMENT



Note

The headrest adjustment bracket is pre-set at the factory and should not require adjustment.

Step 3: Place the magnetic headrest cushion in position.

Step 1: Loosen two locknuts on adjustment screws.

Step 2: Loosen or tighten adjustment screws to desired tension and retighten locknuts.

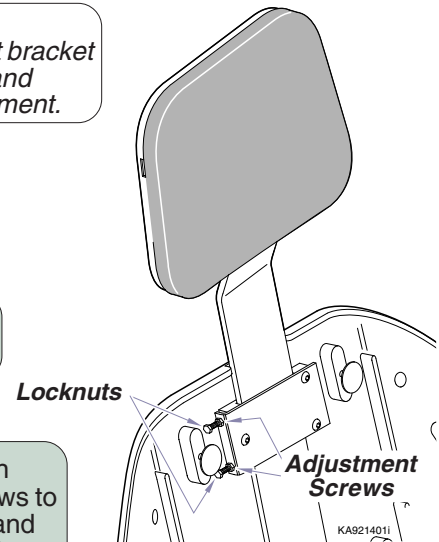

SEAT UPHOLSTERY

Step 1: Lower the footrest

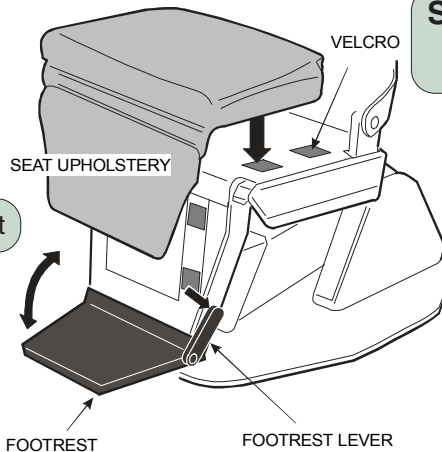

Step 2: Place the seat upholstery in position, pressing down to secure to velcro strips.

BACK UPHOLSTERY



Equipment Alert

Do not over tighten the screws as it may cause the upholstery to distort or wrinkle.

Step 1: Install springs into the bushings on the chair back.

Step 2: Insert screw through chair back and into studs

Note

Compress the spring to allow screw to be inserted into stud. Tighten 2 to 3 turns.

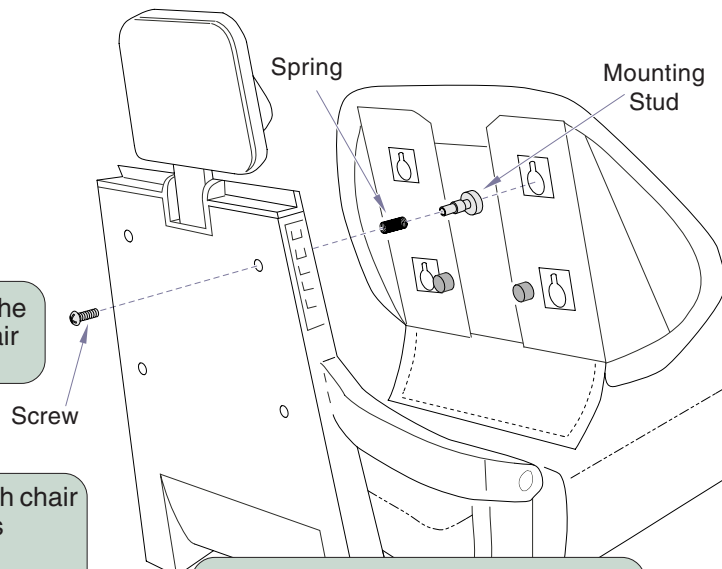

Step 3: Slide chair back cushion over studs, pushing downward to lock in place.

Note

Make certain that all four points are locked, then tighten the screws.

DA1914000

ARMREST LOCK AND UNLOCK POSITIONING

Note

We recommend disabling (locking) the swing out feature on the side of the chair opposite patient access.

Left Armrest Swing Out Position

Left Armrest Locked Position

Step 1: Remove pivot screw and washer on underside of armrest.

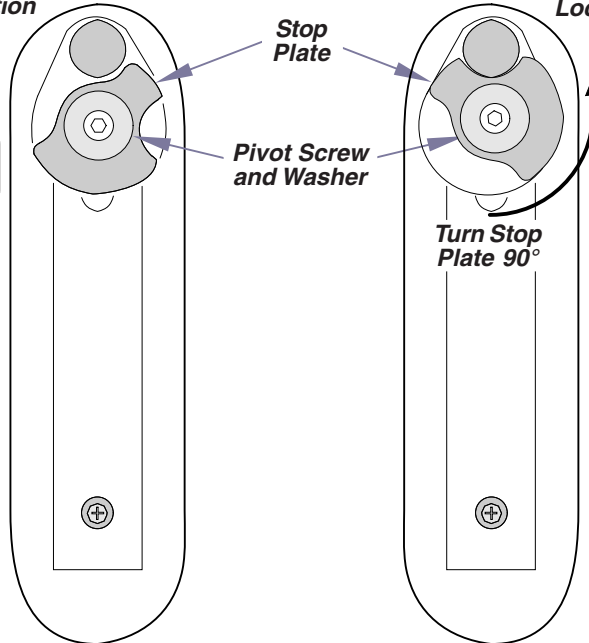

Step 2: Rotate stop plate 90°

Step 3: Reinstall the pivot screw and washer

DA169700i

ARMREST INSTALLATION

Step 1: After turning set screw outward, insert armrest in pivot post.

Note: There is a left and right hand armrest. The armrest is in the proper position when the notch above the slot is located toward the outside of the chair.

Step 2: Position the armrest parallel to the side of the chair, until the slot in the shaft locks into position on the locating pin.

Step 3: Turn the set screw in until it is tight and then back it out 1/4 turn.

Note: This adjustment allows the armrest to be lifted and rotated but prevents complete removal of the armrest.

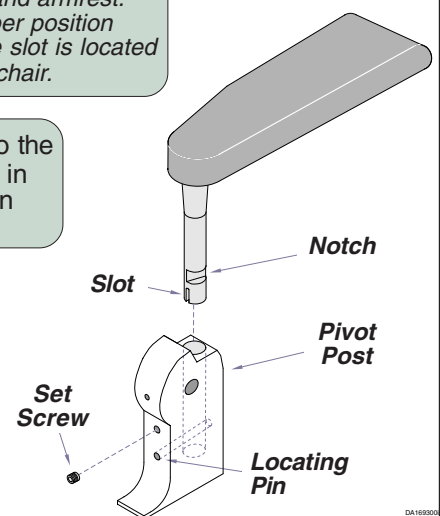
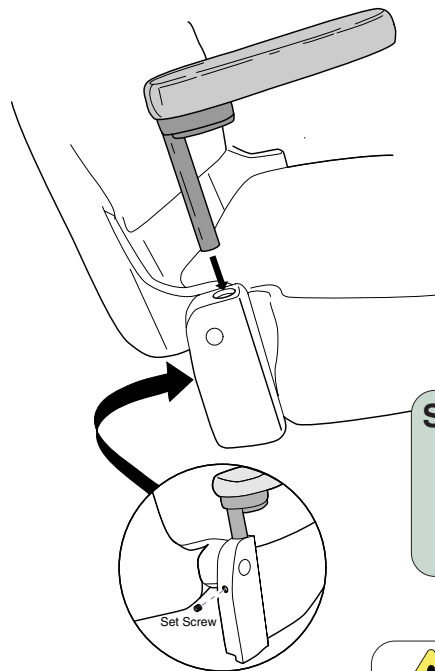

DA169900



Equipment Alert

Never operate the armrest without the set screw in position and properly adjusted. Without the set screw in position the armrest could be positioned toward the back. If the chair were to be operated, damage could occur to the armrest or chair.

Specifications

Weights, Dimensions, Electrical Specifications

Patient Weight (Maximum) 325 lbs (147.4 kgs)

Weight of Chair:
 Without Shipping Carton 355 lbs (161.0 kg)
 With Packaging & Skid 367 lbs (166.5 kg)

Electrical Requirements: 120 VAC Nominal +/- 10%, 50/60 Hz, 8.0 Amp, Single Phase.

Fuses: [See Chart]

Protection against ingress of fluids: Ordinary Equipment

Fire Code Ratings: All Midmark Standard Upholstery sets comply with:
 California Bureau of Home Furnishing Tech. Bulletin 117.

Classifications Class 1, Type B Applied Part, Ordinary Equipment

Duty Cycle: Intermittent Operation, (On 30 secs.- Off 5 min).

Certifications:
 Midmark Corporation ISO 9001 Certified

Model 391-002 ETL Classified, conforms to UL STD. 60601-1
 Certified to CAN/ CSA STD. C22.2 NO. 601.1

Fuse Characteristics



Caution
 Only people qualified in electrical service should attempt to replace the fuse(s).
 Always disconnect power to the chair before removing any component or panel.

Model Number	Voltage (VAC)	Fuse Characteristics			
		Motor Fuse w/ Spare (F1) [located on PCB]	Transformer Fuse w/ Spare (F2) [located on PCB]	Light (F3) [located on PCB]	External Line Fuse (F4) [located on cover]
391-002	120	10A, 250V, Type F Fast-Acting	1/2A, 250V, Type T Slow-Acting	1/2A, 250V, Type T Slow-Acting	10A, 250V, Type F Fast-Acting (Qty 1)

Midmark Corporation
60 Vista Drive
P.O. Box 286
Versailles, OH 45380-0286
937-526-3662
Fax 937-526-5542
www.midmark.com



Because we care.