



Casters [9A365]

Components:	
Casters	4
Screws (5/16")	4
Washers	4
Special Tools:	
4" x 4" x 24" support	

Intended Use:
To make exam table mobile.

Restrictions:
Do not install casters with rotational base.

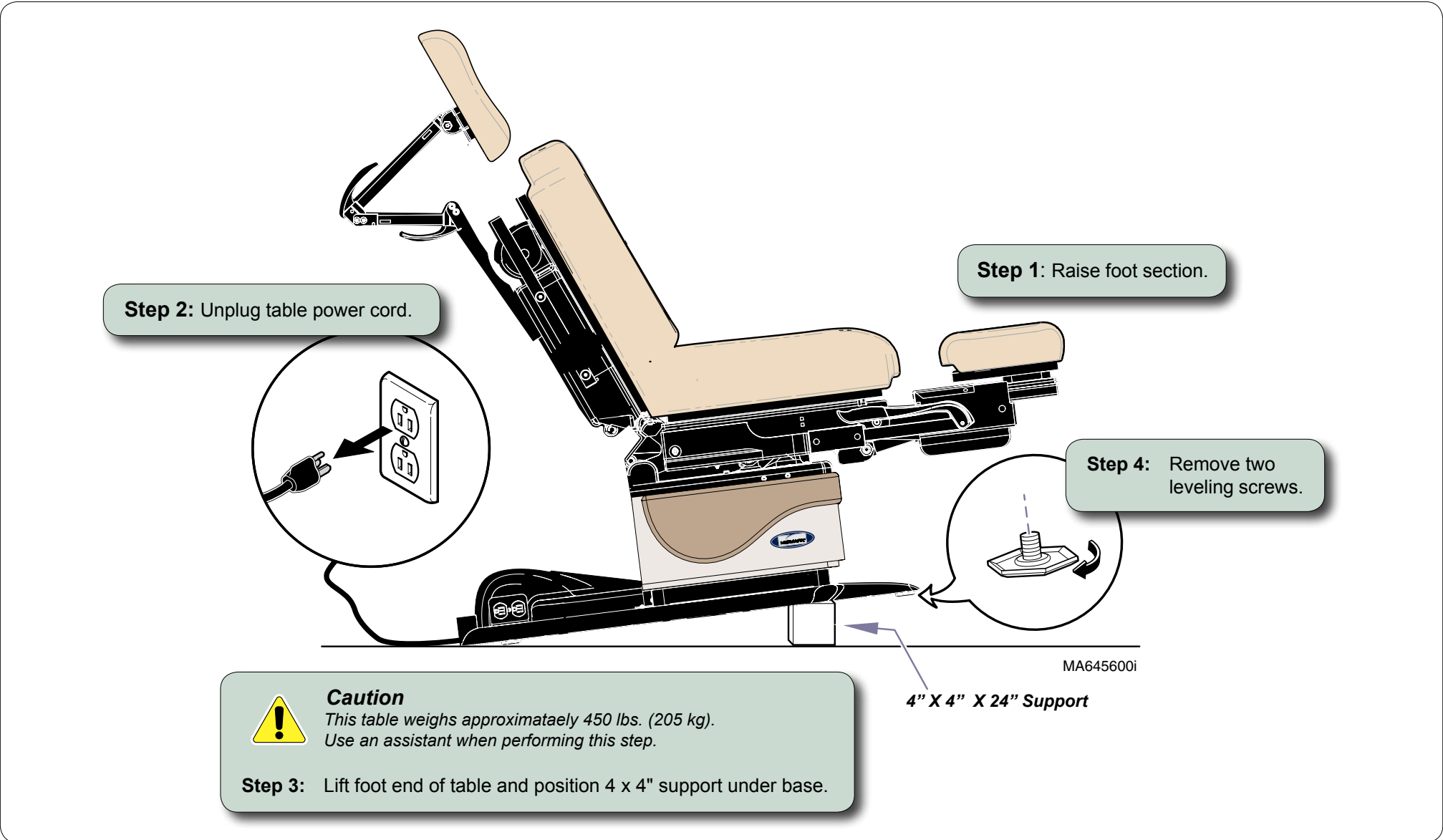

Step 5: Position foot end casters and secure with screws & washers.

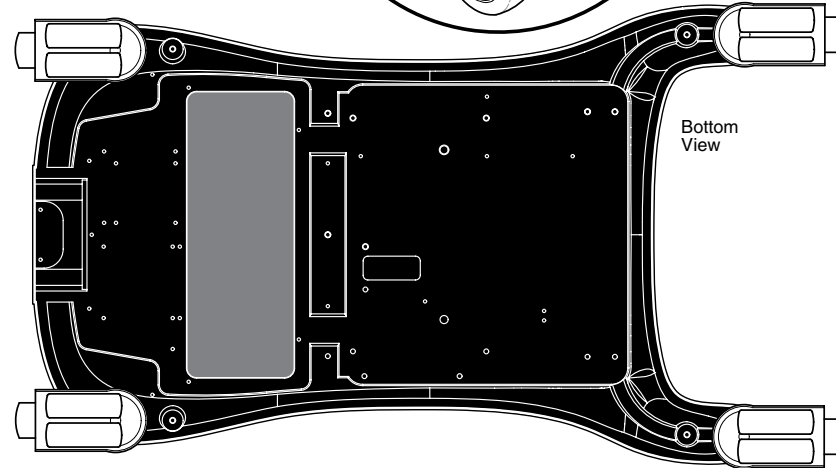
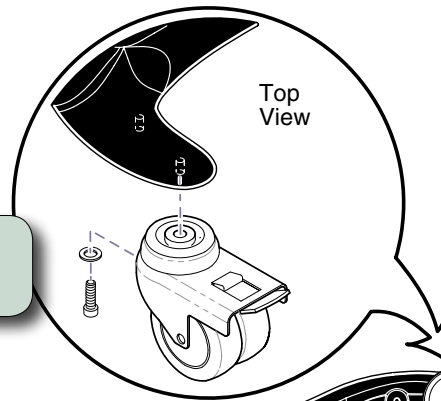

Caution

To prevent injury, lock foot end casters before performing Step 6.

Step 6: Position 4 x 4" support under head end of base. Install head end casters (same procedure).



Caution

To prevent injury, always lock casters before performing any procedures.

To UNLOCK caster(s)...
Lift up on brake lever.

To LOCK caster(s)...
Press down on brake lever.

MA743800i

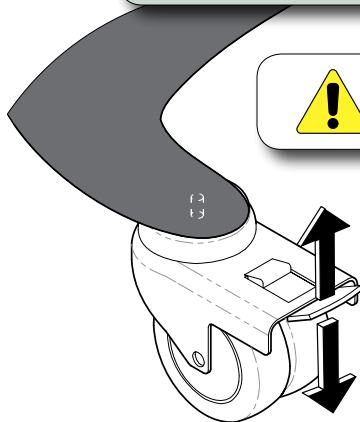

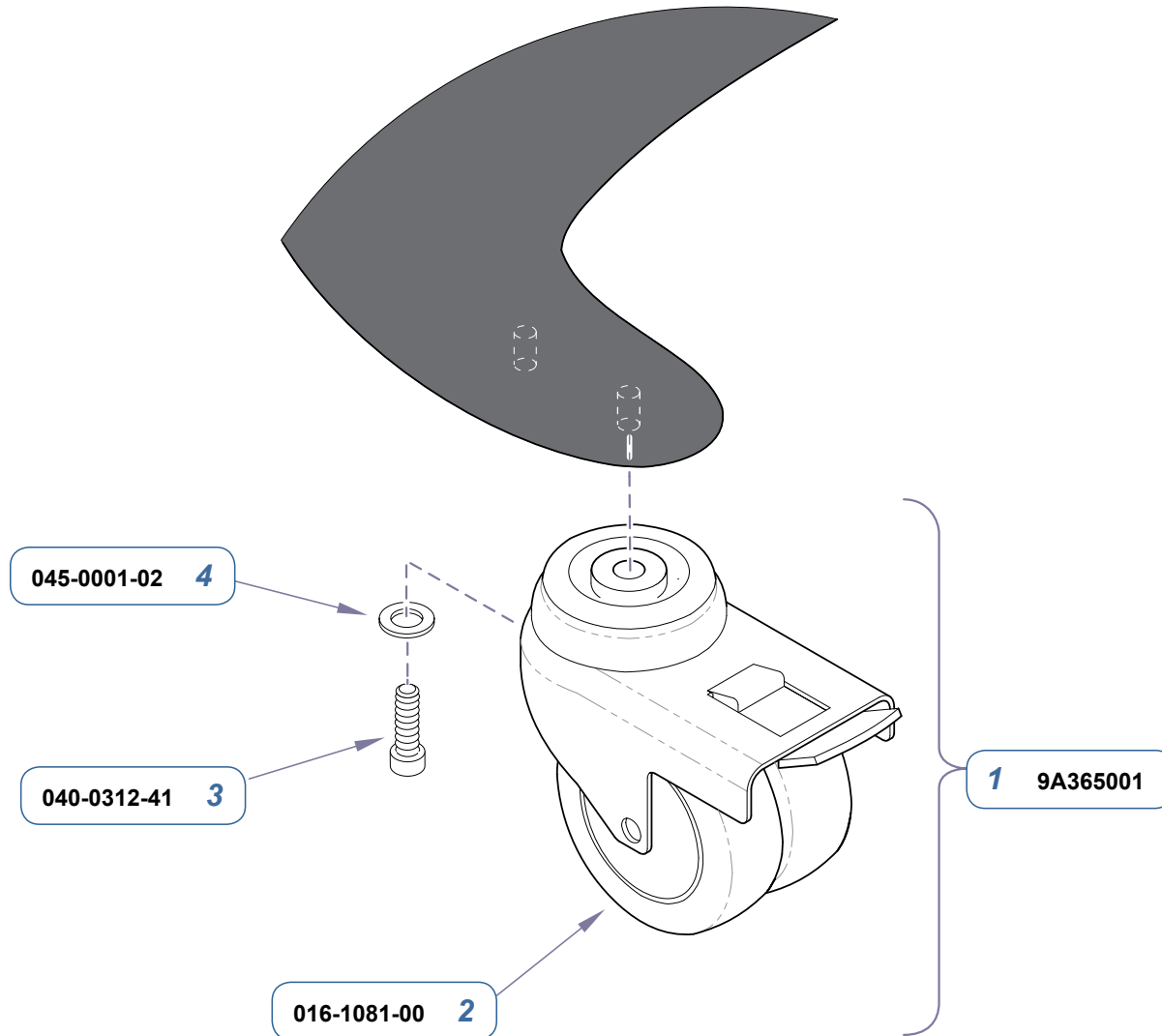

Item	Description	Qty.
1	Caster Accessory (incl. items 2 thru 5)	1
2	• Twin Wheel Caster	4
3	• Screw (5/16"-18 x 1")	4
4	• Washer (1/4", type "A", plain)	4
Always specify Model & Serial Number		

Serial Numbers / Dates: all