

IV Armboard [154081-XXX] (Installation on Model Knight Biltmore Dental Chair)

Contents:
 Installation 1
 Exploded View 3
Special Tools:
 Allen Wrenches

Intended Use:
 To provide support for patient's arm.

Restrictions:
 None

Step 1: Remove present armrest...
 A) Determine which side user wants the IV armboard installed.
 B) Loosen the set screw.
 C) Remove the existing armboard.

Step 2: Disassemble Strut and Clamp...
 A) Loosen knob.
 B) Slide Strut and Clamp from IV armboard rod assembly.
 C) Remove two socket cap screws and separate Clamp from Mounting Block.

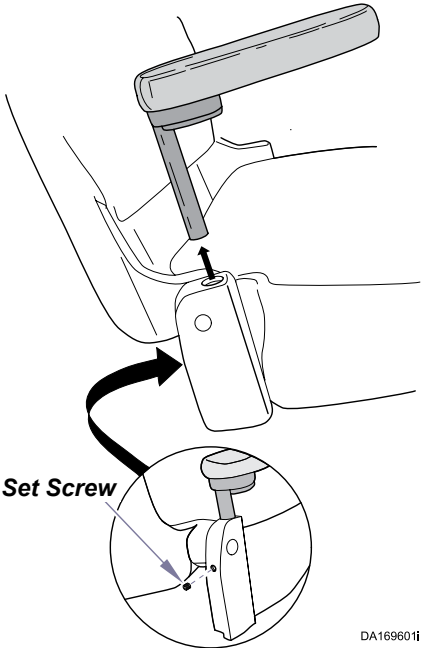
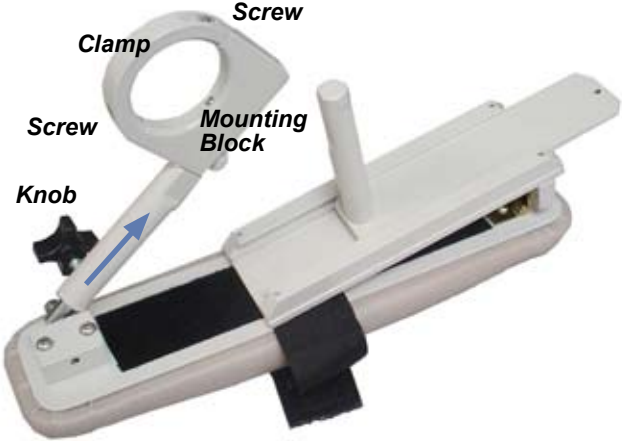

DA169601f

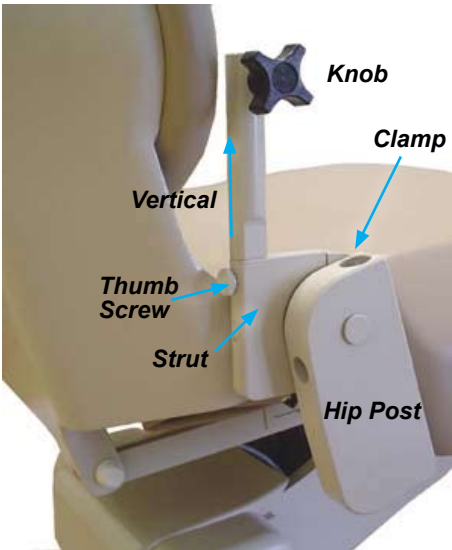

Step 3: Install Strut and Clamp...
Note: With the chair back all the way up, position the strut and knob assembly vertically as shown before tightening the two screws on the clamp.
 A) Mount the Strut and clamp on the pivot between the hip post and seat. Tighten the two screws.
 B) If necessary, remove thumb screw and rotate strut and knob assembly 180° so knob is pointed outward from the chair.

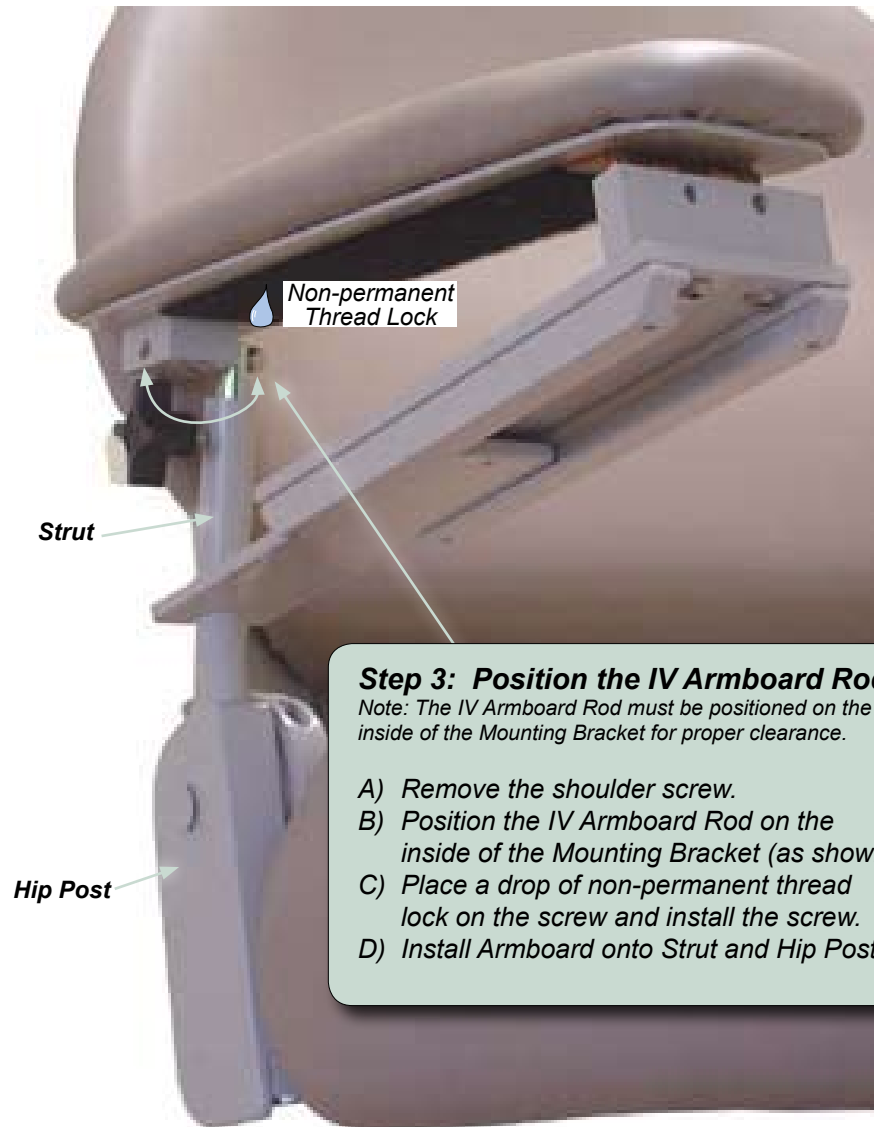

Step 3: Position the IV Armboard Rod.
Note: The IV Armboard Rod must be positioned on the inside of the Mounting Bracket for proper clearance.

- A) Remove the shoulder screw.
- B) Position the IV Armboard Rod on the inside of the Mounting Bracket (as shown).
- C) Place a drop of non-permanent thread lock on the screw and install the screw.
- D) Install Armboard onto Strut and Hip Post.



Step 4: Arm Adjustment
A) Loosen knob and move arm up or down.

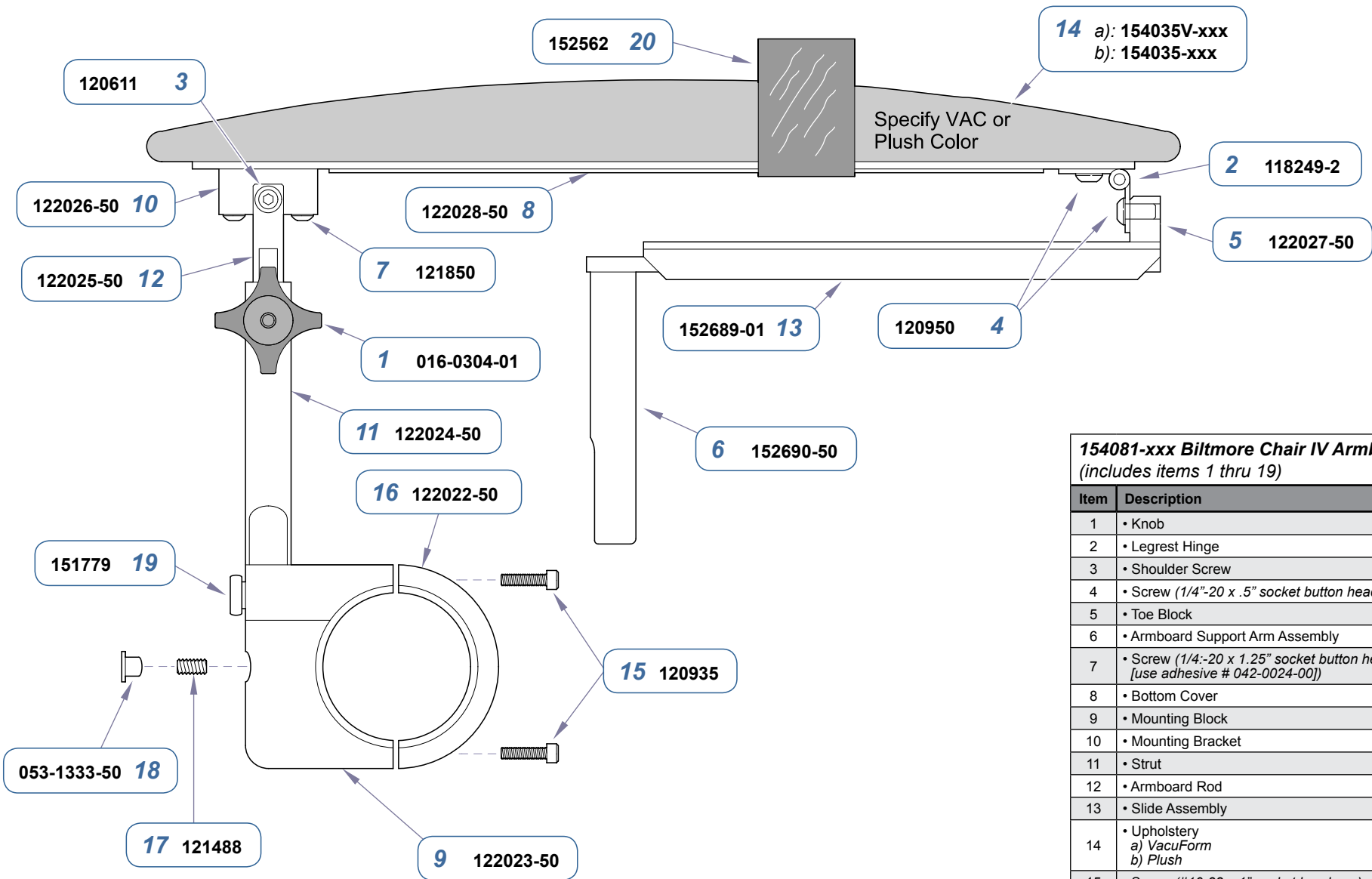

154081-xxx Biltmore Chair IV Armboard
(includes items 1 thru 19)

Item	Description	Qty.
1	• Knob	1
2	• Legrest Hinge	1
3	• Shoulder Screw	1
4	• Screw (1/4"-20 x .5" socket button head)	6
5	• Toe Block	1
6	• Armboard Support Arm Assembly	1
7	• Screw (1/4"-20 x 1.25" socket button head) [use adhesive # 042-0024-00]	2
8	• Bottom Cover	1
9	• Mounting Block	1
10	• Mounting Bracket	1
11	• Strut	1
12	• Armboard Rod	1
13	• Slide Assembly	1
14	• Upholstery a) VacuForm b) Plush	1
15	• Screw (#10-32 x 1" socket head cap)	2
16	• Clamp	1
17	• Screw (1/4"-20 x .5" ss. cup point socket set)	1
18	• Plug	1
19	• Thumb Screw	1
20	• Arm Band	1

DA161801I

Serial Numbers / Dates: all