

## Install Handpieces

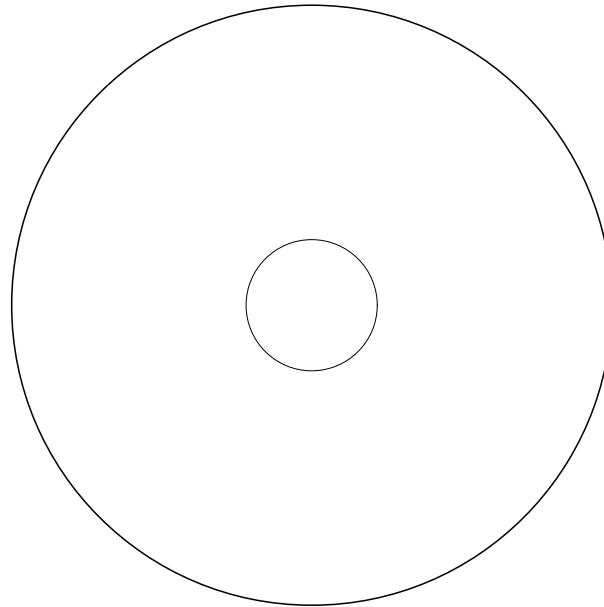

### **To activate warranty:**

Insert CD, then select Product Registration from the menu.

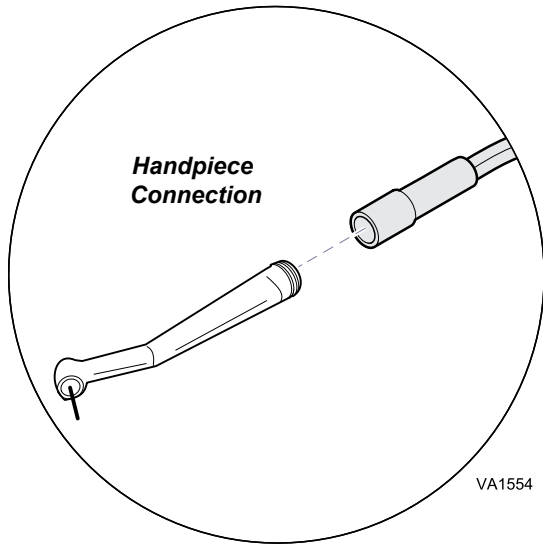

### **Equipment Alert**

Complete manufactures instructions for "Infection Control / Sterilization found in the documentation included with the handpieces. Failure to do this will cause premature failure of handpieces.

## Maintenance Kits



### **Regulator Filter & O-Ring**

\*Change O-ring & Filter at the same time.

**Order #: 053-1166-00**

**(Filter)**

**014-0176-45**

**(O-Ring)**



### **Water Bottle Gasket**

**Order #: 014-0176-52**

VA1349

### **Calling for Service**

If service is required, contact your Midmark dealer.

To contact Midmark directly:

1-800-Midmark (1-800-643-6275)

8:00am until 5:00 pm Monday through Friday (EST)

Midmark Corporation  
60 Vista Drive  
Versailles, OH 45380-0286  
Phone: 937-526-3662  
Fax: 937-526-5542  
www.midmark.com



Because we care.



## **Operating & Care Guide VetPro® 5000 Table & Wall/Cabinet Mount**

Model Number:   
Serial Number:

Dealer Information:

Purchase Date:

003-1903-00 Rev F

The operation of the VetPro® 5000 Wall/ Cabinet & Table Mount is restricted to use by veterinary professionals.

This guide outlines basic care and maintenance of the VetPro® 5000. The enclosed CD provides additional instructions on operation and care. If service is required, contact your authorized Midmark dealer.

© Midmark Corporation 2008

### To Flush Delivery System...

- A) Remove all handpieces that use water.
- B) Open water needle valve.
- C) Turn foot control toggle switch to WET.
- D) Hold end of tubing over a container and press foot control for 30 seconds. Then press and hold flush button for 30 seconds. Repeat (step D) for all handpieces.
- E) Press and hold syringe buttons (air & water) for 30 seconds.
- F) Install newly disinfected handpieces.
- G) Refill water bottle.

Note: When performing "Flush" procedure at the end of the day. Refer to: User's Guide 003-1902-00 on CD or [www.Midmark.com](http://www.Midmark.com) for procedure.)

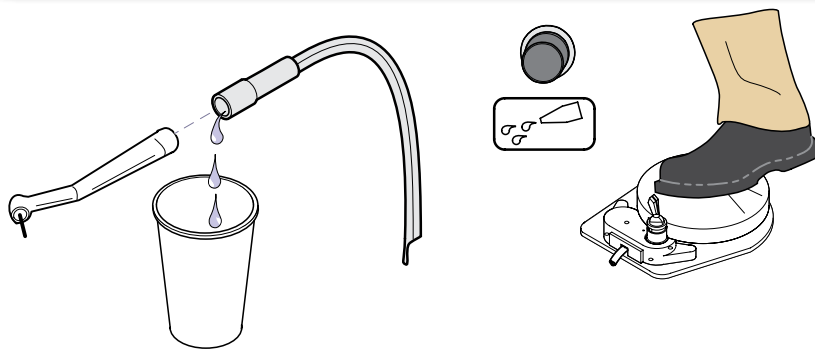

### To clean the air / oil separator cup...

- A) Turn master On/Off switch Off.
- A) Unsnap cup.
- B) Dispose of saturated gauze.
- C) Disinfect cup.
- D) Install new gauze, then reinstall cup.

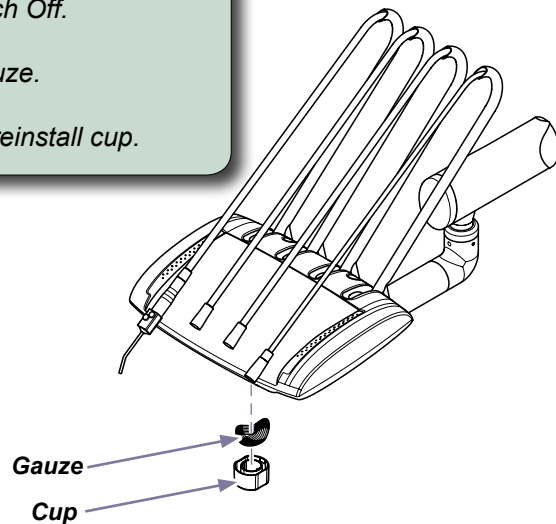

### At the beginning of each work day...

- Fill water bottles with fresh distilled water.
- Flush handpieces.

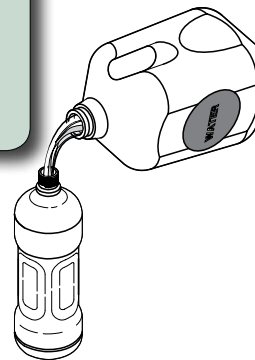

### To Change Regulator Valve Filter Before you begin...

Turn off water & air supply to the dental unit by closing both manual shut-off valves.

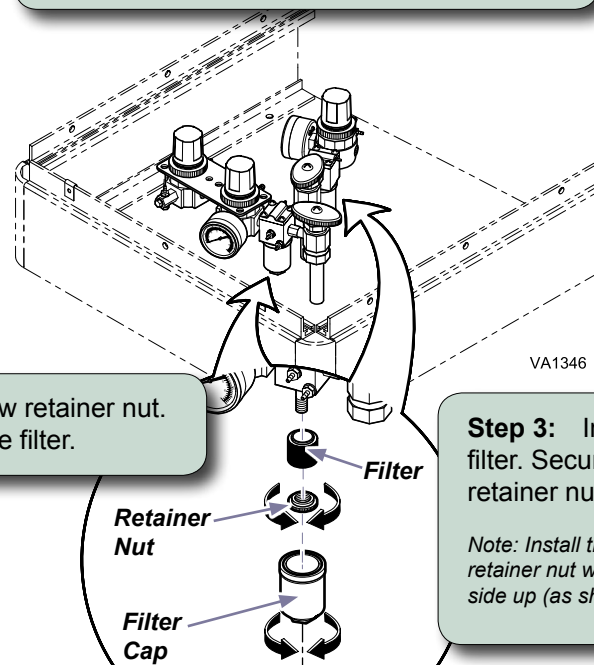

**Step 2:** Unscrew retainer nut. Remove filter.

**Step 3:** Install new filter. Secure with retainer nut.

Note: Install the filter & retainer nut with the ridged side up (as shown).

**Step 1:** Unscrew filter cap.

Note: Use 9/16" wrench.

**Step 4:** Reinstall filter cap.

Note: Use 9/16" wrench.

## After Each Procedure

### A. Clean.

Handpieces and syringe tip should be changed or disinfected between each patient according to manufacturer's instructions.

### B. Flush Delivery System.

### C. Fill Water Bottle.

## Daily

### A. Clean System.

- Disinfect handpieces according to manufacturer's instructions.
- Wipe down delivery equipment with disinfectant.

### B. Bleach Flush Delivery System.

(End of Day Only - Refer to: User's Guide 003-1902-00 on CD or [www.Midmark.com](http://www.Midmark.com) for procedure.)

## Periodically

### A. Check air/oil separator fluid level.

- Change Gauze when saturated. Use 2 x 2 Gauze pads.

## Every Three Months

\*Only in Models that have a Junction Box.

### A. Replace Regulator Valve Filters.