

# Air Regulator [002-0768-00]

**Components:**  
Air Regulator..... 1

**Special Tools:**  
none

**Step 1:** Turn air and water manual shut-off valves located in junction box OFF.

**Step 2:** Tag and disconnect any tubing connected to fittings of regulator.

**Step 3:** Remove locking ring from regulator then remove from mounting plate.

**Note**  
If removing water bottle air regulator (w/o gauge), step four is not necessary. Go to step 5.

**Step 4:** Remove gauge and any fittings or plugs from regulator.

**Step 5:** Unscrew regulator from master pilot shut-off valve.

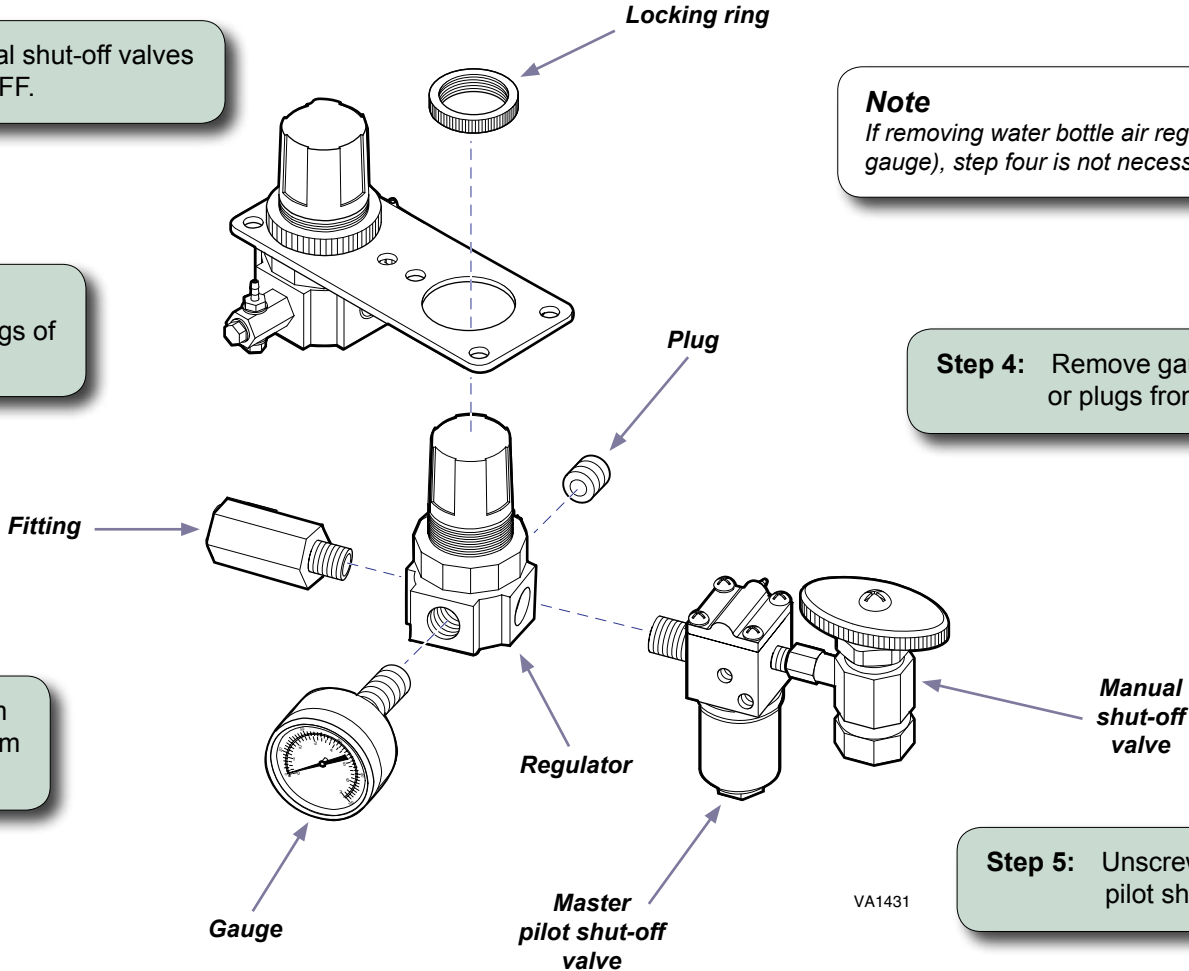

**Step 6:** Install gauge and any fittings and plugs [removed in step 5] into regulator.

**Note**  
If installing water bottle air regulator (w/o gauge), step 7 is not necessary. Go to step 8.

**Step 7:** Apply removable loctite, then screw regulator onto fitting of master pilot shut-off valve.

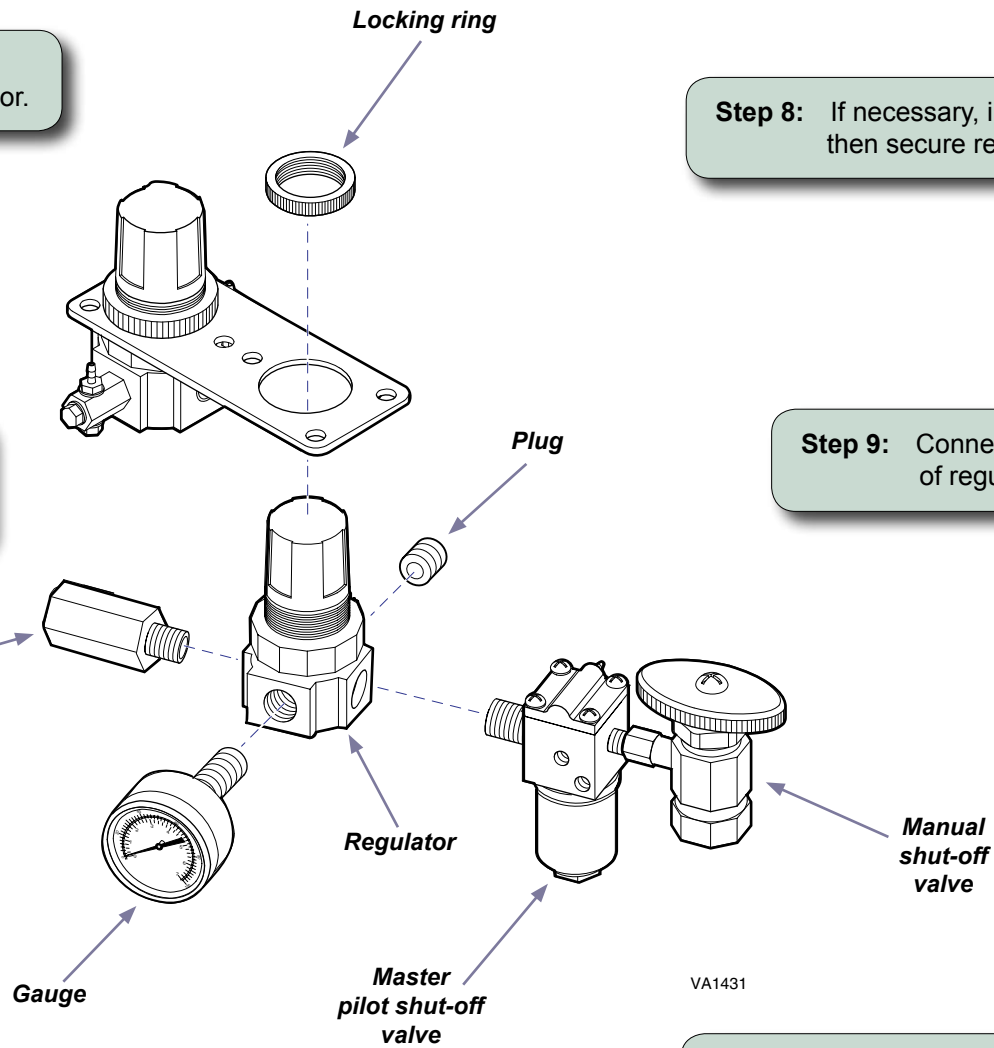

**Step 8:** If necessary, install mounting plate then secure regulator with locking ring.

**Step 9:** Connect tubing to proper fittings of regulator.

**Step 10:** Turn air and water manual shut-off valves ON and check for proper operation.