

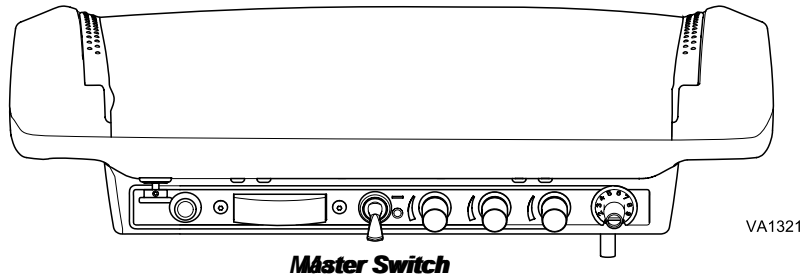

Kink Valve [152839]

- Components:**
Kink Valve..... 1
1/16 Allen Wrench .. 1
- Special Tools:**
none



Step 1: Turn unit master switch OFF and remove tool pad.

Step 2: Remove four screws and upper shroud to access kink valve.

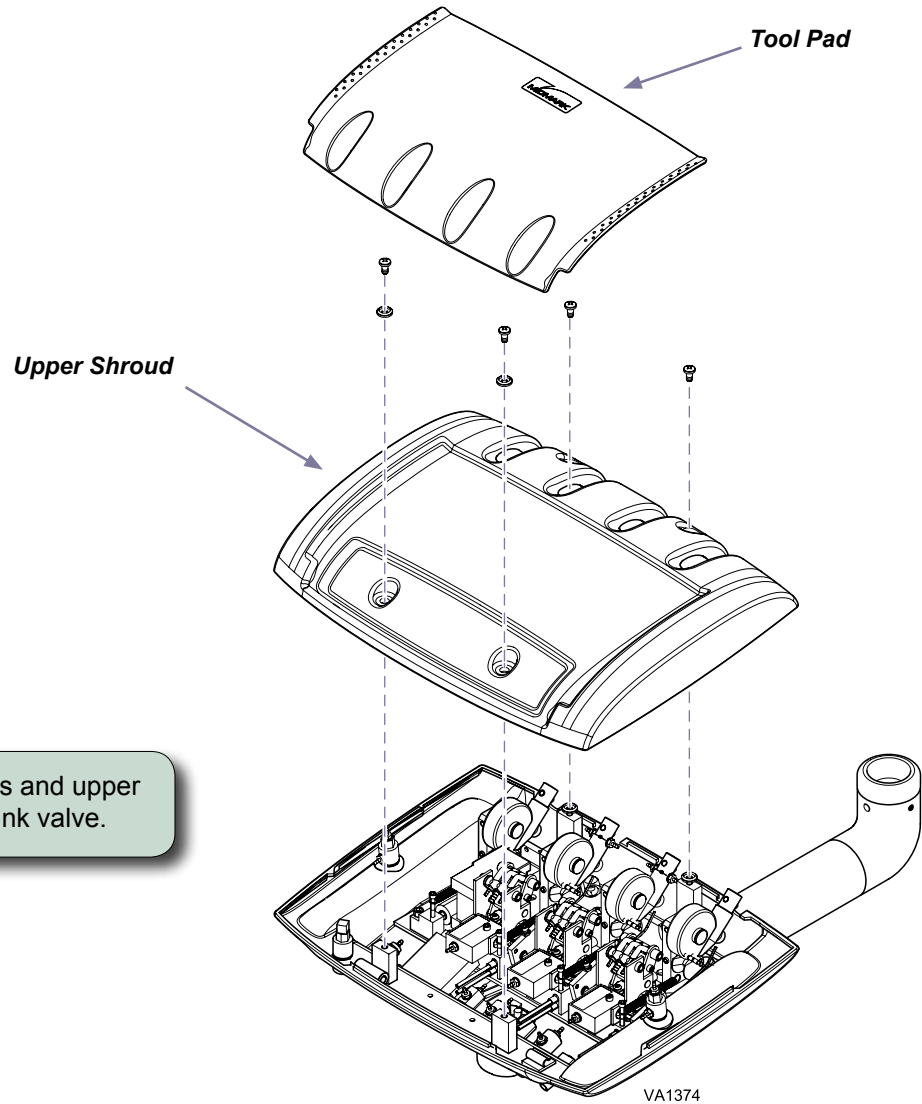

Step 3: Tag and disconnect tubing from six kink valve fittings and one kink valve manifold fitting.

Step 4: Remove one mounting screw and kink valve assembly from whip pivot assembly.

Step 5: Connect tubing to proper kink valve fittings and kink valve manifold fitting.

Step 6: Position kink valve and secure with mounting screw.

Step 7: Reinstall upper shroud and tool pad.

Step 8: Turn unit master switch ON and check for proper operation.

