



M9/M11 Fill / Vent Valve Assembly

M9 Kit Number
002-10016-00
002-10016-01

Used On
115vac
230vac

M11 Kit Number
002-10017-00
002-10017-01

Used On
115vac
230vac

Components:
Valve Assy. 1
Copper Fill Tube 1
Wire Harness..... 2

Special Tools:
none



Caution

Always disconnect power to sterilizer before removing covers or performing any service procedure.

Note

Replaces old style Fill / Vent Valve Assemblies.



Equipment Alert

The new copper fill tube must be installed to prevent water leaks.

Step 1: Drain water from reservoir.

Step 4: Install nut finger tight onto bottom elbow. Install new fill tube into elbow fitting & valve assembly. Secure valve assembly with mounting screw. Tighten nuts on both ends of new fill tube.

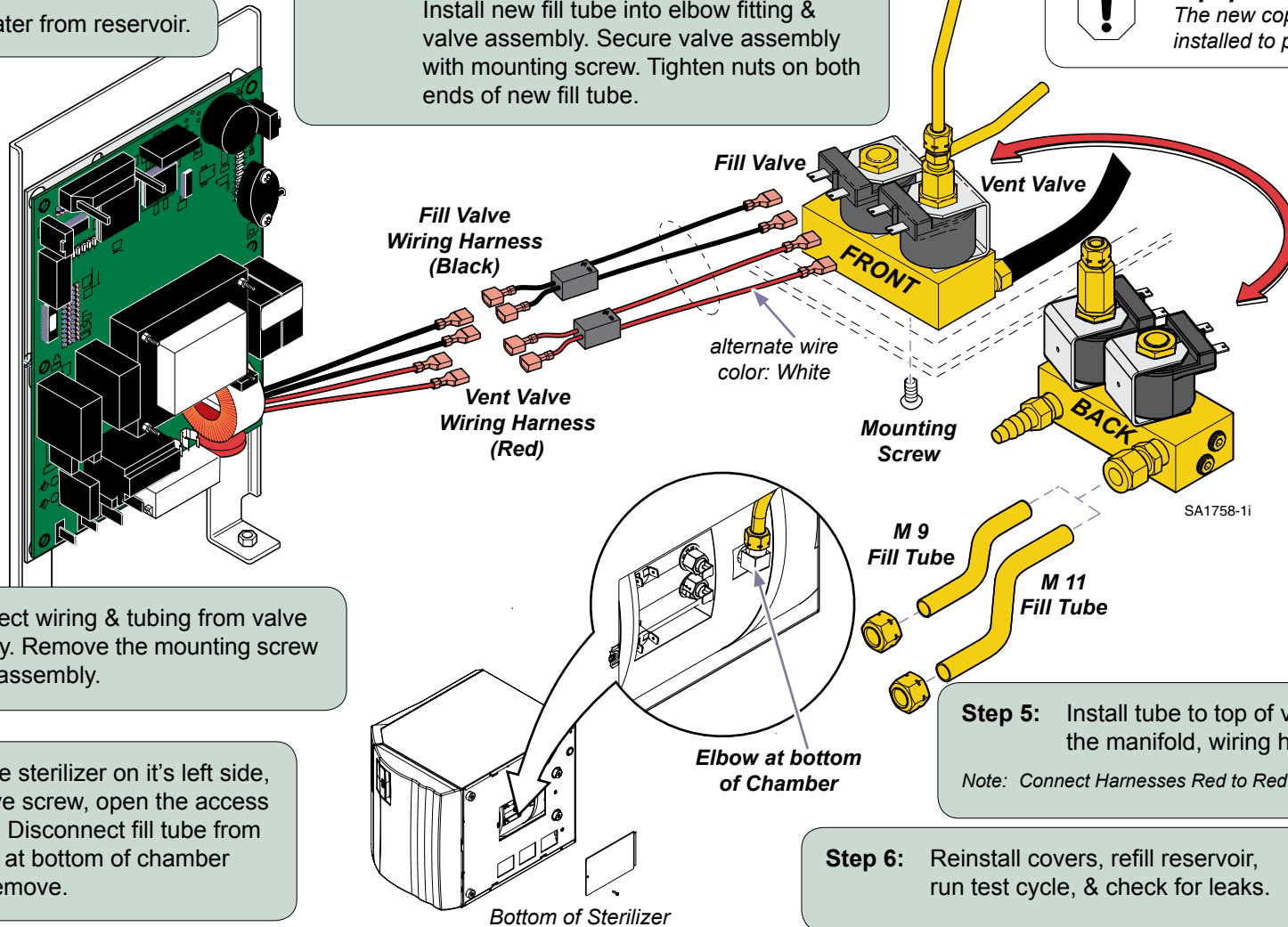

Step 2: Disconnect wiring & tubing from valve assembly. Remove the mounting screw & valve assembly.

Step 3: Put the sterilizer on it's left side, remove screw, open the access panel. Disconnect fill tube from elbow at bottom of chamber and remove.

Step 5: Install tube to top of vent valve, hose to the manifold, wiring harnesses to solenoids.

Note: Connect Harnesses Red to Red - Black to Black.

Step 6: Reinstall covers, refill reservoir, run test cycle, & check for leaks.