



Veterinary Folding Exam Table Installation

Applies to Models:
8012-00-001
8012-00-XXX
8012*

Language of origin: English

Equipment Alert
The wall structure must be capable of supporting the table and load.
Moment (max) 738 ft. lbs. (1000 N-m)

Loose Parts Sent with Table

Shaft Support **E-Ring**

Spacer Bearing **3/8" x 4" Hex HD Lag Bolt**

3/8" Washer **1/4-20 x 7/8" Hex Screw**

Upper Shaft

Lower Shaft

Note
Shafts come installed on wall base and folding section. Must remove before installing the folding section to the wall base.

VA1844i

Step 1: Determine mounting location.
A) Use dimension information shown to determine the mounting location.

Install Table A Minimum of 36" From Floor For Clearance when Table is in Drop Position

VA1843i

TP200 Rev. A



Equipment Alert

Table top must be 36" minimum from floor.

Step 2: Install wall base for Wood Studs.

- A) Mark top two mounting holes on stud centers, 33.25" from floor.
- B) Drill two 1/4" holes 4" deep at mark hole locations.
- C) Secure wall base to wall with two 3/8" lag bolts (for wood) and washers.
- D) Drill other four mounting holes for wall base and install remaining bolts and washers.
- E) As you tighten all bolts, use level to make sure wall base is flat.

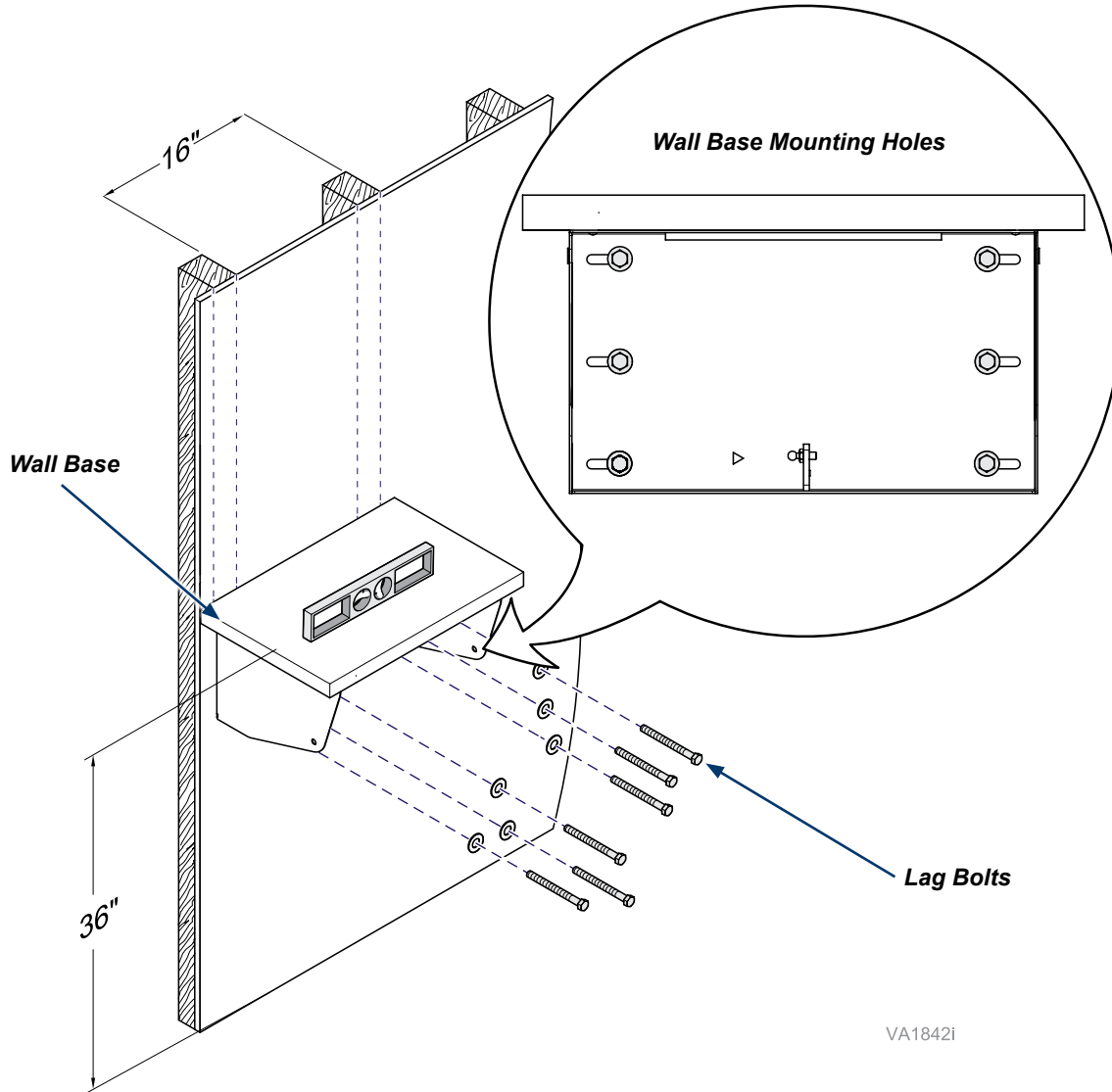

Note

Refer to chase installation manual for mounting hole locations in chase cabinet. To install table to chase, use hardware included with chase cabinet. (3/8" bolts, washers and nuts)

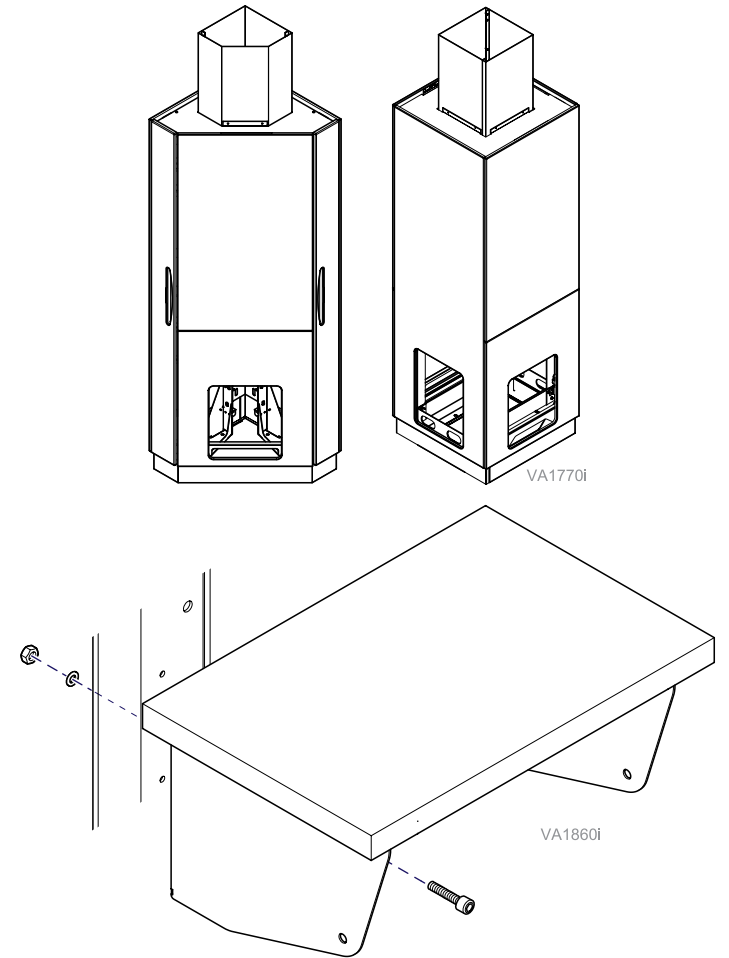

Step 2: Install wall base for Steel Stud.

If mounting table to a steel stud wall, there are two options.

1. Use backer plate kit, 002-1692-00 (ordered separately), install per instructions included with kit. Install wall base to backer plate starting with Step 2: E) - or
2. Install wood blocking design into steel studs as described below. Install wall base directly into wood blocking with lag bolts. In existing facilities cut hole in drywall large enough to install blocking design.

- A) Make relief cut on 2 - 2x12's. Starting with right side insert first 2x12 on steel stud stiffening lip and use 4 - 2" #14 flat head wood screws to affix 2x12 to steel web at 34.5" high. Screw plywood spacer to first 2x12. Insert second 2x12 onto stiffening lip and screw into place. Repeat for left side.
- B) Screw 4 - 3" #14 flat head wood screws onto front of stud flange using a total of 8 to secure blocking.
- C) Repair drywall and mark top two mounting holes (on new blocking design), 33.25" from floor.
- D) Drill two 1/4" holes 4" deep at mark hole locations.
- E) Secure wall base to wall with two 3/8" lag bolts (3/8 bolt for backer plate) and washers.
- F) Drill four mounting holes for wall base (wood block design). Install remaining bolts and washers.
- G) As you tighten all bolts, use level to make sure wall base is flat.



WARNING

Serious injury possible if instructions are not followed



Equipment Alert

Table top must be 36" minimum from floor.

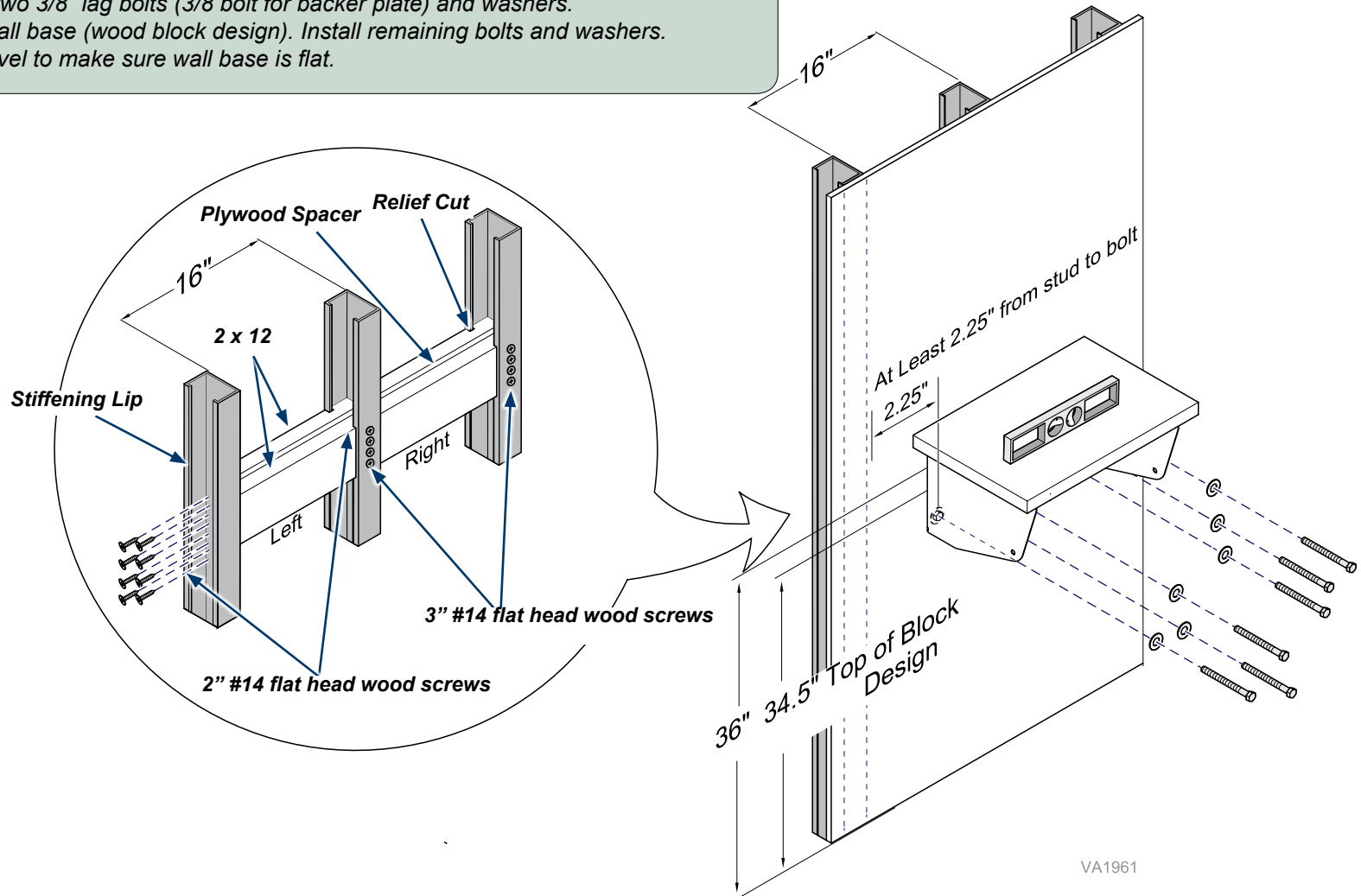

VA1961

Step 3: Install folding section.

- A) Install first e-ring on one end of upper shaft.
- B) Position folding section to wall base and slide top shaft through mounting holes.
- C) Install second e-ring to other end of top shaft.

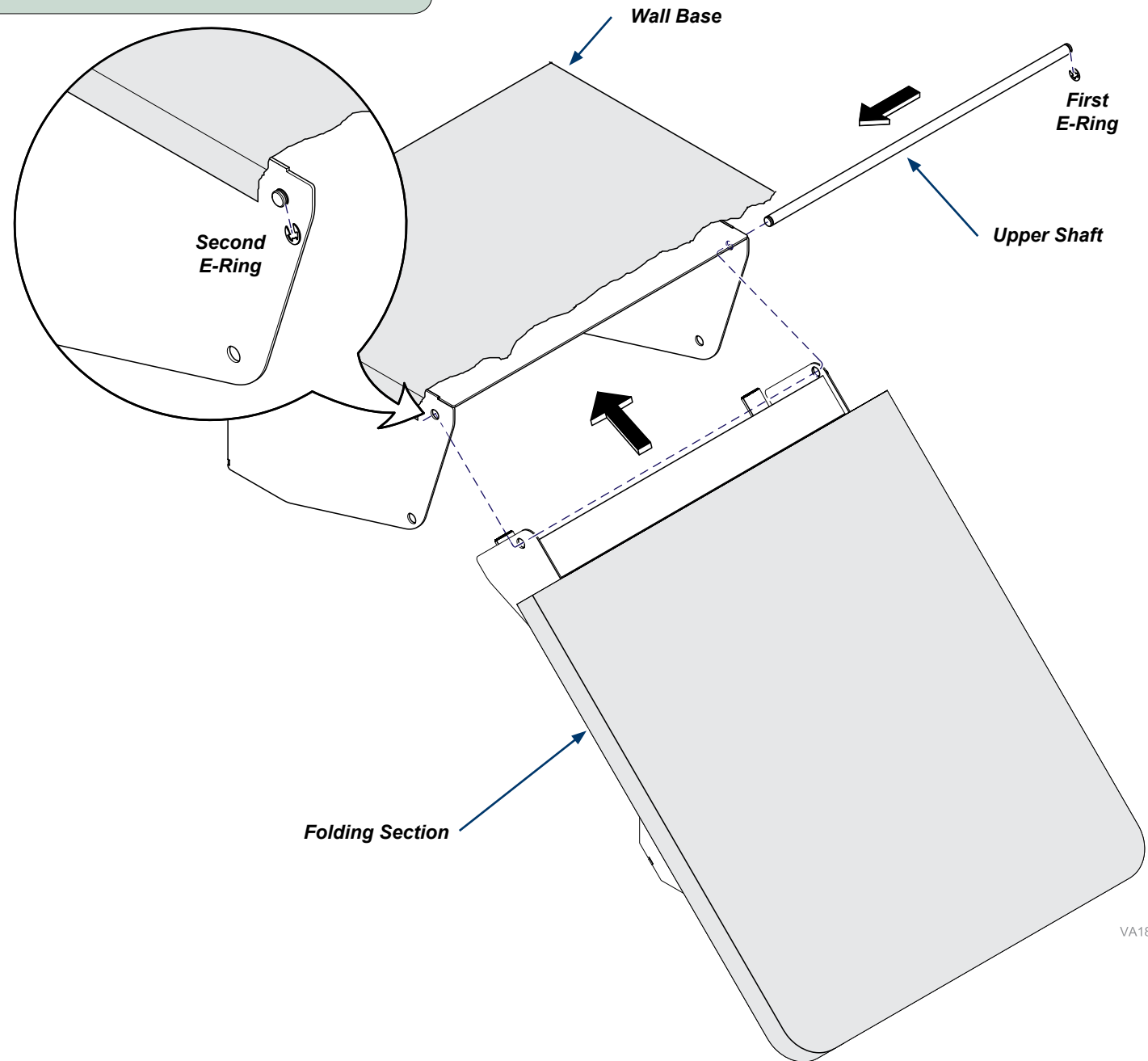

VA1845I

Step 4: Install gas spring.

- A) Snap rod end of gas spring into ball stud on wall base.
- B) Snap large end of gas spring into ball stud on folding section.
- C) If gas spring is not aligning with the ball stud on folding section, do the following:
- Loosen four table top screws under folding section.
 - Pivot folding section higher to align gas spring to ball stud.
 - Reposition table top to have approximately 1/8" seam gap and tighten screws.

Note: Midmark recommends the gas spring be installed rod end down.

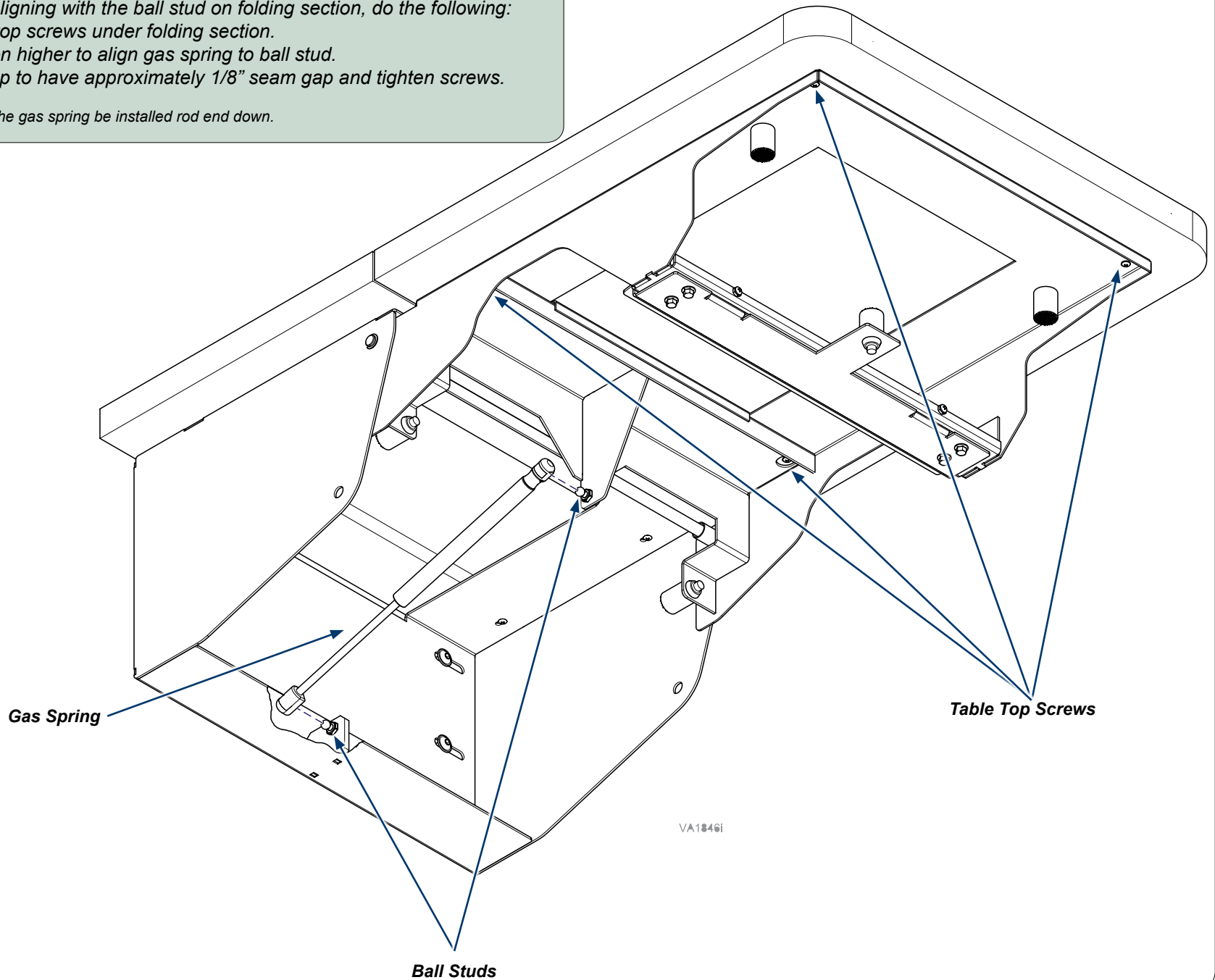

Step 5: Install locking arm.

- A) Install spacer bearing onto one side of locking arm
- B) Slide locking arm through opening in folding section bracket.
- C) Install spacer bearing onto other side of locking arm.
- D) Slide lower shaft through spacer bearings on locking arm.
- E) Align shaft in locking arm with holes in wall base.
- F) Install shaft supports using 1/4-20 screws and a 5/32 allen wrench.



Equipment Alert

Install Locking Arm with Gas Spring Cut Out facing top. Will damage Gas Spring if installed incorrectly.

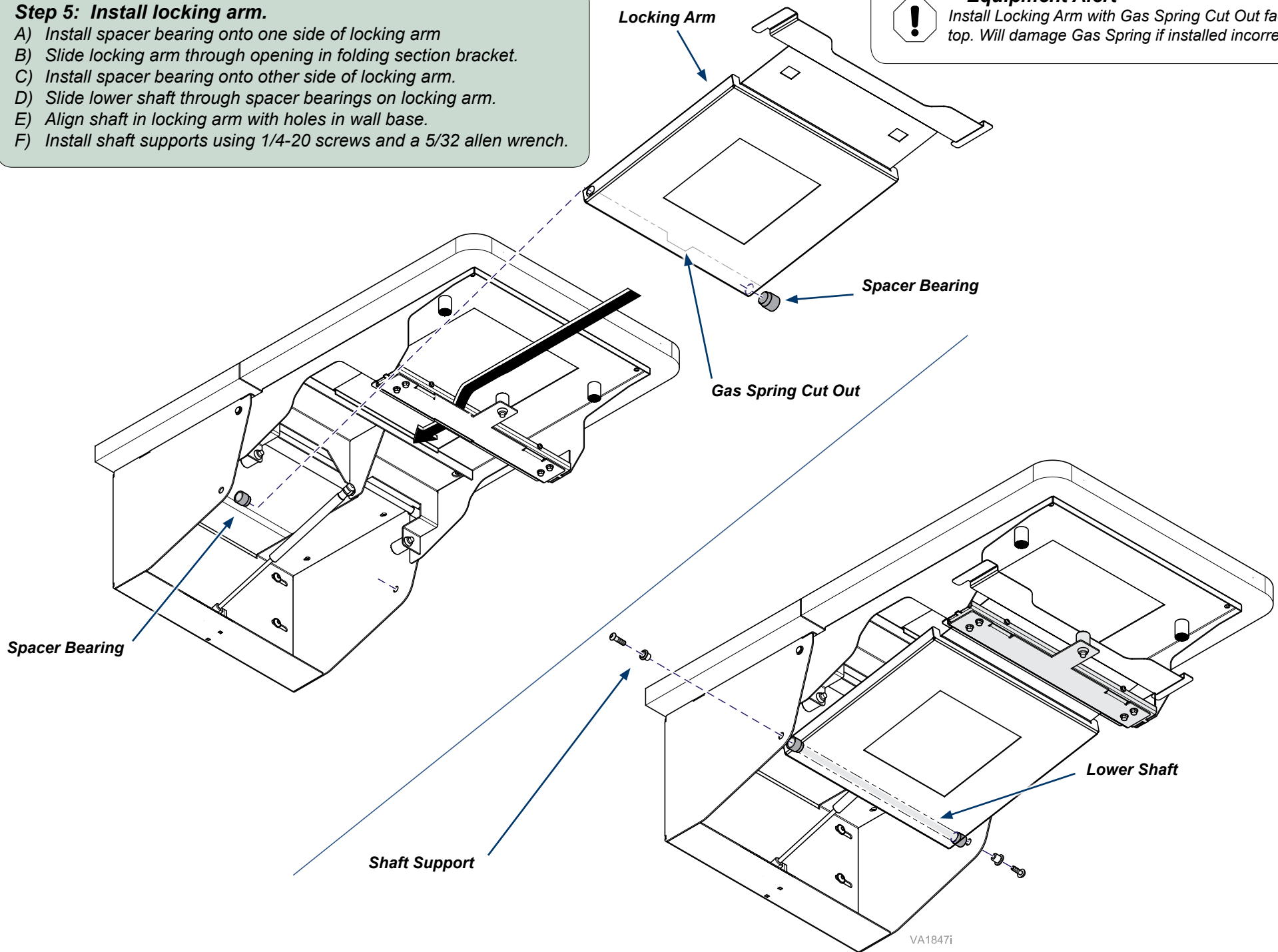

VA1847i

Step 6: Level table.

- A) Place level on table folding section to verify it is flat.
- B) Adjust table if needed.
- C) Lift one side of the locking arm handle to allow table to go down. Lift up the table top to raise and verify it is working properly.

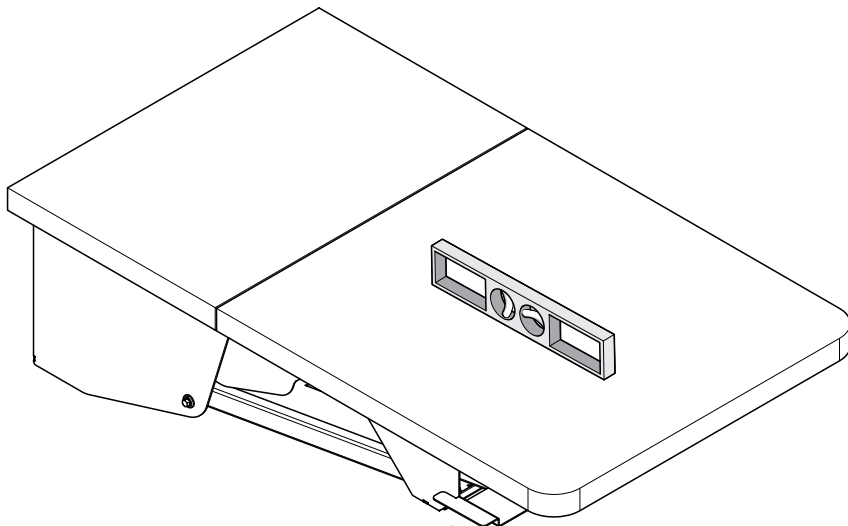

**Locking Arm
Typical**

VA1849i

To adjust table (if needed)..

- A) Loosen all four bolts under end of table.
 - Turn two adjustment screws clockwise to raise table.
 - Turn two adjustment screws counterclockwise to lower table.
- B) Tighten all four bolts.

Note: Both adjustment screws need to be loosened to properly level.

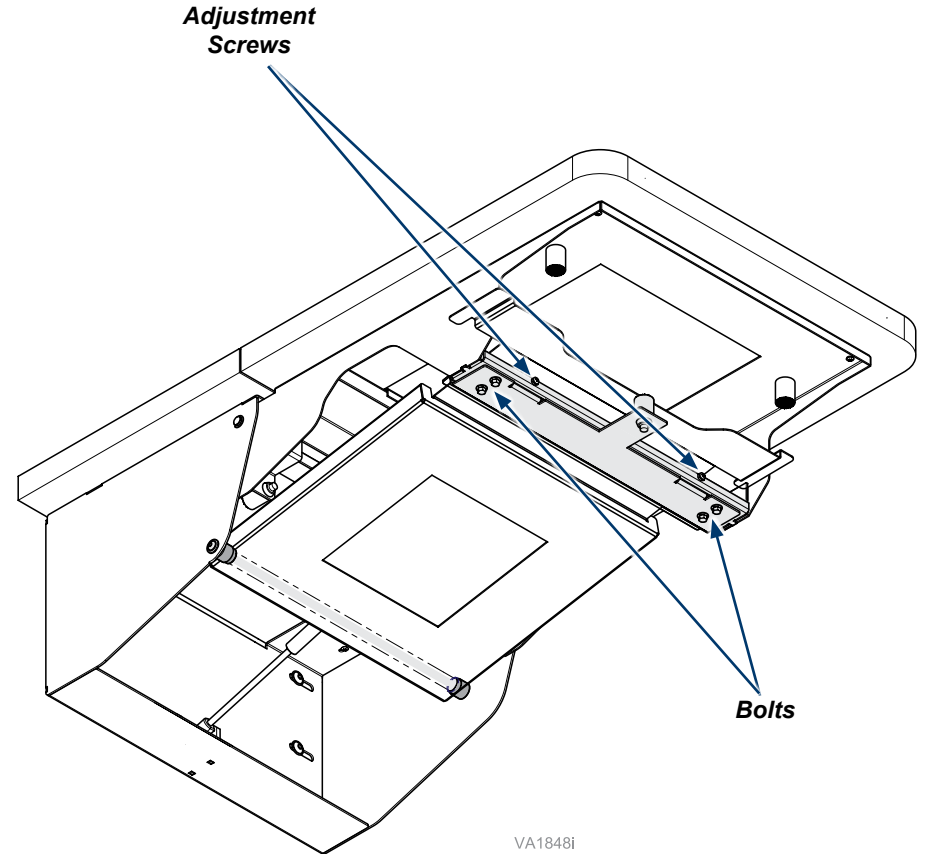

**Adjustment
Screws**

Bolts

VA1848i