

# Socket Accessory Installation

Applies to: Patient Support Spline Adaptor [9A582]

**Components:**  
Adaptor..... 2

**Special Tools:**  
none

**Step 1: Install extension.**  
A) Place adaptor to receiver assembly (9A585).  
B) Tighten adaptor using included allen wrench and combination wrench.  
C) Repeat for other side.

*Note: Align notches so adaptor fits completely into receiver assembly.*

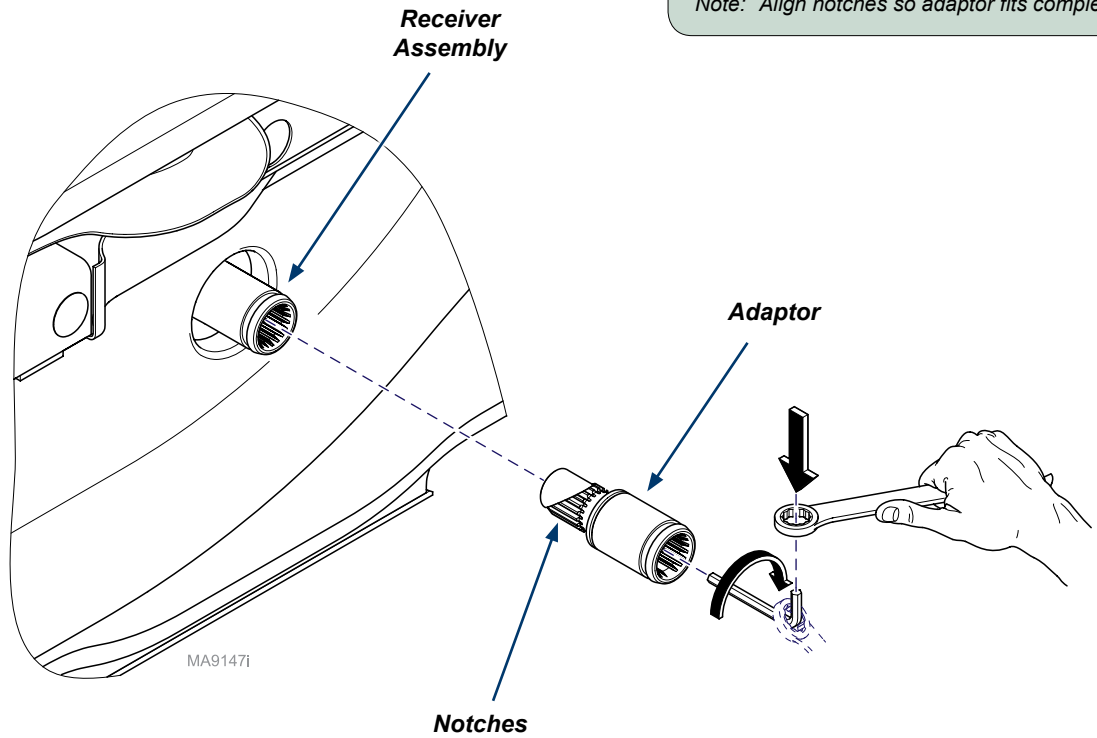

TP200 Rev. A

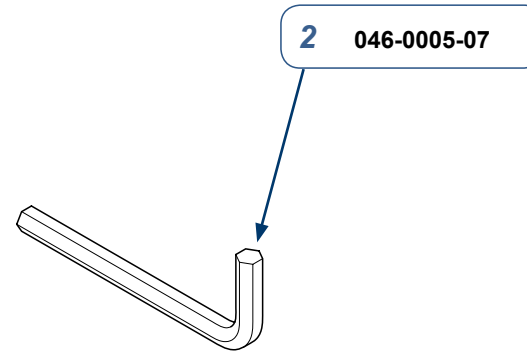
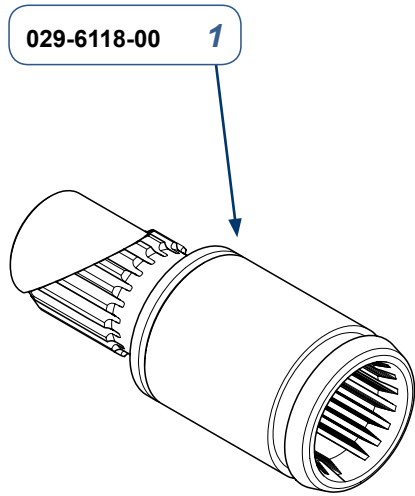

MA9148I

**9A582 Wide Spline Adaptor Assembly**  
(includes items 1 - 3)

Item	Description	Qty.
1	Adaptor	2
2	1/4 Allen Wrench	1
3	Instructions (003-2728-00 <i>not shown</i> )	1

<b>Serial Numbers / Dates:</b>	all
--------------------------------	-----