



255 Mobile Light Mounting Hardware Kit Installation [002-2026-00]

Applies to Models:
255 (-005 / -007 (w/o cord);
-025 / -027 (w/o cord))

Special Tools:
Torque wrench

Language of origin: English



Warning

Always turn OFF light then disconnect power before removing covers.
Failure to do so may result in personal injury.

Step 1: Inspect components.

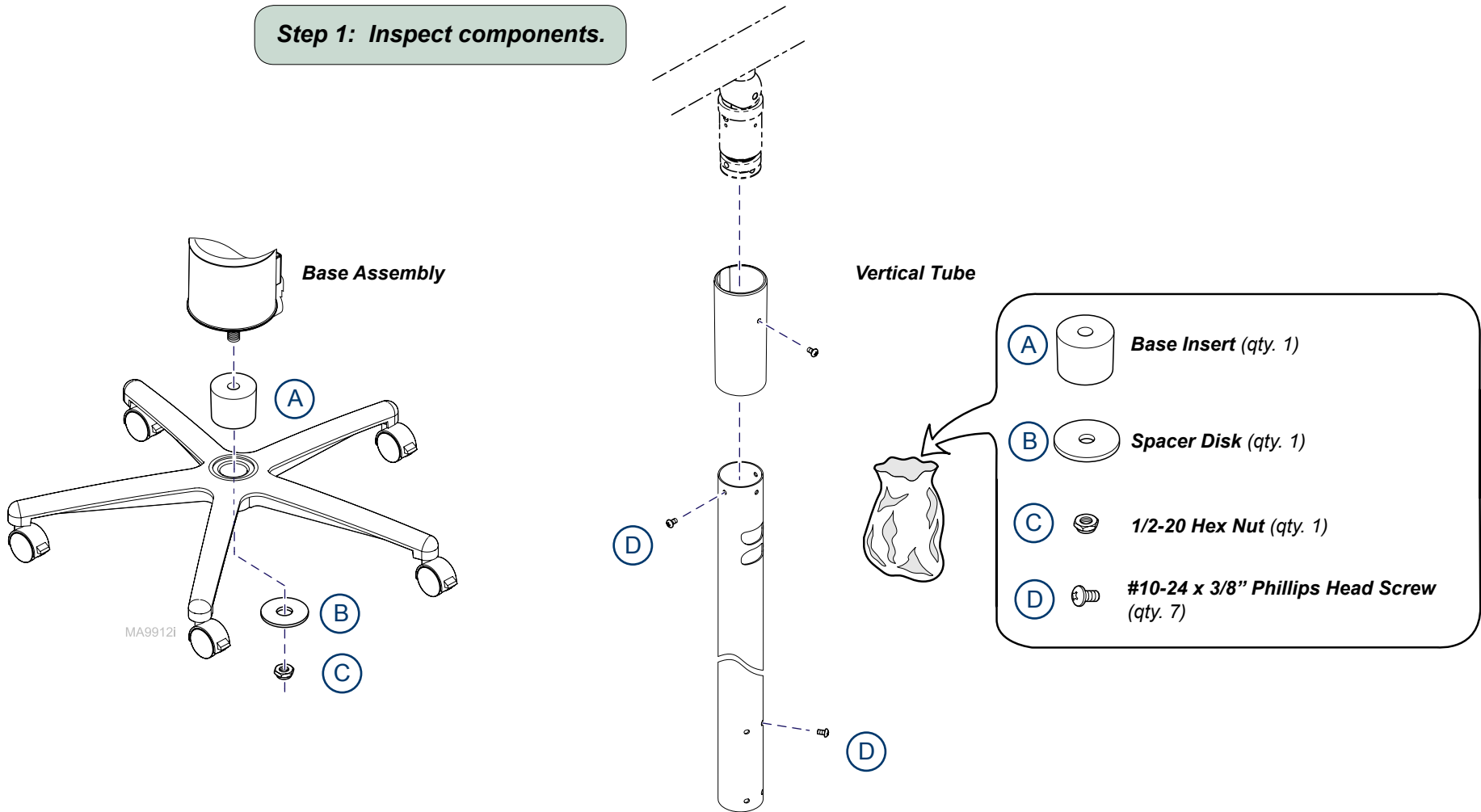

Step 2: Disconnect power.

A) Turn OFF light then disconnect light from power source.

To install base assembly hardware...

A) Place light in ideal, safe working position.

B) Remove hardware from bottom of base assembly.

C) Remove spacer disk between power supply housing and base assembly.

D) Place new base insert and spacer disk on base.

E) Secure power supply housing to base with new hex nut.

Note: Tighten hex nut to 35 - 45 ft-lb (47.5 - 61 N•m)

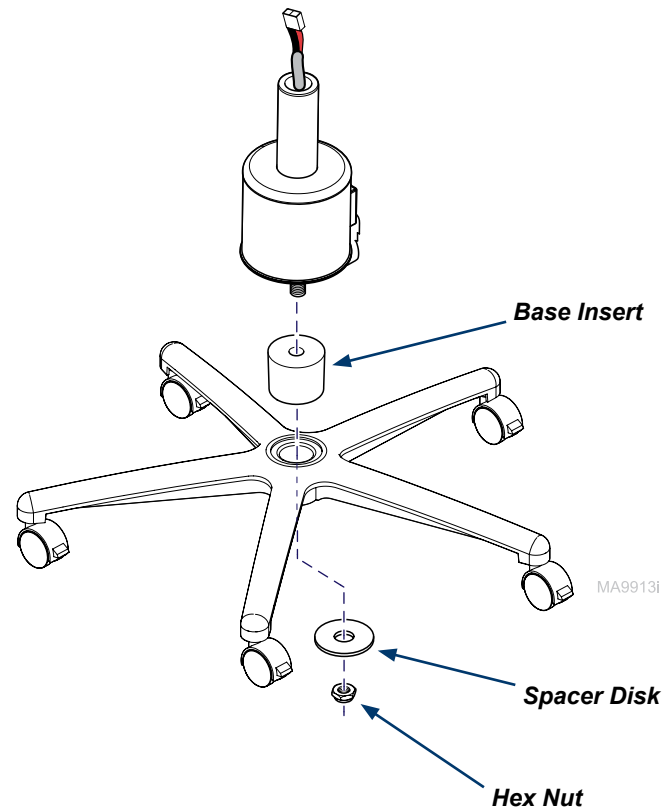

To install vertical tube hardware...

- A) Place light in ideal, safe working position.
- B) Remove four bottom screws from vertical tube.
- C) Install four bottom screws to vertical tube.
- D) Remove the screw from the sleeve.
- E) Slide sleeve down below top screws.
- F) Remove three top screws from vertical tube.
- G) Install three top screws to vertical tube.
- H) Slide sleeve up in previous position and secure with screw.

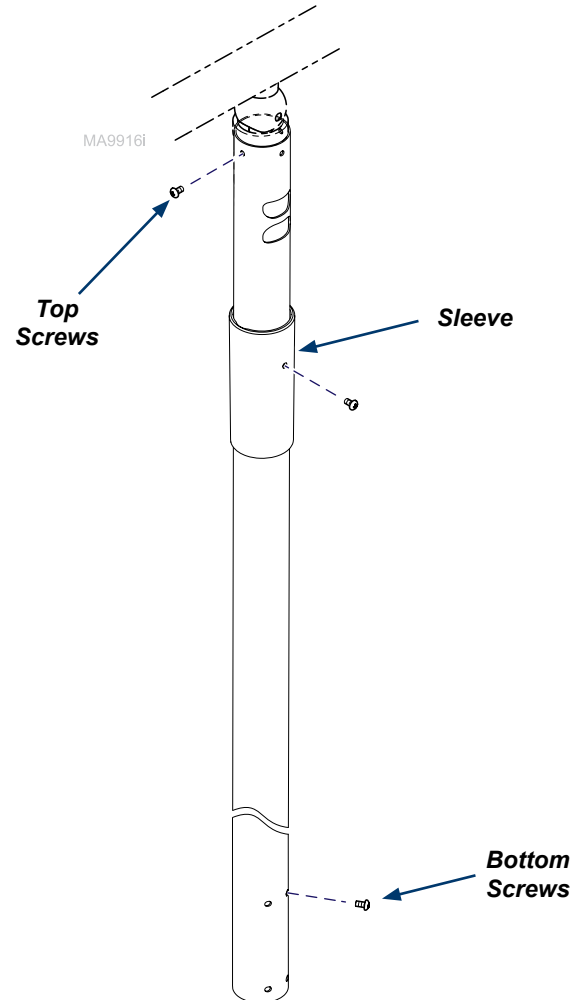

Final Step: Connect power.

- A) Connect light to power source.
- B) Verify operation.