

# 255 LED Mobile Lights

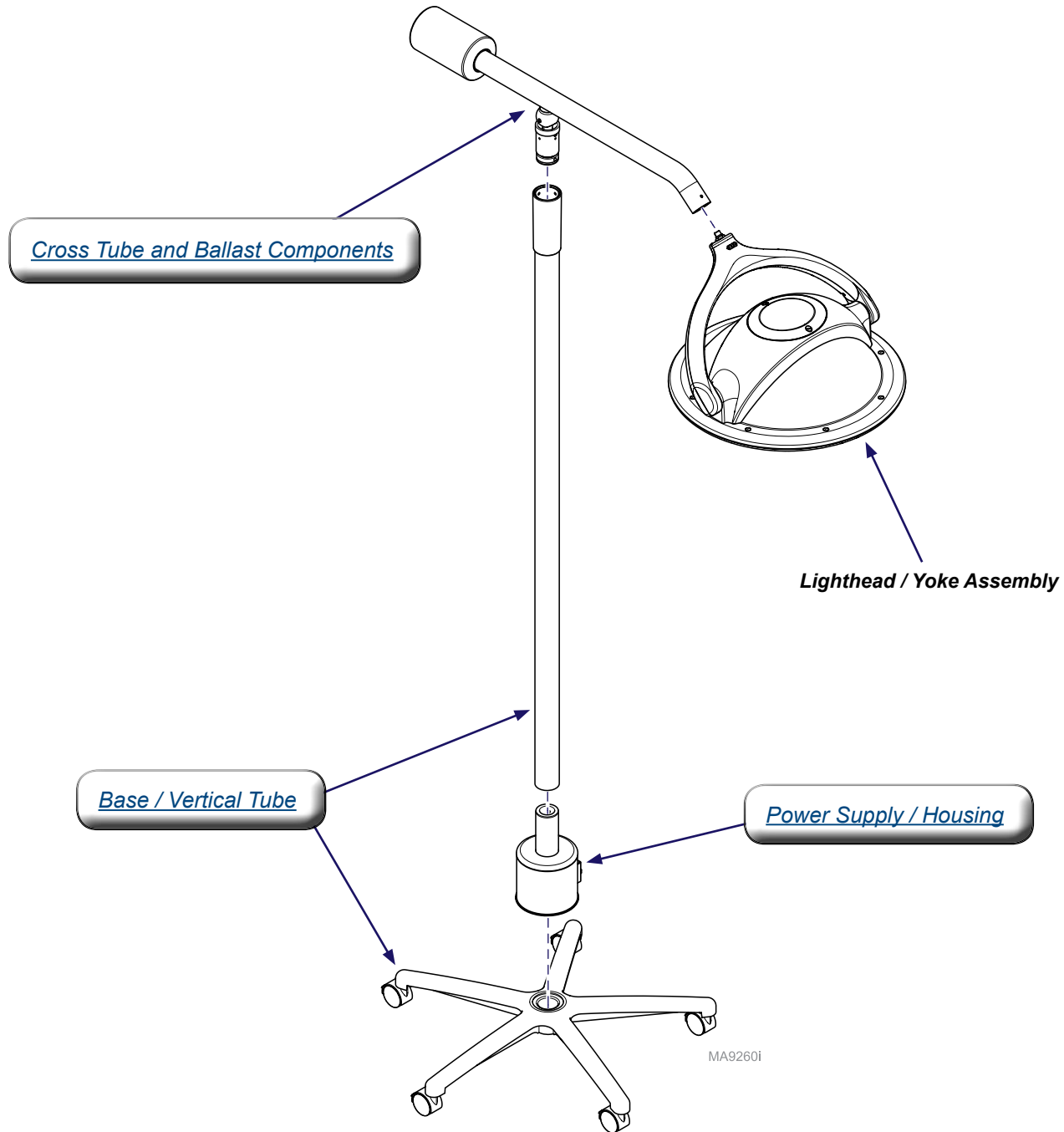

TP205 Rev. B

MA9282i

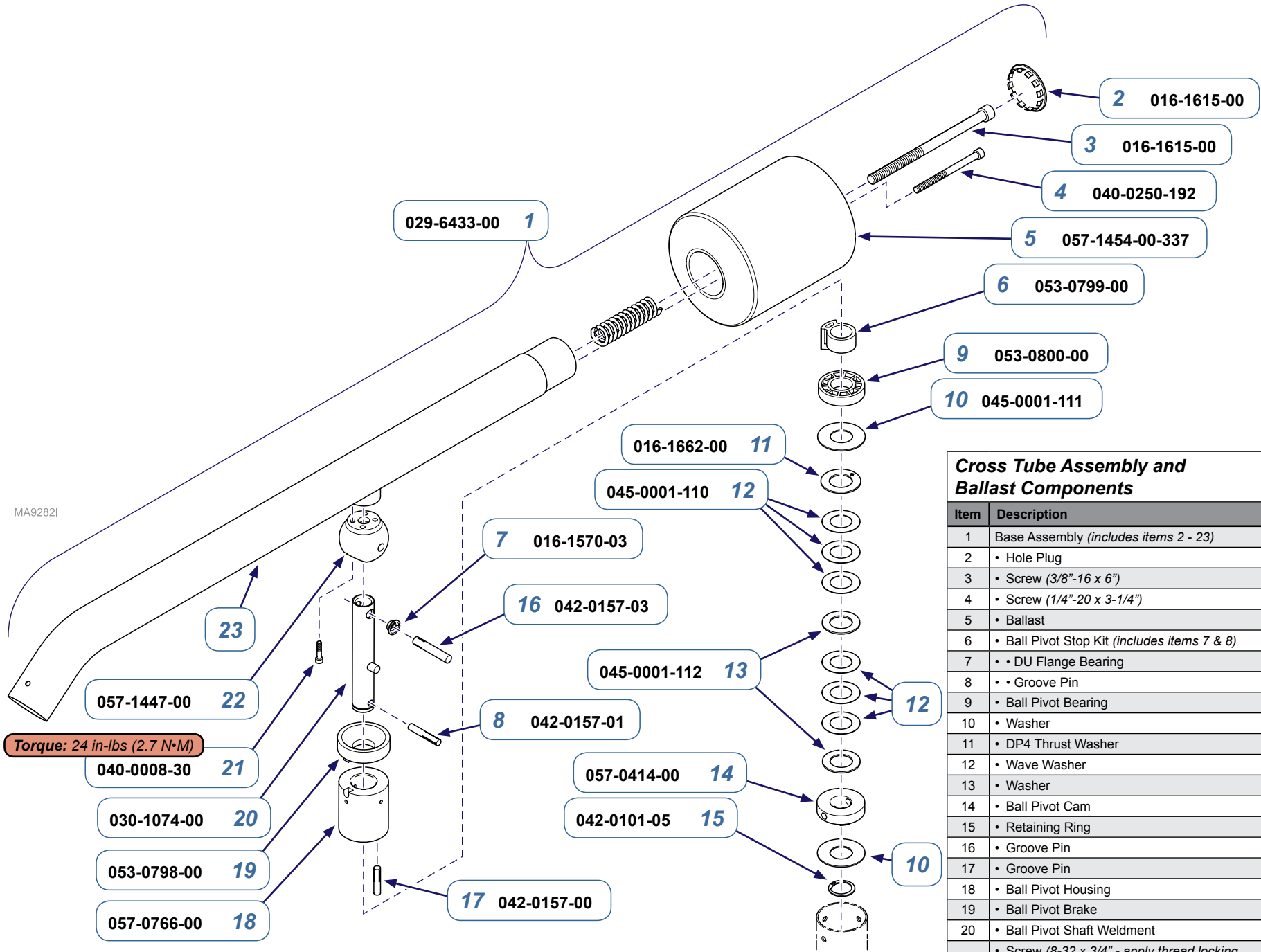

**Cross Tube Assembly and Ballast Components**

Item	Description	Qty.
1	Base Assembly (includes items 2 - 23)	1
2	• Hole Plug	1
3	• Screw (3/8"-16 x 6")	1
4	• Screw (1/4"-20 x 3-1/4")	1
5	• Ballast	1
6	• Ball Pivot Stop Kit (includes items 7 & 8)	1
7	• • DU Flange Bearing	2
8	• • Groove Pin	1
9	• Ball Pivot Bearing	1
10	• Washer	2
11	• DP4 Thrust Washer	1
12	• Wave Washer	6
13	• Washer	2
14	• Ball Pivot Cam	1
15	• Retaining Ring	1
16	• Groove Pin	1
17	• Groove Pin	1
18	• Ball Pivot Housing	1
19	• Ball Pivot Brake	1
20	• Ball Pivot Shaft Weldment	1
21	• Screw (8-32 x 3/4" - apply thread locking adhesive #042-0646-00)	4
22	• Ball Pivot	1
23	• Cross Tube Weldment	1

<b>Page Applies To Model Numbers:</b>	<b>Serial Numbers:</b>
255 (-005, -007)	all

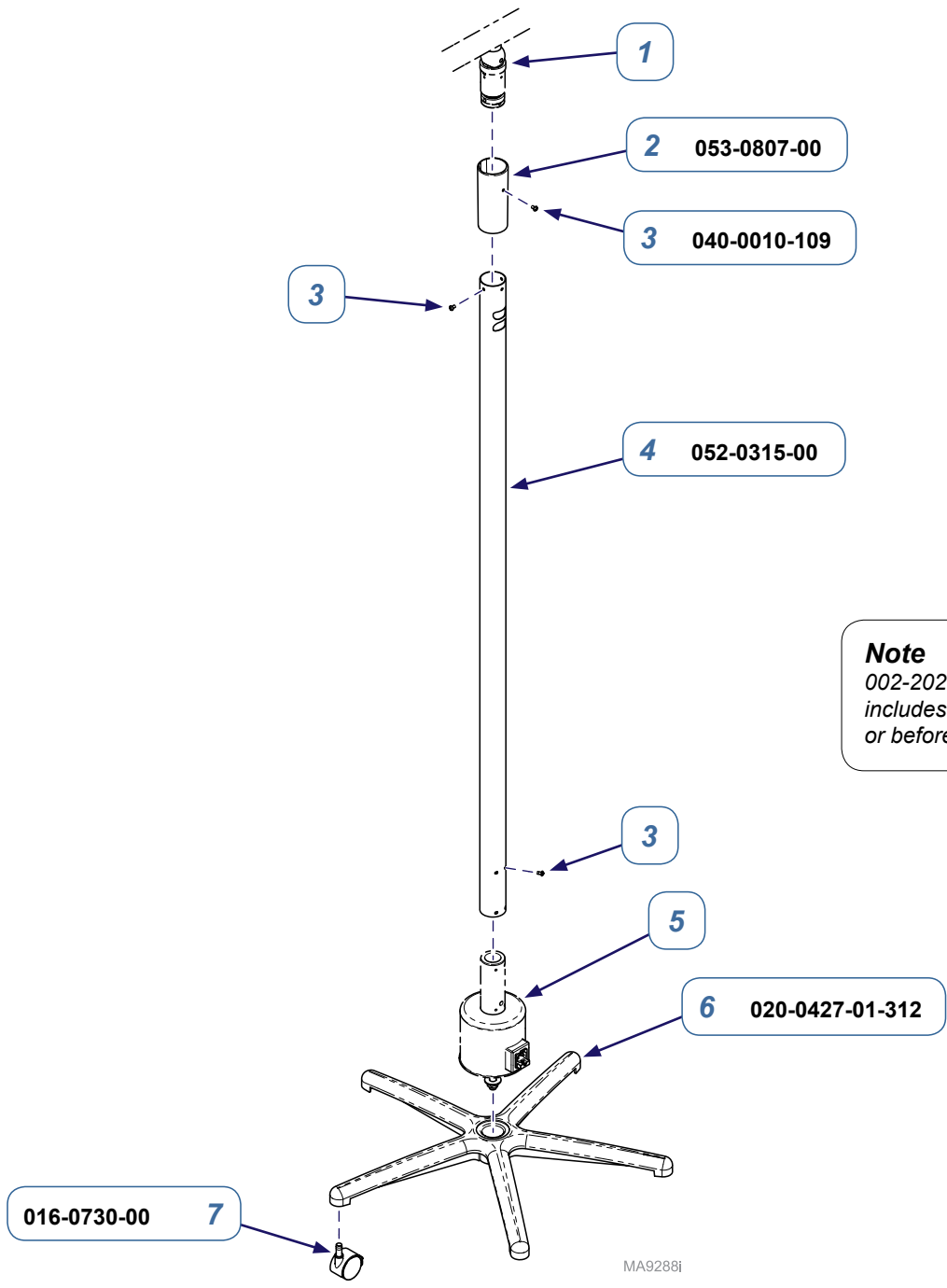

**Note**  
 002-2026-00 mounting hardware kit for base casting includes Items 9, 11 and 12. If light was made on January 12, 2016 or before, then order Item 8 in addition to the 002-2026-00 kit.

<b>Base / Vertical Tube</b>		
Item	Description	Qty.
1	Refer to <a href="#">Cross Tube / Ballast Components</a>	Ref
2	Ball Pivot Sleeve	1
3	Screw (10-24 x 3/8")	7
4	Vertical Tube	1
5	Refer to <a href="#">Power Supply / Housing</a>	Ref
6	Base Casting	1
7	Caster	5

<b>Page Applies To Model Numbers:</b>	<b>Serial Numbers:</b>
255 (-005, -007)	all

MA9288i

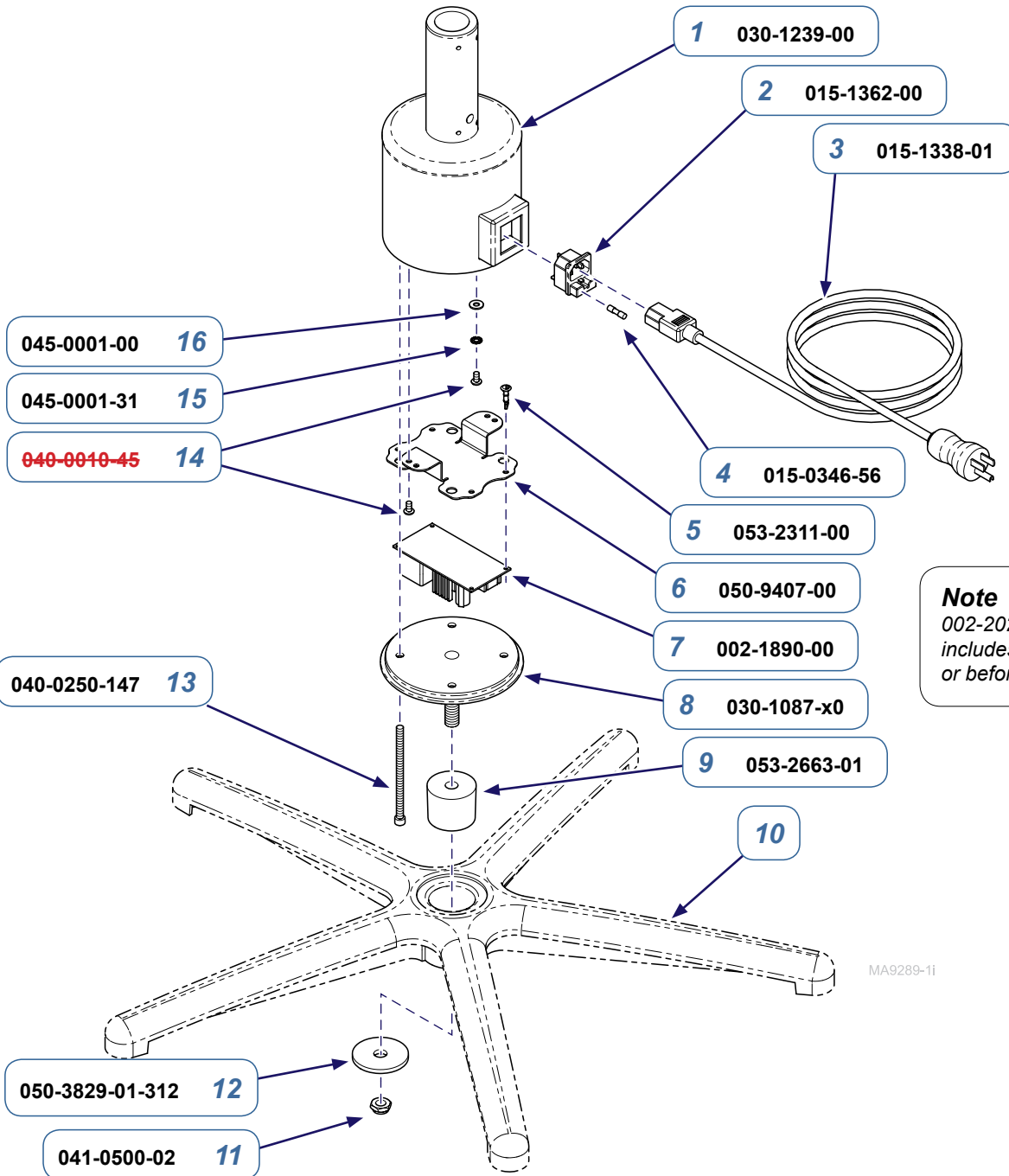

**Note**  
 002-2026-00 mounting hardware kit for base casting includes Items 9, 11 and 12. If light was made on January 12, 2016 or before, then order Item 8 in addition to the 002-2026-00 kit.

Power Supply / Housing		
Item	Description	Qty.
1	Top Plate Weldment	1
2	AC Inlet	1
3	Cordset	1
4	Fuse (1.6A, 250V, Slo-Blo)	2
5	PC Board Standoff	4
6	Power Supply Bracket	1
7	Power Supply	1
8	Bottom Plate Weldment	1
9	Base Insert	1
10	Refer to <a href="#">Base / Vertical Tube</a>	Ref
11	Lock Nut (1/2" - 20)	1
12	Spacer Disk	1
13	Screw (1/4" - 20 x 4")	4
14	Screw (10-24 x 3/8")	3
15	Lock Washer (#10)	1
16	Washer (#10)	1

Page Applies To Model Numbers:	Serial Numbers:
255 (-005, -007)	all

TP205 Rev. B