

General dimensions

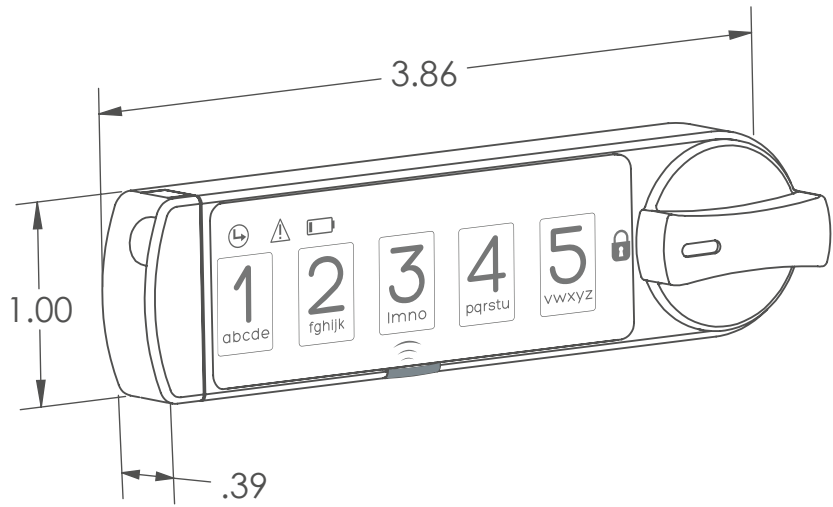
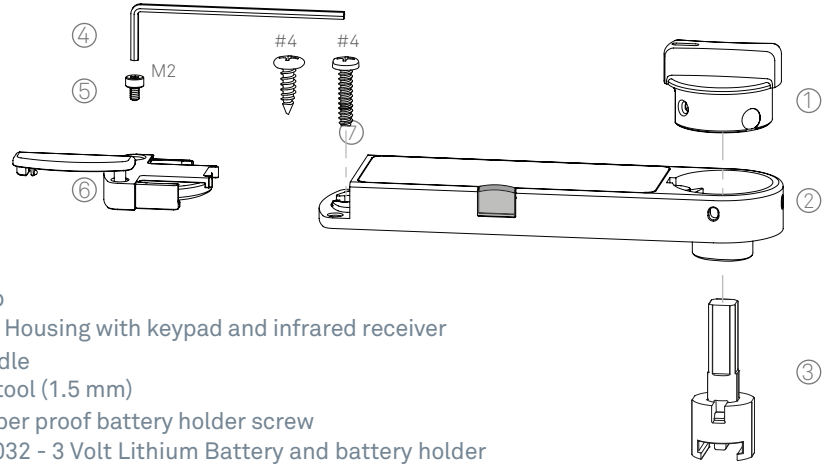

Fig. 1



- 1 Knob
- 2 Lock Housing with keypad and infrared receiver
- 3 Spindle
- 4 Hex tool (1.5 mm)
- 5 Temper proof battery holder screw
- 6 CR2032 - 3 Volt Lithium Battery and battery holder
- 7 Mounting screws (select one)

1

Installation

- 1 Align the bar on the MicroIQ spindle to be perpendicular with the bars of the Timberline shell as shown below. (Bars shown darkened in the picture below)

With the knob attached, insert the spindle into the shell and using the MicroIQ knob, turn the spindle 90° CCW until you hear or feel a snap sound.

Verify that the spindle is engaged.

Example*:

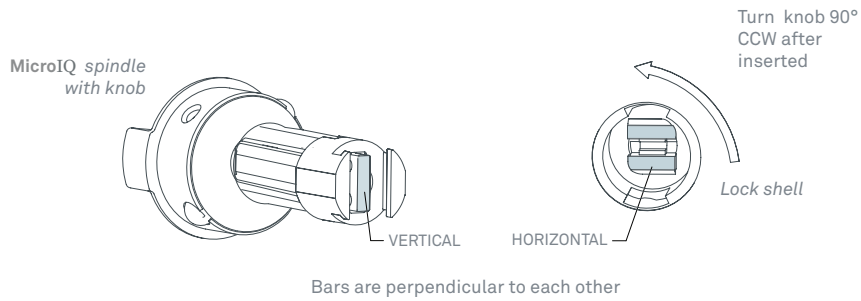

* NOTE: If the lock shell bars are vertical, insert the spindle with the bars in the horizontal position.

2

- 2 Exercise the knob and verify that the spindle is engaged and operates your locking mechanism as intended.

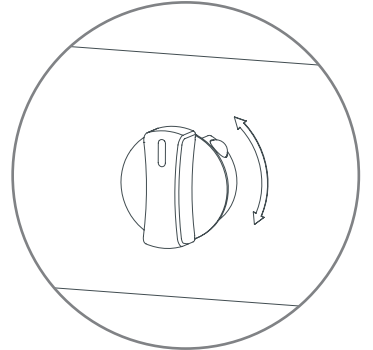

- 3 Remove the knob from the spindle with the mechanism in the locked position.

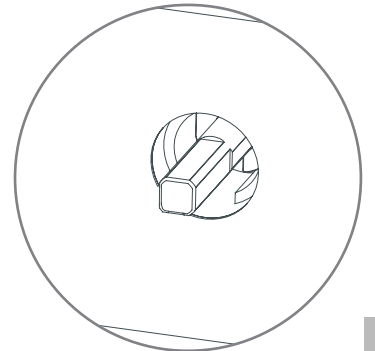

4

- 4 Install Fastener

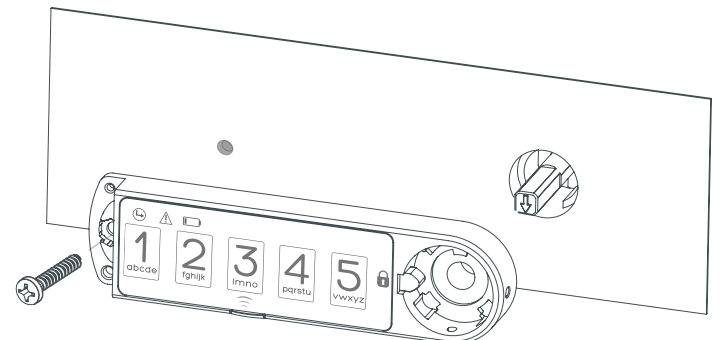

- 5 Select appropriate mounting screw.

If mounted on sheet metal :

#4 x.375 sheetmetal screw

If mounted to wood panel with threaded insert:

#4 -40 x.500 machine screw

- 6 Insert the knob and push until flush inside housing at locked position and rotate to verify that the cam stop was positioned correctly.

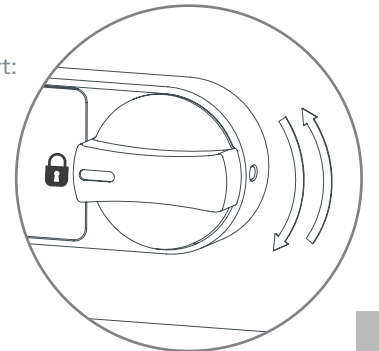

Confirm that your mechanism is locked when the knob points to the lock icon.

5

- 7 Rotate your knob only 45°. Using the hex tool, fasten the knob to the spindle from the indicated location.

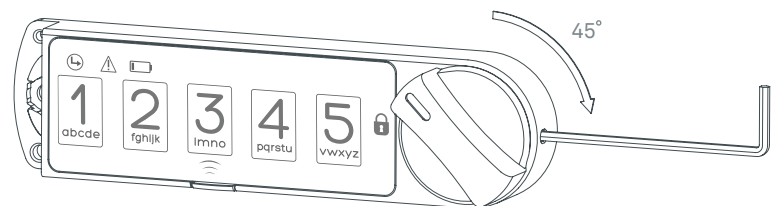

Battery

The mounting screw for the lock housing must be installed before installing the MicroIQ battery. Prior to installation and insertion of the battery, the knob of the lock mechanism will be free moving.

After installing the lock to the mounting surface, the battery and holder can be inserted into the lock. The cover for the battery holder also serves to lock the holder into the lock housing. The battery cover must be in the fully open position before inserting the holder. The battery holder screw cannot be protruding from the bottom of the battery holder. It must be flush with the holder so the holder can be inserted.

6

3



www.microiqlock.com



New Install (Wood)



New Install (Metal)

TriTaq Lock and Security
701 Gullo Ave
Elk Grove Village, IL 60007

Phone: (847) 640-7002
Toll Free: (888) 603-5625
Email: marketing@triteqlock.com

061715 - Rev. 4

© Copyright 2014 TriTaq Lock and Security. All rights reserved



Installation Instructions
CORE REPLACEMENT LOCK
MicroIQ



Check that the battery is properly inserted into the holder. The “+” surface of the battery should be inserted into the holder against the surface of the holder marked with the “+” symbol. Insert the battery holder into the lock with the holder cover in the fully open position and with the battery holder screw flush to the bottom of the holder until the holder is fully seated. Next, use the hex tool to fasten the battery holder screw into the lock body. Last, swing the battery holder cover to the closed position, push in and fully seat the cover into the battery holder until it is flush to the lock body.

If the battery is inserted while the knob is locked, you should hear the lock mechanism click and the unit will lock. If the battery is inserted while the knob is unlocked, after turning the knob to the locked position you should hear the lock mechanism click and the unit will lock. If the unit will not lock after inserting the battery, enter the factory code, move the knob to the unlocked position, and move the knob to the locked position and you should hear the lock mechanism click and the unit will lock. If the unit still does not lock, replace the battery.

Cleaning and Care: To clean the MicroIQ surface, apply a non-acid based cleaner to a clean cotton cloth. Do not spray cleaner directly on the MicroIQ. Wipe down the keypad and housing surface of excess cleaner.

TriTeq Limited Warranty: TriTeq offers a one year limited warranty on all products to be free from manufacturing defects in materials and workmanship. This limited warranty does not cover battery, lost combinations or damages caused by improper mounting, operation or unreasonable use.

Liability Limits: This is a limited warranty and in lieu of all other warranties (including the implied warranties of merchantability and fitness of use) and under no circumstances shall TriTeq Lock & Security or Hudson Lock, LLC be liable for any incidental or consequential damages or losses.

Station Mode Programming Instructions

Two operating modes:

1. Station mode (repeated use with the same code)
2. Locker mode (use with a temporary code)

The default operating mode from the factory is Station Mode. To determine which operating mode the lock is in, remove the battery, press and release the program button, and reinsert the battery. Note the color sequence of the LED flashes when the battery is reinserted:

 (green, red, yellow) indicates station mode
 (green, yellow, red) indicates locker mode

Program button:

Initiate the lock programming mode by pressing the front thin edge of the black button inward toward the mounting surface the MicroIQ is mounted to.

Infrared Receiver:

The Infrared Receiver will receive a signal from an electronic TriTeq key fob when it is pointed at the receiver located behind the Program button. The Program button is slightly opaque so the key-fob signal will penetrate the button.

Knob:

To move the lock mechanism 90 or 180 degrees clockwise or counterclockwise from the locked and unlocked states.

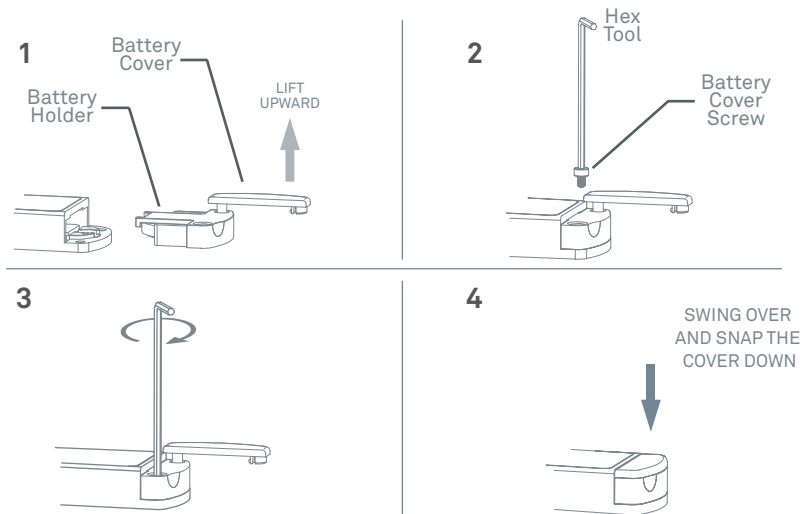
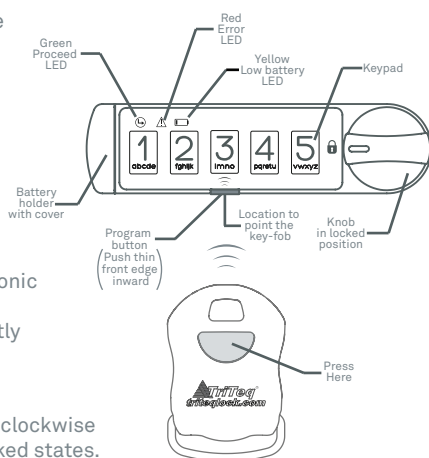

Operating Temperature: 0 - +50 C
Storage temperature: -10 - +70 C
Operating Moisture: 20% - 80% Rh (without condensation)
Replacement Battery: 3 volt lithium CR2032
Battery Life: 5 years or more (calculated at 20 uses per day)

Multiple levels of access:

1. Master code and/or blue control key fob
2. Supervisor code and/or black key fob (station mode only)
3. User code and/or black key fob (user key fob available for station mode only)

As an option, the lock can be operated with one blue remote key-fob and up to two black remote key-fobs.

The factory master code is: **135243**
The factory supervisor code is: **123**

Note:

The MicroIQ is pre-programmed with a factory master code and a factory supervisor code.

Operation:

Unlock with a code by entering a valid code. The green LED will illuminate. Turn the knob to unlock. To lock, turn the knob to align the knob pointer with the lock icon on the keypad.

Programming Chart Symbols:

- = press program button
- Solid color indicates LED is lit
- Indicates LED is flashing

(Nx) - indicates flashes N times

1,2,3,4,5 = Indicates the button number to press

If any there are any errors in executing the steps below or too much time elapses between the steps, (3x) and the lock will exit the programming mode.

CHANGE THE MASTER CODE (6 DIGITS) USING THE FACTORY MASTER CODE

factory master code factory master code new master code (2x) (6x)

Example: 135243 135243 112233 (2x) (6x)

Result: Factory master code 135243 was erased and the new master code 112233 was accepted.

CHANGE THE SUPERVISOR CODE (3-6 DIGITS) USING THE FACTORY SUPERVISOR CODE

factory supervisor code new supervisor code (6x)

Example: 123 4321 (6x)

Result: Supervisor code 123 was erased and supervisor code 4321 was added.

ADD A USER CODE (3-6 DIGITS) USING THE SUPERVISOR CODE

supervisor code user code (6x)

Example: 4321 54321 (6x)

Result: Supervisor code 4321 was used to add user code 54321.

CHANGE THE MASTER CODE (6 DIGITS)

old master code old master code new master code (2x) (6x)

Example: 112233 112233 123455 123455 (6x)

Result: Old master code 112233 was erased and new master code 123455 was accepted.

CHANGE THE SUPERVISOR CODE (3-6 DIGITS) USING A SUPERVISOR CODE

old supervisor code new supervisor code (6x)

Example: 4321 111555 (6x)

Result: Supervisor code 4321 was erased and supervisor code 111555 was added.

CHANGE THE SUPERVISOR CODE (3-6 DIGITS) USING THE MASTER CODE

master code new supervisor code (6x)

Example: 123455 531 (6x)

Result: Master code 123455 was used to change the supervisor code to 531.

ADD A USER FOB USING THE SUPERVISOR FOB

point supervisor fob at and press fob button point the user fob at and press fob button (6x)

Result: Supervisor fob was used to add a user fob.

REMOVE THE USER FOB USING THE SUPERVISOR CODE

supervisor code 11111 (6x)

Example: 543 11111 (6x)

Result: Supervisor code 543 was used to remove the user fob. User fob is no longer valid for access.

REMOVE THE USER FOB USING THE SUPERVISOR FOB

point supervisor fob at and press fob button 11111 (6x)

Result: User fob is no longer valid for access.

TO UNLOCK WITH A FOB

Point a valid fob at and press fob button turn knob to unlock the lock

Result: The lock will unlock.

Double digit codes:

The numbers 6, 7, 8, and 9 can be entered by pressing two keys simultaneously in order to produce a sum. For example 2 and 4 can be pressed simultaneously to produce the number 6 (2+4=6). Note, if the code was programmed using 2+4 as the 6 digit, the 2+4 must be used when accessing the lock, because other combinations that equal six such as 1+5 are distinguished from 2+4.

REMOVE THE USER CODE USING THE SUPERVISOR CODE

supervisor code 11111 (6x)

Example: 531 11111 (6x)

Result: Supervisor code 531 was used to remove the user code. User code is no longer valid for access.

ADD A CONTROL FOB

master code point control fob at and press fob button (6x)

Example: 123455 point control fob at and press fob button (6x)

Result: Master code 123455 was used to add a control fob.

ADD A SUPERVISOR CODE (3-6 DIGITS) USING THE CONTROL FOB

point control fob at and press fob button supervisor code (6x)

Example: point control fob at and press fob button 543 (6x)

Result: Control fob was used to add new supervisor code 543.

ADD A SUPERVISOR FOB USING THE MASTER CODE

master code point supervisor fob at and press fob button (6x)

Example: 123455 point supervisor fob at and press fob button (6x)

Result: Master code 123455 was used to add a supervisor fob.

ADD A SUPERVISOR FOB USING THE CONTROL FOB

point control fob at and press fob button point supervisor fob at and press fob button (6x)

ADD A USER FOB USING THE SUPERVISOR CODE

supervisor code point the user fob at and press fob button (6x)

Example: 543 point the user fob at and press fob button (6x)

Result: Supervisor code 543 was used to add a user fob.

Switching Modes

Note: The master code is retained when switching modes.

1. Unlock the MicroIQ and turn the knob to the unlocked position
2. Remove the battery for 10 seconds
3. While holding the program button , reinsert the battery and wait until all 3 LED's fade in and fade out simultaneously
4. Release the program button
5. Enter the 6 digit master code. When the master code is entered correctly, the yellow LED will illuminate.
6. Press button number 1 for station mode, Press button number 2 for locker mode.
7. Once the lock switches modes, the LED's will flash in a certain order according to the mode selected.
 - a. Station Mode:
 - b. Locker Mode:
8. Proceed to operate the lock in the selected mode



TriTeq Lock and Security
701 Gullo Ave
Elk Grove Village, IL 60007
101615 - Rev. 4 MMK

www.microiqlock.com

Phone: (847) 640-7002
Toll Free: (888) 603-5625
Email: marketing@triteqlock.com

© Copyright 2014 TriTeq Lock and Security. All rights reserved