



# Wireless Hand / Foot Control Installation [9A429]

**Components:**

Bracket .....	1
Screw: (#10-24 x 3/8") .....	1
Antenna .....	1
PC Board .....	1
Foot Control .....	1
Hand Control .....	1
Batteries (AA) .....	4

**Compatible with serial numbers:**  
9A429004 [625-001, -003, -005, -006 (S/N V968528 thru V1266165)]  
9A429010 [625-001, -003, -005, -006 (S/N V1266166 thru Present)]

**Note**  
For parts list, refer to the 625 Service and Parts manual.

 **Caution**  
Always disconnect power to chair before removing covers or performing any service procedures.

**Step 1: Remove RH side cladding.**  
A) Press two tabs, then pull bottom of cladding away from the table.  
B) Lift cladding off the upperwrap engagement.  
C) Pull cladding toward foot end to remove.

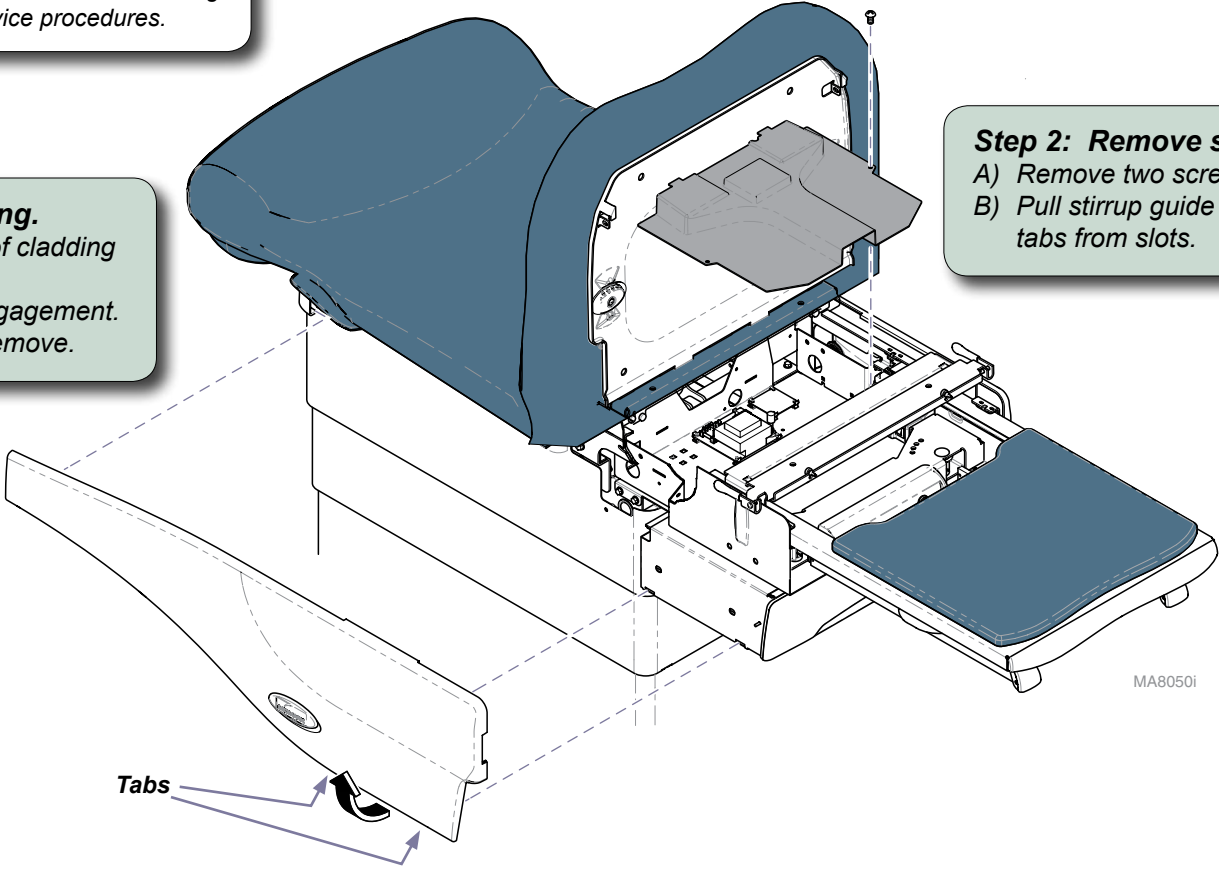

**Step 2: Remove stirrup guide.**  
A) Remove two screws.  
B) Pull stirrup guide to disengage tabs from slots.

**Step 3: Install the PC board.**

- A) Position the PC board as shown.
- B) Press board onto four standoffs.

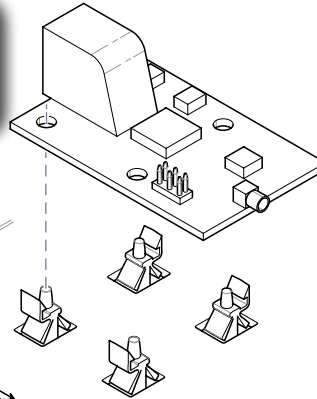

**Equipment Alert**

Antenna connection is very delicate. Do not kink wire or apply stress to connection. Be sure not to pinch wire when installing stirrup guide.

**Step 5: Connect wiring to PC board.**

- A) Install bushing as shown.
- B) Route antenna wire up thru bushing.
- C) Secure antenna wire with cable tie.
- D) Connect two wire harnesses to PC board as shown.

Note: When power is connected, three LEDs on the PC board will illuminate.

**Step 4: Mount the antenna.**

- A) Insert bracket into slot.
- B) Secure bracket with screw.
- C) Secure antenna to bracket with lockwasher & nut.

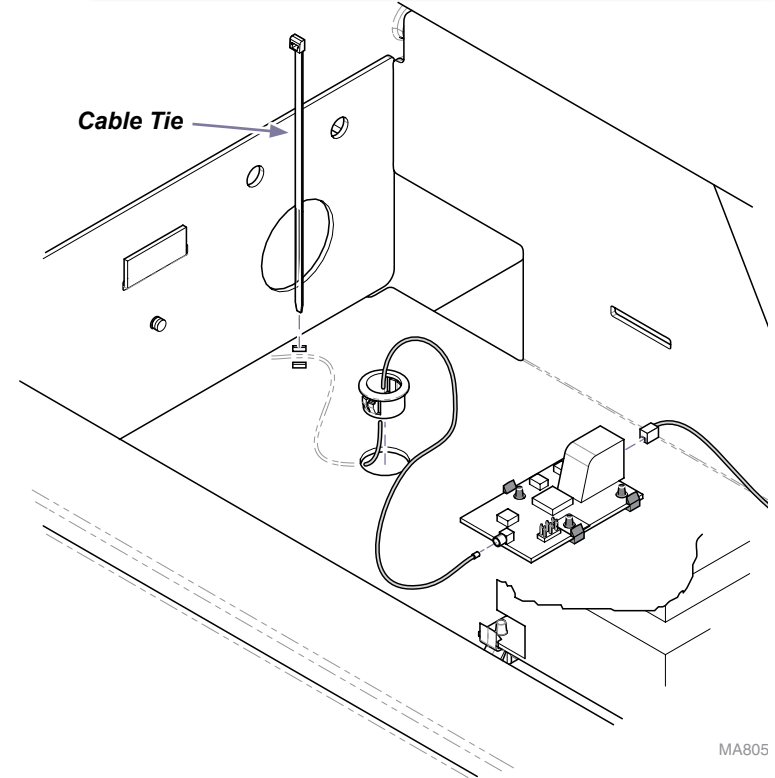
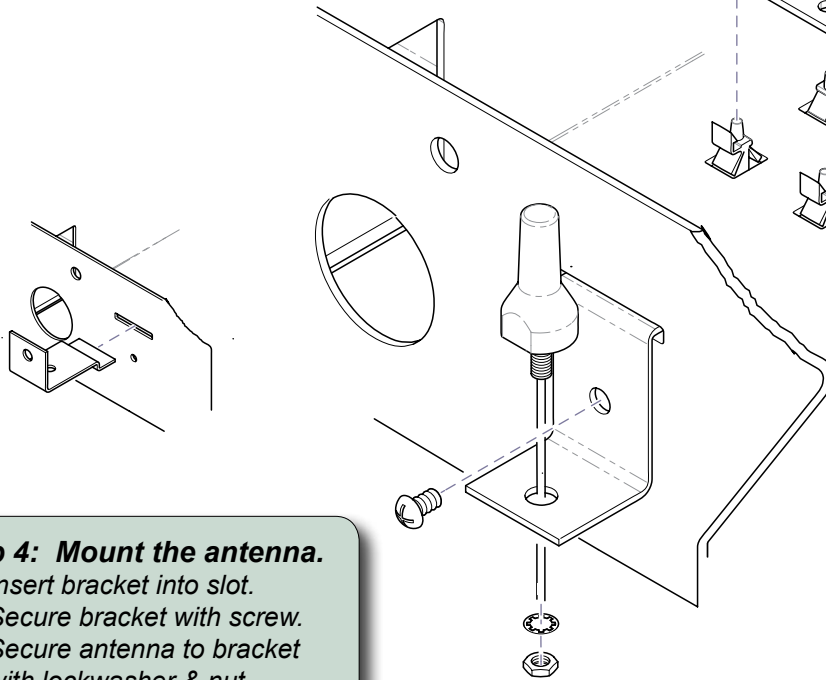

**To complete installation:**

- Install batteries in hand / foot controls
- Check for proper operation
- Install stirrup guide & side cladding
- Install FCC Compliance label to back of chair (beside serial number label)

MA805